

APPENDIX 'D'

TRAFFIC STAGING FIGURES

M:\Proj\13014\CD\14014\CD\Infrastructure Improvements-Detailed Design\Figures\Staging\13014 - 2014 and 2015 Staging.dwg - Last Saved: 4/22/2014 8:27 AM by dilan - Plotted: 4/22/2014 10:12 AM by Dave Lane

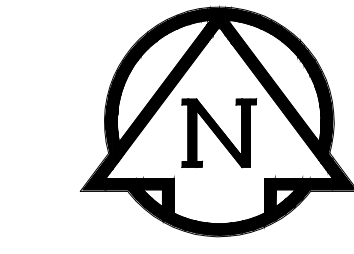
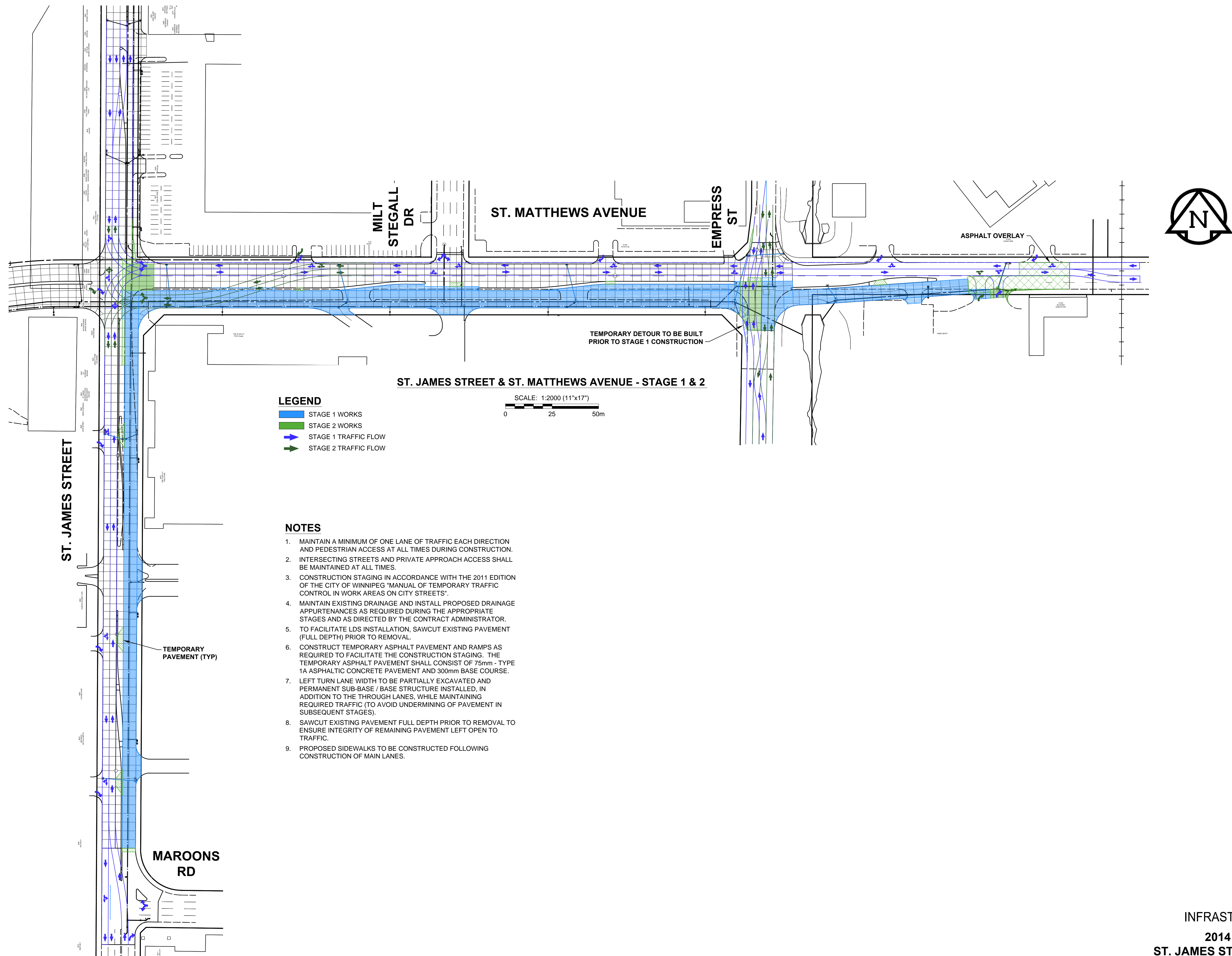

POLO PARK
 INFRASTRUCTURE IMPROVEMENTS
 2014 STAGING - STAGE 1 & 2
 ST. JAMES STREET & ST. MATTHEWS AVENUE
 FIGURE S-01

M:\Proj\W130014\CD\POLO Park Infrastructure Improvements-Detailed Design\Figures\Staging\W130014 - 2014 and 2015 Staging.dwg - Last Saved: 4/22/2014 9:21 AM by Diane Plotted: 4/22/2014 10:12 AM by Dave Lane

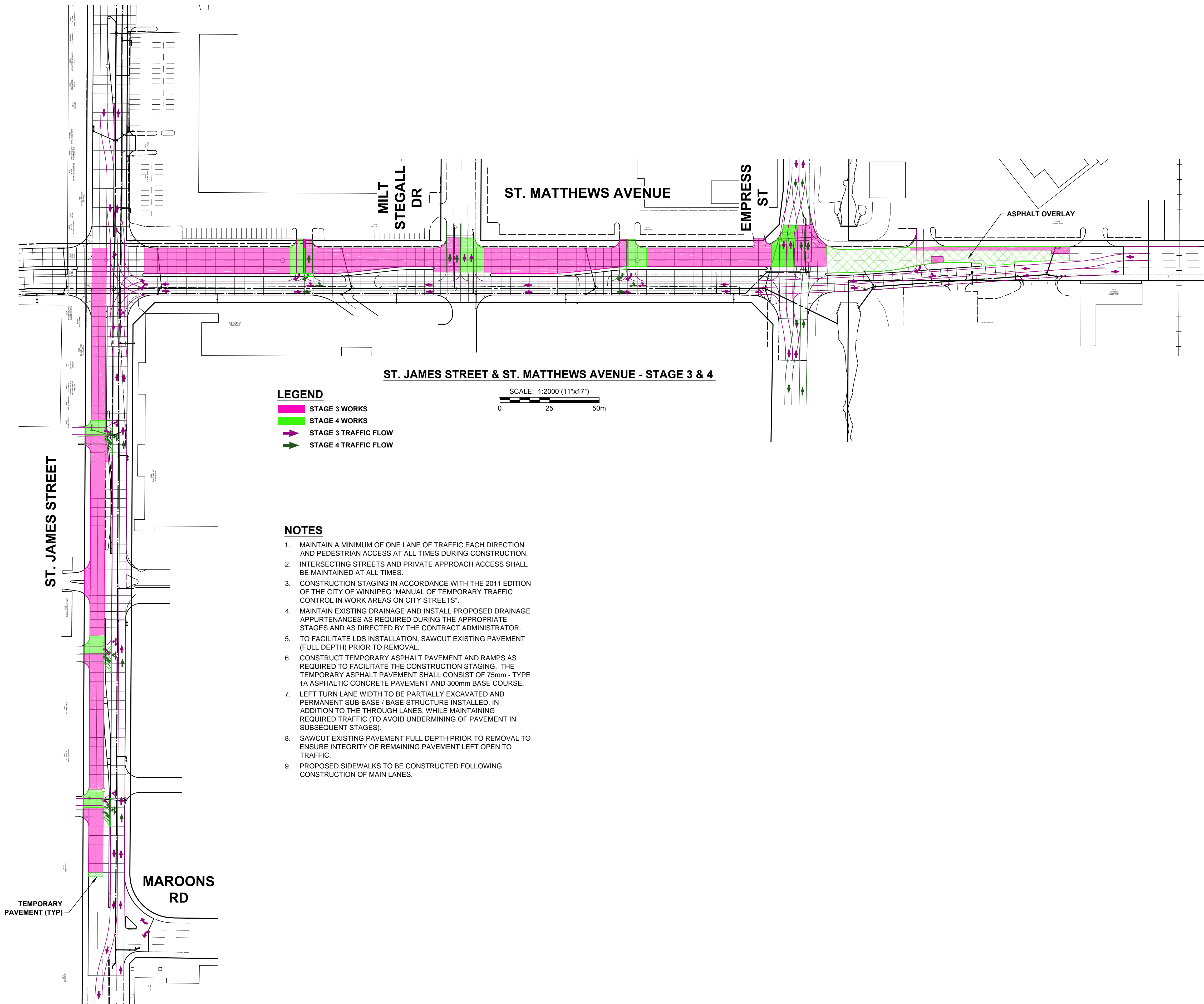

ST. JAMES STREET & ST. MATTHEWS AVENUE - STAGE 3 & 4

- LEGEND**
- STAGE 3 WORKS
 - STAGE 4 WORKS
 - STAGE 3 TRAFFIC FLOW
 - STAGE 4 TRAFFIC FLOW

SCALE: 1:2000 (11"x17")
0 25 50m

- NOTES**
1. MAINTAIN A MINIMUM OF ONE LANE OF TRAFFIC EACH DIRECTION AND PEDESTRIAN ACCESS AT ALL TIMES DURING CONSTRUCTION.
 2. INTERSECTING STREETS AND PRIVATE APPROACH ACCESS SHALL BE MAINTAINED AT ALL TIMES.
 3. CONSTRUCTION STAGING IN ACCORDANCE WITH THE 2011 EDITION OF THE CITY OF WINNIPEG "MANUAL OF TEMPORARY TRAFFIC CONTROL IN WORK AREAS ON CITY STREETS".
 4. MAINTAIN EXISTING DRAINAGE AND INSTALL PROPOSED DRAINAGE APPURTENANCES AS REQUIRED DURING THE APPROPRIATE STAGES AND AS DIRECTED BY THE CONTRACT ADMINISTRATOR.
 5. TO FACILITATE LDS INSTALLATION, SAWCUT EXISTING PAVEMENT (FULL DEPTH) PRIOR TO REMOVAL.
 6. CONSTRUCT TEMPORARY ASPHALT PAVEMENT AND RAMPS AS REQUIRED TO FACILITATE THE CONSTRUCTION STAGING. THE TEMPORARY ASPHALT PAVEMENT SHALL CONSIST OF 75mm - TYPE 1A ASPHALTIC CONCRETE PAVEMENT AND 300mm BASE COURSE.
 7. LEFT TURN LANE WIDTH TO BE PARTIALLY EXCAVATED AND PERMANENT SUB-BASE / BASE STRUCTURE INSTALLED, IN ADDITION TO THE THROUGH LANES, WHILE MAINTAINING REQUIRED TRAFFIC (TO AVOID UNDERMINING OF PAVEMENT IN SUBSEQUENT STAGES).
 8. SAWCUT EXISTING PAVEMENT FULL DEPTH PRIOR TO REMOVAL TO ENSURE INTEGRITY OF REMAINING PAVEMENT LEFT OPEN TO TRAFFIC.
 9. PROPOSED SIDEWALKS TO BE CONSTRUCTED FOLLOWING CONSTRUCTION OF MAIN LANES.

POLO PARK
 INFRASTRUCTURE IMPROVEMENTS
 2014 STAGING - STAGE 3 & 4
 ST. JAMES STREET & ST. MATTHEWS AVENUE
 FIGURE S-02

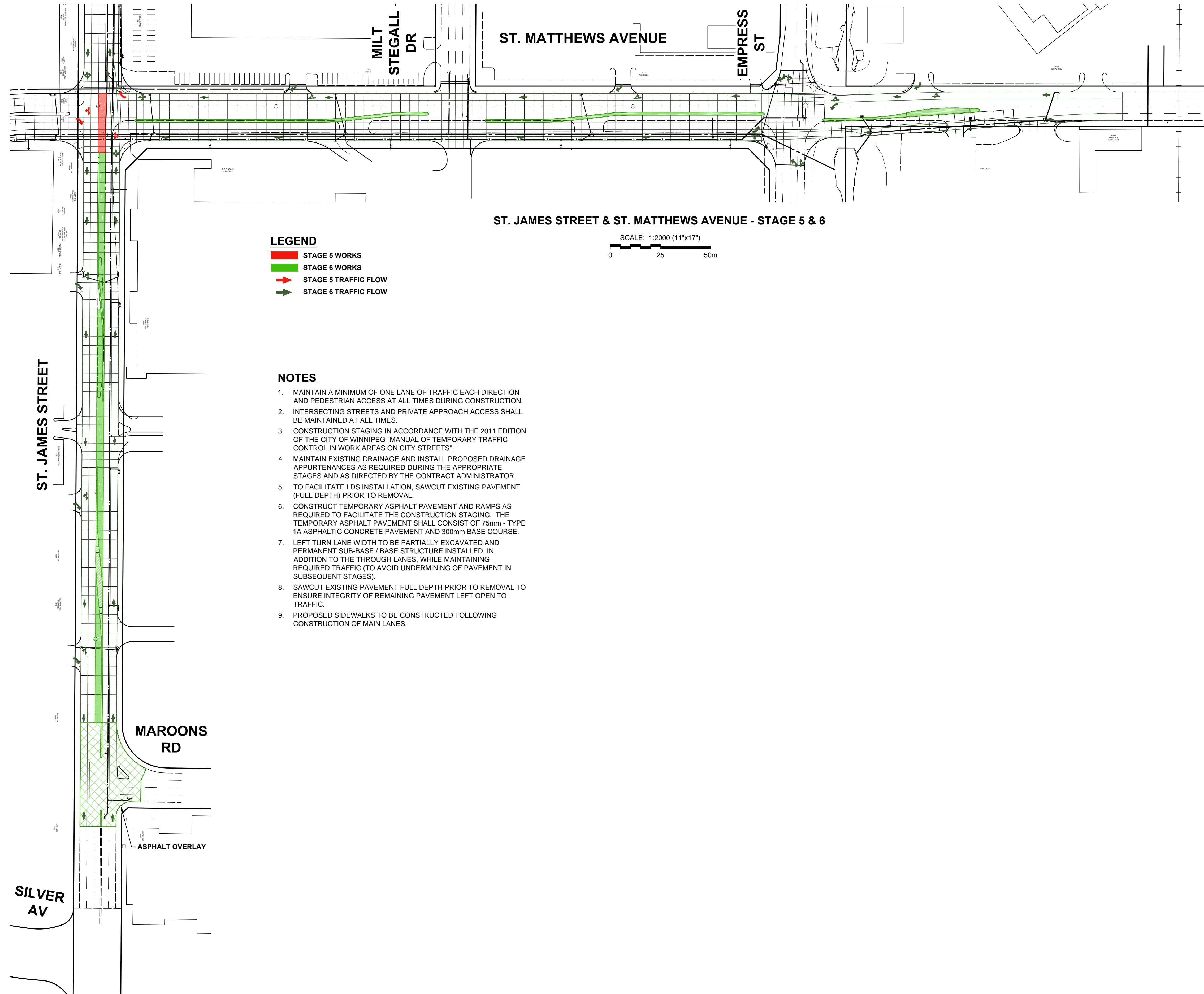
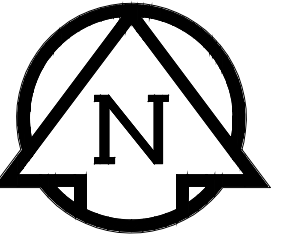

ST. JAMES STREET & ST. MATTHEWS AVENUE - STAGE 5 & 6

SCALE: 1:2000 (11"x17")
0 25 50m

- LEGEND**
- █ STAGE 5 WORKS
 - █ STAGE 6 WORKS
 - ➔ STAGE 5 TRAFFIC FLOW
 - ➔ STAGE 6 TRAFFIC FLOW

- NOTES**
1. MAINTAIN A MINIMUM OF ONE LANE OF TRAFFIC EACH DIRECTION AND PEDESTRIAN ACCESS AT ALL TIMES DURING CONSTRUCTION.
 2. INTERSECTING STREETS AND PRIVATE APPROACH ACCESS SHALL BE MAINTAINED AT ALL TIMES.
 3. CONSTRUCTION STAGING IN ACCORDANCE WITH THE 2011 EDITION OF THE CITY OF WINNIPEG "MANUAL OF TEMPORARY TRAFFIC CONTROL IN WORK AREAS ON CITY STREETS".
 4. MAINTAIN EXISTING DRAINAGE AND INSTALL PROPOSED DRAINAGE APPURTENANCES AS REQUIRED DURING THE APPROPRIATE STAGES AND AS DIRECTED BY THE CONTRACT ADMINISTRATOR.
 5. TO FACILITATE LDS INSTALLATION, SAWCUT EXISTING PAVEMENT (FULL DEPTH) PRIOR TO REMOVAL.
 6. CONSTRUCT TEMPORARY ASPHALT PAVEMENT AND RAMPS AS REQUIRED TO FACILITATE THE CONSTRUCTION STAGING. THE TEMPORARY ASPHALT PAVEMENT SHALL CONSIST OF 75mm - TYPE 1A ASPHALTIC CONCRETE PAVEMENT AND 300mm BASE COURSE.
 7. LEFT TURN LANE WIDTH TO BE PARTIALLY EXCAVATED AND PERMANENT SUB-BASE / BASE STRUCTURE INSTALLED, IN ADDITION TO THE THROUGH LANES, WHILE MAINTAINING REQUIRED TRAFFIC (TO AVOID UNDERMINING OF PAVEMENT IN SUBSEQUENT STAGES).
 8. SAWCUT EXISTING PAVEMENT FULL DEPTH PRIOR TO REMOVAL TO ENSURE INTEGRITY OF REMAINING PAVEMENT LEFT OPEN TO TRAFFIC.
 9. PROPOSED SIDEWALKS TO BE CONSTRUCTED FOLLOWING CONSTRUCTION OF MAIN LANES.

Mc:\Proj\W130014\CDP\Polo Park Infrastructure Improvements-Detailed Design\Figures\Staging\W130014 - 2014 and 2015 Staging.dwg Last Saved: 4/22/2014 8:27 AM by dilan Plotted: 4/22/2014 10:12 AM by Dave Lane

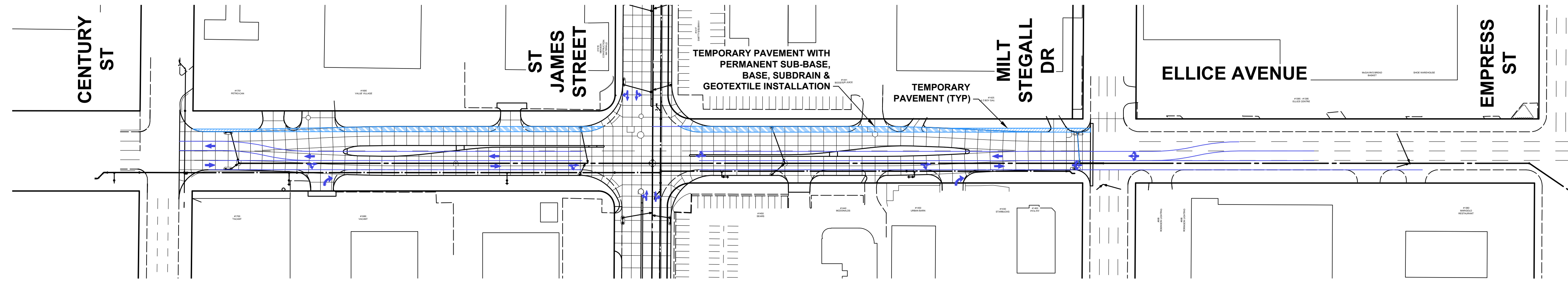
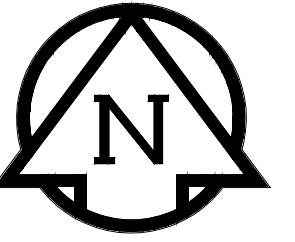

LEGEND
 ■ STAGE 1 WORKS
 → STAGE 1 TRAFFIC FLOW

ELLICE AVENUE - STAGE 1
 SCALE: 1:2000 (11"x17")
 0 25 50m

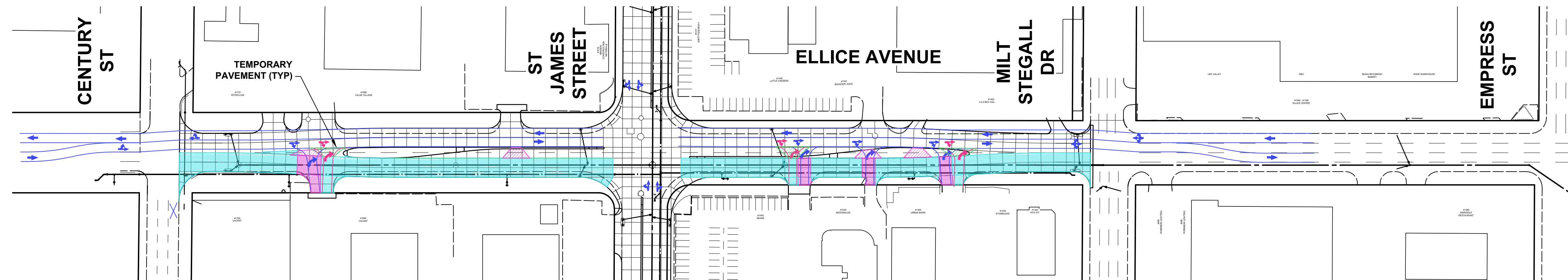

LEGEND
 ■ STAGE 2 WORKS
 ■ STAGE 3 WORKS
 → STAGE 2 TRAFFIC FLOW
 → STAGE 3 TRAFFIC FLOW

ELLICE AVENUE - STAGE 2 & 3
 SCALE: 1:2000 (11"x17")
 0 25 50m

NOTES

1. MAINTAIN A MINIMUM OF ONE LANE OF TRAFFIC EACH DIRECTION AND PEDESTRIAN ACCESS AT ALL TIMES DURING CONSTRUCTION.
2. INTERSECTING STREETS AND PRIVATE APPROACH ACCESS SHALL BE MAINTAINED AT ALL TIMES.
3. CONSTRUCTION STAGING IN ACCORDANCE WITH THE 2011 EDITION OF THE CITY OF WINNIPEG "MANUAL OF TEMPORARY TRAFFIC CONTROL IN WORK AREAS ON CITY STREETS".
4. MAINTAIN EXISTING DRAINAGE AND INSTALL PROPOSED DRAINAGE APPURTENANCES AS REQUIRED DURING THE APPROPRIATE STAGES AND AS DIRECTED BY THE CONTRACT ADMINISTRATOR.
5. TO FACILITATE LDS INSTALLATION, SAWCUT EXISTING PAVEMENT (FULL DEPTH) PRIOR TO REMOVAL.
6. CONSTRUCT TEMPORARY ASPHALT PAVEMENT AND RAMPS AS REQUIRED TO FACILITATE THE CONSTRUCTION STAGING. THE TEMPORARY ASPHALT PAVEMENT SHALL CONSIST OF 75mm - TYPE 1A ASPHALTIC CONCRETE PAVEMENT AND 300mm BASE COURSE.
7. LEFT TURN LANE WIDTH TO BE PARTIALLY EXCAVATED AND PERMANENT SUB-BASE / BASE STRUCTURE INSTALLED, IN ADDITION TO THE THROUGH LANES, WHILE MAINTAINING REQUIRED TRAFFIC (TO AVOID UNDERMINING OF PAVEMENT IN SUBSEQUENT STAGES).
8. SAWCUT EXISTING PAVEMENT FULL DEPTH PRIOR TO REMOVAL TO ENSURE INTEGRITY OF REMAINING PAVEMENT LEFT OPEN TO TRAFFIC.
9. PROPOSED SIDEWALKS TO BE CONSTRUCTED FOLLOWING CONSTRUCTION OF MAIN LANES.

POLO PARK
 INFRASTRUCTURE IMPROVEMENTS
 2014 STAGING - STAGE 1, 2 & 3
 ELLICE AVENUE
 FIGURE S-04

McProj\W130014\CDP\Polo Park Infrastructure Improvements-Detailed Design\Figures\Staging\W130014 - 2014 and 2015 Staging.dwg
 Last Saved: 4/22/2014 9:27 AM by Diane
 Plotted: 4/22/2014 10:12 AM by Dave Lane

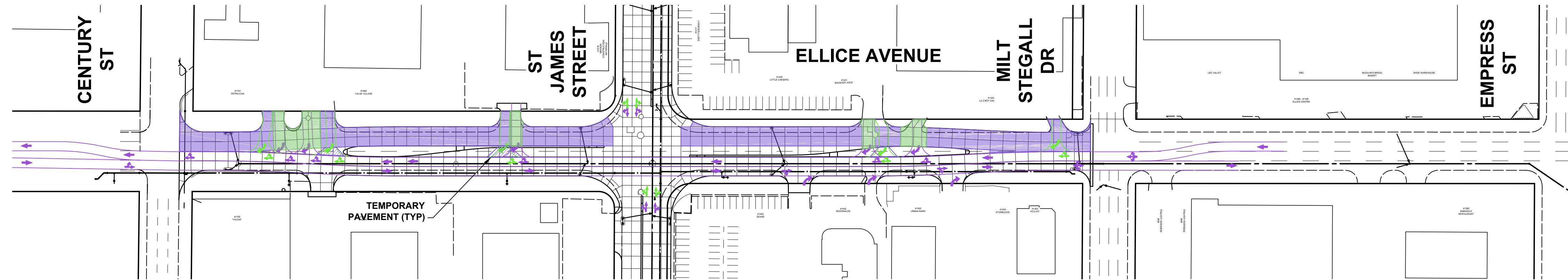
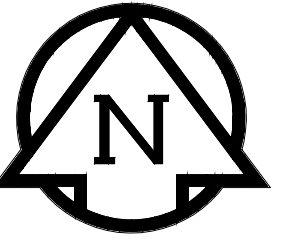

LEGEND

- STAGE 4 WORKS
- STAGE 5 WORKS
- STAGE 4 TRAFFIC FLOW
- STAGE 5 TRAFFIC FLOW

ELLICE AVENUE - STAGE 4 & 5

SCALE: 1:2000 (11"x17")
0 25 50m

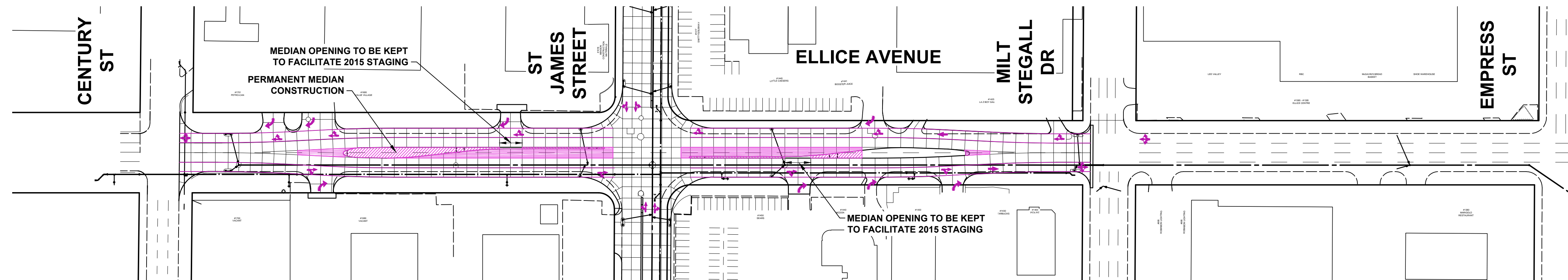

LEGEND

- STAGE 6 WORKS
- STAGE 6 TRAFFIC FLOW

ELLICE AVENUE - STAGE 6

SCALE: 1:2000 (11"x17")
0 25 50m

NOTES

1. MAINTAIN A MINIMUM OF ONE LANE OF TRAFFIC EACH DIRECTION AND PEDESTRIAN ACCESS AT ALL TIMES DURING CONSTRUCTION.
2. INTERSECTING STREETS AND PRIVATE APPROACH ACCESS SHALL BE MAINTAINED AT ALL TIMES.
3. CONSTRUCTION STAGING IN ACCORDANCE WITH THE 2011 EDITION OF THE CITY OF WINNIPEG "MANUAL OF TEMPORARY TRAFFIC CONTROL IN WORK AREAS ON CITY STREETS".
4. MAINTAIN EXISTING DRAINAGE AND INSTALL PROPOSED DRAINAGE APPURTENANCES AS REQUIRED DURING THE APPROPRIATE STAGES AND AS DIRECTED BY THE CONTRACT ADMINISTRATOR.
5. TO FACILITATE LDS INSTALLATION, SAWCUT EXISTING PAVEMENT (FULL DEPTH) PRIOR TO REMOVAL.
6. CONSTRUCT TEMPORARY ASPHALT PAVEMENT AND RAMPS AS REQUIRED TO FACILITATE THE CONSTRUCTION STAGING. THE TEMPORARY ASPHALT PAVEMENT SHALL CONSIST OF 75mm - TYPE 1A ASPHALTIC CONCRETE PAVEMENT AND 300mm BASE COURSE.
7. LEFT TURN LANE WIDTH TO BE PARTIALLY EXCAVATED AND PERMANENT SUB-BASE / BASE STRUCTURE INSTALLED, IN ADDITION TO THE THROUGH LANES, WHILE MAINTAINING REQUIRED TRAFFIC (TO AVOID UNDERMINING OF PAVEMENT IN SUBSEQUENT STAGES).
8. SAWCUT EXISTING PAVEMENT FULL DEPTH PRIOR TO REMOVAL TO ENSURE INTEGRITY OF REMAINING PAVEMENT LEFT OPEN TO TRAFFIC.
9. PROPOSED SIDEWALKS TO BE CONSTRUCTED FOLLOWING CONSTRUCTION OF MAIN LANES.

POLO PARK
 INFRASTRUCTURE IMPROVEMENTS
 2014 STAGING - STAGE 4, 5 & 6
 ELLICE AVENUE
 FIGURE S-05

TEMPORARY DETOUR TO BE BUILT
PRIOR TO STAGE 1 CONSTRUCTION

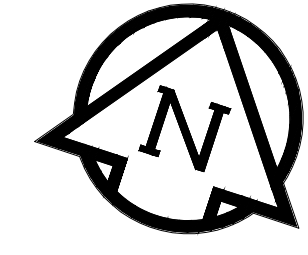
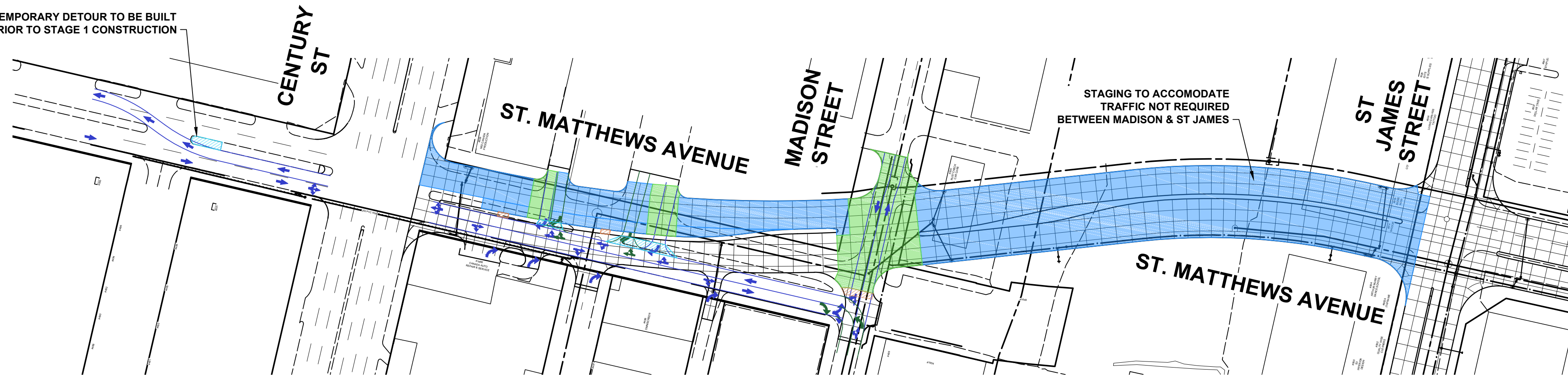

- LEGEND**
- █ STAGE 1 WORKS
 - █ STAGE 2 WORKS
 - ➔ STAGE 1 TRAFFIC FLOW
 - ➔ STAGE 2 TRAFFIC FLOW

ST. MATTHEWS AVENUE - STAGE 1 & 2

SCALE: 1:2000 (11"x17")
0 25 50m

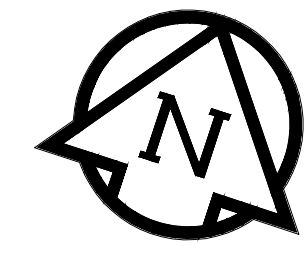
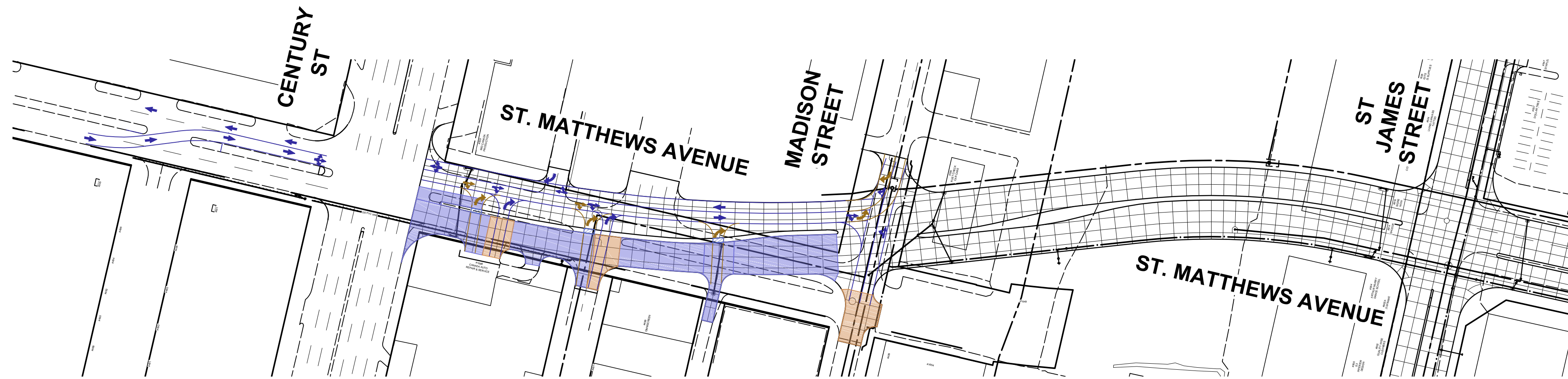

- LEGEND**
- █ STAGE 3 WORKS
 - █ STAGE 4 WORKS
 - ➔ STAGE 3 TRAFFIC FLOW
 - ➔ STAGE 4 TRAFFIC FLOW

ST. MATTHEWS AVENUE - STAGE 3 & 4

SCALE: 1:2000 (11"x17")
0 25 50m

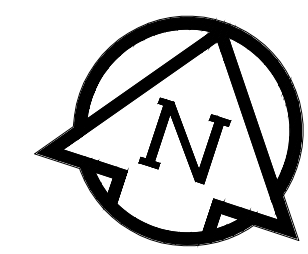
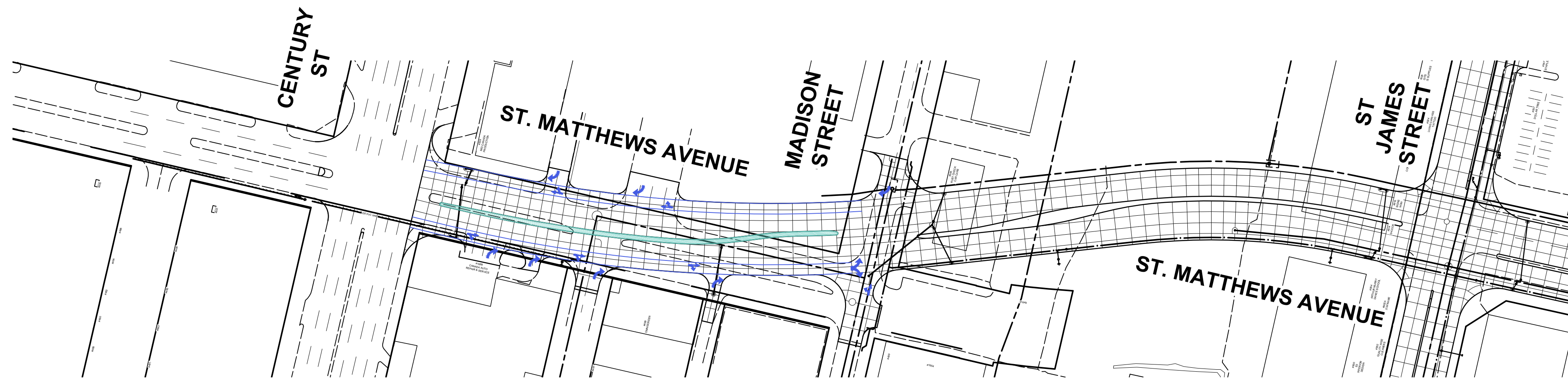

- LEGEND**
- █ STAGE 5 WORKS
 - ➔ STAGE 5 TRAFFIC FLOW

ST. MATTHEWS AVENUE - STAGE 5

SCALE: 1:2000 (11"x17")
0 25 50m

NOTES

1. MAINTAIN A MINIMUM OF ONE LANE OF TRAFFIC EACH DIRECTION AND PEDESTRIAN ACCESS AT ALL TIMES DURING CONSTRUCTION.
2. INTERSECTING STREETS AND PRIVATE APPROACH ACCESS SHALL BE MAINTAINED AT ALL TIMES.
3. CONSTRUCTION STAGING IN ACCORDANCE WITH THE 2011 EDITION OF THE CITY OF WINNIPEG "MANUAL OF TEMPORARY TRAFFIC CONTROL IN WORK AREAS ON CITY STREETS".
4. MAINTAIN EXISTING DRAINAGE AND INSTALL PROPOSED DRAINAGE APPURTENANCES AS REQUIRED DURING THE APPROPRIATE STAGES AND AS DIRECTED BY THE CONTRACT ADMINISTRATOR.
5. TO FACILITATE LDS INSTALLATION, SAWCUT EXISTING PAVEMENT (FULL DEPTH) PRIOR TO REMOVAL.
6. CONSTRUCT TEMPORARY ASPHALT PAVEMENT AND RAMPS AS REQUIRED TO FACILITATE THE CONSTRUCTION STAGING. THE TEMPORARY ASPHALT PAVEMENT SHALL CONSIST OF 75mm - TYPE 1A ASPHALTIC CONCRETE PAVEMENT AND 300mm BASE COURSE.
7. LEFT TURN LANE WIDTH TO BE PARTIALLY EXCAVATED AND PERMANENT SUB-BASE / BASE STRUCTURE INSTALLED, IN ADDITION TO THE THROUGH LANES, WHILE MAINTAINING REQUIRED TRAFFIC (TO AVOID UNDERMINING OF PAVEMENT IN SUBSEQUENT STAGES).
8. SAWCUT EXISTING PAVEMENT FULL DEPTH PRIOR TO REMOVAL TO ENSURE INTEGRITY OF REMAINING PAVEMENT LEFT OPEN TO TRAFFIC.
9. PROPOSED SIDEWALKS TO BE CONSTRUCTED FOLLOWING CONSTRUCTION OF MAIN LANES.

POLO PARK
INFRASTRUCTURE IMPROVEMENTS
2015 STAGING - STAGE 1, 2, 3, 4 & 5
ST. MATTHEWS AVENUE

FIGURE S-06

M:\Proj\13014\CD\POLO Park Infrastructure Improvements-Detailed Design\Figures\Staging\13014 - 2014 and 2015 Staging.dwg
Last Saved: 4/22/2014 9:27 AM by dilan
Plotted: 4/22/2014 10:14 AM by Dave Lane

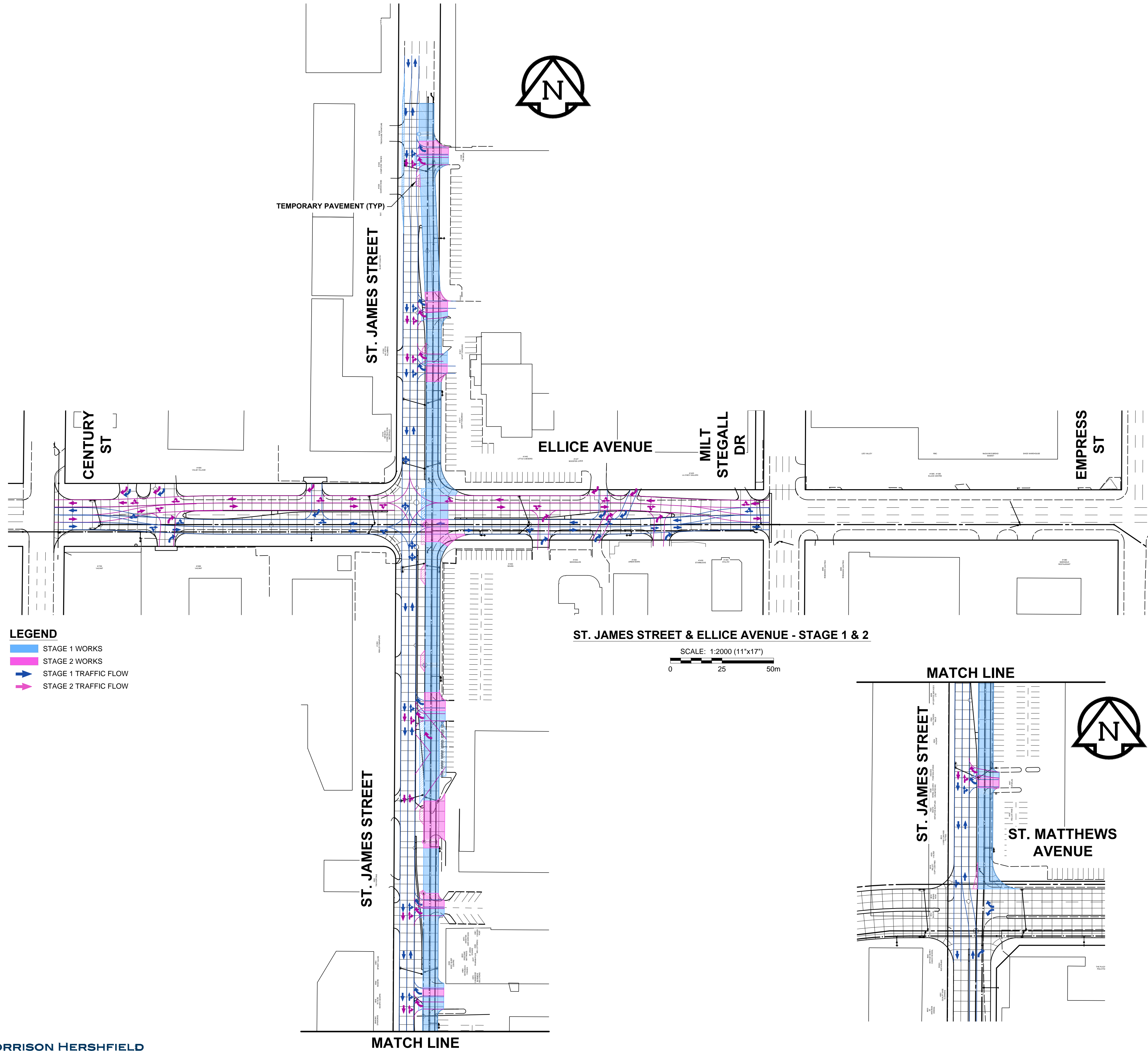

NOTES

1. MAINTAIN A MINIMUM OF ONE LANE OF TRAFFIC EACH DIRECTION AND PEDESTRIAN ACCESS AT ALL TIMES DURING CONSTRUCTION.
2. INTERSECTING STREETS AND PRIVATE APPROACH ACCESS SHALL BE MAINTAINED AT ALL TIMES.
3. CONSTRUCTION STAGING IN ACCORDANCE WITH THE 2011 EDITION OF THE CITY OF WINNIPEG "MANUAL OF TEMPORARY TRAFFIC CONTROL IN WORK AREAS ON CITY STREETS".
4. MAINTAIN EXISTING DRAINAGE AND INSTALL PROPOSED DRAINAGE APPURTENANCES AS REQUIRED DURING THE APPROPRIATE STAGES AND AS DIRECTED BY THE CONTRACT ADMINISTRATOR.
5. TO FACILITATE LDS INSTALLATION, SAWCUT EXISTING PAVEMENT (FULL DEPTH) PRIOR TO REMOVAL.
6. CONSTRUCT TEMPORARY ASPHALT PAVEMENT AND RAMPS AS REQUIRED TO FACILITATE THE CONSTRUCTION STAGING. THE TEMPORARY ASPHALT PAVEMENT SHALL CONSIST OF 75mm - TYPE 1A ASPHALTIC CONCRETE PAVEMENT AND 300mm BASE COURSE.
7. LEFT TURN LANE WIDTH TO BE PARTIALLY EXCAVATED AND PERMANENT SUB-BASE / BASE STRUCTURE INSTALLED, IN ADDITION TO THE THROUGH LANES, WHILE MAINTAINING REQUIRED TRAFFIC (TO AVOID UNDERMINING OF PAVEMENT IN SUBSEQUENT STAGES).
8. SAWCUT EXISTING PAVEMENT FULL DEPTH PRIOR TO REMOVAL TO ENSURE INTEGRITY OF REMAINING PAVEMENT LEFT OPEN TO TRAFFIC.
9. PROPOSED SIDEWALKS TO BE CONSTRUCTED FOLLOWING CONSTRUCTION OF MAIN LANES.

M:\Proj\W13014\CDP\POLO Park Infrastructure Improvements-Detailed Design\Figures\Staging\W13014 - 2014 and 2015 Staging.dwg
 Last Saved: 4/22/2014 8:27 AM by dilane Plotted: 4/22/2014 10:14 AM by Dave Lane

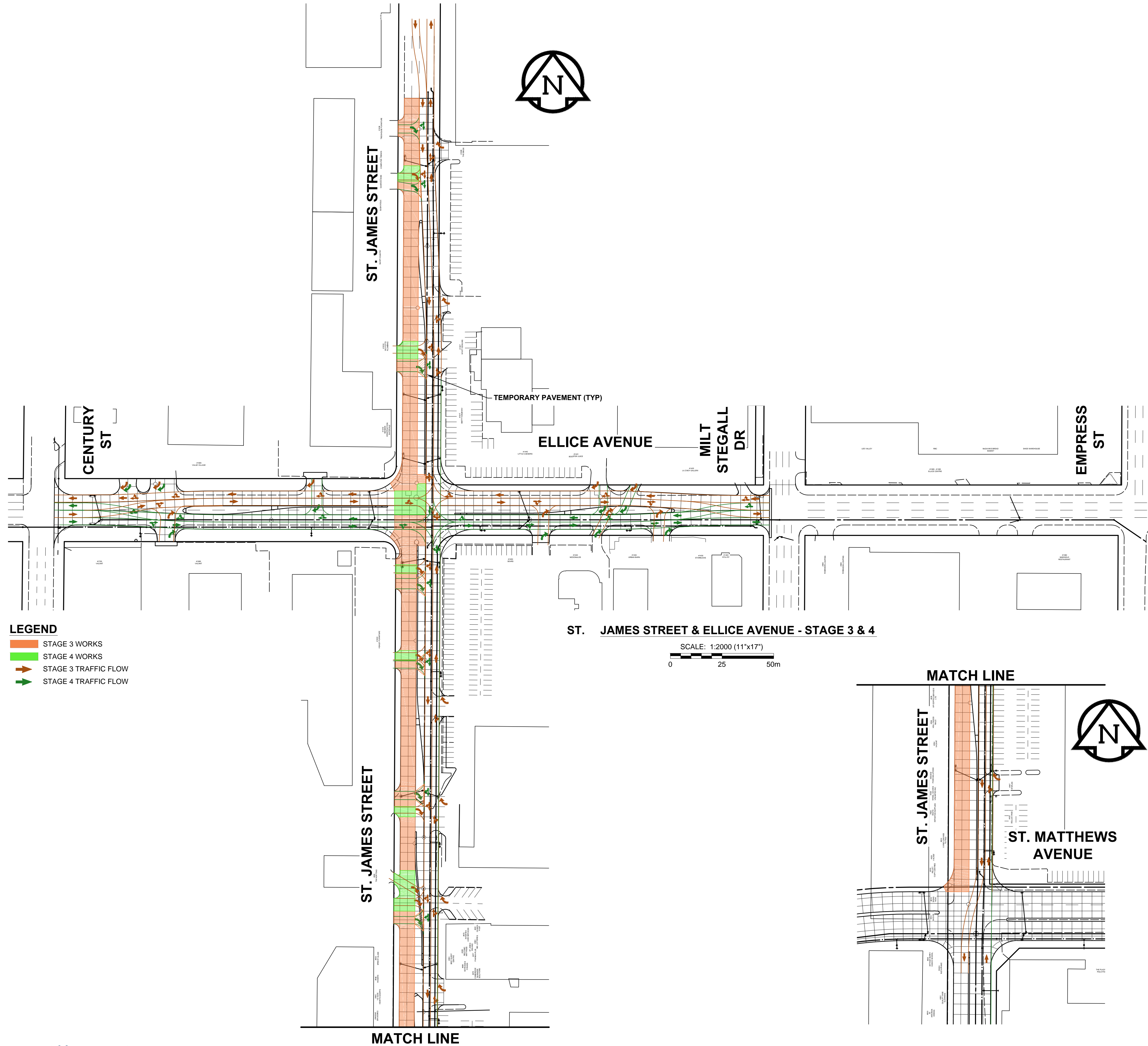

LEGEND

- STAGE 3 WORKS
- STAGE 4 WORKS
- STAGE 3 TRAFFIC FLOW
- STAGE 4 TRAFFIC FLOW

NOTES

1. MAINTAIN A MINIMUM OF ONE LANE OF TRAFFIC EACH DIRECTION AND PEDESTRIAN ACCESS AT ALL TIMES DURING CONSTRUCTION.
2. INTERSECTING STREETS AND PRIVATE APPROACH ACCESS SHALL BE MAINTAINED AT ALL TIMES.
3. CONSTRUCTION STAGING IN ACCORDANCE WITH THE 2011 EDITION OF THE CITY OF WINNIPEG "MANUAL OF TEMPORARY TRAFFIC CONTROL IN WORK AREAS ON CITY STREETS".
4. MAINTAIN EXISTING DRAINAGE AND INSTALL PROPOSED DRAINAGE APPURTENANCES AS REQUIRED DURING THE APPROPRIATE STAGES AND AS DIRECTED BY THE CONTRACT ADMINISTRATOR.
5. TO FACILITATE LDS INSTALLATION, SAWCUT EXISTING PAVEMENT (FULL DEPTH) PRIOR TO REMOVAL.
6. CONSTRUCT TEMPORARY ASPHALT PAVEMENT AND RAMPS AS REQUIRED TO FACILITATE THE CONSTRUCTION STAGING. THE TEMPORARY ASPHALT PAVEMENT SHALL CONSIST OF 75mm - TYPE 1A ASPHALTIC CONCRETE PAVEMENT AND 300mm BASE COURSE.
7. LEFT TURN LANE WIDTH TO BE PARTIALLY EXCAVATED AND PERMANENT SUB-BASE / BASE STRUCTURE INSTALLED, IN ADDITION TO THE THROUGH LANES, WHILE MAINTAINING REQUIRED TRAFFIC (TO AVOID UNDERMINING OF PAVEMENT IN SUBSEQUENT STAGES).
8. SAWCUT EXISTING PAVEMENT FULL DEPTH PRIOR TO REMOVAL TO ENSURE INTEGRITY OF REMAINING PAVEMENT LEFT OPEN TO TRAFFIC.
9. PROPOSED SIDEWALKS TO BE CONSTRUCTED FOLLOWING CONSTRUCTION OF MAIN LANES.

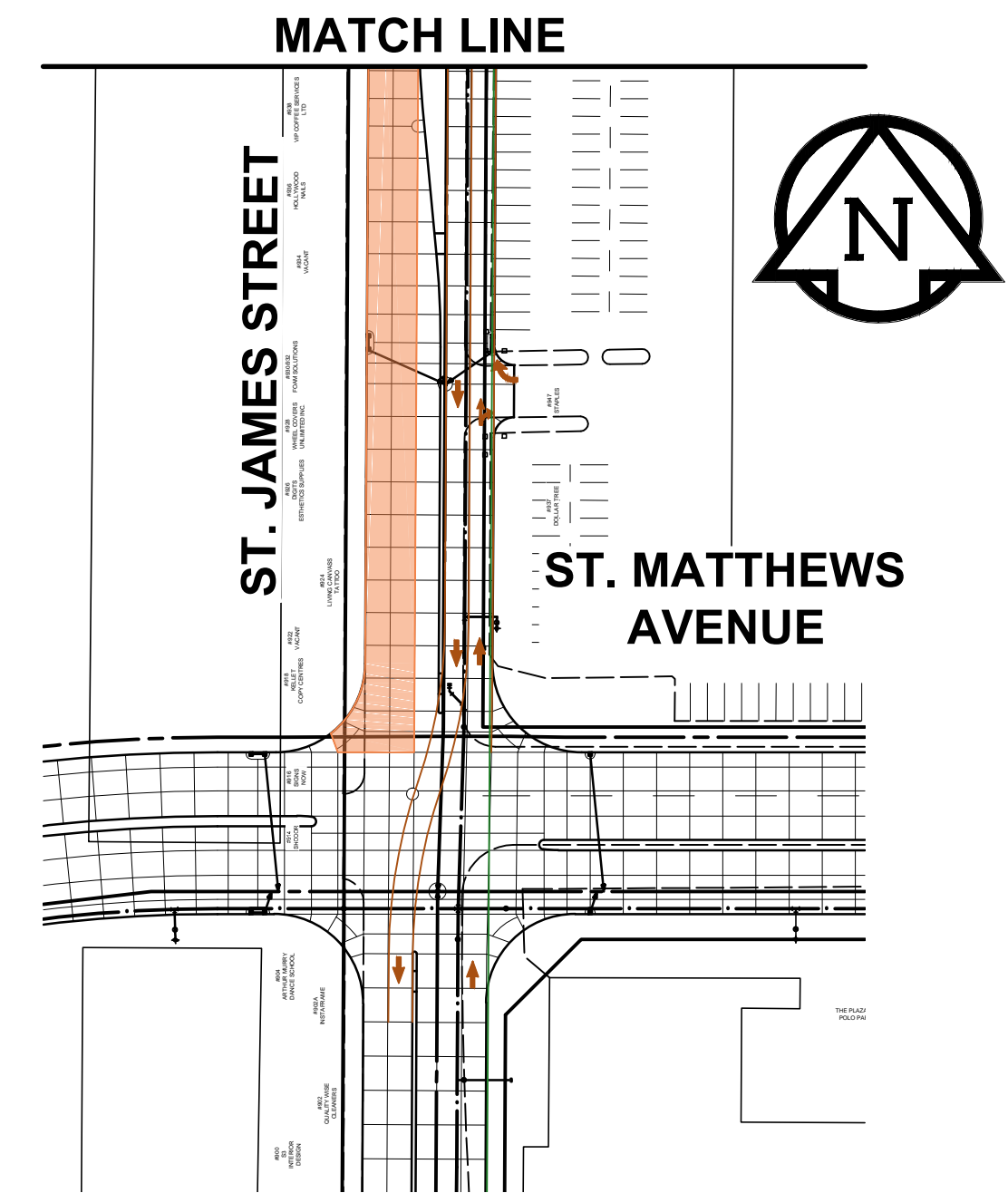

POLO PARK
 INFRASTRUCTURE IMPROVEMENTS
 2015 STAGING - STAGE 3 & 4
 ST. JAMES STREET & ELLICE AVENUE
 FIGURE S-08

M:\Proj\13014\CDP\13014\CDP\Infrastructure Improvements-Detailed Design\Figures\Staging\13014 - 2014 and 2015 Staging.dwg Last Saved: 4/22/2014 8:27 AM by dilane Plotted: 4/22/2014 10:14 AM by Dave Lane

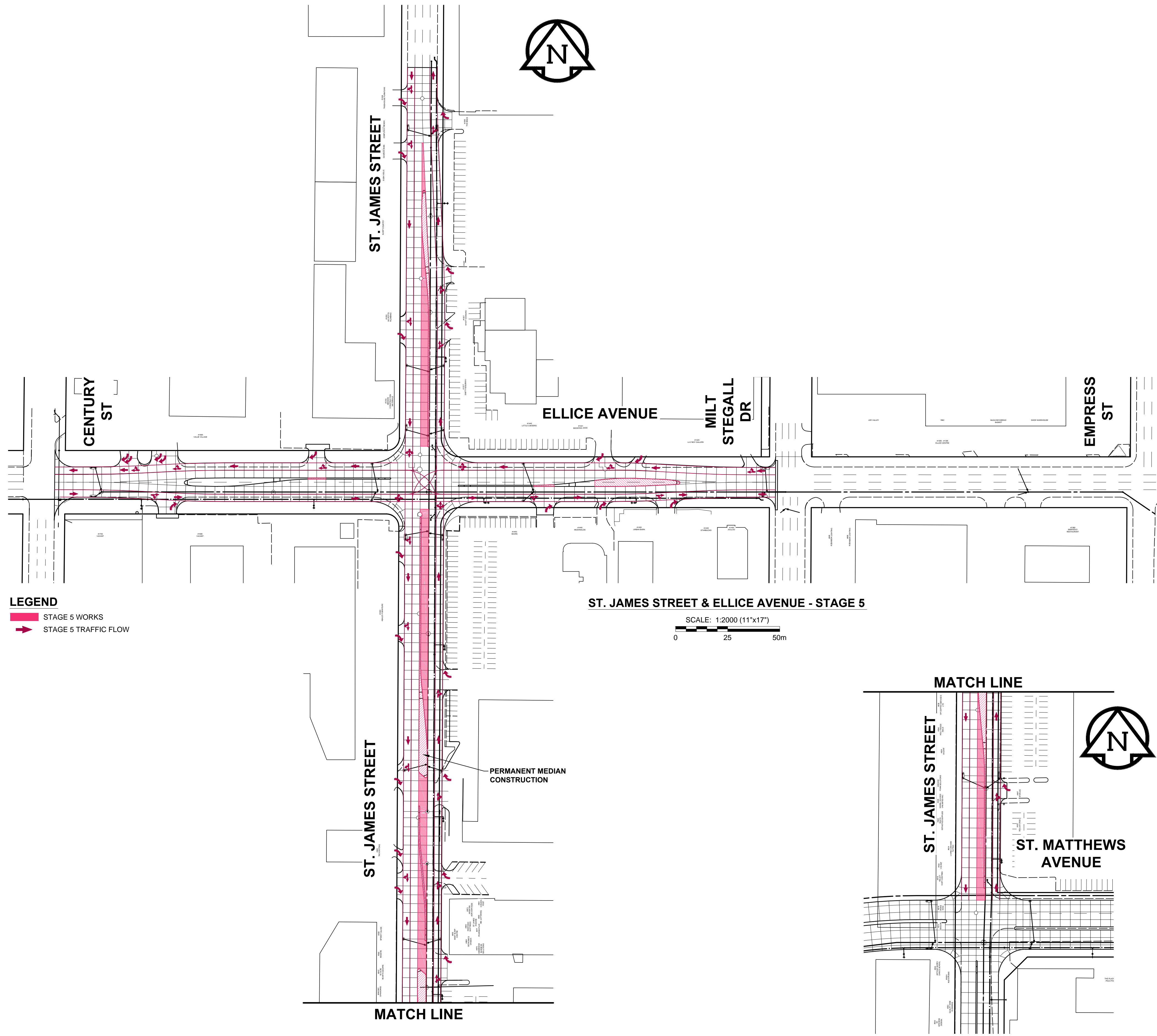

LEGEND
 ■ STAGE 5 WORKS
 → STAGE 5 TRAFFIC FLOW

ST. JAMES STREET & ELLICE AVENUE - STAGE 5

SCALE: 1:2000 (11'x17')
 0 25 50m

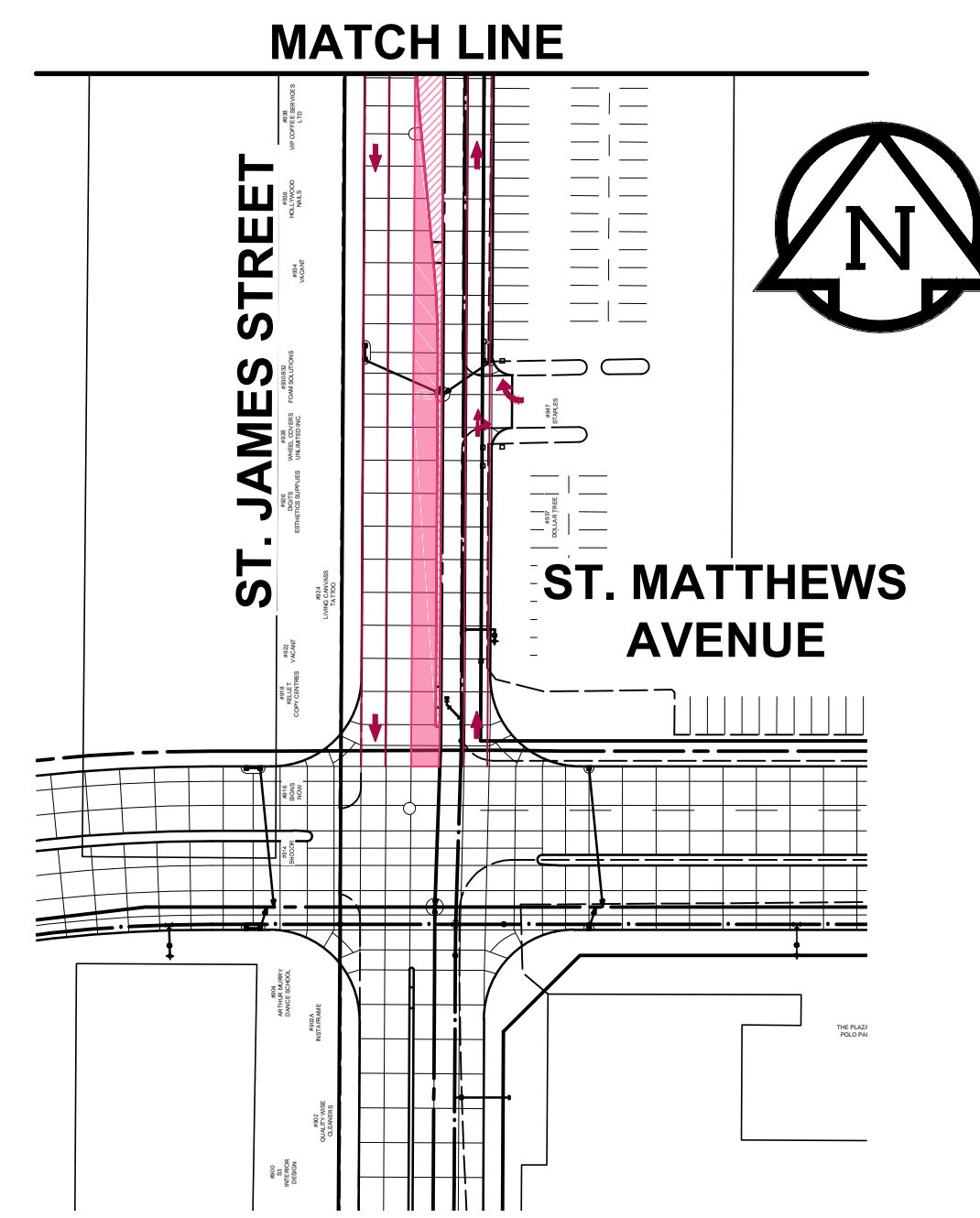

NOTES

1. MAINTAIN A MINIMUM OF ONE LANE OF TRAFFIC EACH DIRECTION AND PEDESTRIAN ACCESS AT ALL TIMES DURING CONSTRUCTION.
2. INTERSECTING STREETS AND PRIVATE APPROACH ACCESS SHALL BE MAINTAINED AT ALL TIMES.
3. CONSTRUCTION STAGING IN ACCORDANCE WITH THE 2011 EDITION OF THE CITY OF WINNIPEG "MANUAL OF TEMPORARY TRAFFIC CONTROL IN WORK AREAS ON CITY STREETS".
4. MAINTAIN EXISTING DRAINAGE AND INSTALL PROPOSED DRAINAGE APPURTENANCES AS REQUIRED DURING THE APPROPRIATE STAGES AND AS DIRECTED BY THE CONTRACT ADMINISTRATOR.
5. TO FACILITATE LDS INSTALLATION, SAWCUT EXISTING PAVEMENT (FULL DEPTH) PRIOR TO REMOVAL.
6. CONSTRUCT TEMPORARY ASPHALT PAVEMENT AND RAMPS AS REQUIRED TO FACILITATE THE CONSTRUCTION STAGING. THE TEMPORARY ASPHALT PAVEMENT SHALL CONSIST OF 75mm - TYPE 1A ASPHALTIC CONCRETE PAVEMENT AND 300mm BASE COURSE.
7. LEFT TURN LANE WIDTH TO BE PARTIALLY EXCAVATED AND PERMANENT SUB-BASE / BASE STRUCTURE INSTALLED, IN ADDITION TO THE THROUGH LANES, WHILE MAINTAINING REQUIRED TRAFFIC (TO AVOID UNDERMINING OF PAVEMENT IN SUBSEQUENT STAGES).
8. SAWCUT EXISTING PAVEMENT FULL DEPTH PRIOR TO REMOVAL TO ENSURE INTEGRITY OF REMAINING PAVEMENT LEFT OPEN TO TRAFFIC.
9. PROPOSED SIDEWALKS TO BE CONSTRUCTED FOLLOWING CONSTRUCTION OF MAIN LANES.

POLO PARK
 INFRASTRUCTURE IMPROVEMENTS
 2015 STAGING - STAGE 5
 ST. JAMES STREET & ELLICE AVENUE
 FIGURE S-09