



# THE CITY OF WINNIPEG

PUBLIC WORKS DEPARTMENT  
ENGINEERING DIVISION

## PORTAGE AVENUE REHABILITATION

PART A- EASTBOUND FROM SHERBURN STREET TO MARYLAND STREET.

PART B- WESTBOUND FROM EMPRESS STREET TO MINTO STREET

BID OPPORTUNITY NO. 1109-2014

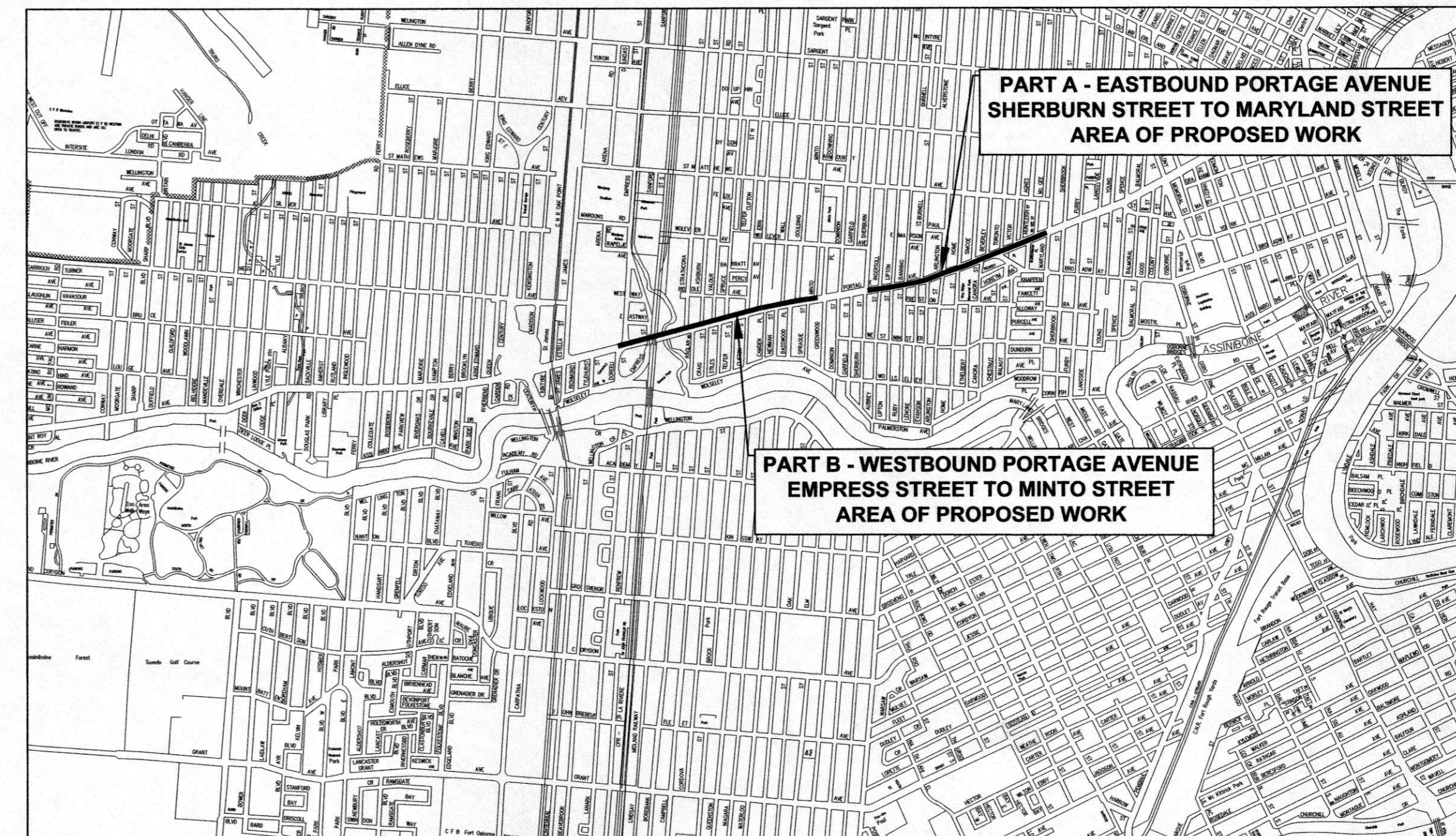

LOCATION PLAN

DRAWING INDEX

TITLE

PART A-EASTBOUND PORTAGE AVENUE  
SHERBURN STREET TO MARYLAND STREET

CITY OF WINNIPEG  
DRAWING No.

AECOM  
DRAWING No.

COVER SHEET	P-3359-01	CT01
CONSTRUCTION STAGING PLAN (PART A)	P-3359-02	CT02
PLAN/PROFILE PART A STATION 1+639 TO STATION 1+730	P-3359-03	CT03
PLAN/PROFILE PART A STATION 1+730 TO STATION 1+870	P-3359-04	CT04
PLAN/PROFILE PART A STATION 1+870 TO STATION 1+990	P-3359-05	CT05
PLAN/PROFILE PART A STATION 1+990 TO STATION 2+130	P-3359-06	CT06
PLAN/PROFILE PART A STATION 2+130 TO STATION 2+270	P-3359-07	CT07
PLAN/PROFILE PART A STATION 2+270 TO STATION 2+410	P-3359-08	CT08
PLAN/PROFILE PART A STATION 2+410 TO STATION 2+550	P-3359-09	CT09
PLAN/PROFILE PART A STATION 2+550 TO STATION 2+690	P-3359-10	CT10
PLAN/PROFILE PART A STATION 2+690 TO STATION 2+784	P-3359-11	CT11

DRAWING INDEX

TITLE

PART B-WESTBOUND PORTAGE AVENUE  
EMPRESS STREET TO MINTO STREET

CITY OF WINNIPEG  
DRAWING No.

AECOM  
DRAWING No.

CONSTRUCTION STAGING PLAN (PART B)	P-3356-01	CT12
PLAN/PROFILE PART B STATION 0+110 TO STATION 0+220	P-3356-02	CT13
PLAN/PROFILE PART B STATION 0+220 TO STATION 0+360	P-3356-03	CT14
PLAN/PROFILE PART B STATION 0+360 TO STATION 0+500	P-3356-04	CT15
PLAN/PROFILE PART B STATION 0+500 TO STATION 0+630	P-3356-05	CT16
PLAN/PROFILE PART B STATION 0+630 TO STATION 0+770	P-3356-06	CT17
PLAN/PROFILE PART B STATION 0+770 TO STATION 0+910	P-3356-07	CT18
PLAN/PROFILE PART B STATION 0+910 TO STATION 1+050	P-3356-08	CT19
PLAN/PROFILE PART B STATION 1+050 TO STATION 1+170	P-3356-09	CT20
PLAN/PROFILE PART B STATION 1+170 TO STATION 1+304	P-3356-10	CT21



RELEASED FOR CONSTRUCTION BY :

*[Signature]* *Nov 26/14*  
DATE

B. KELLET  
STREETS PROJECT COORDINATOR

ISSUED FOR TENDER

SET NO. \_\_\_\_\_

AECOM PROJECT No. 60318473