

CHAINAGE ALONG S PL

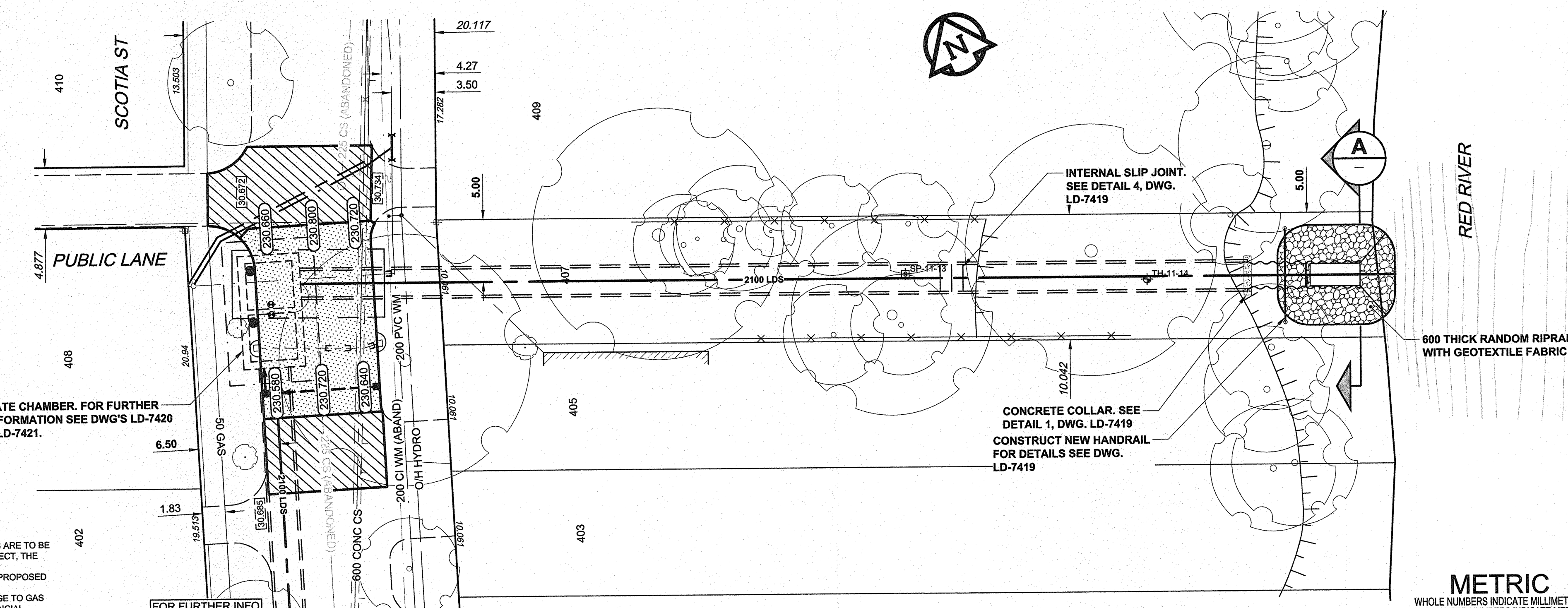

- CONSTRUCTION NOTES:**
- FOR DETAILED TEST HOLE INFORMATION, SEE SPECIFICATION.
  - LOCATION OF SERVICES SHOWN ON DRAWINGS ARE APPROXIMATE.
  - CONFIRM LOCATION OF ALL WATER & WASTEWATER SERVICES IN THE FIELD.
  - INSTALL NEW SEWERS AND CATCHBASIN LEADS BY TRENCHLESS METHODS.
  - CLASS 'A' CONCRETE PIPE BEDDING SHALL BE USED IN ALL SHAFTS (SD-001).
  - ALL SHAFTS SHALL BE BACKFILLED WITH CLASS 2 BACKFILL.
  - TYPE 3 INITIAL BACKFILL MATERIAL SHALL BE USED IN PLACE OF SAND IN ALL SHAFTS.



**WARNING**  
IF POWER EQUIPMENT OR EXPLOSIVES ARE TO BE USED FOR EXCAVATION ON THIS PROJECT, THE CONTRACTOR MUST:  
1) NOTIFY THE GAS COMPANY OF THE PROPOSED LOCATION OF EXCAVATION.  
2) TAKE PRECAUTION TO AVOID DAMAGE TO GAS COMPANY INSTALLATIONS. SEE PROVINCIAL REGULATION 149/92 FOR DETAILS.

FOR FURTHER INFO SEE DWG LD-7417

**APECM**  
Certificate of Authorization  
AECOM Canada Ltd.  
No. 4671 Date: 13 Nov 2014

**METRIC**  
WHOLE NUMBERS INDICATE MILLIMETRES  
DECIMALIZED NUMBERS INDICATE METRES

EXISTING	LEGEND - PLAN	NEW	EXISTING	LEGEND - PLAN	NEW	EXISTING	LEGEND - PROFILE	NEW
150 WM	WATERMAIN	150 WM	CURB STOP	150 WM	WATERMAIN	150 WM	WATERMAIN	150 WM
300 LDS	LAND DRAINAGE SEWER	300 LDS	REDUCER	300 LDS	HYDRANT	300 LDS	HYDRANT	300 LDS
250 WWS	WASTE WATER SEWER	250 WWS	COUPLING	250 WWS	VALVE	250 WWS	VALVE	250 WWS
	MANHOLE		ANODE		LAND DRAINAGE SEWER		LAND DRAINAGE SEWER	
	CATCH BASIN		HYDRO		WASTE WATER SEWER		WASTE WATER SEWER	
	CURB INLET		MTS		PAVEMENT CROWN		PAVEMENT CROWN	
	CULVERT		GAS		N/W PROPERTY LINE		N/W PROPERTY LINE	
	PIPE ABANDONMENTS		TESTHOLE		S/E PROPERTY LINE		S/E PROPERTY LINE	
	SURVEY BAR		LAMP STANDARD		N/W GUTTER		N/W GUTTER	
			TREE		S/E GUTTER		S/E GUTTER	

**LOCATION APPROVED**  
UNDERGROUND STRUCTURES  
SUPR. U/G STRUCTURES DATE COMMITTEE  
**NOTE:**  
LOCATION OF UNDERGROUND STRUCTURES AS SHOWN ARE BASED ON THE BEST INFORMATION AVAILABLE. BUT NO GUARANTEE IS GIVEN THAT ALL EXISTING UTILITIES ARE SHOWN OR THAT THE GIVEN LOCATIONS ARE EXACT. CONFIRMATION OF EXISTENCE AND EXACT LOCATION OF ALL SERVICES MUST BE OBTAINED FROM THE INDIVIDUAL UTILITIES BEFORE PROCEEDING WITH CONSTRUCTION.

NO.	REVISIONS	DATE	BY
0	ISSUED FOR TENDER	14/11/12	WJd

<b>AECOM</b>	
DESIGNED BY	ADB
CHECKED BY	JAT
DRAWN BY	ADL
APPROVED BY	CCW
HOR. SCALE	1:250
VERT. SCALE	1:50
RELEASSED FOR CONSTRUCTION	
DATE	

PROFESSIONAL'S SEAL  
PROVINCE OF MANITOBA  
Member  
23484  
CONSULTANT DRAWING NO.  
60219315-SHT-00-CON4-C-1002

**THE CITY OF WINNIPEG**  
Winnipeg  
**WATER AND WASTE DEPARTMENT**

**JEFFERSON EAST**  
**COMBINED SEWER RELIEF**  
**CONTRACT 4 - SEMPLE OUTFALL**  
NEW OUTFALL AT 407 SCOTIA STREET  
SCOTIA STREET TO  
RED RIVER

SHEET 02 OF 07  
CITY DRAWING NUMBER  
**LD-7418**  
REV 0

BID OPPORTUNITY NO. 1062-2014