

CONSTRUCTION NOTES

- 1) CURB REPLACEMENT AS DIRECTED BY THE CONTRACT ADMINISTRATOR.
- 2) ALL STREET RADIUS CURB UNDER 15M RADIUS SHALL BE REPLACED AS MODIFIED OR AS DIRECTED BY THE CONTRACT ADMINISTRATOR.
- 3) PAVEMENT REPAIRS SHOWN ARE ONLY A REPRESENTATIVE SAMPLE OF THE TENDERED QUANTITIES.
- 4) ASPHALT TIE-INS ON APPROACHES TO BE DETERMINED IN THE FIELD BY THE CONTRACT ADMINISTRATOR.
- 5) ALL BULLNOSES TO HAVE SLOPED FACE.

WARNING

IF POWER EQUIPMENT OR EXPLOSIVES ARE TO BE USED FOR EXCAVATION ON THIS PROJECT THE CONTRACTOR MUST:

- 1) OBTAIN CLEARANCE FROM THE GAS UTILITY PRIOR TO EXCAVATION.
- 2) TAKE PRECAUTION TO AVOID DAMAGE TO GAS UTILITY INSTALLATIONS.

SEE PROVINCIAL REGULATION 210/72 FOR DETAILS

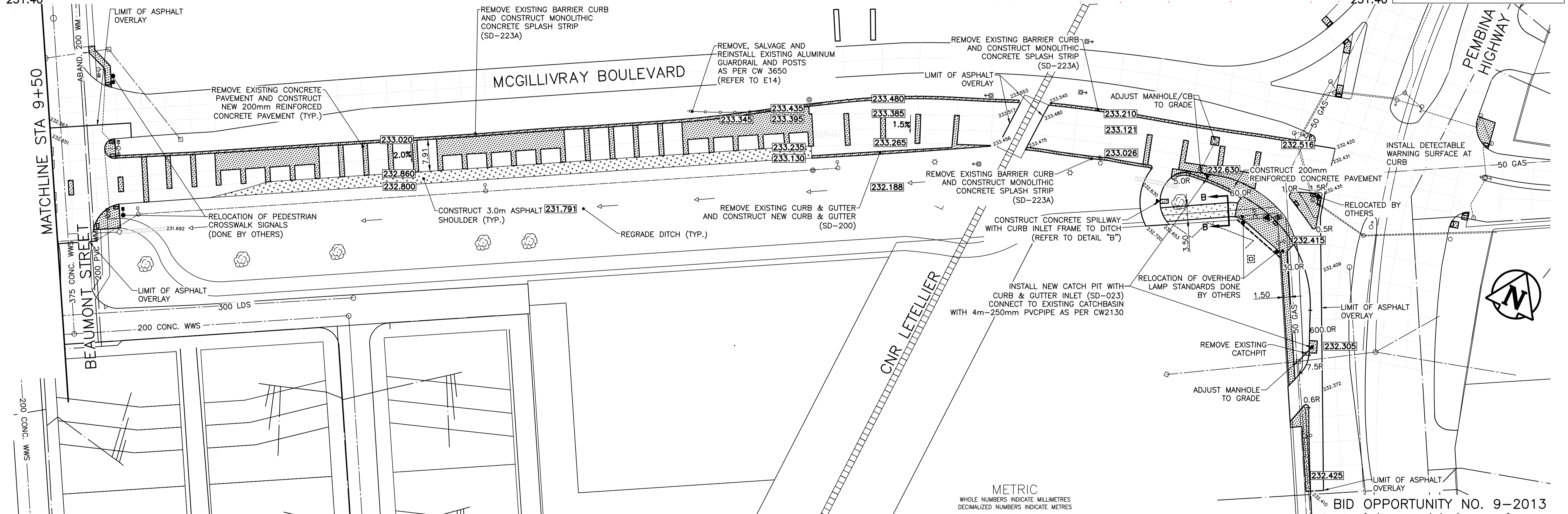

METRIC
WHOLE NUMBERS INDICATE MILLIMETRES
DECIMALIZED NUMBERS INDICATE METRES

BID OPPORTUNITY NO. 9-2013

◇	HYDRANT	◆	LDS/WWS	▨	PAVED SHOULDER (TYP.)	▩	LOCATION APPROVED
⊕	RAILWAY WARNING SIGNALS	●	WATERMAIN	▩	CULVERT	▩	UNDERGROUND STRUCTURES
⊙	PEDESTRIAN X-WALK	●	GAS	▩	GEODETIC BENCH MARK	▩	
⊕	SURVEY BAR	●	HYDRO	▩	TACTILE WARNING DEVICE	▩	
○	O.L.S.	●	TRAFFIC SIGNALS	▩	DITCH FLOW	▩	
○	MANHOLE	●	MTS	▩	EXISTING	▩	
□	CATCH BASIN	●	CURB RENEWAL	▩	LEGEND - PLAN	▩	
△	CURB & GUTTER INLET	▴	ELEVATIONS	231.000	TURN LANES	▩	
☆	HYDRO POLE	▴	PROPERTY LINE		NORTH GUTTER	▩	
→	TRAFFIC SIGNAL POLE	▴	ASPHALT		SOUTH GUTTER	▩	
⊙	OVERHEAD SIGN	▴	CONCRETE		DITCH (SOUTH)	▩	
EXISTING	LEGEND - PLAN	PROPOSED	EXISTING	LEGEND - PLAN	PROPOSED	EXISTING	LEGEND - PROFILE

LOCATION APPROVED UNDERGROUND STRUCTURES

DATE

NOTE:
LOCATION OF UNDERGROUND STRUCTURES AS SHOWN ARE BASED ON THE BEST INFORMATION AVAILABLE. BUT NO GUARANTEE IS GIVEN THAT THE GIVEN LOCATIONS ARE EXACT. CONFIRMATION OF EXISTENCE AND EXACT LOCATION OF ALL SERVICES MUST BE OBTAINED FROM THE INDIVIDUAL UTILITIES BEFORE PROCEEDING WITH CONSTRUCTION.

B.M. ELEV.	GBM 65-033	232.100
NO.	REVISIONS	DATE
1.	SUBMIT FOR ENGINEER'S APPROVAL	01/04/13 S.M.
0.	SUBMIT FOR PLAN APPROVAL	12/21/12 S.M.

ENGINEERING DIVISION
TECHNOLOGY SERVICES BRANCH
106 - 1155 PACIFIC AVE

DESIGNED BY S.M. CHECKED BY A.P.
DRAWN BY S.M. APPROVED BY R.T.C.

HOR. SCALE: 1 : 500
VERTICAL: 1 : 10

ENGINEER'S SEAL

PROVINCE OF MANITOBA
R.T. CUNNINGHAM
Member
24711
REGISTERED PROFESSIONAL ENGINEER

ORIGINAL SIGNED BY
R.T.C. MARCH 4, 2013

THE CITY OF WINNIPEG
PUBLIC WORKS DEPARTMENT

MCGILLIVRAY BOULEVARD EASTBOUND
FROM IRENE STEET TO PEMBINA HIGHWAY
ASPHALT OVERLAY AND ASSOCIATED WORKS
FROM STA. 9+50 TO STA. 12+69

CITY DRAWING NUMBER P-3340-4
SHEET 4 OF 5

4