

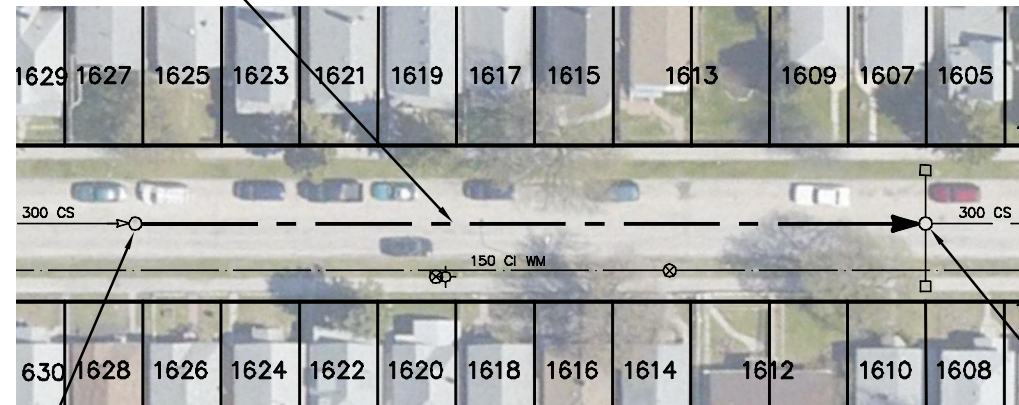

# ROSS AVENUE (W)

**78.00 OF 300 CLAY CS  
TO BE LINED S-MA20012285  
(PARTIALLY DETERIORATED)**



S-MH20011218  
RIM 232.47  
INV E 229.79  
INV W 229.79

S-MH20011192  
RIM 232.18  
INV E 229.48  
INV W 229.48

80 m TO  
KEEWATIN ST

SEWER JUNCTION INFORMATION FROM SEWER VIDEO INSPECTION SEWER ID S-MA20012285		
DISTANCE FROM MH ID S-MH20011218		
DISTANCE	DIAMETER	CLOCK
1.0	150	9
7.5	150	3
9.4	150	10
15.0	150	2
15.7	150	10
20.4	150	10
22.5	150	2
30.8	150	10
30.9	150	2
37.5	150	2
38.6	150	10
45.4	150	2
47.4	150	10
53.9	150	10
54.2	150	2
60.7	150	2
61.3	150	10
69.3	150	10
76.3	150	2
77.0	150	10

### WARNING

IF POWER EQUIPMENT OR EXPLOSIVES  
ARE TO BE USED FOR EXCAVATION ON  
THIS PROJECT THE CONTRACTOR MUST:

- 1) NOTIFY THE GAS COMPANY OF THE  
PROPOSED LOCATION OF EXCAVATION.
- 2) TAKE PRECAUTION TO AVOID DAMAGE  
TO GAS COMPANY INSTALLATIONS.

SEE PROVINCIAL REGULATION 210/72 FOR DETAILS

**METRIC**  
WHOLE NUMBERS INDICATE MILLIMETRES  
DECIMALIZED NUMBERS INDICATE METRES

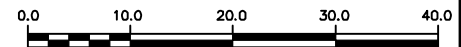

LOCATION APPROVED  
UNDERGROUND STRUCTURES

SUPV. U/G STRUCTURES COMMITTEE DATE

NOTE:

LOCATION OF UNDERGROUND STRUCTURES AS SHOWN ARE BASED ON THE BEST INFORMATION AVAILABLE BUT NO GUARANTEE IS GIVEN THAT ALL EXISTING UTILITIES ARE SHOWN OR THAT THE GIVEN LOCATIONS ARE EXACT. CONFIRMATION OF EXISTENCE AND EXACT LOCATION OF ALL SERVICES MUST BE OBTAINED FROM THE INDIVIDUAL UTILITIES BEFORE PROCEEDING WITH CONSTRUCTION.

B.M. ELEV.

CONSTRUCTION COMPLETION DATE: YYYY MM DD

NO.	REVISIONS	DATE	BY

DESIGNED BY	TS	CHECKED BY	SC
DRAWN BY	MA	APPROVED BY	KZ
SCALE:	1:750	RELEASED FOR CONSTRUCTION	
HORIZONTAL			
VERTICAL			
DATE	2013 10 24	DATE	

PLOT DATE: 2013 10 24

ENGINEER'S SEAL

ORIGINAL  
SIGNED BY  
S.R.J.  
COURNOYER  
13-10-24

CONSULTANT DRAWING NUMBER

BID OPPORTUNITY: 885-2013  
CONTRACT NUMBER: 12



**THE CITY OF WINNIPEG**  
WATER AND WASTE DEPARTMENT  
ENGINEERING DIVISION

2013 SEWER RENEWALS  
BY CIPP LINING  
**ROSS AVENUE (W)**  
1ST MH E OF KEEWATIN STREET TO  
2ND MH E OF KEEWATIN STREET

SHEET 27 OF 46

CITY DRAWING NUMBER

10596

FILE PATH: R:\DRAWINGS\SEWER\2013\_RENEWALS\CIPP\CONTRACT 12\EXPORTS\  
FILE NAME: 10596.dwg