

# HAMPTON STREET

108.00 OF 375 CONC CS  
TO BE LINED S-MA20008272  
(PARTIALLY DETERIORATED)

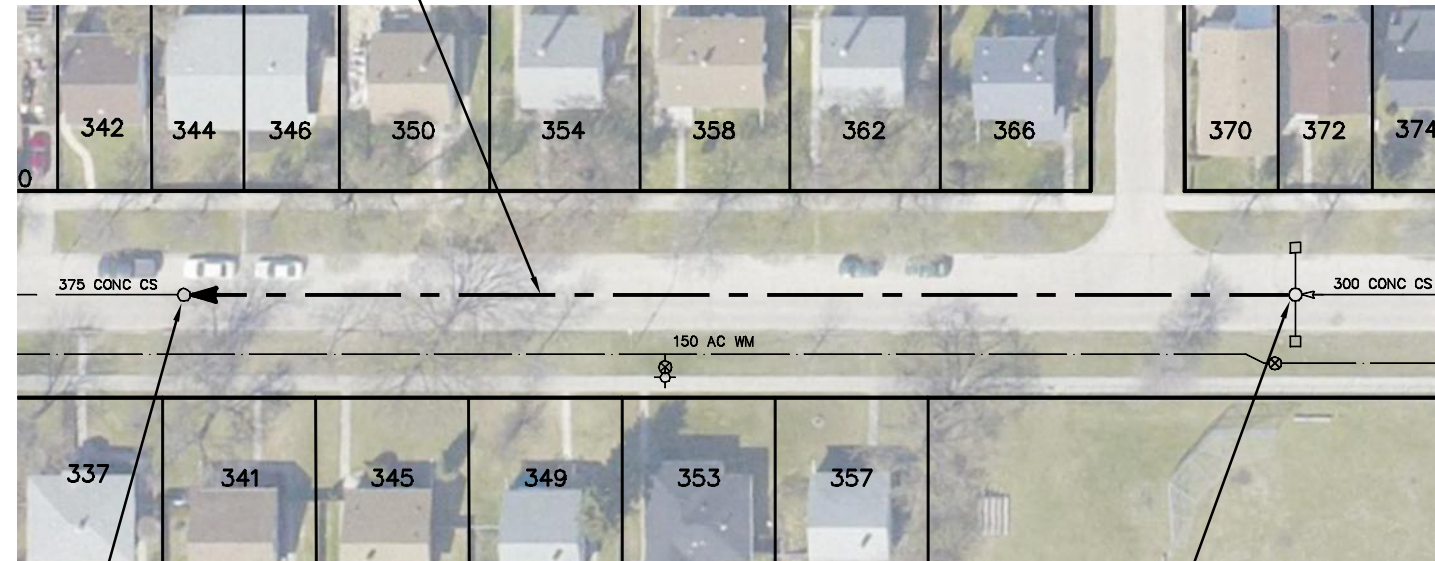

S-MH20007586  
RIM 235.76  
INV N 231.95  
INV S 231.95

S-MH20007587  
RIM 235.61  
INV N 232.34  
INV S 232.34

70 m TO NESS AVENUE

SEWER JUNCTION INFORMATION FROM SEWER VIDEO INSPECTION SEWER ID S-MA20008272		
DISTANCE FROM MH ID S-MH20007587		
DISTANCE	DIAMETER	CLOCK
11.0	150	1
28.3	150	1
29.0	150	1
45.3	150	1
46.0	150	11
46.7	150	11
57.0	150	1
59.9	150	1
60.8	150	11
73.8	150	11
74.4	200	1
77.0	150	1
83.3	150	1
90.1	150	2
90.4	150	1
94.1	150	11
99.6	150	1
102.9	150	11

## WARNING

IF POWER EQUIPMENT OR EXPLOSIVES ARE TO BE USED FOR EXCAVATION ON THIS PROJECT THE CONTRACTOR MUST:

- 1) NOTIFY THE GAS COMPANY OF THE PROPOSED LOCATION OF EXCAVATION.
- 2) TAKE PRECAUTION TO AVOID DAMAGE TO GAS COMPANY INSTALLATIONS.

SEE PROVINCIAL REGULATION 210/72 FOR DETAILS

## METRIC

WHOLE NUMBERS INDICATE MILLIMETRES  
DECIMALIZED NUMBERS INDICATE METRES

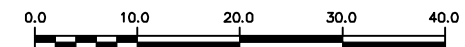

LOCATION APPROVED  
UNDERGROUND STRUCTURES

SUPV. U/G STRUCTURES COMMITTEE DATE

NOTE:

LOCATION OF UNDERGROUND STRUCTURES AS SHOWN ARE BASED ON THE BEST INFORMATION AVAILABLE BUT NO GUARANTEE IS GIVEN THAT ALL EXISTING UTILITIES ARE SHOWN OR THAT THE GIVEN LOCATIONS ARE EXACT. CONFIRMATION OF EXISTENCE AND EXACT LOCATION OF ALL SERVICES MUST BE OBTAINED FROM THE INDIVIDUAL UTILITIES BEFORE PROCEEDING WITH CONSTRUCTION.

B.M. ELEV.			
CONSTRUCTION COMPLETION DATE: YYYY MM DD			
NO.	REVISIONS	DATE	BY

DESIGNED BY	TS	CHECKED BY	SC
DRAWN BY	MA	APPROVED BY	KZ
SCALE:		RELEASED FOR CONSTRUCTION	
HORIZONTAL	1:750		
VERTICAL			
DATE	2013 10 24	DATE	

ENGINEER'S SEAL

ORIGINAL SIGNED BY  
S.R.J. COURNOYER  
13-10-24

CONSULTANT DRAWING NUMBER  
-



**THE CITY OF WINNIPEG**  
WATER AND WASTE DEPARTMENT  
ENGINEERING DIVISION

2013 SEWER RENEWALS  
BY CIPP LINING  
**HAMPTON STREET**  
2ND MH N OF NESS AVENUE TO  
1ST MH N OF NESS AVENUE

SHEET 16 OF 46

CITY DRAWING NUMBER

10585