

Door Schedule																	
Door Number	Room Number	Room Name	Hardware Set	Type Mark	Width	Height	Thickness	Door Material	Door Finish	Door Fire Rating	Insulated	Frame Type	Frame Material	Frame Fire Rating	Frame Finish	Glazing Type	Comments
D001	N/A	EXTERIOR CONCRETE PAD	(COMMENTS)	DT12	1350	2150		CHAIN LINK	GALV.			N/A	STL		GALV.		HASP AND PADLOCK REQUIRED.
D100A	100	VESTIBULE	1	DT1	1050	2150	57	ALUM	ANODIZED		YES	FT1	ALUM		ANODIZED	DUAL, TEMPERED	AUTOMATIC DOOR OPENER. THERMALLY BROKEN STOREFRONT SYSTEM.
D100B	100	VESTIBULE	2	DT2	1050	2150	45	ALUM	ANODIZED			FT2	ALUM		ANODIZED	SINGLE, TEMPERED	AUTOMATIC DOOR OPENER.
D102A	102	OFFICE	3	DT5	1050	2150	45	SC WOOD	STAINED			FT2	ALUM		ANODIZED		
D102B	102	OFFICE	4	DT8	1050	2239*	13	ALUM	ANODIZED			FT3	WOOD		STAINED		ROLL UP DOOR & FRAME TO MANUFACTURER'S DETAIL. SEE ALSO 8/A503, 10/A503 AND 13/A503.
D104A	104	BOARD/FLEX	18	DT3	1050	2150	45	SC WOOD	STAINED			FT4	PSF		PAINTED		AUTOMATIC DOOR OPENER.
D104B	104	BOARD/FLEX	6	DT9	2600*	2200*	45	SC WOOD	STAINED			FT4	WOOD		STAINED	SINGLE, TEMPERED	SEE ALSO 15/A503 AND 16/A503.
D104C	104	BOARD/FLEX	6	DT10	1950*	2200*	45	SC WOOD	STAINED			FT4	WOOD		STAINED	SINGLE, TEMPERED	SEE ALSO 15/A503 AND 16/A503.
D104D	104	BOARD/FLEX	8	DT7	1800	2150	45	SC WOOD	STAINED			FT4	PSF		PAINTED		
D104E	104	BOARD/FLEX	8	DT7	1800	2150	45	SC WOOD	STAINED			FT4	PSF		PAINTED		
D104F	104	BOARD/FLEX	9	DT5	1050	2150	45	HM	PAINTED			FT4	PSF		PAINTED		
D105A	105	SERVERY	5	DT4	1050	2150	45	SC WOOD	STAINED			FT4	PSF		PAINTED		AUTOMATIC DOOR OPENER.
D105B	105	SERVERY	4	DT8	1800	2239*	13	ALUM	ANODIZED			FT3	WOOD		STAINED		ROLL UP DOOR & FRAME TO MANUFACTURER'S DETAIL. SEE ALSO 6/1503, 7/A503, 8/A503 AND 13/A503.
D105C	105	SERVERY	4	DT8	1500	2239*	13	ALUM	ANODIZED			FT3	WOOD		STAINED		ROLL UP DOOR & FRAME TO MANUFACTURER'S DETAIL. SEE ALSO 6/A503, 7/A503, 8/A503 AND 13/A503.
D105D	105	SERVERY	9	DT5	1050	2150	45	HM	PAINTED			FT4	PSF		PAINTED		
D105E	105	SERVERY	4	DT8	1500	2239*	13	ALUM	ANODIZED			FT3	WOOD		STAINED		ROLL UP DOOR & FRAME TO MANUFACTURER'S DETAIL. SEE ALSO 6/A503, 7/A503, 8/A503 AND 13/A503.
D107A	107	VESTIBULE	19	DT1	1050	2150	57	ALUM	ANODIZED		YES	FT1	ALUM		ANODIZED	DUAL, TEMPERED	AUTOMATIC DOOR OPENER. THERMALLY BROKEN STOREFRONT SYSTEM.
D107B	107	VESTIBULE	2	DT2	1050	2150	45	ALUM	ANODIZED			FT2	ALUM		ANODIZED	SINGLE, TEMPERED	AUTOMATIC DOOR OPENER.
D108A	108	SERVICE / ZAMBONI	10	DT5	1050	2150	45	HM	PAINTED	45 MIN		FT4	PSF	45 MIN	PAINTED		
D108B	108	SERVICE / ZAMBONI	11	DT5	1050	2150	45	HM	PAINTED		YES	FT4	PSF		PAINTED		INSULATED DOOR AND FRAME.
D108C	108	SERVICE / ZAMBONI	4	DT11	3050	3050	50	HM	PREFIN		YES	N/A					SECTIONAL OVERHEAD INSULATED DOOR AND FRAME. SEE ALSO 7/A402, 3/A502 AND 4/A552.
D110	110	UTR	13	DT5	1050	2150	45	SC WOOD	STAINED			FT4	PSF		PAINTED		AUTOMATIC DOOR OPENER.
D111A	111	GYM	7	DT2	1050	2150	45	SC WOOD	STAINED			FT2	ALUM		ANODIZED	SINGLE, TEMPERED	AUTOMATIC DOOR OPENER.
D111B	111	GYM	14	DT13	1050/750	2150	45	SC WOOD	STAINED			FT2	ALUM		ANODIZED	SINGLE, TEMPERED	AUTOMATIC DOOR OPENER. 1050 WIDE ACTIVE LEAF/750 WIDE INACTIVE LEAF.
D111C	111	GYM	15	DT7	1800	2150	45	HM	PAINTED		YES	FT5	PSF		PAINTED		INSULATED DOOR & FRAME.
D111D	111	GYM	15	DT7	1800	2150	45	HM	PAINTED		YES	FT5	PSF		PAINTED		INSULATED DOOR & FRAME.
D111E	111A	STOR	12	DT7	1800	2150	45	HM	PAINTED			FT4	PSF		PAINTED		
D111F	111B	STOR	12	DT7	1800	2150	45	HM	PAINTED			FT4	PSF		PAINTED		
D113	113A	ELEC	16	DT6	1050	2150	45	HM	PAINTED	45 MIN		FT4	PSF	45 MIN	PAINTED		
D200	200A	STORAGE ROOM	17	DT6	1050	2150	45	HM	PAINTED	45 MIN		FT4	PSF	45 MIN	PAINTED		
D201	200	MECHANICAL / MEZZANINE	(COMMENTS)	DT12	1220	2150		CHAIN LINK	GALV.			N/A	STL		GALV.		HASP AND PADLOCK REQUIRED.

NOTE:  
 • ##### DENOTES DOOR THAT IS LARGER THAN OPENING SIZE - SEE DOOR TYPES AND MANUFACTURER'S DETAILS WHERE APPLICABLE

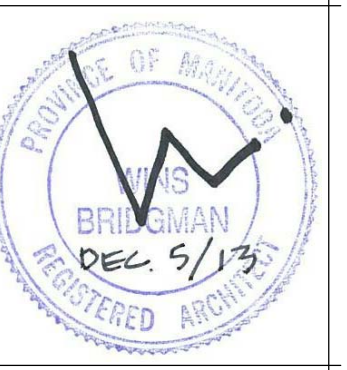
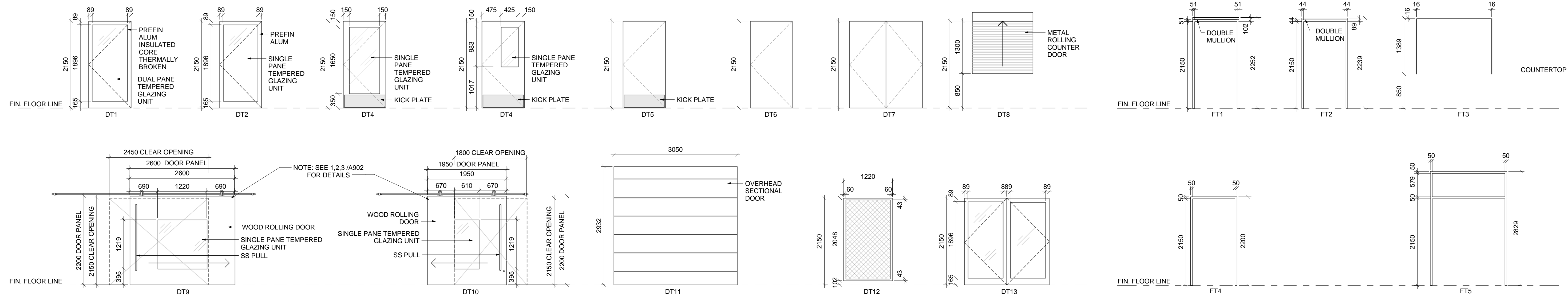
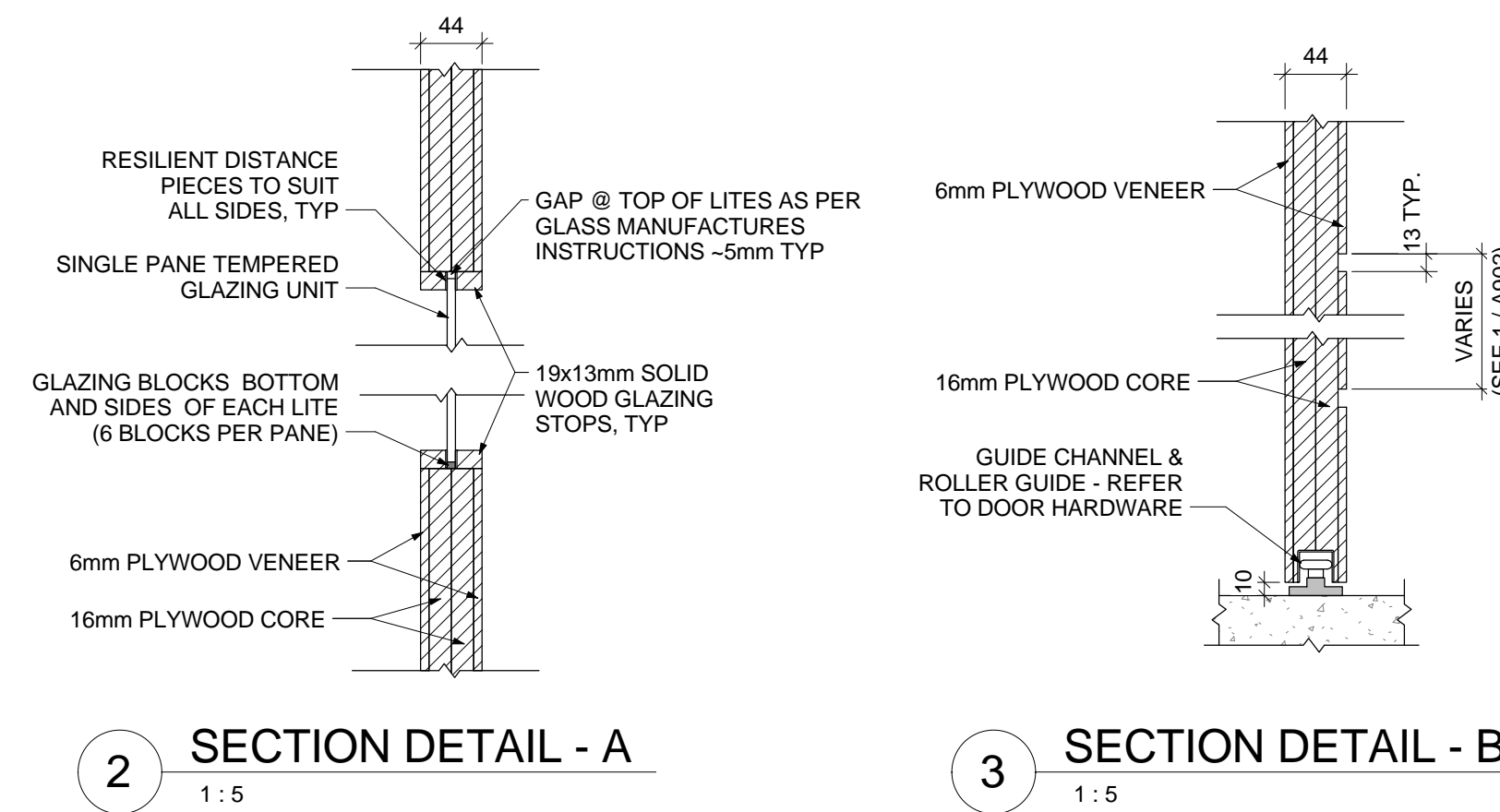
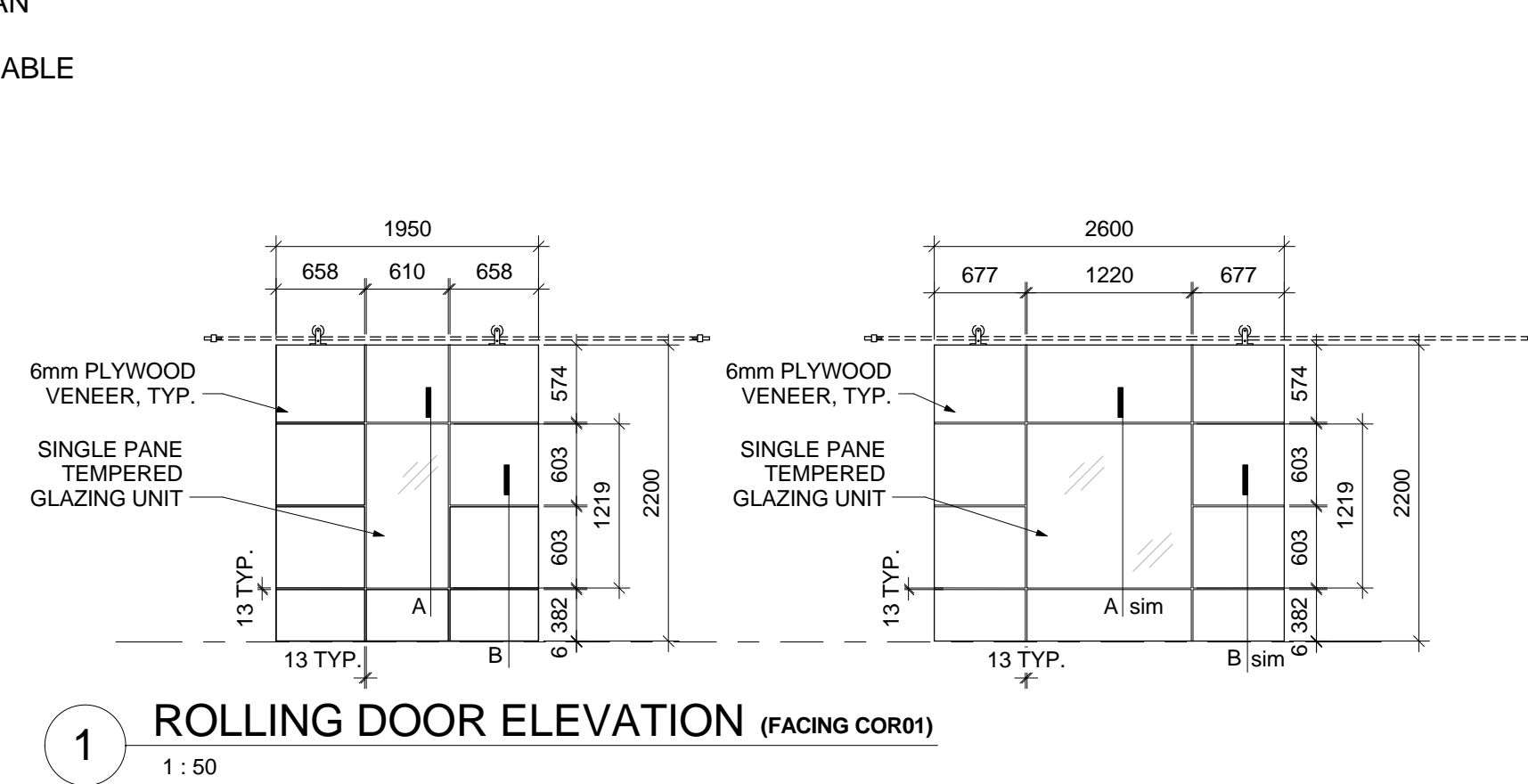

THE CITY OF WINNIPEG PLANNING,  
 PROPERTY AND DEVELOPMENT  
 DEPARTMENT  
 MUNICIPAL ACCOMMODATIONS DIVISION  
 4TH FLOOR - 185 KING STREET  
 WINNIPEG, MB  
 R3B 1J1

Project:  
 EAST ELMWOOD  
 COMMUNITY  
 CENTRE  
 490 KEENLEYSIDE,  
 WINNIPEG, MB

Project Number: 2015-041  
 Bid Opportunity Number: 788-2013

Drawing Title:  
 DOOR & FRAME  
 SCHEDULE

# Issue/Revision Date  
 1 ISSUED FOR TENDER 2013-12-09

Design By:  
 Date:  
 Design Check:  
 Date:  
 Drawn By:  
 Date:  
 DWG Check:  
 Date:

Sheet No: **A902**

This drawing is property of the Consultant and cannot be reproduced or used without the consent of the Consultant. The contractor is responsible for checking and verifying all levels and dimensions and shall report all discrepancies to the Consultant and obtain clarification prior to commencing work.