

- CONSTRUCTION NOTES:**
- CONTRACTOR SHALL TAKE PRECAUTIONARY STEPS TO AVOID DAMAGE FROM CONSTRUCTION ACTIVITIES TO EXISTING BOULEVARDS AND TREES WITHIN THE LIMITS OF CONSTRUCTION.
 - LOCATION OF EXISTING SERVICES ARE TO BE CONFIRMED IN THE FIELD BY THE CONTRACTOR.
 - TIE-INS TO BE VERIFIED IN THE FIELD BY THE CONTRACT ADMINISTRATOR.
 - LIMITS OF SIDEWALK RENEWALS TO BE FINALIZED IN THE FIELD BY THE CONTRACT ADMINISTRATOR.
 - FOR ADJUSTMENTS AND REMOVALS SEE SHEETS CT-0002 TO CT-0010.
 - DITCH GRADING TO BE FINALIZED IN FIELD BY CONTRACT ADMINISTRATOR.
 - INSTALL 18 m OF 150 mm SUB DRAIN TO CATCH BASINS IN BOTH DIRECTIONS PARALLEL TO ROADWAY AS PER SD-245 AND CAP ENDS.
 - INSTALL 100 m OF 150 mm SUB DRAIN ON EITHER SIDE OF PLESSIS UNDERPASS LOW POINT. (LOWEST PAVEMENT EDGE ONLY)
 - SEE CIVIL DRAWINGS FOR ALL CATCH BASIN AND CULVERT INFORMATION.
 - INSTALL MODIFIED BARRIER CURB (SD-203B) ON ALL CONCRETE APPROACH RADII.
 - EXCAVATION SLOPES ON EITHER SIDE OF THE RAIL SHOOFLY SHALL BE AS DIRECTED IN THE GEOTECHNICAL MEMO WITHIN THE BID OPPORTUNITY.
 - NO VIBRATORY COMPACTION OVER OIL LINES.

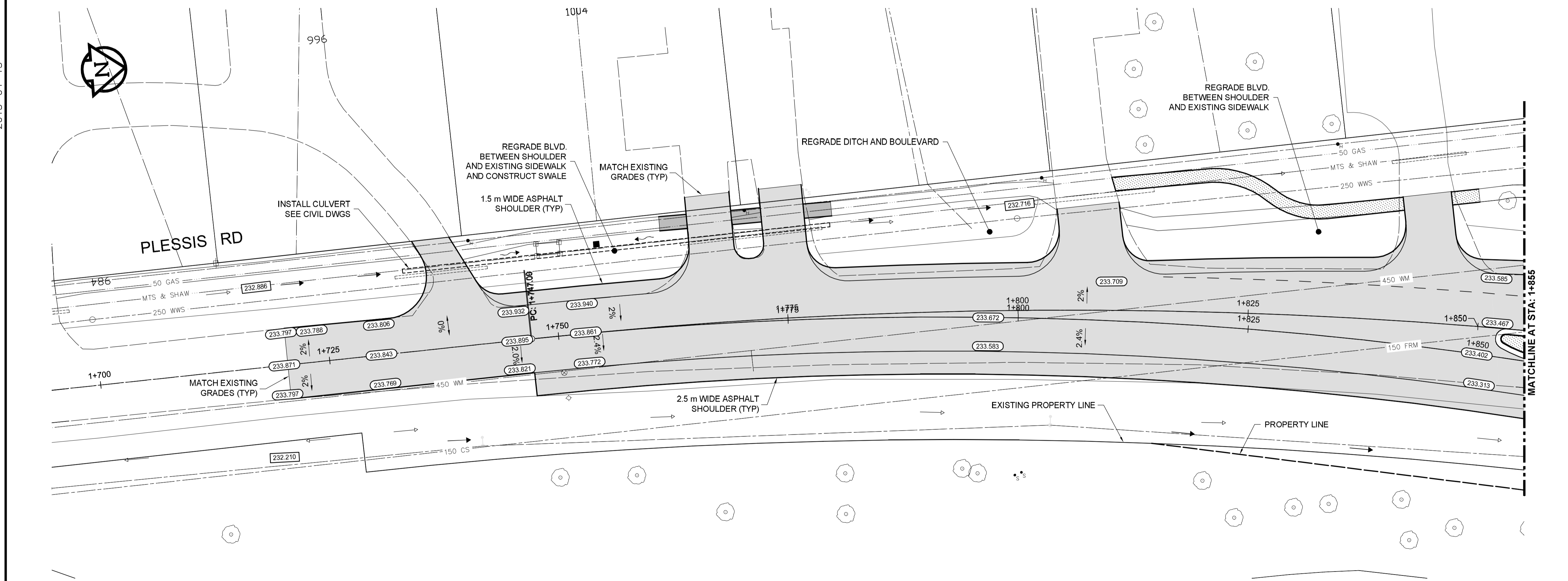

METRIC
WHOLE NUMBERS INDICATE MILLIMETRES
DECIMAL NUMBERS INDICATE METRES

WARNING

IF POWER EQUIPMENT OR EXPLOSIVES ARE TO BE USED FOR EXCAVATION ON THIS PROJECT THE CONTRACTOR MUST:

- NOTIFY THE GAS COMPANY OF THE PROPOSED LOCATION OF EXCAVATION.
- TAKE PRECAUTION TO AVOID DAMAGE TO GAS COMPANY INSTALLATIONS SEE PROVINCIAL REGULATION 140/22 FOR DETAILS.
- OBTAIN EXCAVATION PERMITS PRIOR TO CONSTRUCTION.



150 WM		150 WM		HYDRO		HYDRO		150 WM		WATERMAIN		150 WM		LOCATION APPROVED UNDERGROUND STRUCTURES		B.M. ELEV.		DESIGNED BY		CHECKED BY		ENGINEER'S SEAL		THE CITY OF WINNIPEG PUBLIC WORKS DEPARTMENT		CITY DRAWING NUMBER	
○	HYDRANT	○	HYDRANT	○	MTS	○	MTS	○	HYDRANT	○	VALVE	○	VALVE	○	CONCRETE	○	CONCRETE	○	RTP	○	TJP	○	T.J. PETERS	○	PLESSIS ROAD TWINNING AND GRADE SEPARATION AT CN REDDITT SUBDIVISION CONTRACT 3	○	U238-2014-2123
○	VALVE	○	VALVE	○	CONCRETE	○	CONCRETE	○	LAND DRAINAGE SEWER	○	LAND DRAINAGE SEWER	○	LAND DRAINAGE SEWER	○	ASPHALT	○	ASPHALT	○	TJH	○	DPK	○	2013/11/21	○	Member 22309	○	23 OF 66
○	LAND DRAINAGE SEWER	○	LAND DRAINAGE SEWER	○	ASPHALT	○	ASPHALT	○	WASTE WATER SEWER	○	WASTE WATER SEWER	○	WASTE WATER SEWER	○	PLANING	○	PLANING	○	1:250	○	RELEASED FOR CONSTRUCTION BY:	○	CONSULTANT DRAWING NO. 12-6576-CT-0023	○	PLAN-PROFILE - PLESSIS - STA. 1+685 TO 1+845 (NORTHBOUND)	○	CT-0023
○	WASTE WATER SEWER	○	WASTE WATER SEWER	○	SIDEWALK	○	SIDEWALK	○	MANHOLE	○	MANHOLE	○	MANHOLE	○	PAVING STONES	○	PAVING STONES	○	1:10	○		○		○			
○	MANHOLE	○	MANHOLE	○	PROPERTY LINE	○	PROPERTY LINE	○	CATCH BASIN	○	CATCH BASIN	○	CATCH BASIN	○	PROPERTY LINE	○	PROPERTY LINE	○		○		○		○			
○	CATCH BASIN	○	CATCH BASIN	○	DRAINAGE SWALE	○	DRAINAGE SWALE	○	CURB INLET	○	CURB INLET	○	CURB INLET	○	DRAINAGE ARROW	○	DRAINAGE ARROW	○		○		○		○			
○	CURB INLET	○	CURB INLET	○	NORTH/WEST GUTTER	○	NORTH/WEST GUTTER	○	JUNCTIONS	○	JUNCTIONS	○	JUNCTIONS	○	SOUTH/EAST GUTTER	○	SOUTH/EAST GUTTER	○		○		○		○			
○	JUNCTIONS	○	JUNCTIONS	○	NORTH/WEST DITCH	○	NORTH/WEST DITCH	○	CULVERT	○	CULVERT	○	CULVERT	○	SOUTH/EAST DITCH	○	SOUTH/EAST DITCH	○		○		○		○			
○	CULVERT	○	CULVERT	○	NORTH/WEST DITCH	○	NORTH/WEST DITCH	○	100 GAS	○	100 GAS	○	100 GAS	○	SOUTH/EAST DITCH	○	SOUTH/EAST DITCH	○		○		○		○			
○	100 GAS	○	100 GAS	○	SOUTH/EAST DITCH	○	SOUTH/EAST DITCH	○	EXISTING	○	EXISTING	○	EXISTING	○	LEGEND-PLAN	○	LEGEND-PROFILE	○		○		○		○			
○	EXISTING	○	EXISTING	○	LEGEND-PLAN	○	LEGEND-PROFILE	○	PROPOSED	○	PROPOSED	○	PROPOSED	○	LEGEND-PLAN	○	LEGEND-PROFILE	○		○		○		○			