

PLESSIS SOUTHBOUND						
SEGMENT	STATION (START)	STATION (END)	NORTHING (START)	EASTING (START)	NORTHING (END)	EASTING (END)
C1	1+747.082	1+918.878	5527549.594	641738.945	5527719.206	641761.448
L2	1+918.878	1+992.761	5527719.206	641761.448	5527790.045	641782.438
C2	1+992.761	2+063.570	5527790.045	641782.438	5527858.737	641799.527
L3	2+063.570	2+202.028	5527858.737	641799.527	5527994.447	641826.976
C3	2+202.028	2+439.593	5527994.447	641826.976	5528230.782	641842.973
L4	2+439.593	2+628.886	5528230.782	641842.973	5528419.683	641830.792
C4	2+628.886	2+705.456	5528419.683	641830.792	5528496.158	641827.035
L5	2+705.456	3+169.377	5528496.158	641827.035	5528959.814	641811.373

PLESSIS NORTHBOUND						
SEGMENT	STATION (START)	STATION (END)	NORTHING (START)	EASTING (START)	NORTHING (END)	EASTING (END)
C5	1+747.002	1+880.065	5527549.509	641738.947	5527680.826	641756.667
L7	1+880.065	2+014.201	5527680.826	641756.667	5527809.264	641795.350
C6	2+014.201	2+097.875	5527809.264	641795.350	5527890.389	641815.723
L8	2+097.875	2+189.615	5527890.389	641815.723	5527980.307	641833.910
C7	2+189.615	2+446.906	5527980.307	641833.910	5528236.285	641850.354
L9	2+446.906	2+640.884	5528236.285	641850.354	5528429.771	641836.541
C8	2+640.884	2+753.385	5528429.771	641836.541	5528542.110	641830.636
L10	2+753.385	3+171.501	5528542.110	641830.636	5528959.988	641816.520

CURVE DATA					
#	R.	Δc	Tc	L.	L.C.
C1	550.000	17°53'48"	86.603	171.796	171.099
C2	800.000	5°04'17"	35.428	70.810	70.786
C3	900.000	15°07'26"	119.477	237.565	236.876
C4	2500.000	1°45'18"	38.288	76.571	76.568

CURVE DATA					
#	R.	Δc	Tc	L.	L.C.
C5	420.000	18°09'08"	67.094	133.063	132.507
C6	900.000	5°19'37"	41.867	83.674	83.644
C7	950.000	15°31'03"	129.438	257.291	256.506
C8	3000.000	2°08'55"	56.257	112.501	112.494

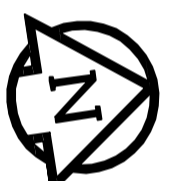
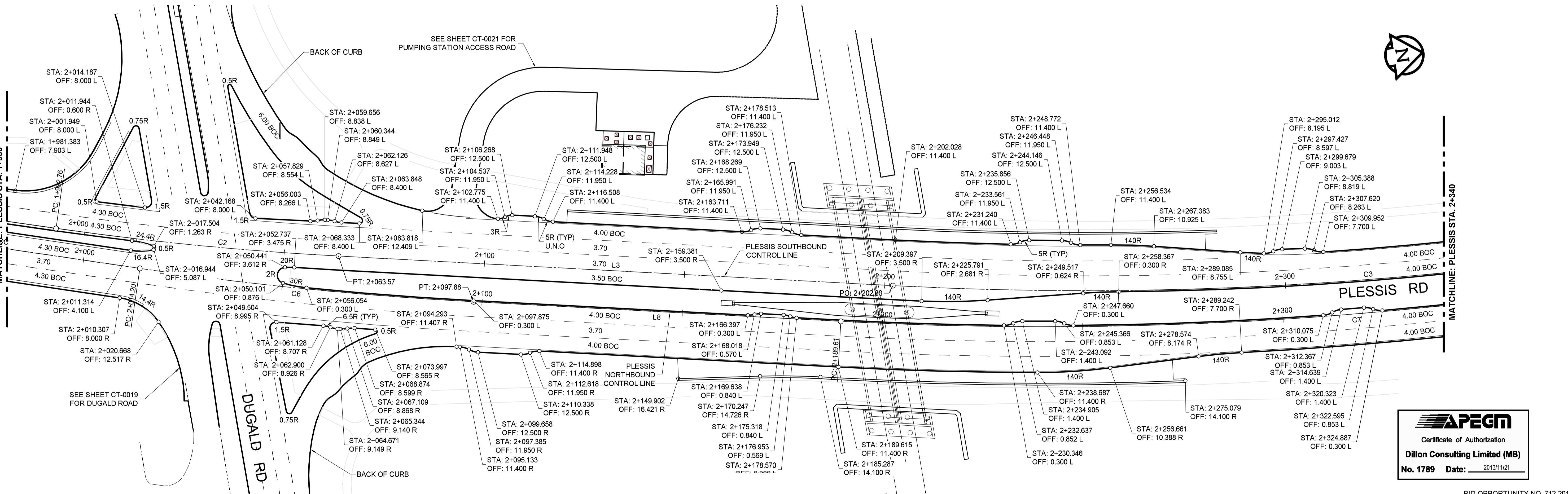

APEGM
 Certificate of Authorization
Dillon Consulting Limited (MB)
 No. 1789 Date: 2013/11/21

2013-04-30

150 WM	150 WWS	HYDRO	HYDRO	150 WM	150 WWS	HYDRO	HYDRO
WATERMAIN	WASTE WATER SEWER	MTS	CONCRETE	WATERMAIN	WASTE WATER SEWER	MTS	CONCRETE
HYDRANT	LAND DRAINAGE SEWER	VALVE	ASPHALT	HYDRANT	LAND DRAINAGE SEWER	VALVE	ASPHALT
MANHOLE	WASTE WATER SEWER	CATCH BASIN	PLANING	MANHOLE	WASTE WATER SEWER	CATCH BASIN	PLANING
JUNCTIONS	WASTE WATER SEWER	CULVERT	SIDEWALK	JUNCTIONS	WASTE WATER SEWER	CULVERT	SIDEWALK
EXISTING	LEGEND-PLAN	PROPOSED	EXISTING	LEGEND-PLAN	PROPOSED	EXISTING	LEGEND-PROFILE

LOCATION APPROVED UNDERGROUND STRUCTURES

SUPV. U/G STRUCTURES COMMITTEE DATE

NOTE:
 LOCATION OF UNDERGROUND STRUCTURES AS SHOWN ARE BASED ON THE BEST INFORMATION AVAILABLE, BUT NO GUARANTEE IS GIVEN THAT THE GIVEN LOCATIONS ARE EXACT. CONFIRMATION OF EXISTENCE AND EXACT LOCATION OF ALL SERVICES MUST BE OBTAINED FROM THE INDIVIDUAL UTILITIES BEFORE PROCEEDING WITH CONSTRUCTION.

B.M. ELEV.	NO.	ISSUED FOR TENDER	DATE	BY
	0	ISSUED FOR TENDER	2013/11/21	TJP

DESIGNED BY	CHECKED BY
RTP	TJP
DRAWN BY	APPROVED BY
TJH	DPK
HOR. SCALE:	RELEASED FOR CONSTRUCTION BY:
1:500	
VERTICAL:	DATE
	2013/11/21

ENGINEER'S SEAL

PROVINCE OF MANITOBA
 REGISTERED PROFESSIONAL ENGINEER
T.J. PETERS
 2013/11/21
 Member
 22309

THE CITY OF WINNIPEG PUBLIC WORKS DEPARTMENT

PLESSIS ROAD TWINNING AND GRADE SEPARATION AT CN REDDITT SUBDIVISION CONTRACT 3

CITY DRAWING NUMBER U238-2014-2117
 SHEET 17 OF 66

CONSULTANT DRAWING NO. 12-6576-CT-0017

CONTROL LINE GEOMETRY - PLESSIS (1 OF 2)

CT-0017