

2013-05-08

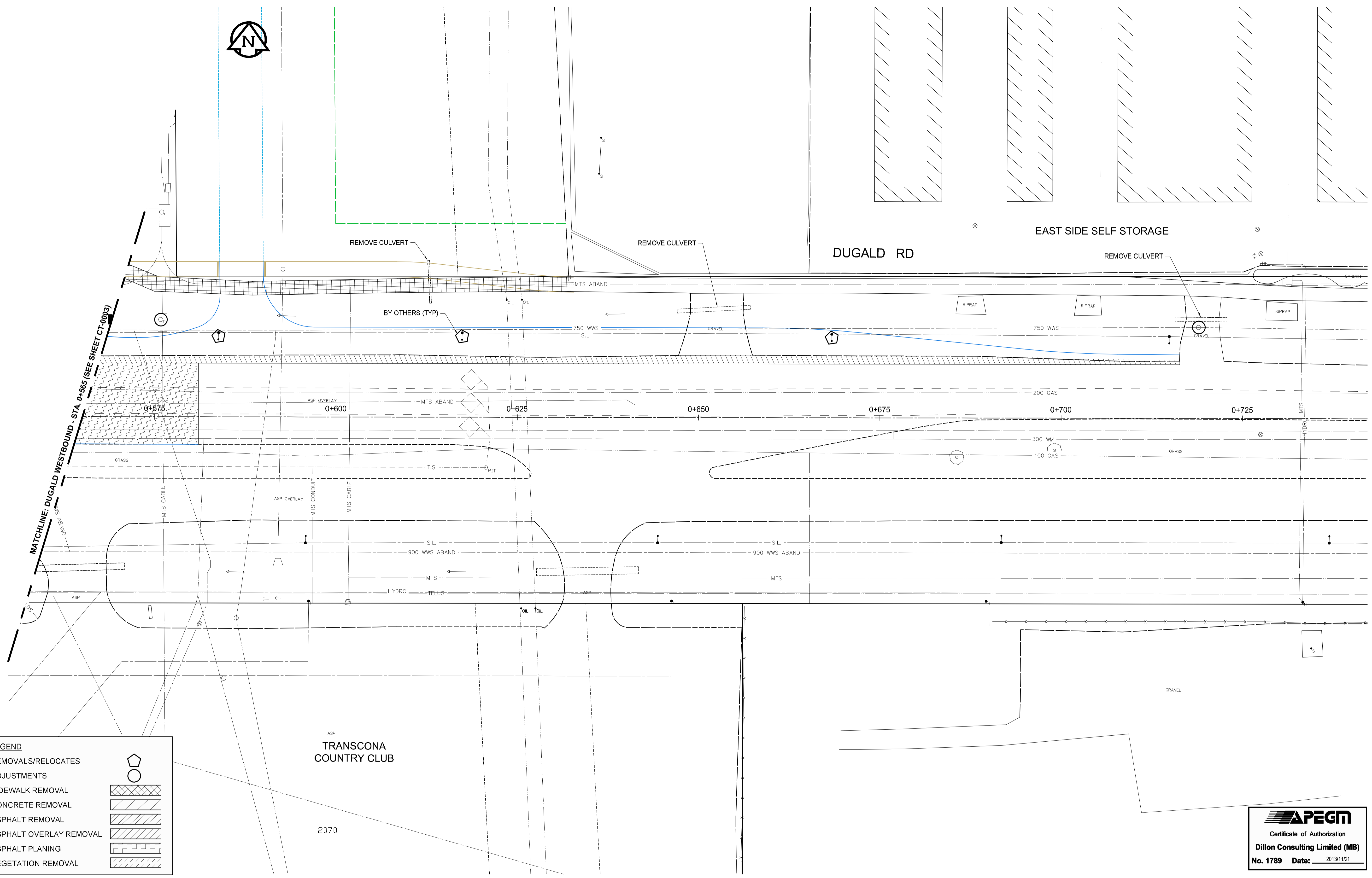
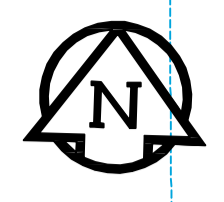

**LEGEND**

REMOVALS/RELOCATES	
ADJUSTMENTS	
SIDEWALK REMOVAL	
CONCRETE REMOVAL	
ASPHALT REMOVAL	
ASPHALT OVERLAY REMOVAL	
ASPHALT PLANING	
VEGETATION REMOVAL	

**APEGM**  
 Certificate of Authorization  
**Dillon Consulting Limited (MB)**  
 No. 1789 Date: 2013/11/21

BID OPPORTUNITY NO. 712-2013

	150 WM WATERMAIN		150 WM WATERMAIN		HYDRO HYDRANT		150 WM WATERMAIN		150 WM WATERMAIN
	HYDRANT		VALVE		M.T.S.		CONCRETE		ASPHALT
	300 LDS LAND DRAINAGE SEWER		300 LDS LAND DRAINAGE SEWER		250 WWS WASTE WATER SEWER		PLANING		SIDEWALK
	250 WWS WASTE WATER SEWER		MANHOLE		CATCH BASIN		CURB INLET		JUNCTIONS
	CULVERT		100 GAS GAS		100 GAS GAS		EXISTING		PROPOSED
	100 GAS GAS		EXISTING		PROPOSED		EXISTING		PROPOSED

**LOCATION APPROVED UNDERGROUND STRUCTURES**

SUPV. U/G STRUCTURES COMMITTEE DATE

**NOTE:**  
 LOCATION OF UNDERGROUND STRUCTURES AS SHOWN ARE BASED ON THE BEST INFORMATION AVAILABLE, BUT NO GUARANTEE IS GIVEN THAT ALL EXISTING UTILITIES ARE SHOWN OR THAT THE GIVEN LOCATIONS ARE EXACT. CONFIRMATION OF EXISTENCE AND EXACT LOCATION OF ALL SERVICES MUST BE OBTAINED FROM THE INDIVIDUAL UTILITIES BEFORE PROCEEDING WITH CONSTRUCTION.

<b>B.M. ELEV.</b>					
0	ISSUED FOR TENDER	2013/11/21	TJP		
NO.	REVISIONS	DATE	BY	DATE	

<b>DESIGNED BY</b>	TJH	<b>CHECKED BY</b>	TJP
<b>DRAWN BY</b>	TJH	<b>APPROVED BY</b>	DPK
<b>HOR. SCALE:</b>	1:250	<b>RELEASED FOR CONSTRUCTION BY:</b>	
<b>VERTICAL:</b>		<b>DATE</b>	2013/11/21

**ENGINEER'S SEAL**

PROVINCE OF MANITOBA  
 REGISTERED PROFESSIONAL ENGINEER  
 T.J. PETERS  
 2013/11/21  
 Member 22309

CONSULTANT DRAWING NO.  
 12-6576-CT-0010

**THE CITY OF WINNIPEG PUBLIC WORKS DEPARTMENT**

PLESSIS ROAD TWINNING AND GRADE SEPARATION AT CN REDDITT SUBDIVISION CONTRACT 3

CITY DRAWING NUMBER U238-2014-2110  
 SHEET 10 OF 66

REMOVALS - DUGALD 0+565 TO 0+740

**CT-0010**