

**BILL OF MATERIALS**

| MK. NO. | QTY. REQ'D. | DESCRIPTION                          | SIZE                      | MATERIAL               | REMARKS                      | LINE NO. |   |
|---------|-------------|--------------------------------------|---------------------------|------------------------|------------------------------|----------|---|
|         |             | <b>DOUBLE MEDIUM DUTY SHAFT - DM</b> |                           |                        |                              |          | 1 |
| 1       | 1           | OCTAGONAL SECTION SHAFT              | 216 A/F - 178 A/F x 4.554 | CSA G40.21 350W        |                              | 2        |   |
| 2       | 1           | BASE PLATE                           | 32 x 305 x 305            | CSA G40.21 300W        |                              | 3        |   |
| 3       | 2           | ARM FLANGE PLATE                     | 25 x 206 x 293            | CSA G40.21 300W        |                              | 4        |   |
| 4       | 1           | EXTENSION FLANGE PLATE               | 16 x 228 x 228            | CSA G40.21 300W        | SEE DETAIL C                 | 5        |   |
| 5       | 4           | SIDE PLATES                          | 6 x 103 x 206             | CSA G40.21 300W        |                              | 6        |   |
| 6       | 2           | TOP GUSSET PLATE                     | 10 x 52 x 178             | CSA G40.21 300W        |                              | 7        |   |
| 7       | 2           | BOTTOM GUSSET PLATE                  | 10 x 57 x 178             | CSA G40.21 300W        |                              | 8        |   |
| 8       | 1           | EXTENSION FLANGE CAP PLATE           | 6 x 228 x 228             | CSA G40.21 300W        | SEE DETAIL D                 | 9        |   |
| 9       | 1           | FLANGE CAP PLATE                     | 6 x 206 x 293             | CSA G40.21 300W        |                              | 10       |   |
| 10      | 1           | BACK-UP STRIP PLATE                  | 4.554 x 40                | CSA G40.21 350W        |                              | 11       |   |
| 11      | 1           | PIPE PENETRATION (1 1/2") C/W PLUG   | 48 O.D. X 25              | ASTM A53 GR. B SCH. 40 | REMOVE BURRS AND SHARP EDGES | 12       |   |
| 12      | 8           | CAP BOLTS                            | 19 (3/4") DIA. x 63       | ASTM A325              | SEE DETAIL E                 | 13       |   |
|         |             |                                      |                           |                        |                              | 14       |   |
| 13      | 1           | ACCESS PANEL                         |                           |                        | SEE NOTE 7                   | 15       |   |
|         |             |                                      |                           |                        |                              | 16       |   |
| 14      | 1           | BREAKAWAY BASE ASSEMBLY              |                           |                        | SUPPLIED BY OTHERS           |          |   |

APPROXIMATE TOTAL MASS = 180 kg

- NOTES:**
- ALL MATERIALS, EXCEPT STAINLESS STEEL ITEMS, SHALL BE HOT DIP GALVANIZED IN ACCORDANCE WITH ASTM A123-09 (PLUS LATEST REVISIONS) WITH NET RETENTION OF 610 g/m<sup>2</sup>.
  - PROVIDE RAISED IDENTIFICATION NUMBER WITH WELDING ELECTRODE AS PER SPECIFICATION, STRUCTURE TYPE CODE = DM.
  - SHIP WITH EXTENSION FLANGE CAP PLATE & FLANGE CAP PLATE C/W NUTS AND WASHERS INSTALLED.
  - GRIND ALL SHARP POINTS AND EDGES.
  - LONGITUDINAL SEAM WELD SHALL HAVE 60% MINIMUM PENETRATION EXCEPT WITHIN 150 mm OF BASE PLATE AND 400 mm OF EXTENSION FLANGE PLATE SHALL BE COMPLETE PENETRATION.
  - EXTERIOR WELD JOINING SHAFT TO BASE PLATE SHALL BE AN UNEQUAL LEG COMPLETE PENETRATION WELD WITH THE LONG LEG OF THE WELD ALONG THE SHAFT, TERMINATING AT 30' FROM THE SHAFT'S SURFACE.
  - PROVIDE ACCESS PANEL IN ACCORDANCE WITH SHEET 13.

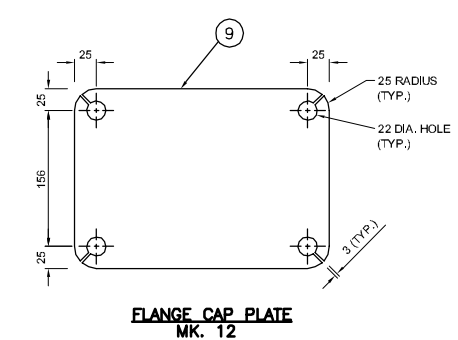
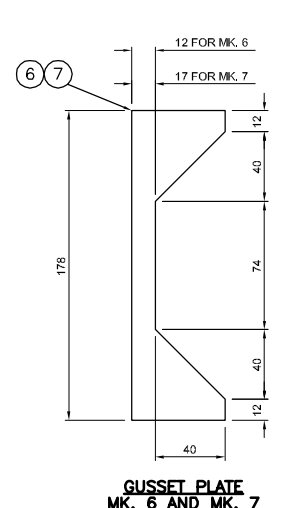

**REDUCED DRAWING N.T.S.**

|                               |                 |                           |                                   |  |                               |
|-------------------------------|-----------------|---------------------------|-----------------------------------|--|-------------------------------|
| B.M. ELEV.                    | DESIGNED BY CDW |                           |                                   |  | CITY DRAWING NUMBER N/A       |
|                               | DRAWN BY JGW    |                           |                                   |  | SHEET 10 OF 13                |
|                               | CHECKED BY SSR  |                           |                                   |  | CONSULTANT DRAWING NUMBER N/A |
|                               | APPROVED BY -   |                           |                                   |  |                               |
|                               | HOR. SCALE NTS  | RELEASED FOR CONSTRUCTION | CONSULTANT PROJECT NUMBER 12-5954 |  |                               |
|                               | VERTICAL NTS    | DATE                      |                                   |  |                               |
| 1 ISSUED BY DILLON CONSULTING | 1/14/13         | CDW                       |                                   |  |                               |
| NO. REVISIONS                 | DATE            | BY                        | DATE                              |  |                               |

G:\CAD\125954\Contract\Current\LIGHT & MEDIUM SHAFT.dwg