

F MOLSON STREET - STA. 0+575
 20/29 SCALE - H:1:100 V:1:50

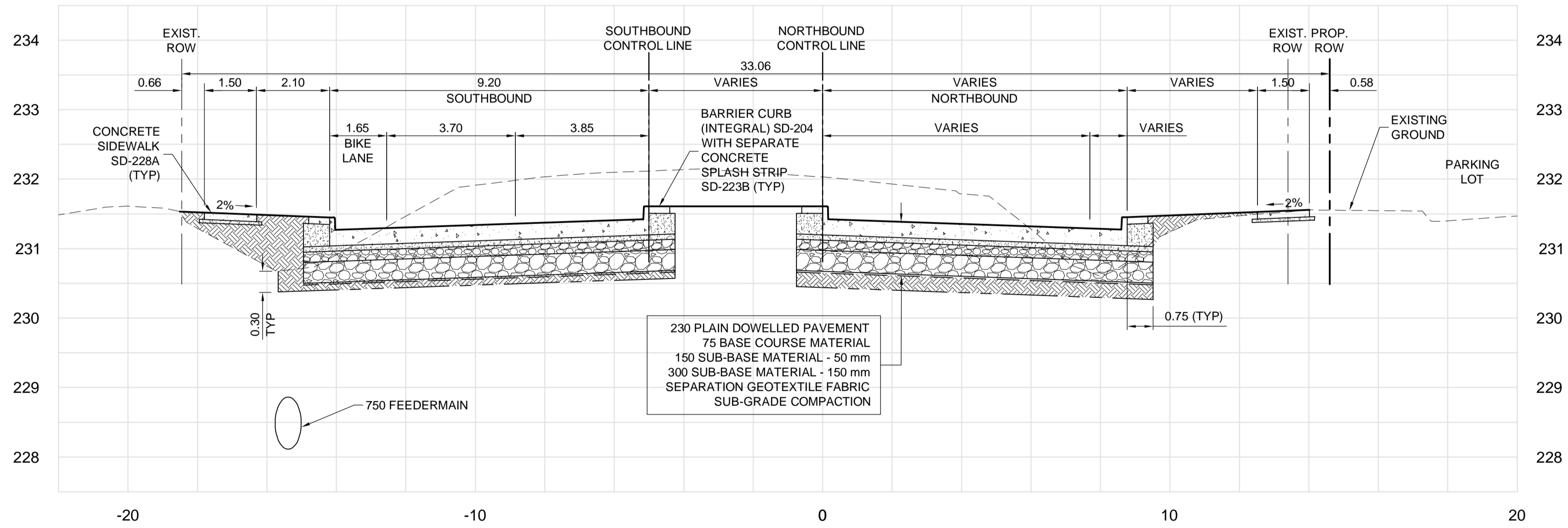

G MOLSON STREET - STA. 0+735
 21/29 SCALE - H:1:100 V:1:50

METRIC

WHOLE NUMBERS INDICATE MILLIMETRES
 DECIMALIZED NUMBERS INDICATE METRES

APEGM
 Certificate of Authorization
Dillon Consulting Limited (MB)
 No. 1789 Date: 12/16/2013

THE CITY OF WINNIPEG
 PUBLIC WORKS DEPARTMENT

Winnipeg

PANET ROAD/MOLSON STREET
 RECONSTRUCTION AND TWINNING

CITY DRAWING NUMBER: P-3350-29
 SHEET OF: 29 OF 45
 CONSULTANT DRAWING NUMBER

G:\CAD\127055\02-Civil\01-Contract\20-Sections-Details.dwg

150 WM	WATERMAIN	150 WM	HYDRO	HYDRO	HYDRO	150 WM	WATERMAIN	150 WM
+	HYDRANT	+	MTS	MTS	MTS	+	HYDRANT	+
+	VALVE	+	MTS	MTS	MTS	+	VALVE	+
300 LDS	LAND DRAINAGE SEWER	300 LDS		CONCRETE		300 LDS	LAND DRAINAGE SEWER	300 LDS
250 WWS	WASTE WATER SEWER	250 WWS		ASPHALT		250 WWS	WASTE WATER SEWER	250 WWS
○	MANHOLE	●		PLANING		○	MANHOLE	○
□	CATCH BASIN	■		SIDEWALK		□	CATCH BASIN	□
▽	CURB INLET	▽		PAVING STONES		▽	CURB INLET	▽
+	JUNCTIONS	+		PARTIAL DEPTH REPAIR		+	JUNCTIONS	+
+	CULVERT	+		PROPERTY LINE		+	CULVERT	+
100 GAS	GAS	100 GAS		DRAINAGE ARROW		100 GAS	GAS	100 GAS
EXISTING	LEGEND-PLAN	PROPOSED	EXISTING	LEGEND-PLAN	PROPOSED	EXISTING	LEGEND-PROFILE	PROPOSED

UNDERGROUND STRUCTURES	B.M. ELEV.
SUPV. U/G STRUCTURES	DATE
LOCATION OF UNDERGROUND STRUCTURES AS SHOWN ARE BASED ON THE BEST INFORMATION AVAILABLE, BUT NO GUARANTEE IS GIVEN THAT ALL EXISTING UTILITIES ARE SHOWN OR THAT THE GIVEN LOCATIONS ARE EXACT. CONFIRMATION OF EXISTENCE AND EXACT LOCATION OF ALL SERVICES MUST BE OBTAINED FROM THE INDIVIDUAL UTILITIES BEFORE PROCEEDING WITH CONSTRUCTION.	

DESIGNED BY	JMS/MRD
DRAWN BY	TJH
CHECKED BY	JNC
APPROVED BY	DPK
HOR. SCALE	RELEASED FOR CONSTRUCTION
VERTICAL	DATE
NO. REVISIONS	DATE BY
3	ISSUED FOR TENDER 12/16/13 JNC
2	ISSUED FOR REVIEW 07/22/13 JNC
1	ISSUED FOR REVIEW 06/21/13 JNC

DATE	12/16/2013
------	------------

DILLON CONSULTING

ENGINEER'S SEAL
 PROVINCE OF MANITOBA
 ORIGINAL STAMPED BY
J.N. CRANG
 12/16/2013
 REGISTERED PROFESSIONAL ENGINEER

CONSULTANT PROJECT NUMBER
12-7055

SECTION (3 OF 5)