

1
L-05 UNIT PAVERS ON GRANULAR - TYP
SCALE - 1 : 20

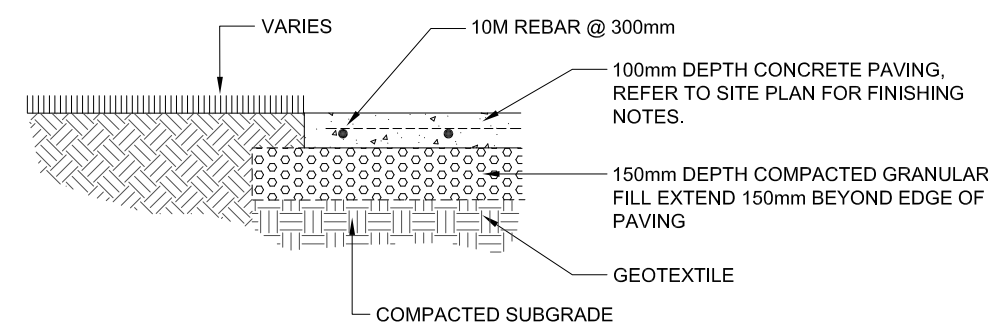

2
L-05 CONCRETE PAVING - TYP
SCALE - 1 : 20

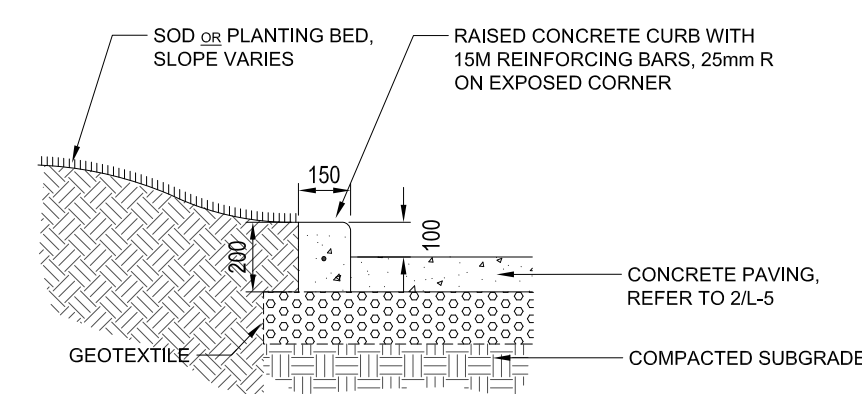

3
L-05 RAISED CURB - TYP.
SCALE - 1 : 20

CONCRETE RETAINING WALL - SPECIFICATION

REINFORCING STEEL:

1. REINFORCING STEEL TO BE NEW DEFORMED BILLET STEEL BARS CONFORMING TO CSA G30.18 (LATEST). GRADE TO BE 400 MPa.
2. REINFORCING STEEL SHALL BE CLEAN, FREE OF RUST, DIRT, LOOSE SCALE, OIL, GREASE OR ANY OTHER MATERIAL WHICH WOULD REDUCE BOND WITH THE CONCRETE.
3. SUBMIT SHOP DRAWINGS WHICH CLEARLY INDICATE BAR SIZES, SPACINGS, LOCATIONS & QUANTITIES OF REINFORCING STEEL, BENDING & CUTTING SCHEDULES, SUPPORTING & SPACING DEVICES, ETC. FOR REVIEW PRIOR TO FABRICATION. DETAIL, FABRICATE AND PLACE REINFORCING IN ACCORDANCE WITH CSA A23.1 (LATEST), CSA A23.3 (LATEST) AND ACI SP-66 (LATEST) UNLESS NOTED. LAP STEEL 36 BAR DIAMETERS (MINIMUM) UNLESS NOTED.
4. BEND ALL HORIZONTAL REINFORCING 305mm AROUND CORNERS OR PROVIDE ADDITIONAL 610mm X 610mm ANGLE BARS.
5. PROVIDE MINIMUM CONCRETE COVER FOR REINFORCING STEEL AS FOLLOWS:

FOOTINGS	75mm
FOUNDATION WALLS	38mm

CONCRETE:

1. CONCRETE MATERIALS AND WORKMANSHIP SHALL BE IN ACCORDANCE WITH CSA A23.1 (LATEST). SEE BELOW FOR MIX REQUIREMENTS.
2. ADMIXTURES SHALL NOT BE USED UNLESS SPECIFIED HEREIN OR APPROVED BY THE DESIGN ENGINEER. CALCIUM CHLORIDE SHALL NOT BE USED.
3. MIX WATER SHALL BE POTABLE.
4. DESIGN, FABRICATE AND ERECT FORMWORK/SHORING IN ACCORDANCE WITH CAN/CSA-S269.3 (LATEST). ALLOW SUFFICIENT CONCRETE CURING TIME PRIOR TO REMOVAL.
5. FORM RELEASE AGENT SHALL BE BIODEGRADABLE, NON-STAINING AND NON-VOLATILE.
6. PROVIDE ADEQUATE COLD/HOT WEATHER PROTECTION AS REQUIRED DURING CURING PERIOD.
7. ALL EXPOSED CORNERS TO HAVE 25mm CHAMFER FILLET UNLESS NOTED.
8. THE CONCRETE SUPPLIER SHALL BE CERTIFIED TO MEET THE REQUIREMENTS OF CSA-A23.1.
9. THE CONCRETE SUPPLIER SHALL SUBMIT CONCRETE MIX DATA SUBMISSION FORMS FOR EACH TYPE OF CONCRETE SPECIFIED FOR REVIEW PRIOR TO BATCHING ANY CONCRETE.

CONCRETE MIX DESIGNS:

CONCRETE MIX DESIGN SHALL BE PROPORTIONED TO MEET THE FOLLOWING PERFORMANCE REQUIREMENTS:

RETAINING WALLS:

EXPOSURE CLASS	S-2
MIN. 28 DAY COMP. STRENGTH	30 MPa
MIN. 56 DAY COMP. STRENGTH	32 MPa
CEMENT TYPE	HS
MAX. W/C RATIO	0.45
MAX. AGGREGATE SIZE	20mm
ENTRAINED AIR CONTENT	4%-7%

PILE AND POLE INSTALLATION NOTES:

1. ANCHOR BOLT DIAMETER AND INSTALLATION PATTERN TO FIT POLE BASE. CONTRACTOR TO VERIFY PRIOR TO DEMOLITION OF EXISTING PILE.

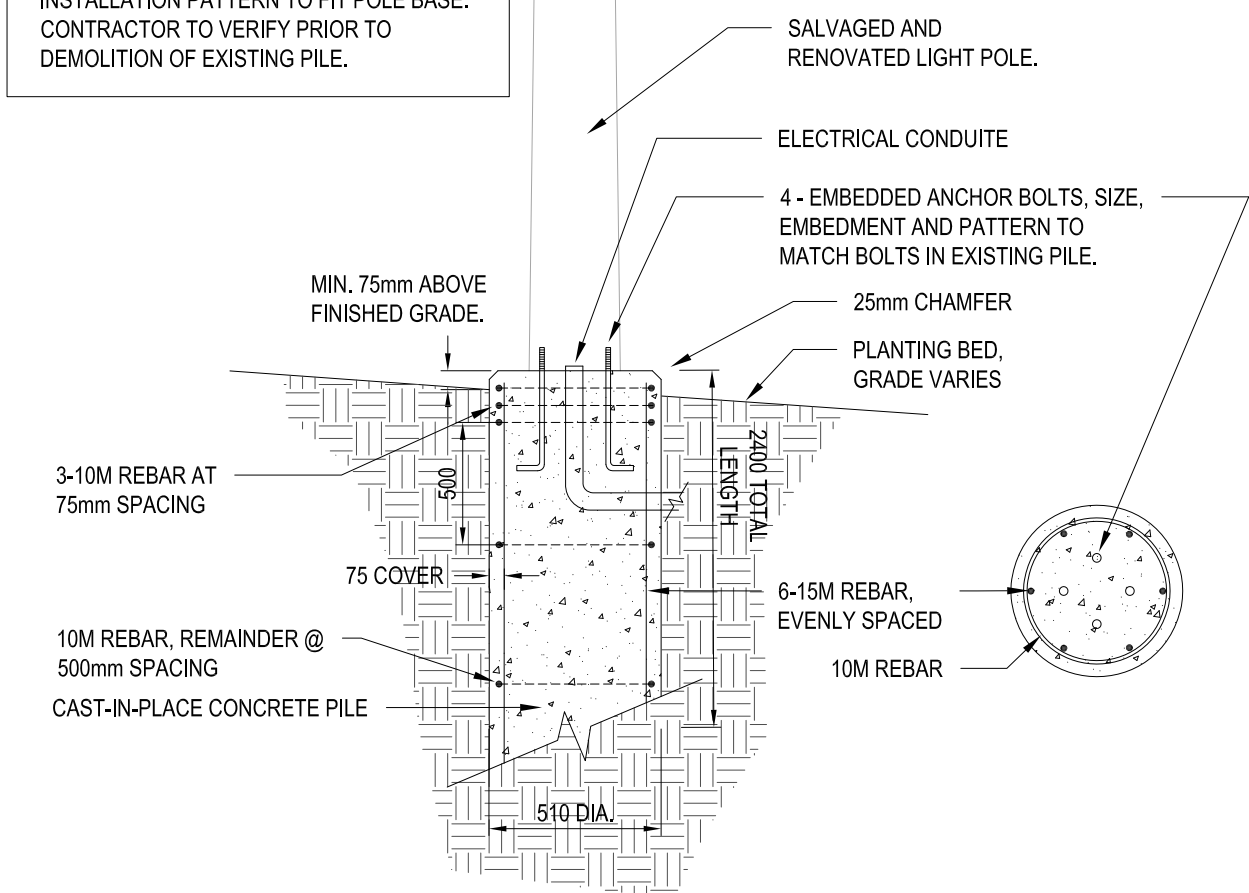

4
L-05 LIGHT PILE
SCALE - 1 : 20

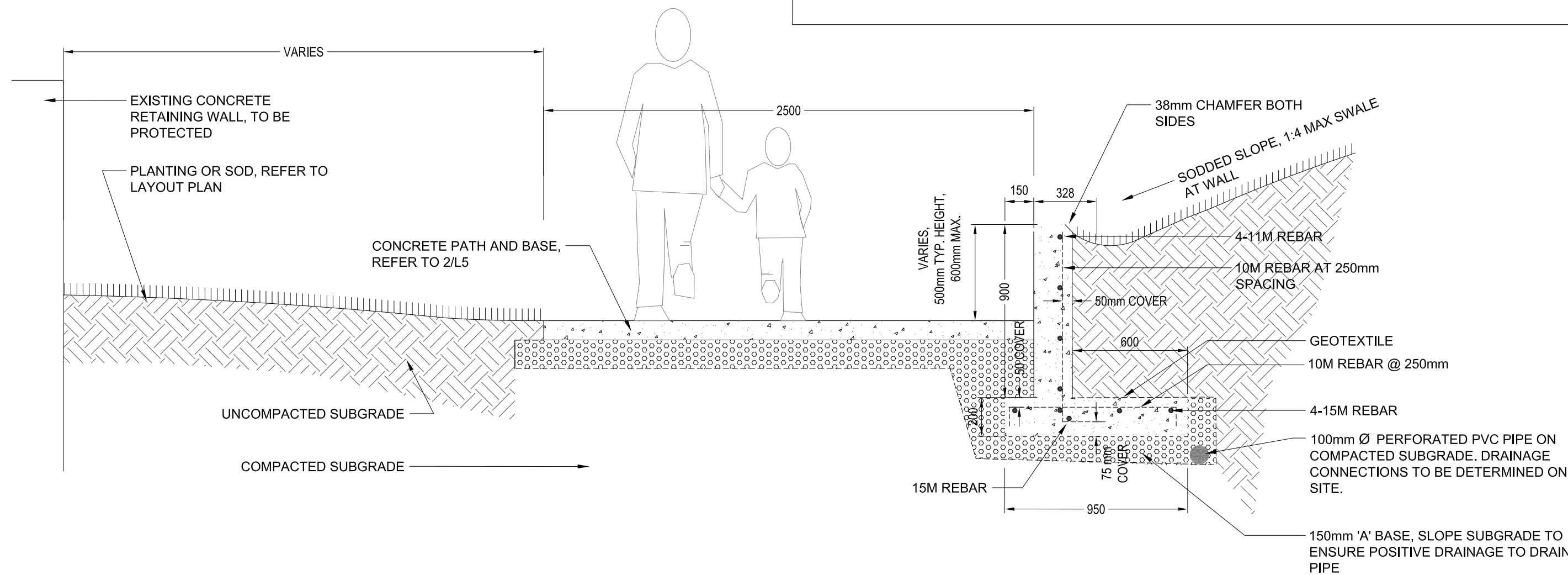

5
L-05 CONCRETE RETAINING WALL AT SLOPED PATHWAY - TYP.
SCALE - 1 : 20

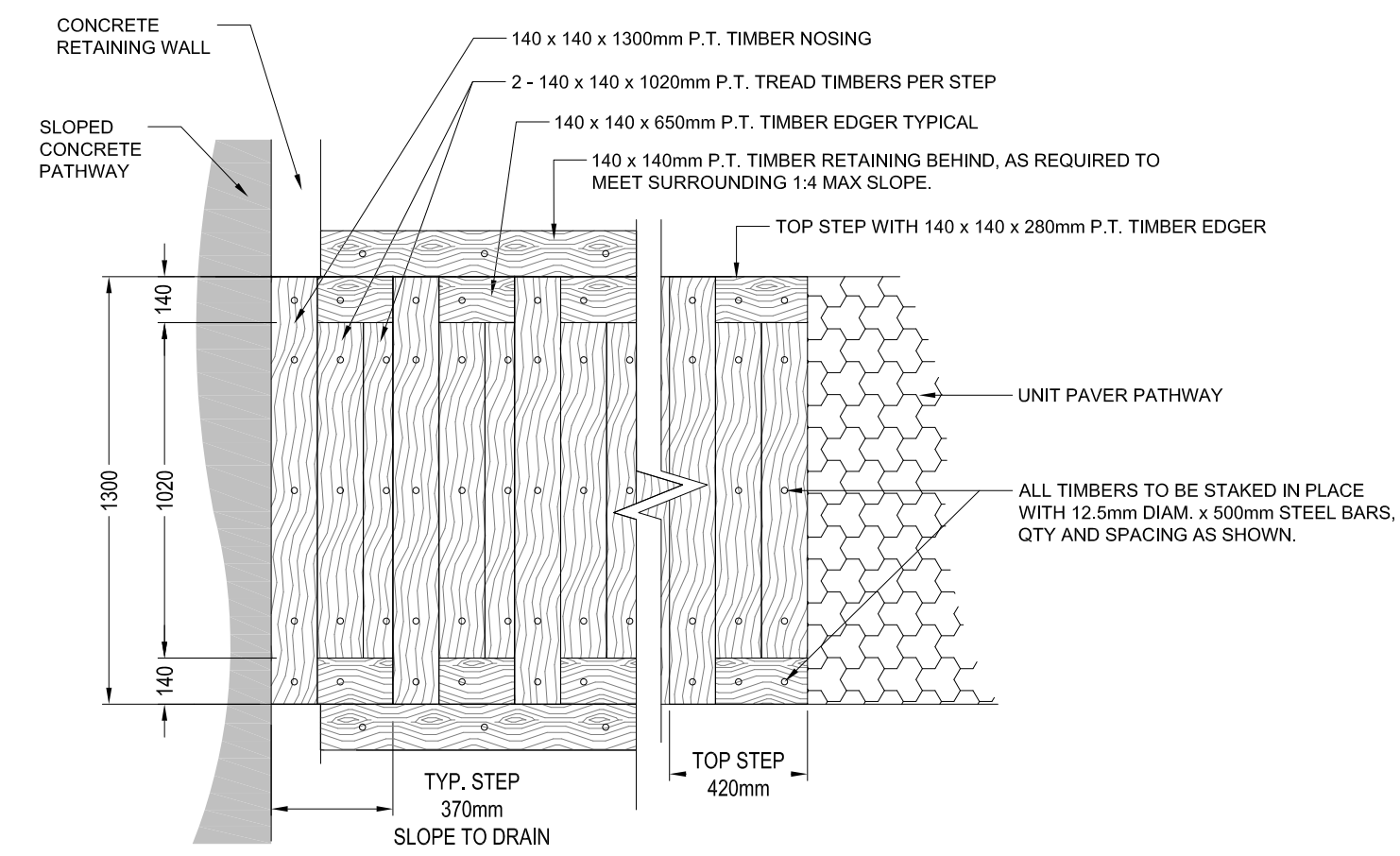

6
L-05 TIMBER STEPS - PLAN
SCALE - 1 : 20

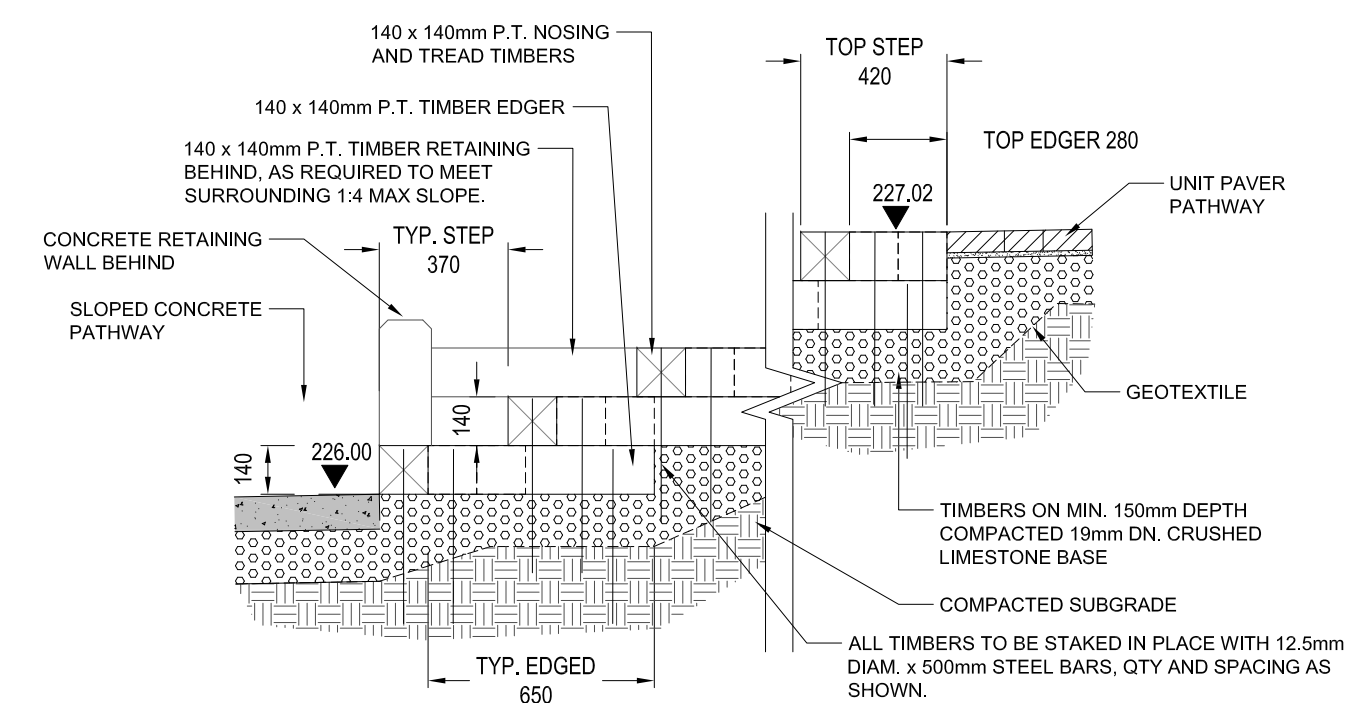

7
L-05 TIMBER STEPS - SECTION
SCALE - 1 : 20

NOTES:

**TENDER SET
NOT FOR
CONSTRUCTION**

0	13 / 07 / 05	ISSUED FOR CITY REVIEW	DKM
REV	YY / MM / DD	DESCRIPTION	BY

A. SECTION LETTER OR DETAIL NUMBER.	SEAL
B. DRAWING WHERE SECTION OR DETAIL IS DRAWN.	
OR	
A. DRAWING WHERE SECTION OR DETAIL IS INDICATED.	
SECTION OR DETAIL SHOWN ON SAME DRAWING.	

SCATLIFF + MILLER + MURRAY Inc.
TEL 204 927-3444
FAX 204 927-3443
1120 - 201 PORTAGE AVENUE
WINNIPEG, MB, CANADA

CLIENT
CITY OF WINNIPEG

PROJECT
**PEGUIS PAVILION
LANDSCAPING**

TITLE
DETAILS

DESIGN	DRAWN	DATE - Y / M / D	SCALE
JW / AH	AH	13/07/05	AS NOTED
CHECKED	APPROVED	JOB NO.	DRAWING NO.
DKM	DKM	12-0107-002	L-05