

C-368 DESJARDINS DRIVE CULVERT
N.T.S.

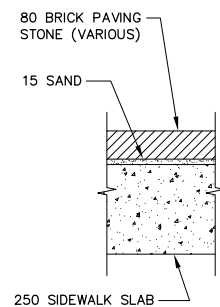

PAVING DETAIL (TYP)
N.T.S.

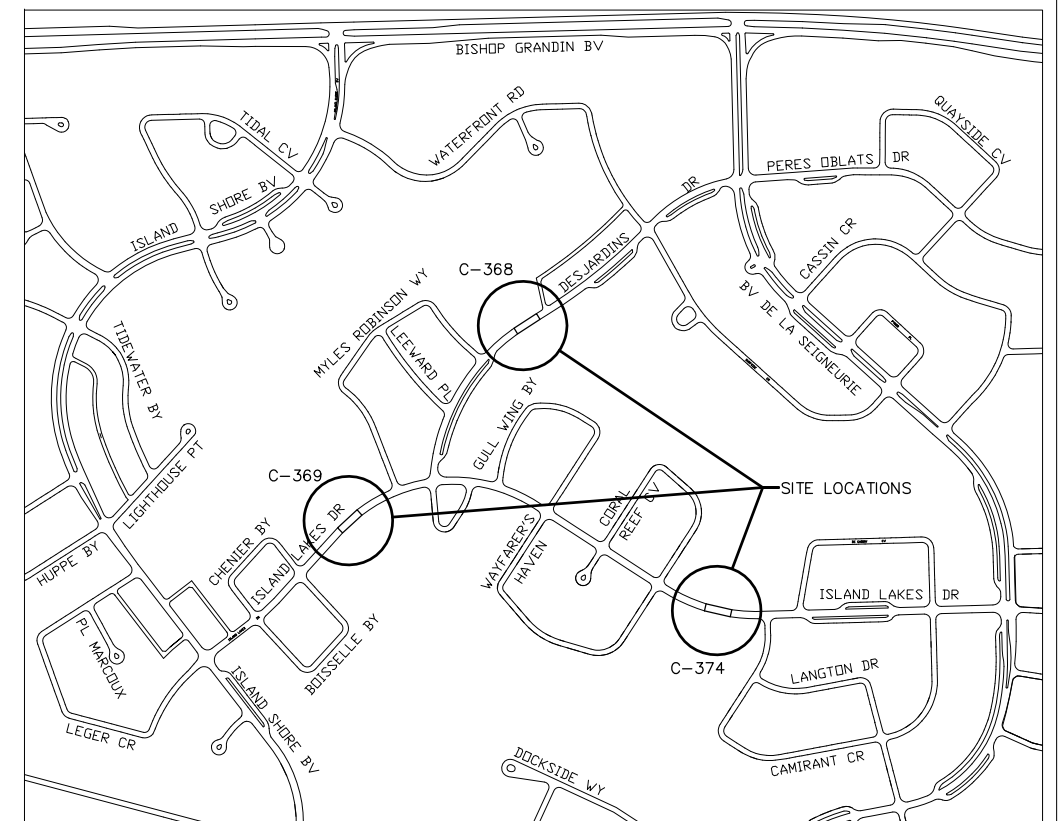

LOCATION PLAN

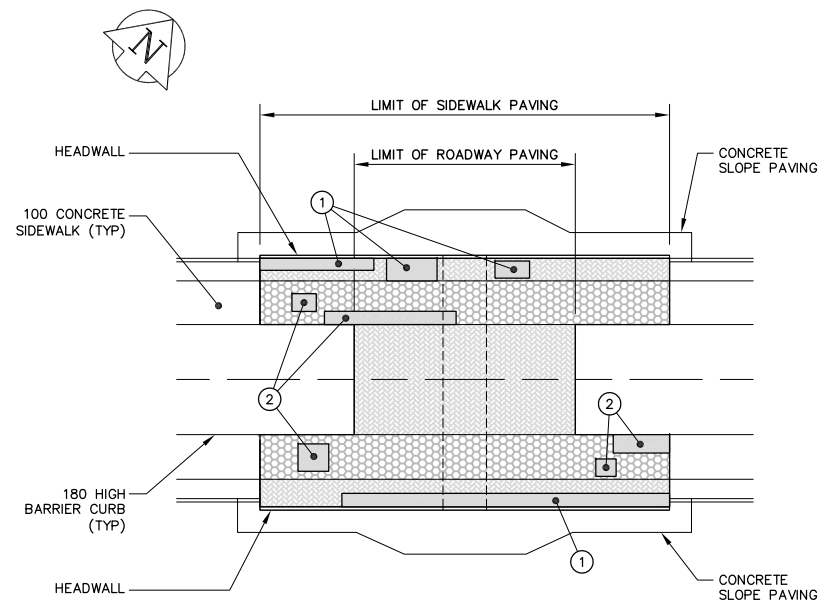

C-369 ISLAND LAKES DRIVE CULVERT
N.T.S.

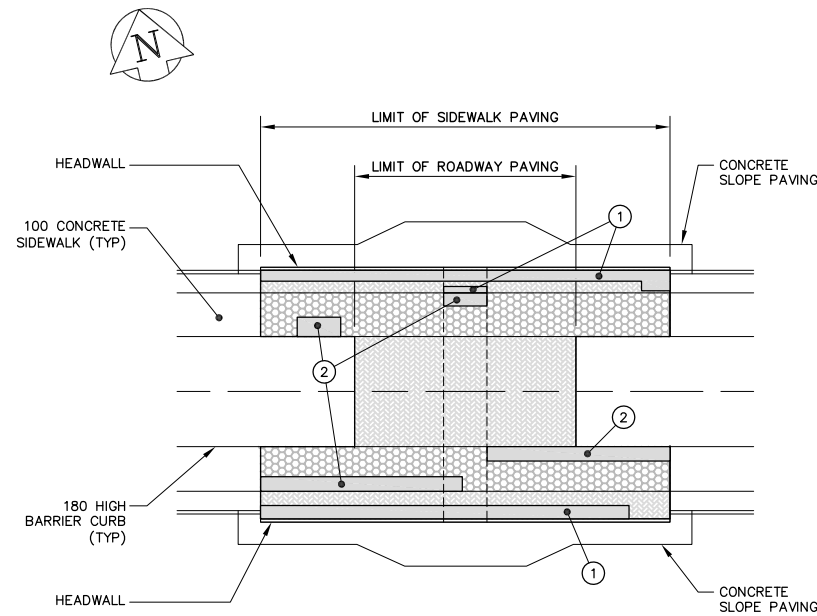

C-374 ISLAND LAKES DRIVE EAST CULVERT
N.T.S.

- ① TYPICAL REPAIR "UNISTONE" STYLE PAVING STONES
- ② TYPICAL REPAIR "HERITAGE" STYLE PAVING STONES
- ③ ROADWAY "UNISTONE" STYLE PAVING STONES
- 200 REQUIRED - LOCATIONS VARY

STRUCTURE NO.	AREA OF PAVER REPAIRS	
	UNISTONE	HERITAGE
C-368	30 m ²	20 m ²
C-369	15 m ²	15 m ²
C-374	10 m ²	10 m ²

- *NOTE:**
- ISLAND LAKES PAVING STONE REPAIRS TO BE DONE AT THREE (3) LOCATIONS AS INDICATED IN THE SPECIFICATION AND LOCATION PLAN ABOVE.
 - SEE SECTION E2 OF SPECIFICATION FOR PAVER TYPES.

METRIC
WHOLE NUMBERS INDICATE MILLIMETRES
DECIMALIZED NUMBERS INDICATE METRES

NOTE:

B.M. ELEV.		DESIGNED BY:	B.A.N.
		DRAWN BY:	J.G.W.
		CHECKED BY:	B.A.N.
		APPROVED BY:	B.A.N.
		AUTHORIZED BY:	
0	ISSUED FOR TENDER	27/06/13	J.G.W.
NO.	REVISION	DATE	BY

ENGINEER'S SEAL

 BID OPPORTUNITY NO.:
 477-2013

CITY OF WINNIPEG
 PUBLIC WORKS DEPARTMENT
 ENGINEERING DIVISION

NORWOOD BRIDGE AND ISLAND LAKES
 STONE PAVER RE-LEVELING

GENERAL ARRANGEMENTS AND
 TYPICAL PAVER REPAIRS

SHEET 1 OF 1
 HORIZONTAL: N.T.S.
 VERTICAL: N.T.S.
 CITY DRAWING NUMBER:
 C368/369/374-2013-01