

TYPICAL CROSS SECTION

REFERENCE NOTES

- A. PAVEMENT DIMENSIONS ARE TO BACK OF CURB
- B. BASELINE IS CENTRE LINE RIGHT-OF-WAY
- C. PROPERTY LINES OBTAINED FROM CITY OF WINNIPEG L.B.I.S., AND NO SCALE FACTOR WAS APPLIED
- D. REFER TO AECOM FIELD BOOK NO. 4794

CONSTRUCTION NOTES

1. REMOVE EXISTING CONCRETE PAVEMENT AND CONSTRUCT NEW 150mm REINFORCED CONCRETE PAVEMENT
2. REMOVE EXISTING CONCRETE PAVEMENT AND CONSTRUCT NEW 200mm CONCRETE PAVEMENT WITH 50mm ASPHALTIC PAVEMENT (TYPE 1A)
3. CONSTRUCT NEW BARRIER CURB (180mm HT. SEPARATE)
4. CONSTRUCT NEW MODIFIED BARRIER CURB (180mm HT. INTEGRAL)
5. CONSTRUCT NEW CURB RAMP (10mm HT. INTEGRAL)
6. RENEW EXISTING 100mm CONCRETE SIDEWALK
7. INSTALL DETECTABLE WARNING SURFACE TILE
8. INSTALL NEW CURB AND GUTTER INLET c/w CATCH BASIN (SD-024) AND CONNECT TO EXISTING 450SRS
9. REMOVE EXISTING COVER AND PLACE NEW SOLID COVER (AP-005)
10. REMOVE EXISTING CATCH BASIN AND ABANDON EXISTING LEAD
11. REMOVE EXISTING CURB INLET AND CATCH BASIN AND ABANDON EXISTING LEAD
12. INSTALL 150mm SUBDRAIN
13. ADJUST EXISTING MANHOLE/CATCH BASIN TO GRADE
14. INSTALL NEW CAST IRON RISER RING
15. ADJUST EXISTING WATER VALVE TO GRADE
16. ADJUST EXISTING CURB STOP

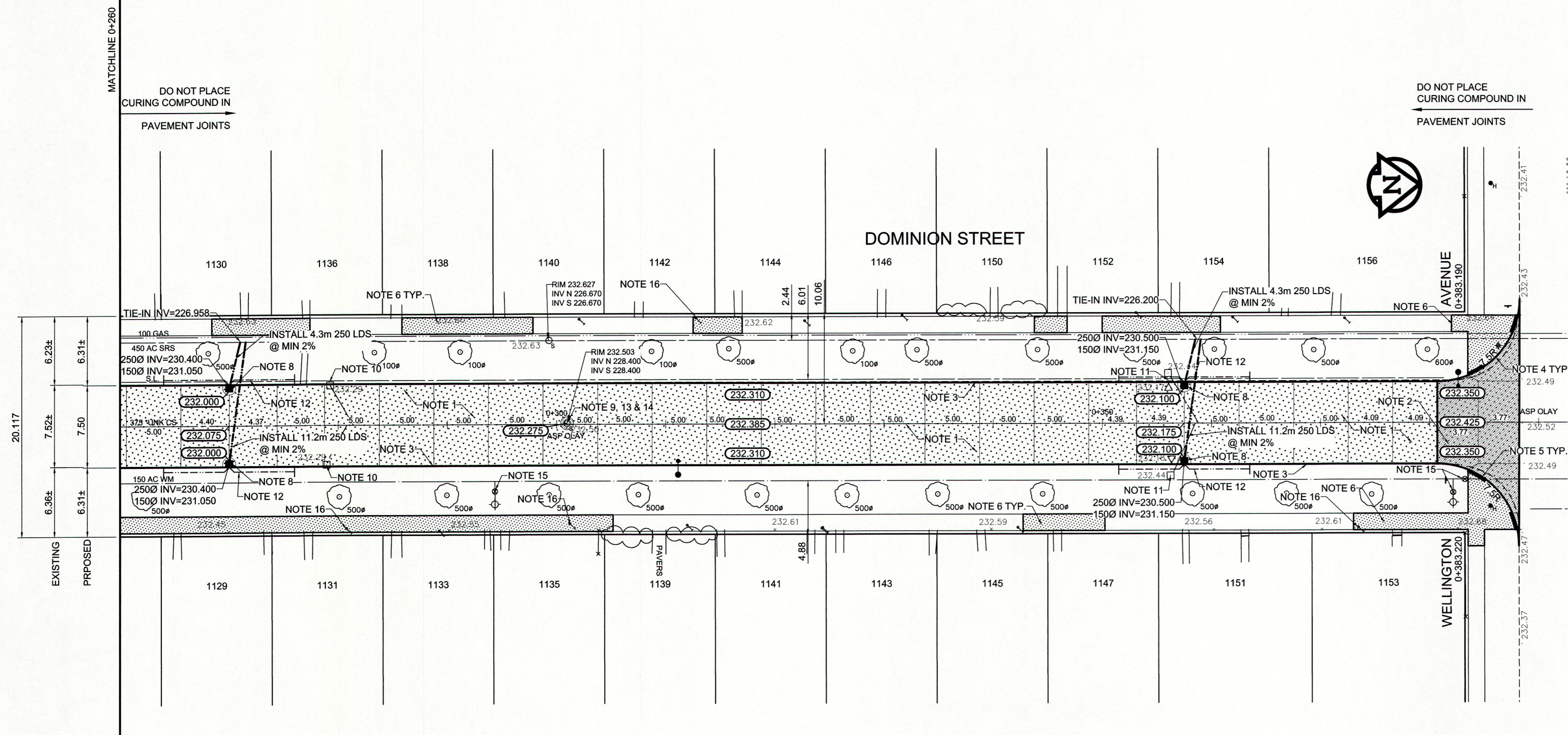

METRIC
WHOLE NUMBERS INDICATE MILLIMETRES
DECIMALIZED NUMBERS INDICATE METRES

150mm W.M.	WATERMAIN	150mm W.M.	HYDRO	— — — — —	— — — — —	— — — — —	— — — — —	— — — — —
300mm L.D.S.	HYDRANT	300mm L.D.S.	M.T.S.	— — — — —	— — — — —	— — — — —	— — — — —	— — — — —
250mm W.W.S.	VALVE	250mm W.W.S.	CONCRETE	— — — — —	— — — — —	— — — — —	— — — — —	— — — — —
	LAND DRAINAGE SEWER		ASPHALT	— — — — —	— — — — —	— — — — —	— — — — —	— — — — —
	WASTEWATER SEWER		PROPERTY LINE	— — — — —	— — — — —	— — — — —	— — — — —	— — — — —
	MANHOLE		SURVEY BAR	— — — — —	— — — — —	— — — — —	— — — — —	— — — — —
	CATCH BASIN		ELEVATION	— — — — —	— — — — —	— — — — —	— — — — —	— — — — —
	CURB INLET		TREE	— — — — —	— — — — —	— — — — —	— — — — —	— — — — —
	JUNCTIONS		SIDEWALK RAMP	— — — — —	— — — — —	— — — — —	— — — — —	— — — — —
	CULVERT		CONCRETE SIDEWALK	— — — — —	— — — — —	— — — — —	— — — — —	— — — — —
	GAS		FENCE	— — — — —	— — — — —	— — — — —	— — — — —	— — — — —
EXISTING	LEGEND - PLAN	PROPOSED	EXISTING	LEGEND - PLAN	PROPOSED	EXISTING	LEGEND - PROFILE	PROPOSED

LOCATION APPROVED UNDERGROUND STRUCTURES

SUPV. U/G STRUCTURES COMMITTEE DATE

NOTE: LOCATION OF UNDERGROUND STRUCTURES AS SHOWN ARE BASED ON THE BEST INFORMATION AVAILABLE. BUT NO GUARANTEE IS GIVEN THAT ALL EXISTING UTILITIES ARE SHOWN OR THAT THE GIVEN LOCATIONS ARE EXACT. CONFIRMATION OF EXISTENCE AND EXACT LOCATION OF ALL SERVICES MUST BE OBTAINED FROM THE INDIVIDUAL UTILITIES BEFORE PROCEEDING WITH CONSTRUCTION.

B.M. 36-014	Bolt in 7.3m Conc. pile, 2.2m S. of S.L. of ELEV. 232.151	Wellington Ave. & 2.4m W. of E.L. of Lipton St.	
NO.	ISSUED FOR TENDER	05/30/2013	BC
A	ISSUED FOR REVIEW	05/17/2013	BC
NO.	REVISIONS	DATE	BY

AECOM	
DESIGNED BY	BC
CHECKED BY	KWR
DRAWN BY	SS
APPROVED BY	
HOR. SCALE:	1:250
VERTICAL:	1:10
RELEASSED FOR CONSTRUCTION BY:	
DATE	MAY 2013
DATE	

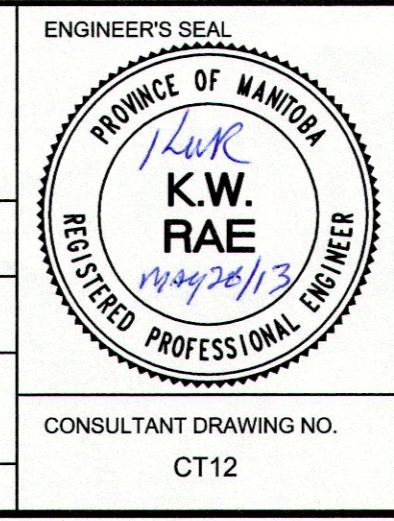

THE CITY OF WINNIPEG
PUBLIC WORKS DEPARTMENT
ENGINEERING DIVISION

2013 LOCAL STREET RENEWAL PROGRAM

DOMINION ST. - WELLINGTON AVE TO SARGENT AVE.
PAVEMENT RECONSTRUCTION
STATION 0+260 TO WELLINGTON AVE.

CITY DRAWING NUMBER
SHEET 12 OF 16

CONSULTANT DRAWING NO. CT12