

SEE DRAWING C0110

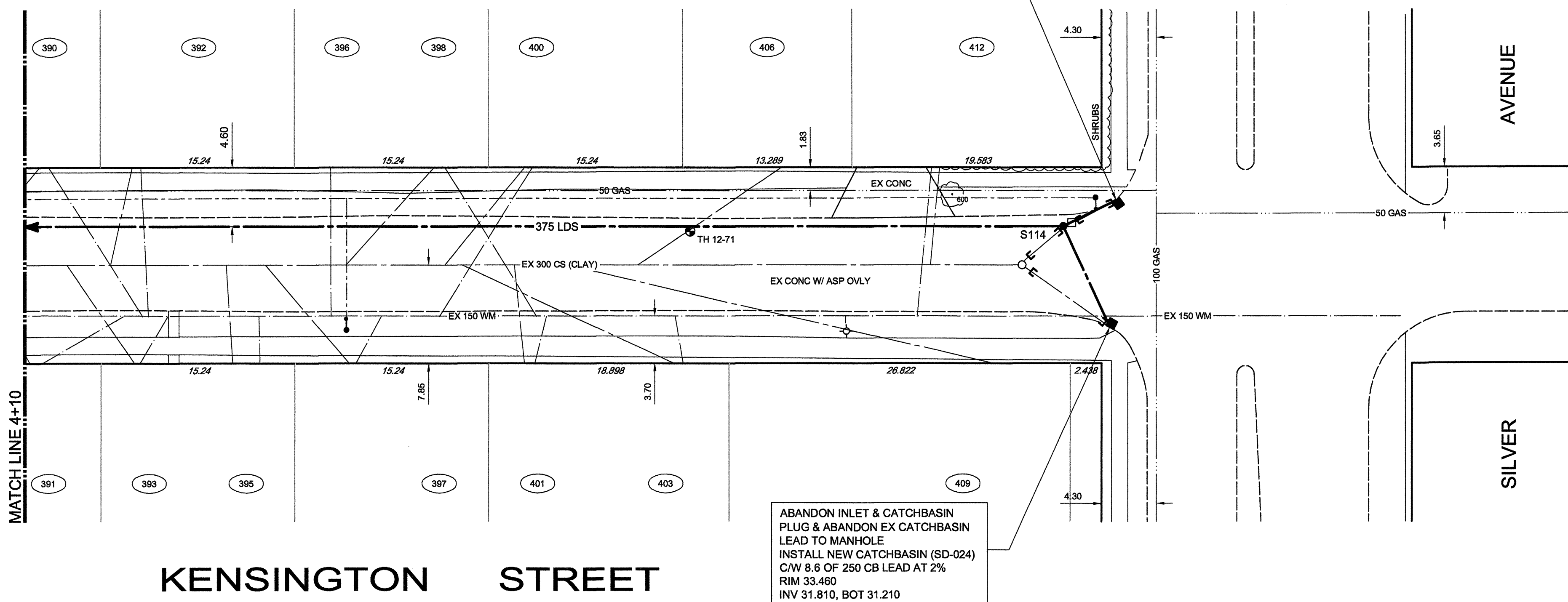

- CONSTRUCTION NOTES:**
1. LOCATION OF ALL SEWER AND WATER LINES TO BE CONFIRMED IN THE FIELD.
 2. SEWER AND WATER SERVICES SHOWN ON DRAWINGS ARE APPROXIMATE ONLY.
 3. INSTALL NEW SEWER AND CATCHBASIN LEADS BY TRENCHLESS METHODS, UNLESS NOTED OTHERWISE.
 4. ALL SHAFTS ON NESS AVENUE TO HAVE CLASS 1 BACKFILL.
 5. INSTALL TYPE 'B' RISERS ON CATCHBASIN LEADS AS DIRECTED BY THE CONSULTANT.
- GENERAL NOTES:**
1. CHAINAGE IS ALONG WEST LIMIT OF KENSINGTON STREET.
 2. STATION 1+00 = NORTH LIMIT OF NESS AVENUE
 3. SEE DRAWINGS C0120 TO C0126 FOR TRAFFIC STAGING ON NESS AVENUE AND CENTURY STREET.
 4. SEE SPECIFICATIONS FOR DETAILED TEST HOLE INFORMATION.

APEGM
Certificate of Authorization
TETRA TECH WEI Inc.
No. 5313 Date: April 30, 2014

WARNING
IF POWER EQUIPMENT OR EXPLOSIVES ARE TO BE USED FOR EXCAVATION ON THIS PROJECT THE CONTRACTOR MUST:
1. NOTIFY THE GAS COMPANY OF THE PROPOSED LOCATION OF EXCAVATION.
2. TAKE PRECAUTION TO AVOID DAMAGE TO GAS COMPANY INSTALLATIONS. SEE PROVINCIAL REGULATION 14092 FOR DETAILS.

PRELIMINARY DRAWING
NOT TO BE USED FOR CONSTRUCTION

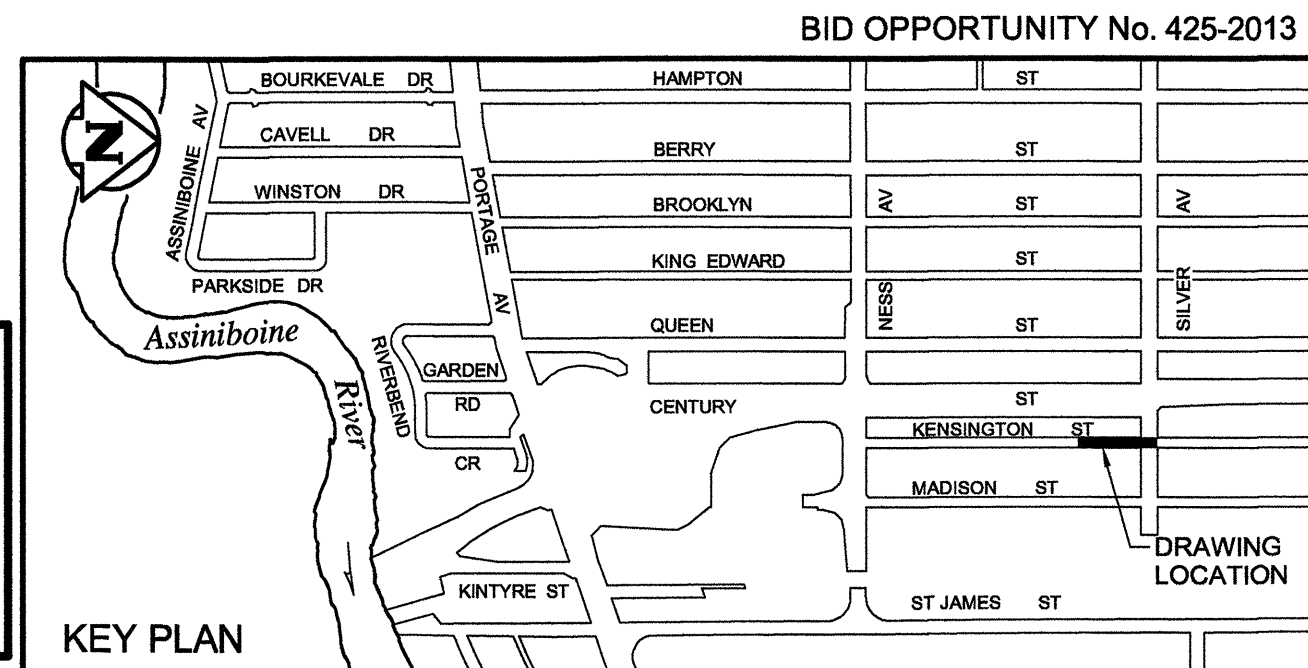

EXISTING	LEGEND-PLAN	PROPOSED	EXISTING	LEGEND-PLAN	PROPOSED	EXISTING	LEGEND-PLAN	PROPOSED
150 WM	WATERMAIN	150 WM	ANCHOR	ANCHOR	ANCHOR	15.240	LEGAL DIMENSION	LEGAL DIMENSION
400 FM	FEEDERMAIN	400 FM	TREE	TREE	TREE			
300 LDS	LAND DRAINAGE SEWER	300 LDS	SURVEY BAR	SURVEY BAR	SURVEY BAR			
250 WWS	WASTEWATER SEWER	250 WWS	TRAFFIC SIGNAL	TRAFFIC SIGNAL	TRAFFIC SIGNAL			
300 CS	COMBINED SEWER	300 CS	GAS	GAS	GAS			
200 FCM	FORCEMAIN	200 FCM	HYDRO	HYDRO	HYDRO			
JUNCTIONS	JUNCTIONS	JUNCTIONS	MTS	MTS	MTS			
HYDRANT	HYDRANT	HYDRANT	SIDEWALK	SIDEWALK	SIDEWALK			
VALVE	VALVE	VALVE	CURB	CURB	CURB			
REDUCER	REDUCER	REDUCER						

LOCATION APPROVED UNDERGROUND STRUCTURES

SUPV. U/G STRUCTURES COMMITTEE DATE

NOTE:
LOCATION OF UNDERGROUND STRUCTURES AS SHOWN ARE BASED ON THE BEST INFORMATION AVAILABLE. BUT NO GUARANTEE IS GIVEN THAT ALL EXISTING UTILITIES ARE SHOWN OR THAT THE GIVEN LOCATIONS ARE EXACT. CONFIRMATION OF EXISTENCE AND EXACT LOCATION OF ALL SERVICES MUST BE OBTAINED FROM THE INDIVIDUAL UTILITIES BEFORE PROCEEDING WITH CONSTRUCTION.

NO.	REVISIONS	DATE	BY
01	ISSUED FOR TENDER	13.05.13	BLM
01	ISSUED FOR APPROVAL	13.05.10	BLM

TETRA TECH

DESIGNED BY: KJM
CHECKED BY: [Signature]
DRAWN BY: GMD
APPROVED BY: [Signature]
HOR. SCALE: 1 : 250
VERTICAL: 1 : 50
RELEASED FOR CONSTRUCTION
DATE: 12.12.17

PROVINCE OF MANITOBA
REGISTERED PROFESSIONAL ENGINEER
Member since 1992
CONSULTANT DRAWING NO. 1000120300-DWG-C0111

THE CITY OF WINNIPEG
WATER AND WASTE DEPARTMENT

FERRY ROAD AND RIVERBEND COMBINED SEWER RELIEF WORKS CONTRACT 1
KENSINGTON STREET
85m SOUTH OF SILVER AVENUE TO SILVER AVENUE

CITY DRAWING NUMBER LD-7115
SHEET 11 OF 26
C0111