

BID OPPORTUNITY NO.: 384-2013

2013 STREETS MAINTENANCE PRESERVATION PROGRAM

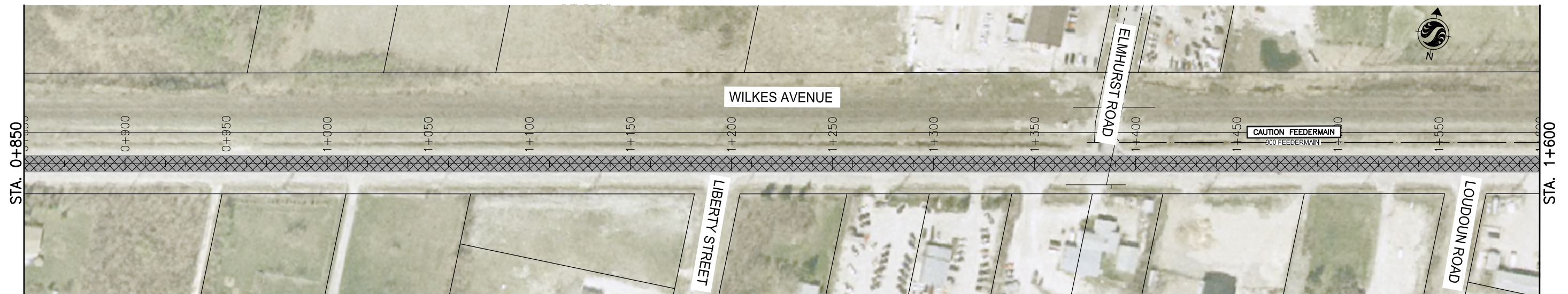
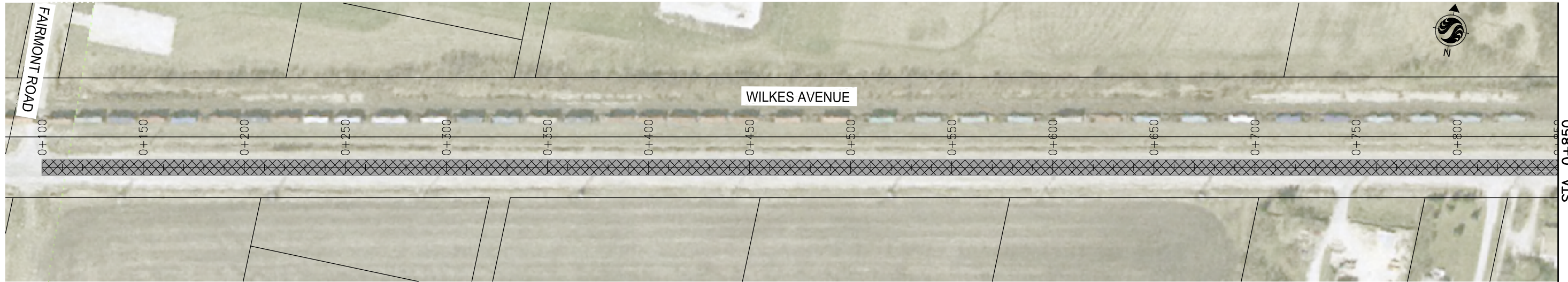

METRIC

WHOLE NUMBERS INDICATE MILLIMETRES
DECIMALIZED NUMBERS INDICATE METRES

APEGM
Certificate of Authorization
Stantec Consulting Ltd.
No. 1301

LEGEND ASPHALT OVERLAY CONCRETE PAVEMENT PRESERVATION	<table border="1"> <tr> <th colspan="4">B.M. ELEV.</th> </tr> <tr> <td> </td> <td> </td> <td> </td> <td> </td> </tr> </table>	B.M. ELEV.								Stantec Consulting Ltd. 905 Waverley Street, Winnipeg, Manitoba Tel 204-489-5900 Fax 204-453-9012	ENGINEER'S SEAL 	THE CITY OF WINNIPEG PUBLIC WORKS DEPARTMENT STREETS MAINTENANCE DIVISION	SHEET OF 1 8 CAD FILE DRAWING NUMBER 06030c-101-xxx.DWG CITY DRAWING NUMBER																			
		B.M. ELEV.																														
NOTE: LOCATION OF UNDERGROUND STRUCTURES AS SHOWN ARE BASED ON THE BEST INFORMATION AVAILABLE BUT NO GUARANTEE IS GIVEN THAT ALL EXISTING UTILITIES ARE SHOWN OR THAT THE GIVEN LOCATIONS ARE EXACT. CONFIRMATION OF EXISTENCE AND EXACT LOCATION OF ALL SERVICES MUST BE OBTAINED FROM THE INDIVIDUAL UTILITIES BEFORE PROCEEDING WITH CONSTRUCTION.	<table border="1"> <tr> <th>NO.</th> <th>REVISIONS</th> <th>DATE</th> <th>BY</th> </tr> <tr> <td>1</td> <td>ISSUED FOR TENDER</td> <td>13/05/06</td> <td>S.B.C.</td> </tr> <tr> <td>0</td> <td>ISSUED FOR REVIEW</td> <td>13/04/16</td> <td>V.M.M.</td> </tr> </table>	NO.	REVISIONS	DATE	BY	1	ISSUED FOR TENDER	13/05/06	S.B.C.	0	ISSUED FOR REVIEW	13/04/16	V.M.M.	<table border="1"> <tr> <td>DESIGNED BY</td> <td>B.Q.D.</td> <td>CHECKED BY</td> <td>D.J.M.</td> </tr> <tr> <td>DRAWN BY</td> <td>B.Q.D.</td> <td>APPROVED BY</td> <td>S.B.C.</td> </tr> <tr> <td>HOR. SCALE:</td> <td>1:2000</td> <td>RELEASED FOR CONSTRUCTION:</td> <td> </td> </tr> <tr> <td>VERTICAL:</td> <td>--</td> <td>DATE</td> <td> </td> </tr> </table>	DESIGNED BY	B.Q.D.	CHECKED BY	D.J.M.	DRAWN BY	B.Q.D.	APPROVED BY	S.B.C.	HOR. SCALE:	1:2000	RELEASED FOR CONSTRUCTION:		VERTICAL:	--	DATE		CONSULTANT DRAWING NO. C-101	WILKES AVENUE FAIRMONT RD. TO SHAFTESBURY BLVD. STA. 0+100 TO STA. 1+600 ASPHALT OVERLAY
NO.	REVISIONS	DATE	BY																													
1	ISSUED FOR TENDER	13/05/06	S.B.C.																													
0	ISSUED FOR REVIEW	13/04/16	V.M.M.																													
DESIGNED BY	B.Q.D.	CHECKED BY	D.J.M.																													
DRAWN BY	B.Q.D.	APPROVED BY	S.B.C.																													
HOR. SCALE:	1:2000	RELEASED FOR CONSTRUCTION:																														
VERTICAL:	--	DATE																														