

NOTE: CHAINAGES SHOWN ARE ALONG W. R. OF EDMONTON ST.

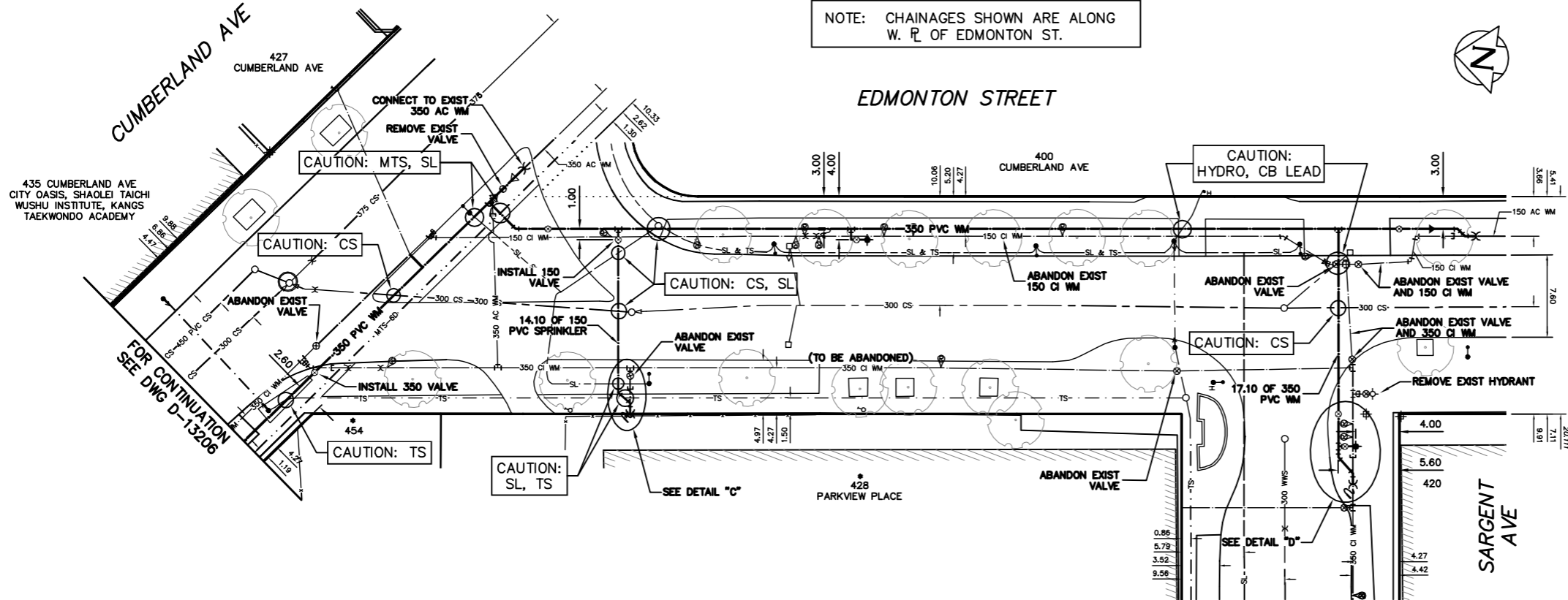

WATER SERVICE INFORMATION					
ADDRESS	SIZE (mm) MATERIAL (STREET)	SIZE (mm) MATERIAL (PROP.)	SHORT & LONG MEASUREMENT	CORP. LOCATION	REMARKS
420 EDMONTON ST COMMERCIAL	150 AC	150 AC	19.06 WEL BLDG	OPP VALVE	-
420 EDMONTON ST COMMERCIAL	150 DI	150 DI	21.96 WEL BLDG	OPP VALVE	-
428 EDMONTON ST COMMERCIAL	150 DI	150 DI	24.84 WEL EDMONTON	OPP VALVE	-
428 EDMONTON ST COMMERCIAL	150 CI	150 PVC	2.74 SNL BLDG	OPP VALVE	RENEW TO R. W/ 150 PVC
428 EDMONTON ST COMMERCIAL	150 PVC	150 PVC	29.13 SSL CUMBERLAND	OPP VALVE	SERV. OFF SARGENT
428 EDMONTON ST COMMERCIAL	150 PVC	150 PVC	5.60 WEL BLDG	OPP VALVE	SERV. OFF SARGENT
454 EDMONTON ST COMMERCIAL	20	20	8.72 WEL EDMONTON	OPP VALVE	SERV. OFF CUMBERLAND
454 EDMONTON ST COMMERCIAL	20	20	4.35 E OF NW CRN HSE	0.2 W OF S/C	SERV. OFF CUMBERLAND
454 EDMONTON ST COMMERCIAL	150	150	12.95 WEL EDMONTON	RECONNECT SERVICE	SERV. OFF CUMBERLAND
454 EDMONTON ST COMMERCIAL	150	150	2.51 E OF NW CRN HSE	OPP VALVE	SERV. OFF CUMBERLAND
454 EDMONTON ST COMMERCIAL	150	150	15.35 WEL EDMONTON	OPP VALVE	RENEW TO R. W/ 150 PVC
400 CUMBERLAND AVE PARK	-	-	-	-	-
427 CUMBERLAND AVE COMMERCIAL	25 COPPER	25 COPPER	5.09 WEL BLDG	5.9 E OF S/C	RECONNECT SERVICE
427 CUMBERLAND AVE COMMERCIAL	25 COPPER	25 COPPER	37.42 EEL EDMONTON	-	RECONNECT SERVICE

* SERVICES TO BE RENEWED TO R. ALL OTHERS TO BE RECONNECTED

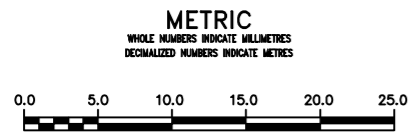

WARNING
IF POWER EQUIPMENT OR EXPLOSIVES ARE TO BE USED FOR EXCAVATION ON THIS PROJECT THE CONTRACTOR MUST:
1) NOTIFY THE GAS COMPANY OF THE PROPOSED LOCATION OF EXCAVATION.
2) TAKE PRECAUTION TO AVOID DAMAGE TO GAS COMPANY INSTALLATIONS.
SEE PROVINCIAL REGULATION 210/72 FOR DETAILS

LOCATION APPROVED UNDERGROUND STRUCTURES
SUPV. U/G STRUCTURES COMMITTEE DATE
NOTE:
LOCATION OF UNDERGROUND STRUCTURES AS SHOWN ARE BASED ON THE BEST INFORMATION AVAILABLE BUT NO GUARANTEE IS GIVEN THAT ALL EXISTING UTILITIES ARE SHOWN OR THAT THE GIVEN LOCATIONS ARE EXACT. CONFIRMATION OF EXISTENCE AND EXACT LOCATION OF ALL UTILITIES MUST BE OBTAINED FROM THE INDIVIDUAL UTILITIES BEFORE PROCEEDING WITH CONSTRUCTION.

NO.	REVISIONS	DATE	BY

DESIGNED BY	TS	CHECKED BY	SC
DRAWN BY	CJH	APPROVED BY	KZ
SCALE:	HORIZONTAL 1:250 VERTICAL 1:50		
RELEASED FOR CONSTRUCTION	DATE 2013 04 19		

ENGINEER'S SEAL
ORIGINAL SIGNED BY K.R. ZUREK 13.04.19
CONSULTANT DRAWING NUMBER

THE CITY OF WINNIPEG
WATER AND WASTE DEPARTMENT
ENGINEERING DIVISION
2013 WATER RENEWALS
EDMONTON STREET
CUMBERLAND AVENUE TO
SARGENT AVENUE
SHEET 7 OF 10
CITY DRAWING NUMBER
D-13207