

NOTE: CHAINAGES SHOWN ARE ALONG S. R. OF CORYDON AVE.

**WATER SERVICE INFORMATION**

ADDRESS	SIZE (mm) MATERIAL (STREET)	SIZE (mm) MATERIAL (PROP.)	SHORT & LONG MEASUREMENT	CORP. LOCATION	REMARKS
1037 CORYDON AVE RESIDENTIAL	20 COPPER	20 COPPER	1.54 EWL HSE 66.69 EEL GUELPH	OPP S/C	RECONNECT SERVICE
1038 CORYDON AVE RESIDENTIAL	20 LEAD	20 LEAD	1.54 EWL HSE 64.79 EEL GUELPH	0.4 W OF S/C	RENEW TO 1/2 W/20 COPPER
1041 CORYDON AVE RESIDENTIAL	20 COPPER	20 COPPER	2.15 WEL HSE 57.65 EEL GUELPH	OPP S/C	RECONNECT SERVICE
1042 CORYDON AVE RESIDENTIAL	20 COPPER	20 COPPER	1.52 WWL HSE 52.68 EEL GUELPH	OPP S/C	RECONNECT SERVICE
1044 CORYDON AVE RESIDENTIAL	20 COPPER	12 COPPER	0.85 WEL HSE 52.19 EEL GUELPH	OPP S/C	RECONNECT SERVICE
1045 CORYDON AVE RESIDENTIAL	20 COPPER	20 COPPER	2.93 WEL HSE 41.32 EEL GUELPH	OPP S/C	RECONNECT SERVICE
1048 CORYDON AVE RESIDENTIAL	20 COPPER	20 COPPER	4.09 EWL HSE 33.26 EEL GUELPH	0.3 W OF S/C	RECONNECT SERVICE
1049 CORYDON AVE RESIDENTIAL	20 COPPER	20 COPPER	0.71 EWL HSE 28.01 EEL GUELPH	OPP S/C	RECONNECT SERVICE
1051 CORYDON AVE RESIDENTIAL	20 COPPER	20 COPPER	2.75 EWL HSE 19.03 EEL GUELPH	0.9 E OF S/C	RECONNECT SERVICE
1052 CORYDON AVE RESIDENTIAL	20 COPPER	20 COPPER	6.64 WEL HSE 19.31 EEL GUELPH	1.3 W OF S/C	RECONNECT SERVICE
1056 CORYDON AVE RESIDENTIAL	20 COPPER	20 COPPER	4.09 EWL HSE 6.39 EEL GUELPH	OPP S/C	RECONNECT SERVICE
217 GUELPH ST RESIDENTIAL	25 COPPER	25 LEAD	3.47 WEL HSE 11.40 EEL GUELPH	OPP S/C	SERV. OFF CORYDON RECONNECT SERVICE

\* SERVICES TO BE RENEWED TO R. ALL OTHERS TO BE RECONNECTED

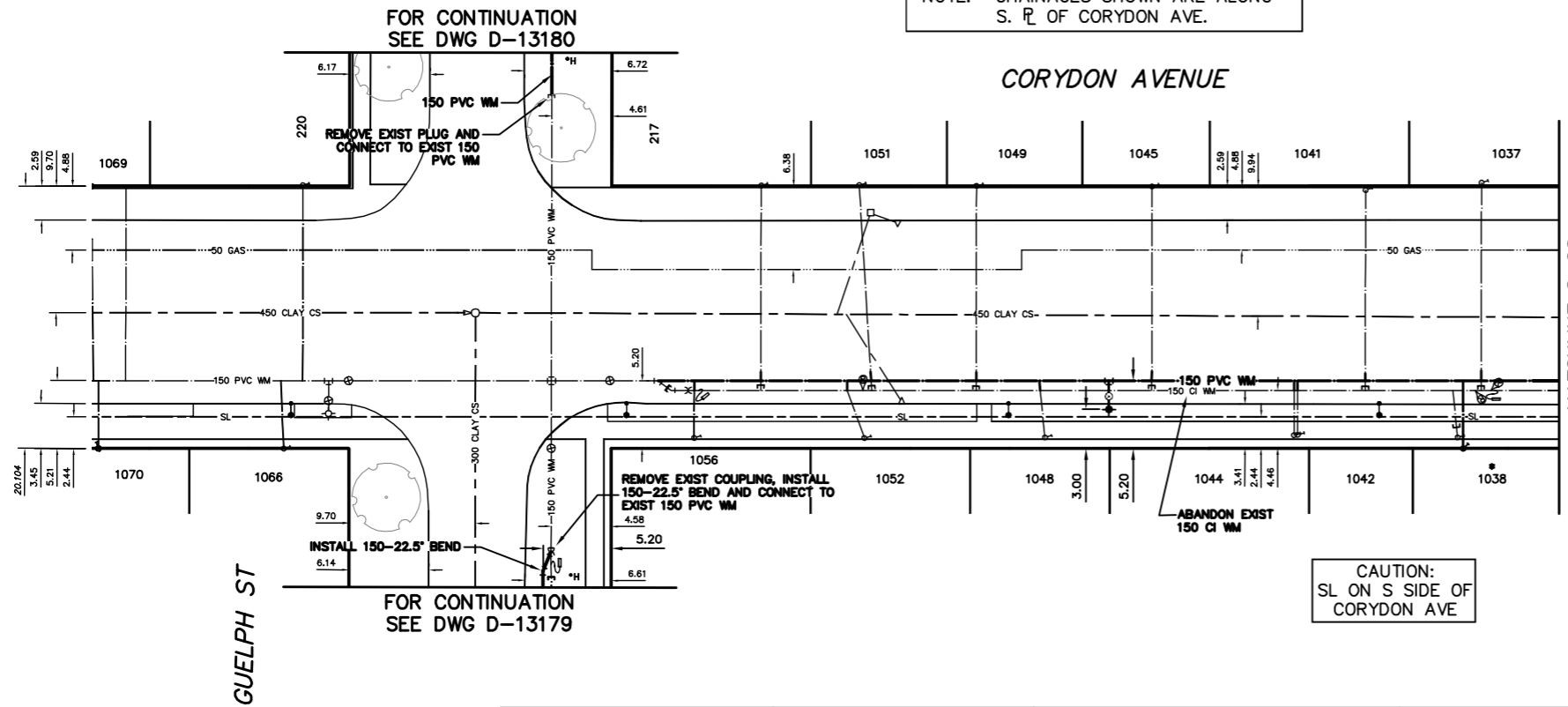

MATCHLINE 2+00 SEE DWG D-13178

CAUTION: SL ON S SIDE OF CORYDON AVE

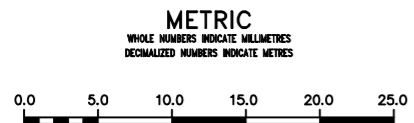

**WARNING**  
IF POWER EQUIPMENT OR EXPLOSIVES ARE TO BE USED FOR EXCAVATION ON THIS PROJECT THE CONTRACTOR MUST:  
1) NOTIFY THE GAS COMPANY OF THE PROPOSED LOCATION OF EXCAVATION.  
2) TAKE PRECAUTION TO AVOID DAMAGE TO GAS COMPANY INSTALLATIONS.  
SEE PROVINCIAL REGULATION 210/72 FOR DETAILS

**LOCATION APPROVED UNDERGROUND STRUCTURES**  
SUPV. U/G STRUCTURES COMMITTEE DATE  
NOTE: LOCATION OF UNDERGROUND STRUCTURES AS SHOWN ARE BASED ON THE BEST INFORMATION AVAILABLE BUT NO GUARANTEE IS GIVEN THAT ALL EXISTING UTILITIES ARE SHOWN OR THAT THE GIVEN LOCATIONS ARE EXACT. CONFIRMATION OF EXISTENCE AND EXACT LOCATION OF ALL SERVICES MUST BE OBTAINED FROM THE INDIVIDUAL UTILITIES BEFORE PROCEEDING WITH CONSTRUCTION.

B.M. ELEV.	
CONSTRUCTION COMPLETION DATE: YYYY MM DD	
DESIGNED BY	RD
CHECKED BY	SC
DRAWN BY	CJH
APPROVED BY	KZ
SCALE:	
HORIZONTAL	1:250
VERTICAL	1:50
RELEASED FOR CONSTRUCTION	K.R. ZUREK
DATE	2013 04 09
DATE	13.04.09
PLOT DATE:	2013 04 09

ENGINEER'S SEAL	
ORIGINAL SIGNED BY S.R.J. COURNOYER 13.04.08	
CONSULTANT DRAWING NUMBER	

**THE CITY OF WINNIPEG**  
WATER AND WASTE DEPARTMENT  
ENGINEERING DIVISION

2013 WATER RENEWALS

CORYDON AVENUE  
GUELPH STREET TO  
75 W OF HARROW STREET

SHEET 4 OF 15  
CITY DRAWING NUMBER  
D-13177

VALVES TO BE COUNTER-CLOCKWISE TO CLOSE (RED OPERATING NUT)