

D SIZE 22" x 34" (558mm x 864mm)

PLOT: 3/25/2013 2:18:09 PM

AECOM FILE NAME: P:\60219315\000-CADD\040-CADD\DWG-SHEETS\0302-SHT-00-Con3-C-0006_C-0009.dwg Saved

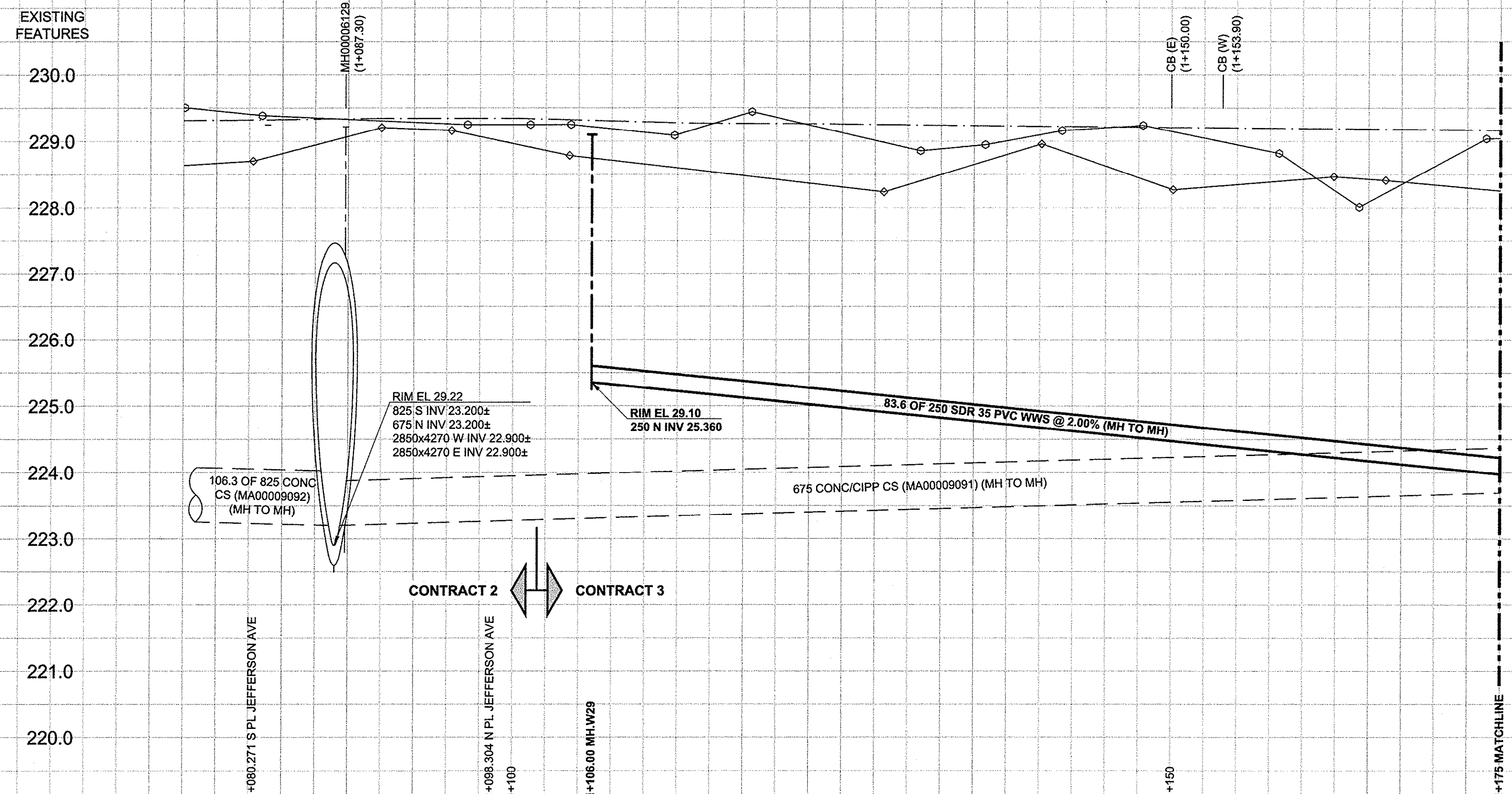

230.0
229.0
228.0
227.0
226.0
225.0
224.0
223.0
222.0
221.0
220.0

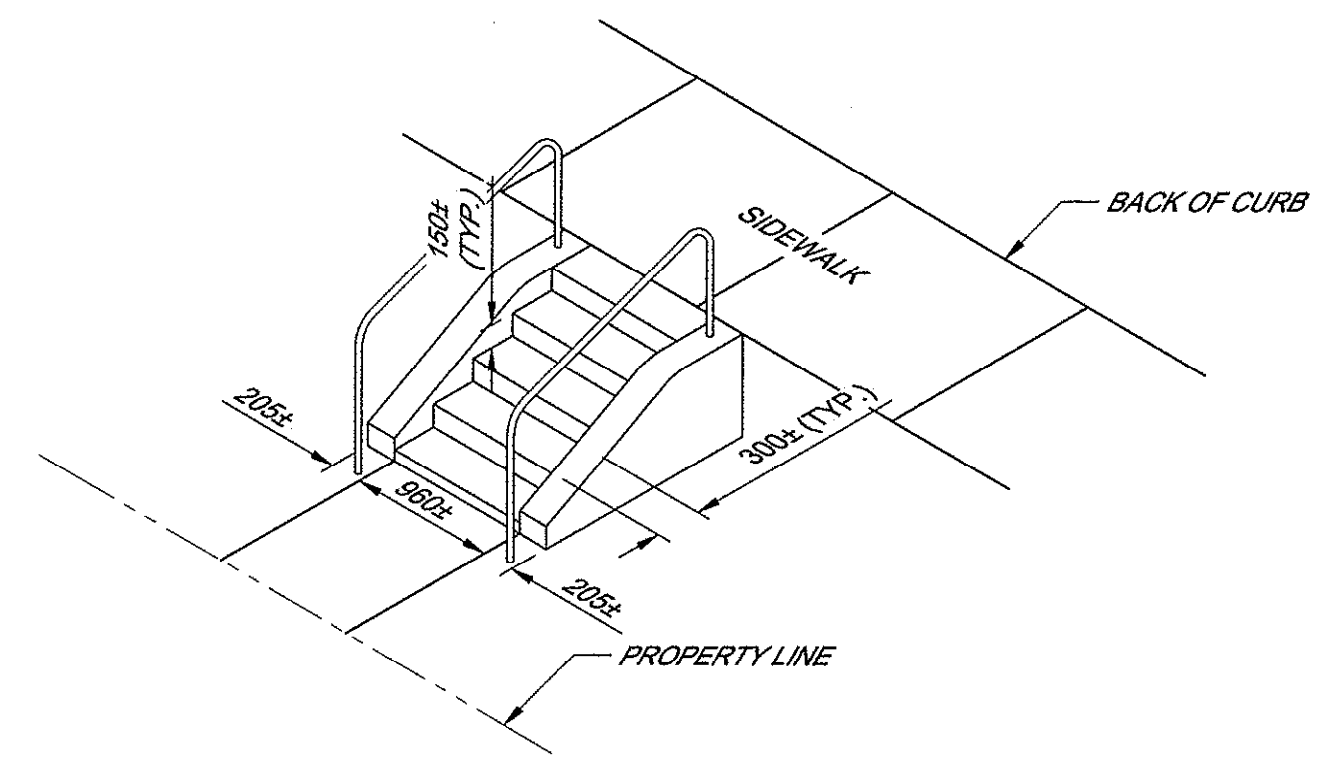

DETAIL
1
10504, 10505, 10506
0 0.5 1 1.5 m SCALE 1:50
TYPICAL EXISTING STAIRCASE
VARIOUS SCOTIA STREET ADDRESS

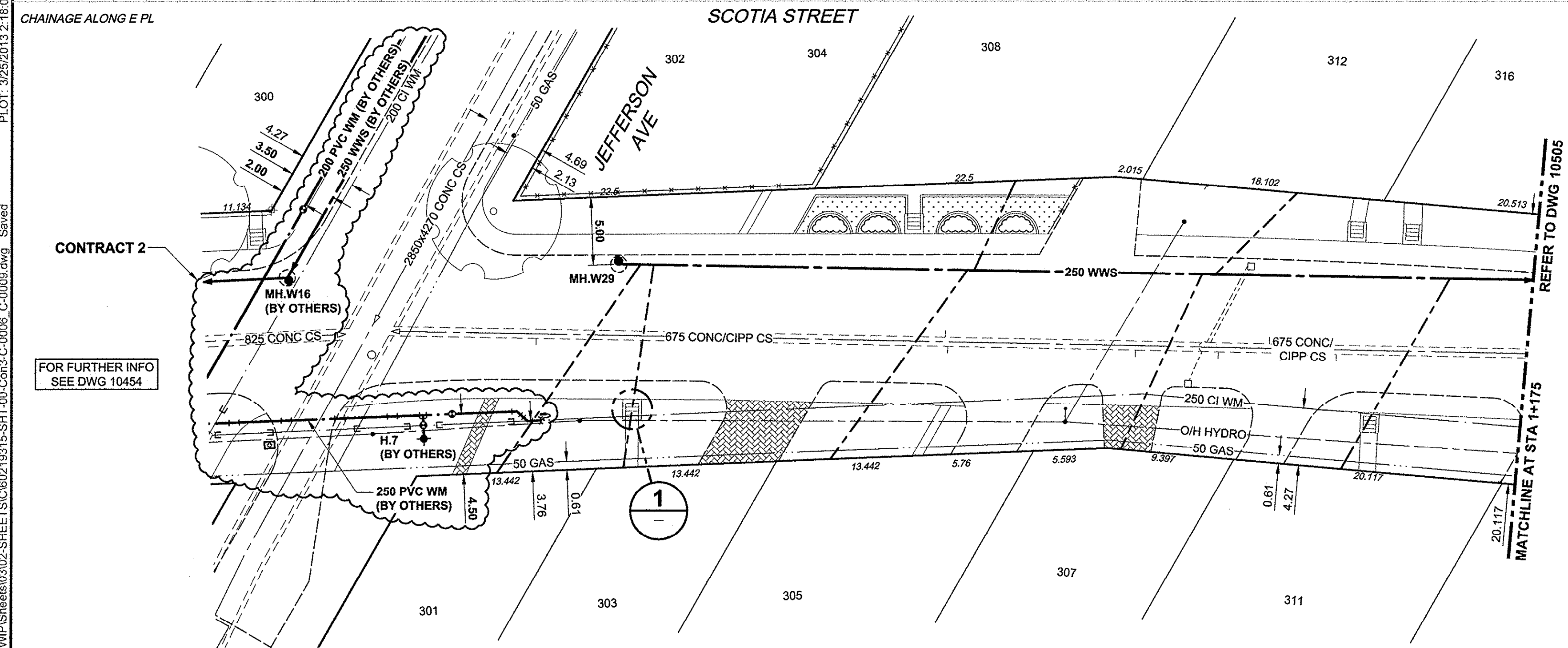

SEWER SERVICE INFORMATION

ADDRESS	PL TIE (SHORT/LONG)	JUNCTION TIE	REMARKS
* 301 SCOTIA		88m S OF MH @ ST ANTHONY	
302/304 SCOTIA			SERVICE OFF JEFFERSON
* 303 SCOTIA		80.5m S OF MH @ ST ANTHONY	
* 305 SCOTIA		57.2m S OF MH @ ST ANTHONY	
* 307 SCOTIA		43.4m S OF MH @ ST ANTHONY	
* 308 SCOTIA		57.4m S OF MH @ ST ANTHONY	
* 311 SCOTIA		28.2m S OF MH @ ST ANTHONY	
* 312 SCOTIA		33.4m S OF MH @ ST ANTHONY	
316 SCOTIA		22.3m W OF E MANHOLE	SERVICE OFF ST. ANTHONY
CB		37.6m S OF MH	

WATER SERVICE INFORMATION

ADDRESS	DISTANCE PROPERTY	SIZE (mm) & TYPE	SHORT & LONG MEASUREMENT	CORPORATION LOCATION	REMARKS
301 SCOTIA	10.90	1.9m NSL HSE	27.1m N HYD S JEFFERSON	OPP S/C	
302/304 SCOTIA	0.30	4.8m SNL HSE	15m NNL JEFFERSON	0.6m S S/C	
303 SCOTIA	10.60	12 LEAD	2.2m SSL HSE	0.5m S S/C	
305 SCOTIA	9.70	12 LEAD	35.8m N HYD S JEFFERSON	OPP S/C	
307 SCOTIA		5m NSL HSE	56.8m N HYD S JEFFERSON	43.3m S OF HYD ST ANTHONY	
308 SCOTIA	16 LEAD	4.5m SNL HSE		1.8m S S/C	
311 SCOTIA	9.60	16 LEAD	2.5m SSL HSE	18.8m S HYD ST ANTHONY	OPP S/C
312 SCOTIA	2.10	20 COPPER	1.3m SNL HSE		3.0m S S/C
316 SCOTIA	0.15	20 COPPER	3.8m EWL HSE		0.3m W S/C
			16.7m WWL SCOTIA		

CONSTRUCTION NOTES:

- FOR DETAILED TEST HOLE INFORMATION, SEE SPECIFICATION.
- LOCATION OF SERVICES SHOWN ON DRAWINGS ARE APPROXIMATE.
- CONFIRM LOCATION OF ALL WATER & WASTEWATER SERVICES IN THE FIELD.
- INSTALL NEW SEWERS, CATCHBASIN LEADS AND WATERMANS BY TRENCHLESS METHODS.
- ALL SHAFTS SHALL HAVE CLASS 3 BACKFILL.
- RENEW SEWER SERVICES TO PROPERTY LINE AND PLUG EXISTING SERVICE AS PER SD-021 (JEFFERSON TO ST. ANTHONY)

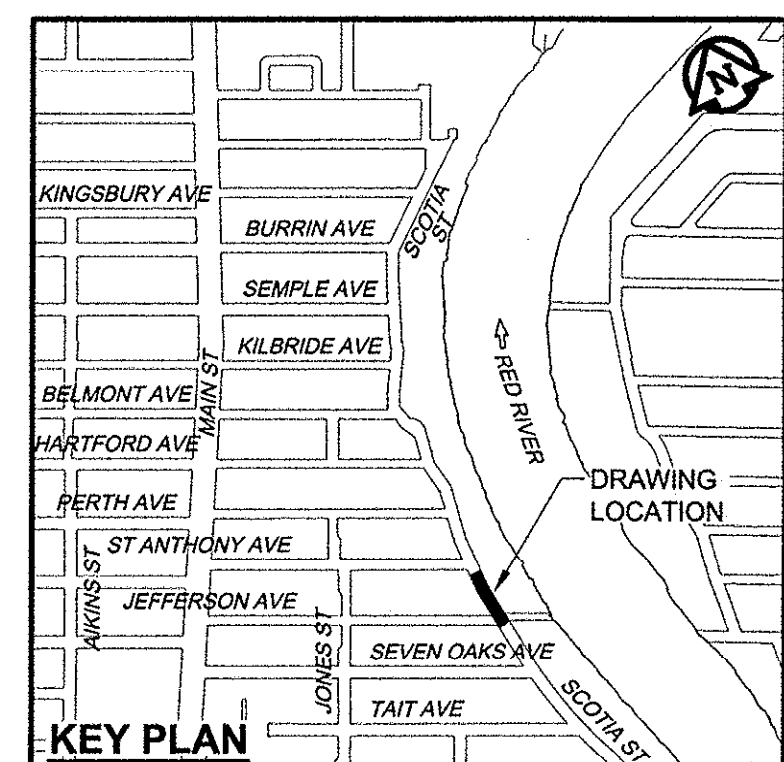

WARNING
IF POWER EQUIPMENT OR EXPLOSIVES ARE TO BE USED FOR EXCAVATION ON THIS PROJECT, THE CONTRACTOR MUST:
1) NOTIFY THE GAS COMPANY OF THE PROPOSED LOCATION OF EXCAVATION.
2) TAKE PRECAUTION TO AVOID DAMAGE TO GAS COMPANY INSTALLATIONS.
SEE PROVINCIAL REGULATION 140/92 FOR DETAILS

150 WM	WATERMAIN	150 WM	♂	CURB STOP	♂	150 WM	WATERMAIN	150 WM	♂	150 WM	WATERMAIN	150 WM	♂	CURB STOP	♂	150 WM	WATERMAIN	150 WM	♂	150 WM	WATERMAIN	150 WM	♂	CURB STOP
○	HYDRANT	○	+	REDUCER	+	○	HYDRANT	○	+	○	HYDRANT	○	+	REDUCER	+	○	HYDRANT	○	+	○	HYDRANT	○	+	REDUCER
○	VALVE	○	+	COUPLING	+	○	VALVE	○	+	○	VALVE	○	+	COUPLING	+	○	VALVE	○	+	○	VALVE	○	+	COUPLING
○	LAND DRAINAGE SEWER	○	+	ANODE	+	○	LAND DRAINAGE SEWER	○	+	○	LAND DRAINAGE SEWER	○	+	ANODE	+	○	LAND DRAINAGE SEWER	○	+	○	LAND DRAINAGE SEWER	○	+	ANODE
○	WASTE WATER SEWER	○	+	HYDRO	+	○	WASTE WATER SEWER	○	+	○	WASTE WATER SEWER	○	+	HYDRO	+	○	WASTE WATER SEWER	○	+	○	WASTE WATER SEWER	○	+	HYDRO
○	MANHOLE	○	+	MTS	+	○	MANHOLE	○	+	○	MANHOLE	○	+	MTS	+	○	MANHOLE	○	+	○	MANHOLE	○	+	MTS
○	CATCH BASIN	○	+	GAS	+	○	CATCH BASIN	○	+	○	CATCH BASIN	○	+	GAS	+	○	CATCH BASIN	○	+	○	CATCH BASIN	○	+	GAS
○	CURB INLET	○	+	TESTHOLE	+	○	CURB INLET	○	+	○	CURB INLET	○	+	TESTHOLE	+	○	CURB INLET	○	+	○	CURB INLET	○	+	TESTHOLE
○	CULVERT	○	+	LAMP STANDARD	+	○	CULVERT	○	+	○	CULVERT	○	+	LAMP STANDARD	+	○	CULVERT	○	+	○	CULVERT	○	+	LAMP STANDARD
○	PIPE ABANDONMENTS	○	+	TREE	+	○	PIPE ABANDONMENTS	○	+	○	PIPE ABANDONMENTS	○	+	TREE	+	○	PIPE ABANDONMENTS	○	+	○	PIPE ABANDONMENTS	○	+	TREE
○	SURVEY BAR	○	+	PAVING STONE	+	○	SURVEY BAR	○	+	○	SURVEY BAR	○	+	PAVING STONE	+	○	SURVEY BAR	○	+	○	SURVEY BAR	○	+	PAVING STONE
○	EXISTING	○	+	LEGEND - PLAN	+	○	EXISTING	○	+	○	EXISTING	○	+	LEGEND - PLAN	+	○	EXISTING	○	+	○	EXISTING	○	+	LEGEND - PROFILE
○	NEW	○	+	LEGEND - PLAN	+	○	NEW	○	+	○	NEW	○	+	LEGEND - PLAN	+	○	NEW	○	+	○	NEW	○	+	LEGEND - PROFILE

LOCATION APPROVED
UNDERGROUND STRUCTURES
SUPR. LIG STRUCTURES DATE COMMITTEE
NOTE: LOCATION OF UNDERGROUND STRUCTURES AS SHOWN ARE BASED ON THE BEST INFORMATION AVAILABLE. BUT NO GUARANTEE IS GIVEN THAT ALL EXISTING UTILITIES ARE SHOWN OR THAT THE GIVEN LOCATIONS ARE EXACT. CONFIRMATION OF EXISTENCE AND EXACT LOCATION OF ALL SERVICES MUST BE OBTAINED FROM THE INDIVIDUAL UTILITIES BEFORE PROCEEDING WITH CONSTRUCTION.

BM 13-009	N.E. Cor. Jefferson Ave. & Main St., Tdbt. in S. Conc. foundation of Lift Station, 0.5m W. & 0.1m below brick of S.E. Cor. of Bldg.	ELEV 230.692m
NO. REVISIONS	DATE	BY
0	ISSUED FOR CONSTRUCTION	13/03/26 ADL

AECOM
Certificate of Authorization
AECOM Canada Ltd.
No. 4671 Date: March 26, 2013

METRIC
WHOLE NUMBERS INDICATE MILLIMETRES
DECIMALIZED NUMBERS INDICATE METRES

DESIGNED BY: FMI
DRAWN BY: ADL
CHECKED BY: EDT
APPROVED BY: [Signature]
HOR. SCALE: 1:250
VERT. SCALE: 1:50
DATE: March 26/13

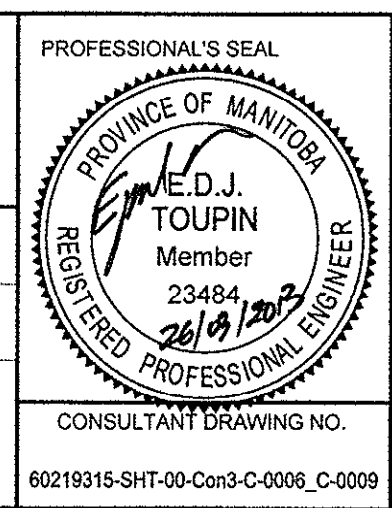

THE CITY OF WINNIPEG WATER AND WASTE DEPARTMENT

JEFFERSON EAST COMBINED SEWER RELIEF CONTRACT 3 SCOTIA STREET
JEFFERSON AVENUE TO 10m SOUTH OF ST. ANTHONY AVENUE

SHEET 06 OF 13
CITY DRAWING NUMBER 10504
REV 0

BID OPPORTUNITY NO. 235-2013