



CARNEGIE LIBRARY ROOF REPLACEMENT

380 WILLIAM AVE

PROJECT NUMBER 1210

NOTES:

CONSULTANT TEAM

ARCHITECTURAL AGER LITTLE ARCHITECTS INC.
202C - 275 BROADWAY
WINNIPEG, MB
R3C 4M6
(204) 414 9191

STRUCTURAL CROSIER KILGOUR PARTNERS LTD.
300 - 275 CARLTON STREET
WINNIPEG, MB
R3C 5R6
(204) 943 7501

MECHANICAL EPP SIEPMAN ENGINEERING INC
303 - 100 OSBORNE STREET SOUTH
WINNIPEG, MB
R3L 1Y5
(204) 453 1080

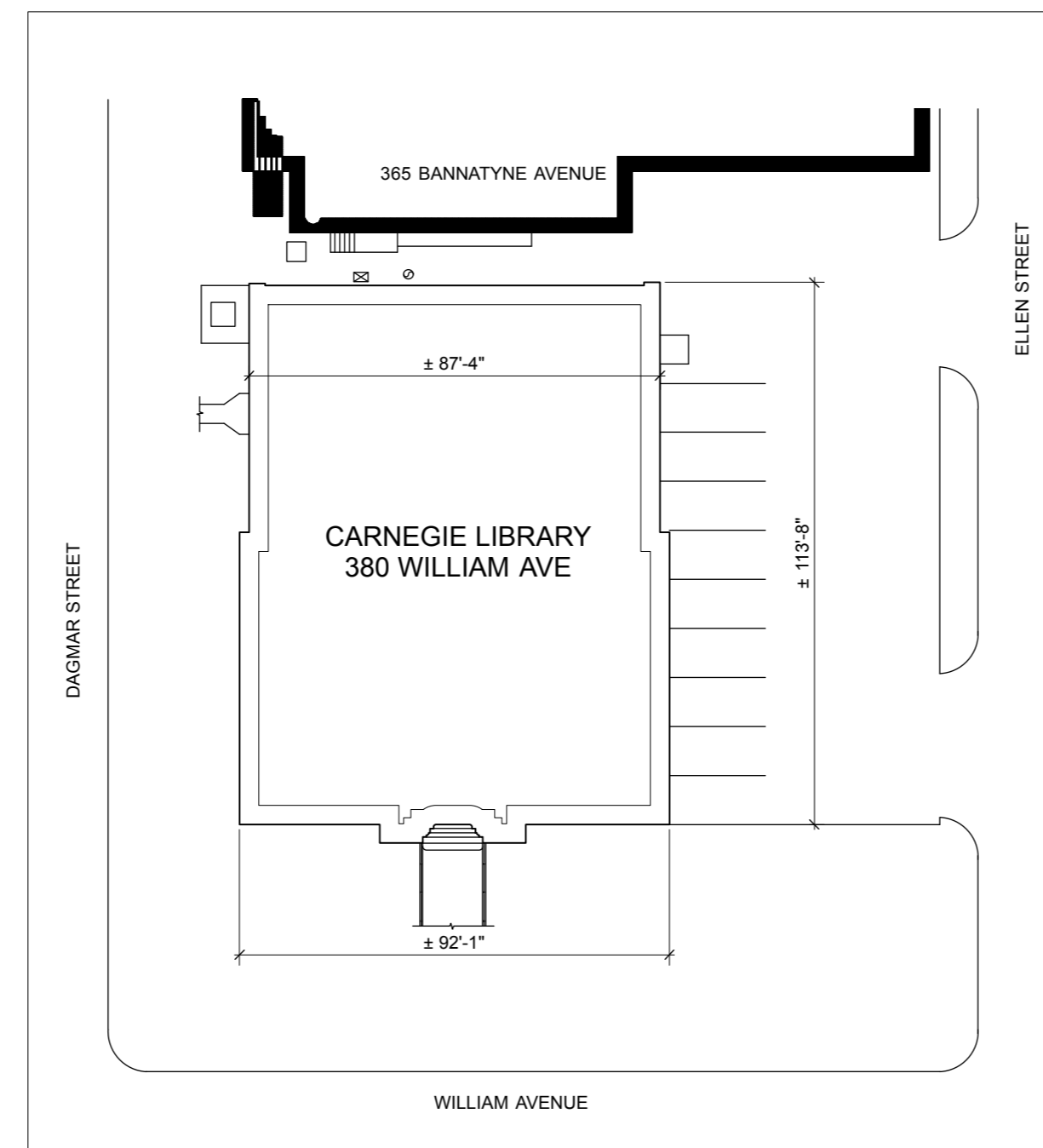

DRAWING LIST	
SHEET No.	SHEET TITLE
A0	COVER SHEET
A1.0	PLANS & DETAILS
S-1	DEMOLITION PLAN, NEW ROOF FRAMING PLAN
S-2	GENERAL NOTES, SECTIONS & DETAILS
S-3	SECTIONS & DETAILS
M1.1	MECHANICAL ROOF DRAINS

ABBREVIATIONS

ACT.	Acoustic Tile	I.D.	Inside Diameter
A.F.F.	Above Finished Floor	I.F.	Inside Face
ALUM.	Aluminum	INSUL.	Insulation
ANOD.	Anodized	INT.	Interior
@	At		
ARCH.	Architectural	m	Metre
AV	Air/Vapour Barrier	mm	Millimetre
		MT.	Mount
BLDG.	Building	MAT'L	Material
BLKG.	Blocking	MAX.	Maximum
BRG.	Bearing	MDF.	Medium Density Fibreboard
B.S.	Both Sides	MECH.	Mechanical
B. to B.	Back to Back	MET.	Metal
		MIN.	Minimum
C.B.	Catch Basin	MISC.	Miscellaneous
CHKR.	Checked	M.O.	Masonry Opening
C.G.	Corner Guard	MV	Maple Veneer
C.J.	Control Joint		
CLG.	Ceiling	NB.	Note well
COL.	Column	NOM.	Nominal
CONC.	Concrete	N.I.C.	Not in Contract
CONN.	Connection	NO.	Number
CONT.	Continuous	N.T.S.	Not to Scale
CORR.	Corridor		
c/w	Complete with	O.C.	On Centre
		O.D.	Outside Diameter
DIA.	Diameter or Round	OPN'G	Opening
DIM.	Dimension	O.H.	Overhead
DN.	Down	OPP.	Opposite
DRWG.	Drawing		
DTL.	Detail	P-LAM.	Plastic Laminate
		PLBG.	Plumbing
ELEV. OR EL.	Elevation	PREFIN.	Prefinished
E.W.	Each Way	P.T.	Pressure Treated
EA.	Each	PTD.	Painted
ELEC.	Electrical	P.L.	Property Line
EQ.	Equal		
EQUIP.	Equipment	R., RAD.	Radius
EXIST.	Existing	RD.	Roof Drain (Low Point)
EXP. JT.	Expansion Joint	REIN.	Reinforced
EXT.	Exterior	REMOV.	Removable
		REQ'D.	Required
FDN.	Foundation	REV.	Revision, Revised
FEJ.	Floor Expansion Joint	R.O.	Rough Opening
FIN.	Finished		
FD.	Floor Drain	SIM.	Similar
FFD.	Funnel Drain	SPCD	Specified
F.F.	Finished Face	SQ.	Square
FHC.	Fire Hose Cabinet	STC.	Sound Transmission Coefficient
FLEX.	Flexible	STD.	Standard
F.O.	Face Of	STL.	Steel
F.R.R.	Fire Resistance Rating	STRUCT.	Structural
GA.	Gauge	SUSP.	Suspended
		TEMP.	Tempered
G.C.	General Contractor	T.G.	Tempered Glass
GB.	Gypsum Board	T.O.	Top of
		TR	Trim
H.D.	Hand dryer (see electrical)	TYP.	Typical
H.M.	Hollow Metal	U/N	Unless Otherwise Noted
HORIZ.	Horizontal	U/S	Under Side
HP	High Point		
HR.	Hour	VERT.	Vertical
H.S.D.G.	Hermetically Sealed Double Glazing		
H.S.S.	Hollow Steel Section	W.	Wide
H.S.T.G.	Hermetically Sealed Triple Glazing	w/	With
HT.	Height	WCT	Wood Ceiling Tile
H.V.A.C.	Heating, Ventilating, Air Conditioning	WD	Wood

01	ISSUED FOR CONSTRUCTION	NK	12.11.09
No.	REVISION/DESCRIPTION	BY	DATE

AGER LITTLE ARCHITECTS INC
202C - 275 Broadway Winnipeg, MB R3C 4M6 (204) 414-9191

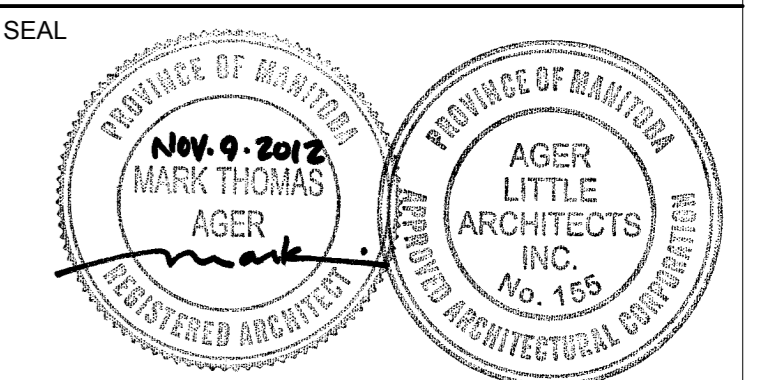

DRAWN	NK	MA	APPROVED
DATE	CHECKED	DESIGNED	APPROVAL
2012.11.09			

THE CITY OF WINNIPEG
PLANNING, PROPERTY AND
DEVELOPMENT DEPARTMENT
MUNICIPAL ACCOMMODATIONS
DIVISION
PROJECT 3-65 GARRY STREET, R3C 4K4
**CARNEGIE LIBRARY
ROOF REPLACEMENT**

380 William Ave, Winnipeg, MB

SHEET TITLE

COVER SHEET

SCALE	PROJECT No: 1210	SHEET No: A0
AS SHOWN		

DRAWING SHEET SIZE: ARCH D (914 mm x 610 mm)

BUILDING CODE ANALYSIS

PROJECT DESCRIPTION:
This project consists of demolition of the existing combustible roof, including: partial demolition of existing chimneys to below new roof level; partial demolition of passive ventilation roof units to below new roof level; demolition of miscellaneous pipes and vents to below new roof level; and demolition of existing roof drain and roof drain line to below new roof level. The project also consists of the construction of a new non-combustible roof structure and new roof; construction of new roof drains and associated plumbing tied back into the existing roof drain; construction of walls and doors to subdivide the attic space; and insulation of the exterior wall from the existing ceiling level to the underside of the new roof.

ADDRESS: 380 William Ave
AREA OF RENOVATION: Complete roof structure & roof system replacement
SPECIFICATIONS: Fire alarm system
Building is not sprinklered
PARKING: Remains unchanged

SECTION 3.1 GENERAL
Major Occupancy: Remains unchanged
Building Height: ± 14.75 M, Basement, Main & Second Floor & 2 Mezzanines
Occupant Load: Remains Unchanged

SECTION 3.2.2. BUILDING SIZE & CONSTRUCTION:
Existing Construction: Combustible & Non-Combustible
Existing Floor Assembly: Combustible & Non-Combustible
Existing Load Bearing Columns & Walls: Non-Combustible
Existing Roof Construction: Combustible
New Roof Construction: Non-Combustible subdivided into compartments < 3230 sq.ft.

SECTION 3.4. EXITS: Remains Unchanged
SECTION 3.7. WASHROOMS: Remains Unchanged

GENERAL DRAWING NOTES

THESE DRAWINGS SHALL NOT BE SCALED.
CONTRACTOR SHALL SATISFY HIMSELF THAT ALL DIMENSIONS, ELEVATIONS, DATUMS AND DETAILED INFORMATION SHOWN ARE CORRECT.
CONTRACTOR TO VERIFY ALL EXISTING SITE CONDITIONS AND REPORT ALL DISCREPANCIES TO THE CONSULTANT 5 DAYS PRIOR TO CLOSE OF TENDER.
CONTRACTOR TO COMPARE BID DOCUMENTS WITH WORK IN PLACE.
CONTRACTOR TO SEAL ALL PENETRATIONS WITH FIRE STOP CAULKING THROUGH FIRE SEPARATIONS TO MAINTAIN THE INTEGRITY OF THE FIRE SEPARATION.
ALL DUCTS, FLOOR GRILLES AND PITS TO BE SIZED BY MECHANICAL.
CONTRACTOR TO PATCH AND MAKE GOOD ALL WALL, CEILING AND FLOOR SURFACES AFFECTED BY THE DEMOLITION WORK.
THESE DRAWINGS TO BE READ IN CONJUNCTION WITH ALL OTHER DRAWINGS, SCHEDULES, SPECIFICATIONS AND DETAILS. REFER ALSO TO ENGINEERING DRAWINGS AND SPECIFICATIONS AS APPLICABLE.

DRAWING LEGEND

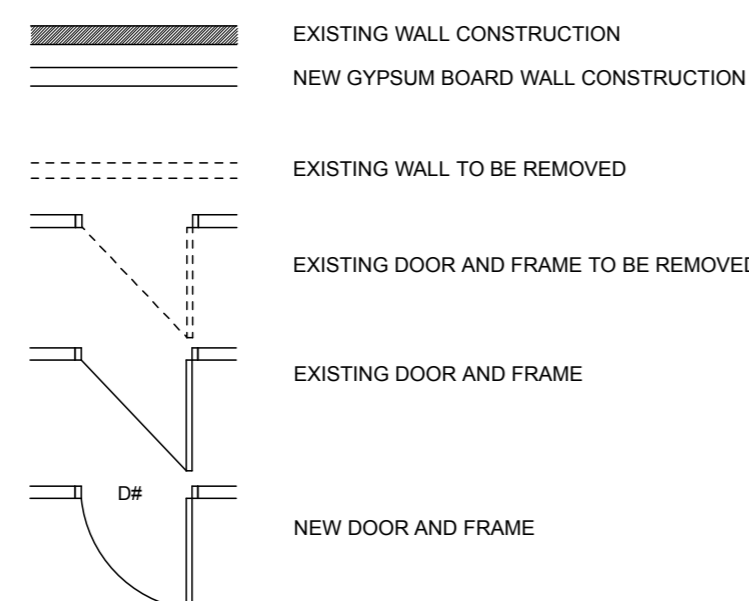

SYMBOLS

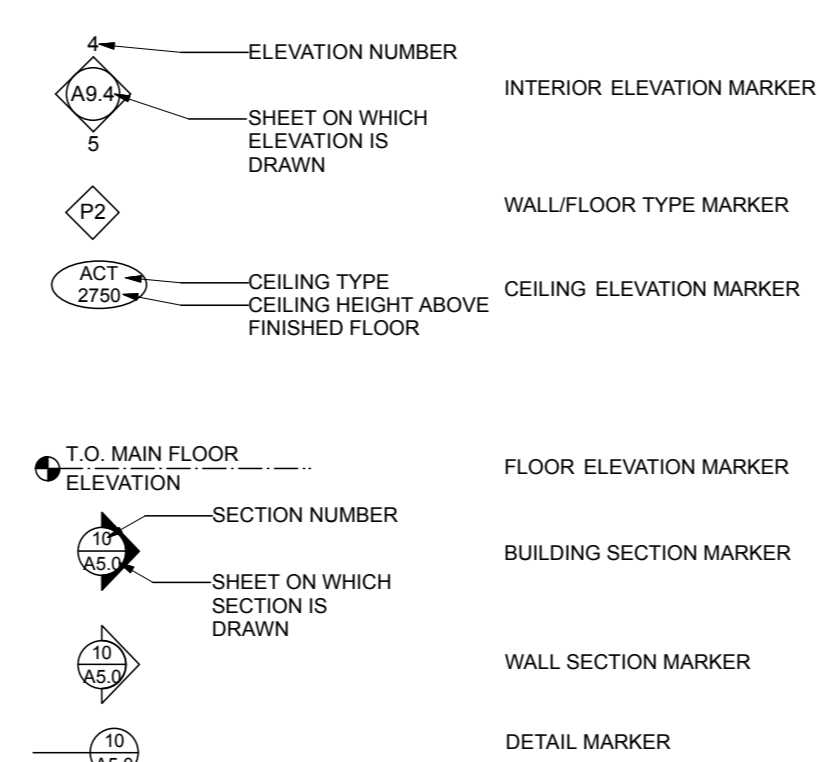

WALL TYPES:

- NOTE:
- REFER TO TYPICAL DETAILS A1.0 & STRUCTURAL
- ALL GYPSUM BOARD JOINTS TO BE TAPED & FILLED (TYP.)
- P1 - 2 1/2" CLOSED CELL SPRAY FOAM INSULATION
- 2 1/2" 25 GA STEEL STUD
- 5/8" TYPE X GYPSUM BOARD
 - P2 - 15 MIN FIRE RESISTANCE RATING
- 5/8" TYPE X GYPSUM BOARD
- 3 5/8" 25 GA STEEL STUD
- 5/8" TYPE X GYPSUM BOARD