

# CHALMERS AVENUE

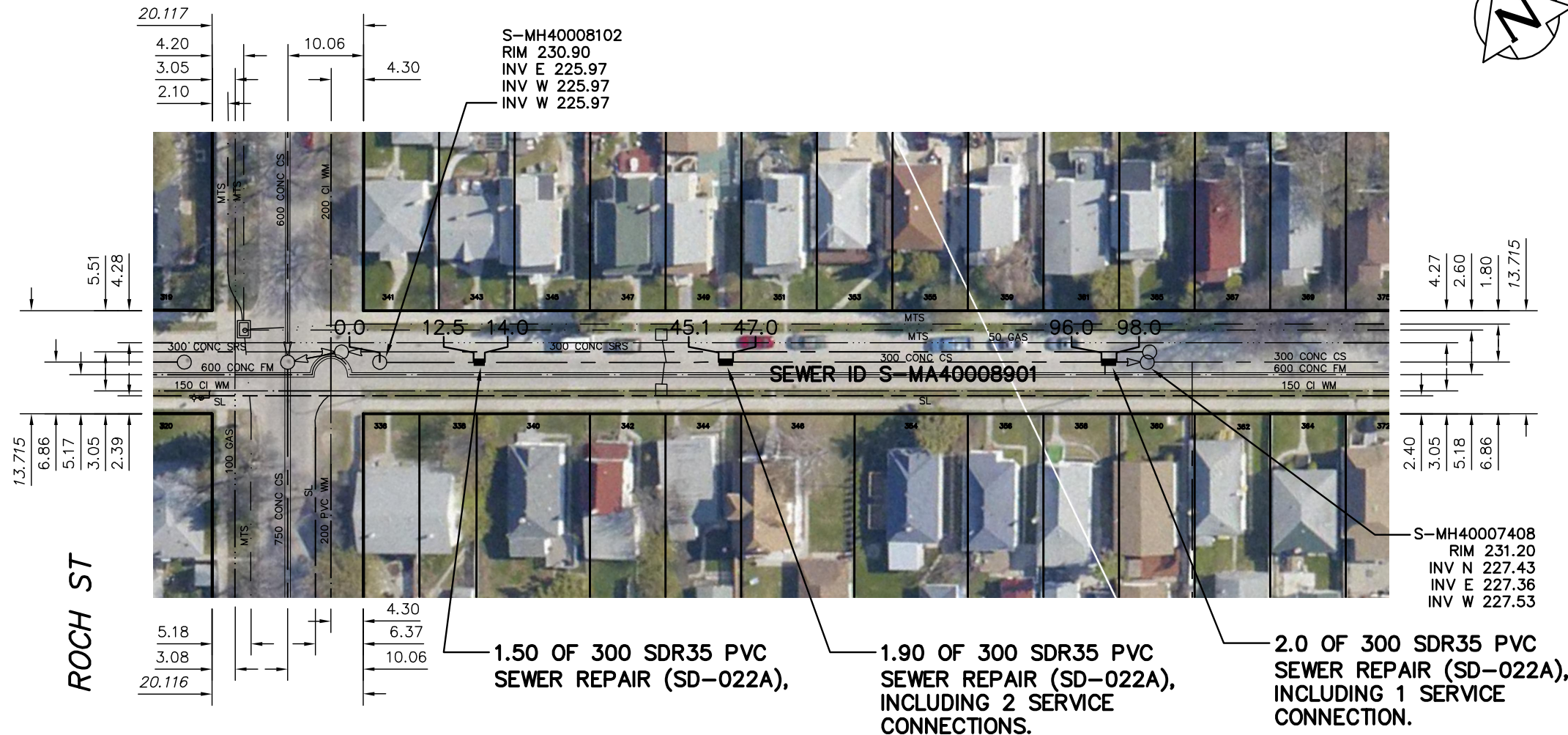
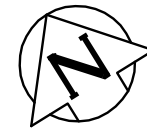

SEWER JUNCTION INFORMATION FROM SEWER VIDEO INSPECTION		
SEWER ID S-MA40008901		
DISTANCE FROM MH ID S-MH40008102		
DISTANCE	DIAMETER	CLOCK
5.1	150	3
5.8	150	10
5.9	150	2
17.1	150	10
25.7	150	4
35.7	150	3
36.2	100	1
36.8	150	1
38.7	200	11
39.6	200	1
45.5	150	2
46.5	150	11
54.5	250	12
55.2	250	12
56.3	150	2
66.9	150	11
76.1	150	1
76.8	150	11
86.9	150	11
88.6	100	11
93.5	150	11
96.5	150	2
100.6	100	1

### WARNING

IF POWER EQUIPMENT OR EXPLOSIVES ARE TO BE USED FOR EXCAVATION ON THIS PROJECT THE CONTRACTOR MUST:

- 1) NOTIFY THE GAS COMPANY OF THE PROPOSED LOCATION OF EXCAVATION.
- 2) TAKE PRECAUTION TO AVOID DAMAGE TO GAS COMPANY INSTALLATIONS.

SEE PROVINCIAL REGULATION 210/72 FOR DETAILS

**CAUTION:  
FEEDERMAIN**

### METRIC

WHOLE NUMBERS INDICATE MILLIMETRES  
DECIMALIZED NUMBERS INDICATE METRES

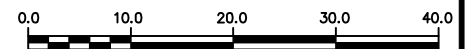

LOCATION APPROVED  
UNDERGROUND STRUCTURES

SUPV. U/G STRUCTURES COMMITTEE DATE

NOTE:

LOCATION OF UNDERGROUND STRUCTURES AS SHOWN ARE BASED ON THE BEST INFORMATION AVAILABLE BUT NO GUARANTEE IS GIVEN THAT ALL EXISTING UTILITIES ARE SHOWN OR THAT THE GIVEN LOCATIONS ARE EXACT. CONFIRMATION OF EXISTENCE AND EXACT LOCATION OF ALL SERVICES MUST BE OBTAINED FROM THE INDIVIDUAL UTILITIES BEFORE PROCEEDING WITH CONSTRUCTION.

B.M. ELEV.	
CONSTRUCTION COMPLETION DATE: YYYY MM DD	
NO.	REVISIONS
	DATE
	BY

DESIGNED BY	NC	CHECKED BY	SC
DRAWN BY	JB	APPROVED BY	KZ
SCALE:		RELEASED FOR CONSTRUCTION	
HORIZONTAL	1:750		
VERTICAL			
DATE	2012 10 26	DATE	

ENGINEER'S SEAL

**ORIGINAL  
SIGNED BY  
S.R.J.  
COURNOYER  
12-10-26**

CONSULTANT DRAWING NUMBER



**THE CITY OF WINNIPEG**  
WATER AND WASTE DEPARTMENT  
ENGINEERING DIVISION

2012 SEWER RENEWALS & REPAIRS

**CHALMERS AVENUE**  
1ST MH E OF ROCH STREET TO  
2ND MH E OF ROCH STREET

SHEET 2 OF 21

CITY DRAWING NUMBER

10413

PLOT DATE: 2012 10 26

BID OPPORTUNITY: 826-2012  
CONTRACT NUMBER: 13

FILE PATH: R:\DRAWINGS\SEWER\2012\_RENEWALS\CIPP, TPR, and EPR\CONTRACT 13\EPR's\  
FILE NAME: 10413.dwg