

SEWER SERVICE INFORMATION			
ADDRESS	SIZE (mm)	R DIST	REMARKS
842 ASHBURN ST RESIDENTIAL	-	4.72 N OF SL	-
843 ASHBURN ST RESIDENTIAL	-	95.77 S MH ST ST MATTHEWS	-
844 ASHBURN ST RESIDENTIAL	-	1.53 S OF NL	-
844 ASHBURN ST RESIDENTIAL	-	95.16 S MH ST ST MATTHEWS	-
844 ASHBURN ST RESIDENTIAL	-	5.80 N OF SL	-
845 ASHBURN ST RESIDENTIAL	-	89.06 S MH ST ST MATTHEWS	-
845 ASHBURN ST RESIDENTIAL	-	4.58 N OF SL	DBL W/#847
847 ASHBURN ST RESIDENTIAL	-	88.44 S MH ST ST MATTHEWS	-
847 ASHBURN ST RESIDENTIAL	-	4.58 N OF SL #845	DBL W/#845
848 ASHBURN ST RESIDENTIAL	-	88.44 S MH ST ST MATTHEWS	-
848 ASHBURN ST RESIDENTIAL	-	3.97 N OF SL	-
849 ASHBURN ST RESIDENTIAL	-	80.52 S MH ST ST MATTHEWS	-
849 ASHBURN ST RESIDENTIAL	-	3.36 S OF NL	-
851 ASHBURN ST RESIDENTIAL	-	75.95 S MH ST ST MATTHEWS	-
851 ASHBURN ST RESIDENTIAL	-	2.14 S OF NL	-
853 ASHBURN ST RESIDENTIAL	-	65.58 S MH ST ST MATTHEWS	-
853 ASHBURN ST RESIDENTIAL	-	4.12 S OF NL	-
854 ASHBURN ST RESIDENTIAL	-	67.95 S MH ST ST MATTHEWS	-
854 ASHBURN ST RESIDENTIAL	-	3.05 S OF NL	-
855 ASHBURN ST RESIDENTIAL	-	75.95 S MH ST ST MATTHEWS	-
855 ASHBURN ST RESIDENTIAL	-	5.49 S OF NL #855	DBL W/#855
856 ASHBURN ST RESIDENTIAL	-	42.70 S MH ST ST MATTHEWS	-
856 ASHBURN ST RESIDENTIAL	-	1.83 S OF NL	-
857 ASHBURN ST RESIDENTIAL	-	68.12 S MH ST ST MATTHEWS	-
857 ASHBURN ST RESIDENTIAL	-	5.49 S OF NL	DBL W/#855
858 ASHBURN ST RESIDENTIAL	-	42.70 S MH ST ST MATTHEWS	-
858 ASHBURN ST RESIDENTIAL	-	3.36 S OF NL	-
860 ASHBURN ST RESIDENTIAL	-	58.86 S MH ST ST MATTHEWS	-
860 ASHBURN ST RESIDENTIAL	-	1.53 N OF SL	-
861 ASHBURN ST RESIDENTIAL	-	50.94 S MH ST ST MATTHEWS	-
861 ASHBURN ST RESIDENTIAL	-	6.10 N OF SL	-
862 ASHBURN ST RESIDENTIAL	-	35.08 S MH ST ST MATTHEWS	-
862 ASHBURN ST RESIDENTIAL	-	2.75 S OF NL	-
864 ASHBURN ST RESIDENTIAL	-	43.31 S MH ST ST MATTHEWS	-
864 ASHBURN ST RESIDENTIAL	-	0.45 N OF SL	-
865 ASHBURN ST RESIDENTIAL	-	35.69 S MH ST ST MATTHEWS	-
865 ASHBURN ST RESIDENTIAL	-	2.75 S OF NL	-
866 ASHBURN ST RESIDENTIAL	-	19.83 S MH ST ST MATTHEWS	-
866 ASHBURN ST RESIDENTIAL	-	6.71 N OF SL	-
869 ASHBURN ST RESIDENTIAL	-	28.06 S MH ST ST MATTHEWS	-
869 ASHBURN ST RESIDENTIAL	-	13.42 E OF WL	SERV. OFF ST. MATTHEWS
870 ASHBURN ST RESIDENTIAL	-	48.80 W MH AT VALOUR	-
870 ASHBURN ST RESIDENTIAL	-	5.19 S OF NL	-
884 ASHBURN ST RESIDENTIAL	-	12.81 S MH ST ST MATTHEWS	-

NOTE: CHAINAGES SHOWN ARE ALONG W. R. OF ASHBURN ST.

CAUTION: GAS & SL ON W SIDE OF ASHBURN ST

CAUTION: GAS

CAUTION: HYDRO & SL

CAUTION: WM

CAUTION: WM ON E SIDE OF ASHBURN ST

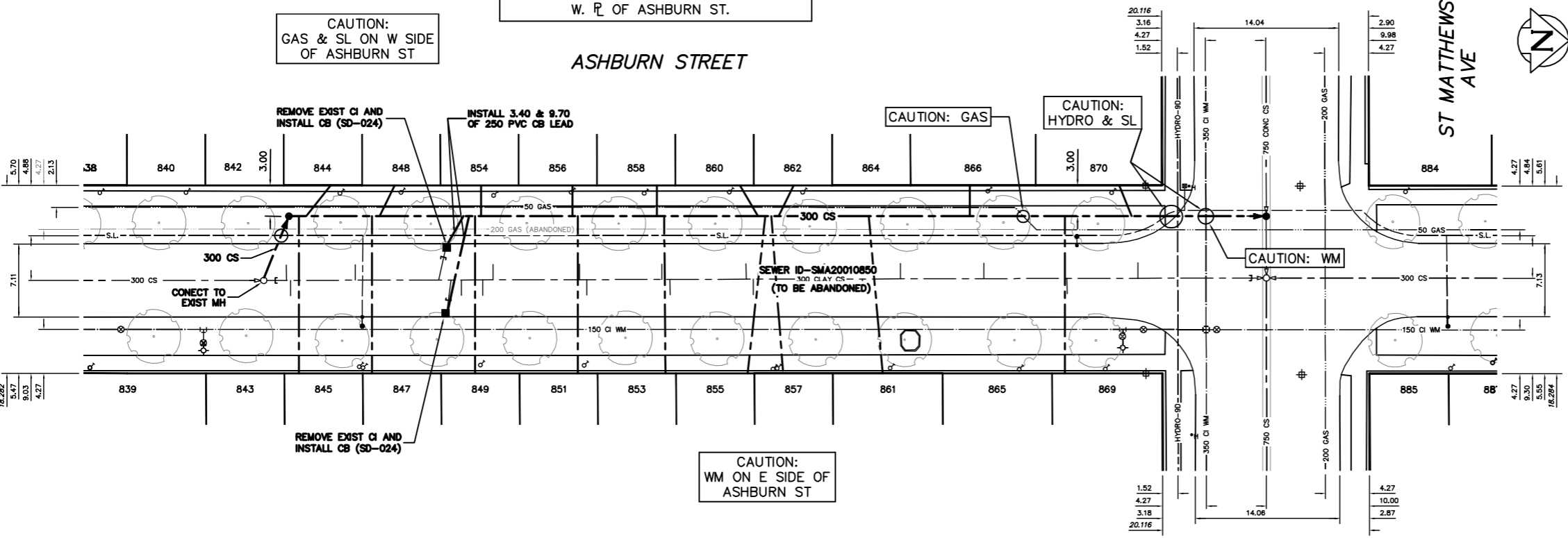

SEWER JUNCTION INFORMATION FROM SEWER VIDEO INSPECTION			
SEWER ID S-MA20010850			
DISTANCE FROM MH ID S-MH20009901	DIAMETER	CLOCK	
2.2	150	11	
2.6	150	2	
8.9	150	11	
17.0	150	11	
18.2	150	12	
19.2	150	2	
21.3	150	1	
22.3	150	11	
30.7	150	11	
31.4	150	2	
38.7	150	10	
26.5	150	2	
46.9	150	11	
54.5	150	10	
55.0	150	2	
58.2	150	12	
61.6	150	10	
62.5	150	1	
70.0	150	11	
78.1	150	1	
85.0	150	11	

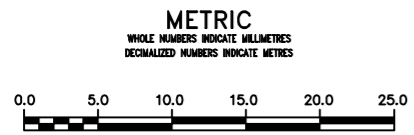

**WARNING**  
IF POWER EQUIPMENT OR EXPLOSIVES ARE TO BE USED FOR EXCAVATION ON THIS PROJECT THE CONTRACTOR MUST:  
1) NOTIFY THE GAS COMPANY OF THE PROPOSED LOCATION OF EXCAVATION.  
2) TAKE PRECAUTION TO AVOID DAMAGE TO GAS COMPANY INSTALLATIONS.  
SEE PROVINCIAL REGULATION 210/72 FOR DETAILS

**LOCATION APPROVED UNDERGROUND STRUCTURES**  
SUPV. U/G STRUCTURES COMMITTEE DATE  
NOTE: LOCATION OF UNDERGROUND STRUCTURES AS SHOWN ARE BASED ON THE BEST INFORMATION AVAILABLE BUT NO GUARANTEE IS GIVEN THAT ALL EXISTING UTILITIES ARE SHOWN OR THAT THE GIVEN LOCATIONS ARE EXACT. CONFIRMATION OF EXISTENCE AND EXACT LOCATION OF ALL SERVICES MUST BE OBTAINED FROM THE INDIVIDUAL UTILITIES BEFORE PROCEEDING WITH CONSTRUCTION.

B.M. ELEV.			
CONSTRUCTION COMPLETION DATE: YYYY MM DD			
DESIGNED BY	NC		
CHECKED BY	SC		
DRAWN BY	CJH		
APPROVED BY	KZ		
SCALE:			
HORIZONTAL	1:250		
VERTICAL	1:50		
RELEASED FOR CONSTRUCTION			
NO.	REVISIONS	DATE	BY

ENGINEER'S SEAL  
**ORIGINAL SIGNED BY S.R.J. COURNOYER 12-11-07**  
CONSULTANT DRAWING NUMBER

**THE CITY OF WINNIPEG**  
WATER AND WASTE DEPARTMENT  
ENGINEERING DIVISION  
2012 SEWER RENEWALS & REPAIRS  
ASHBURN STREET  
1ST MH S OF ST MATTHEWS AVENUE TO  
MH AT ST MATTHEWS AVENUE  
SHEET 45 OF 45  
CITY DRAWING NUMBER 10433