

WILLIAM AVENUE W

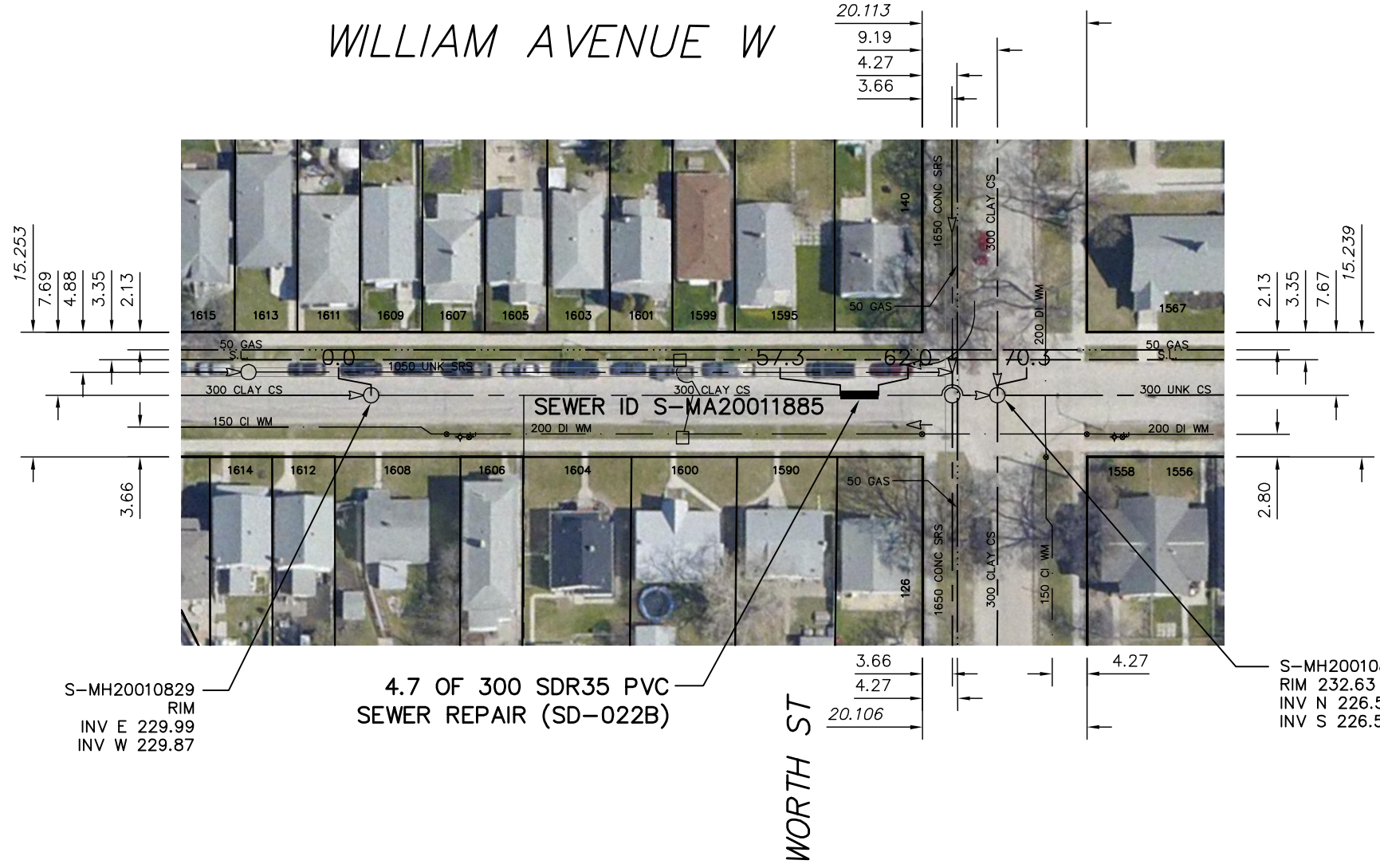

SEWER JUNCTION INFORMATION FROM SEWER VIDEO INSPECTION
SEWER ID S-MA20011885

DISTANCE FROM MH ID S-MH20010829		
DISTANCE	DIAMETER	CLOCK
2.3	150	2
4.3	150	11
12.5	150	10
17.2	150	3
18.0	200	3
19.4	150	10
27.2	150	10
32.5	150	2
35.0	150	10
38.9	150	2
39.8	150	10
40.4	150	2
42.7	150	10
50.4	150	10
55.0	150	2

S-MH20010829
RIM
INV E 229.99
INV W 229.87

4.7 OF 300 SDR35 PVC
SEWER REPAIR (SD-022B)

WORTH ST

S-MH20010888
RIM 232.63
INV N 226.50
INV S 226.50

WARNING

IF POWER EQUIPMENT OR EXPLOSIVES ARE TO BE USED FOR EXCAVATION ON THIS PROJECT THE CONTRACTOR MUST:

- 1) NOTIFY THE GAS COMPANY OF THE PROPOSED LOCATION OF EXCAVATION.
- 2) TAKE PRECAUTION TO AVOID DAMAGE TO GAS COMPANY INSTALLATIONS.

SEE PROVINCIAL REGULATION 210/72 FOR DETAILS

METRIC

WHOLE NUMBERS INDICATE MILLIMETRES
DECIMALIZED NUMBERS INDICATE METRES



LOCATION APPROVED
UNDERGROUND STRUCTURES

SUPV. U/G STRUCTURES COMMITTEE DATE

NOTE:
LOCATION OF UNDERGROUND STRUCTURES AS SHOWN ARE BASED ON THE BEST INFORMATION AVAILABLE BUT NO GUARANTEE IS GIVEN THAT ALL EXISTING UTILITIES ARE SHOWN OR THAT THE GIVEN LOCATIONS ARE EXACT. CONFIRMATION OF EXISTENCE AND EXACT LOCATION OF ALL SERVICES MUST BE OBTAINED FROM THE INDIVIDUAL UTILITIES BEFORE PROCEEDING WITH CONSTRUCTION.

B.M. ELEV.			
CONSTRUCTION COMPLETION DATE: YYYY MM DD			
NO.	REVISIONS	DATE	BY

DESIGNED BY	SC	CHECKED BY	SC
DRAWN BY	JB	APPROVED BY	KZ
SCALE:	1:750	RELEASED FOR CONSTRUCTION	
HORIZONTAL			
VERTICAL			
DATE	2012 11 06	DATE	

ENGINEER'S SEAL

ORIGINAL SIGNED BY
S.R.J. COURNOYER
12-11-07

CONSULTANT DRAWING NUMBER
-



THE CITY OF WINNIPEG
WATER AND WASTE DEPARTMENT
ENGINEERING DIVISION

2012 SEWER RENEWALS & REPAIRS

WILLIAM AVENUE W
2ND MH E OF KEEWATIN STREET TO
MH AT WORTH STREET (Q)

SHEET 43 OF 45

CITY DRAWING NUMBER
10410

PLOT DATE: 2012 11 14

BID OPPORTUNITY: 825-2012
CONTRACT NUMBER: 12

FILE PATH: R:\DRAWINGS\SEWER\2012_RENEWALS\CIPP, TPR, and EPR\CONTRACT 12\EPR\
FILE NAME: WILLIAM.dwg