

KATE STREET

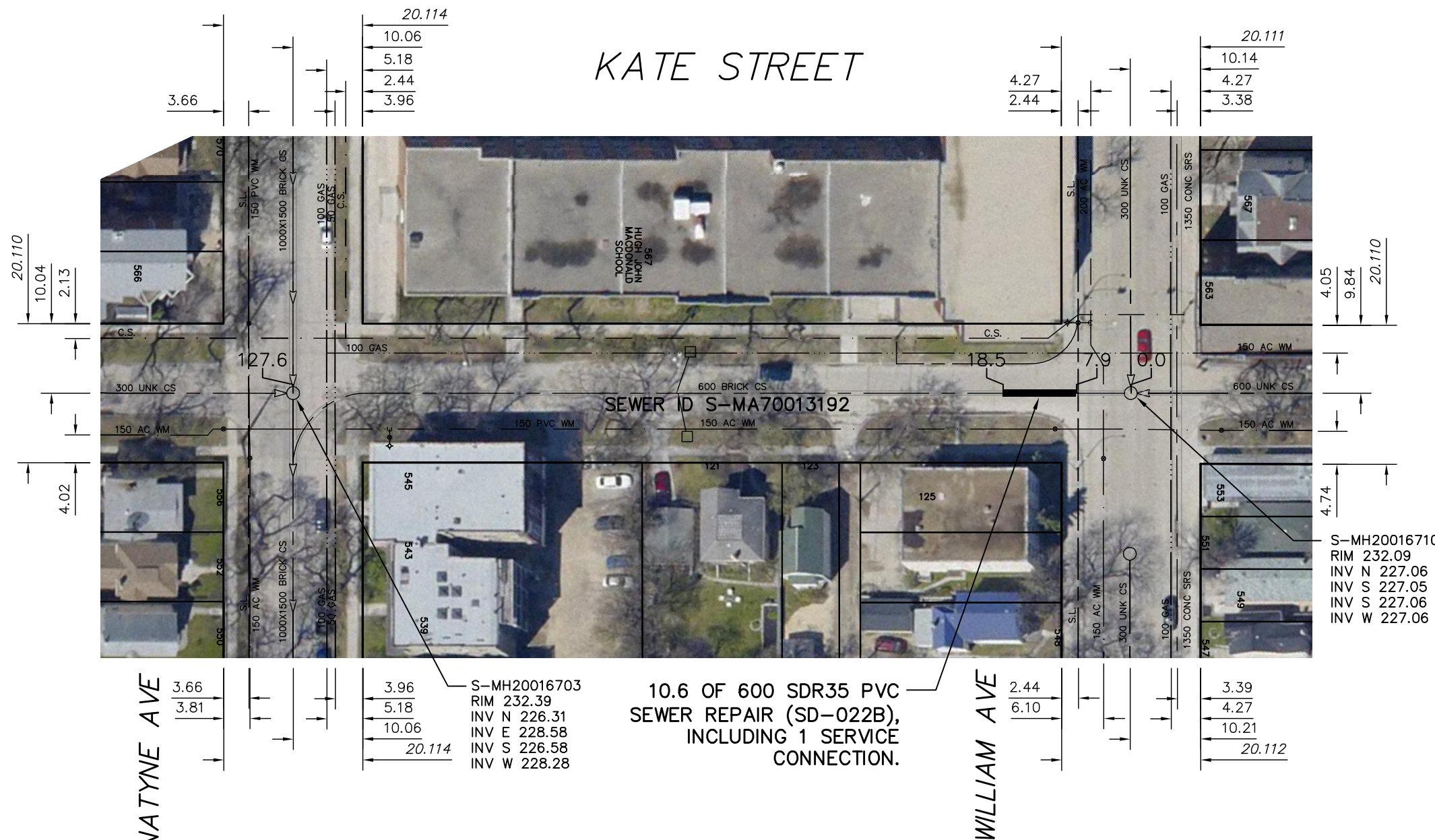

10.6 OF 600 SDR35 PVC
SEWER REPAIR (SD-022B),
INCLUDING 1 SERVICE
CONNECTION.

S-MH20016710
RIM 232.09
INV N 227.06
INV S 227.05
INV S 227.06
INV W 227.06

SEWER JUNCTION INFORMATION FROM SEWER VIDEO INSPECTION SEWER ID S-MA70013192		
DISTANCE FROM MH ID S-TE70005960		
DISTANCE	DIAMETER	CLOCK
9.4	100	2
34.7	100	10
56.6	150	10
56.6	150	2
62.8	150	10
67.0	100	2
76.8	100	2
100.9	150	2
106.3	100	10

S-MH20016703
RIM 232.39
INV N 226.31
INV E 228.58
INV S 226.58
INV W 228.28

WARNING

IF POWER EQUIPMENT OR EXPLOSIVES ARE TO BE USED FOR EXCAVATION ON THIS PROJECT THE CONTRACTOR MUST:

- 1) NOTIFY THE GAS COMPANY OF THE PROPOSED LOCATION OF EXCAVATION.
- 2) TAKE PRECAUTION TO AVOID DAMAGE TO GAS COMPANY INSTALLATIONS.

SEE PROVINCIAL REGULATION 210/72 FOR DETAILS

METRIC

WHOLE NUMBERS INDICATE MILLIMETRES
DECIMALIZED NUMBERS INDICATE METRES



LOCATION APPROVED
UNDERGROUND STRUCTURES

SUPV. U/G STRUCTURES COMMITTEE DATE

NOTE:
LOCATION OF UNDERGROUND STRUCTURES AS SHOWN ARE BASED ON THE BEST INFORMATION AVAILABLE BUT NO GUARANTEE IS GIVEN THAT ALL EXISTING UTILITIES ARE SHOWN OR THAT THE GIVEN LOCATIONS ARE EXACT. CONFIRMATION OF EXISTENCE AND EXACT LOCATION OF ALL SERVICES MUST BE OBTAINED FROM THE INDIVIDUAL UTILITIES BEFORE PROCEEDING WITH CONSTRUCTION.

B.M. ELEV.			
CONSTRUCTION COMPLETION DATE: YYYY MM DD			
NO.	REVISIONS	DATE	BY

DESIGNED BY	SC	CHECKED BY	SC
DRAWN BY	JB	APPROVED BY	KZ
SCALE:	1:750	RELEASED FOR CONSTRUCTION	
HORIZONTAL			
VERTICAL			
DATE	2012 11 06	DATE	
PLOT DATE:	2012 11 14		

ENGINEER'S SEAL

ORIGINAL
SIGNED BY
S.R.J.
COURNOYER
12-11-07

CONSULTANT DRAWING NUMBER
-



THE CITY OF WINNIPEG

WATER AND WASTE DEPARTMENT
ENGINEERING DIVISION

2012 SEWER RENEWALS & REPAIRS

SHEET 20 OF 45

KATE STREET
MH AT WILLIAM AVENUE TO
MH AT BANNATYNE AVENUE

10386