

KEYPLAN

LEGEND

	HAZARDOUS CLASS I, ZONE 1, GROUP IIA
	HAZARDOUS CLASS I, ZONE 2, GROUP IIA
	CATEGORY 1 (MOISTURE)
	CATEGORY 2 (CORROSIVE)
	CATEGORY 2 WET (MOISTURE & CORROSIVE)

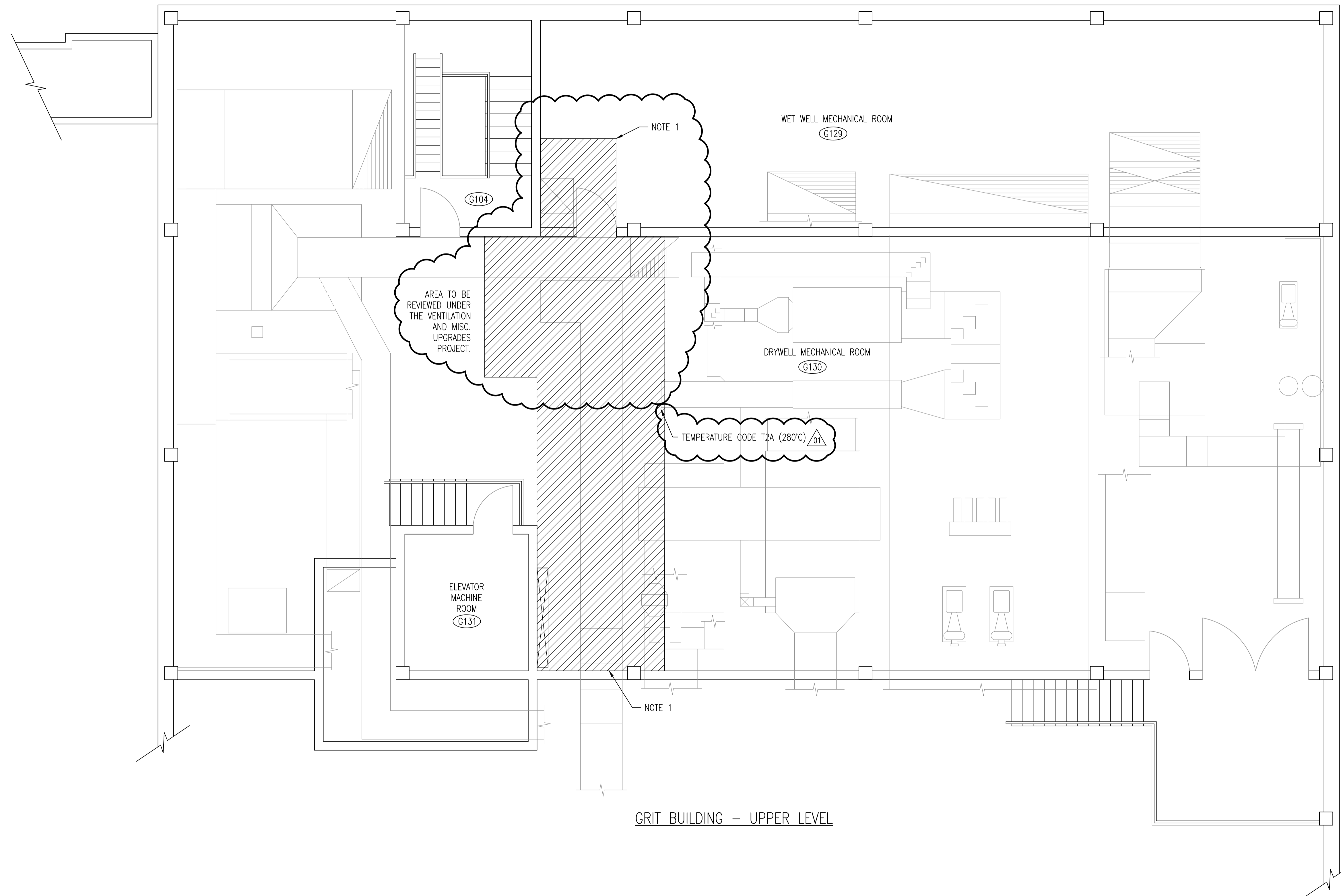

GRIT BUILDING - UPPER LEVEL

- NOTES:**
1. AREAS WITHIN 0.9 METERS OF WET WELL EXHAUST FANS, ASSOCIATED DAMPERS AND UNSEALED DUCTWORK ARE TO BE CLASSIFIED AS ZONE 2 LOCATIONS. (NFPA 820)
 2. THE INDICATED VENTILATION RATES ARE BASED ON EXISTING DOCUMENTATION AND HAVE NOT BEEN VERIFIED VIA ONSITE TESTING.

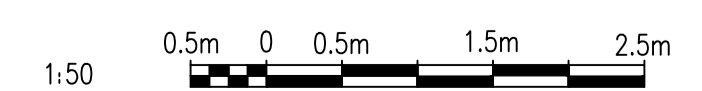

NO.	REVISIONS	DATE	DESIGN	CHECK
01	MODIFIED TEMPERATURE CODE	2012/02/13		
00	ISSUED FOR TENDER, BID OPP. 209-2011	2011/03/31	TMC	CJR

<p>SNC-LAVALIN INC. 148 Nature Park Way Winnipeg, MB, Canada R3P 0X7 204-786-8080</p>	
DESIGNED BY: I. CHURCH	CHECKED BY: C. REIMER
DRAWN BY: S. COATES	APPROVED BY: C. REIMER
SCALE: 1:50	RELEASED FOR CONSTRUCTION BY: N. HARRINGTON
DATE: 2009/11/05	DATE: 2011/03/31
CONSULTANT NO.: 112577-0113-47DD-1204	

ENGINEER'S SEAL

ORIGINAL DRAWING
SEALED BY:
T. M. CHURCH
SNC-LAVALIN
MEMBER #32682
2012/02/15
REV. 01
CHANGES ONLY

THE CITY OF WINNIPEG
WATER AND WASTE DEPARTMENT

SOUTH END WATER POLLUTION CONTROL CENTRE
ELECTRICAL CLASSIFICATION UPGRADES
ELECTRICAL CLASSIFICATION PLAN
GRIT BUILDING - UPPER LEVEL

CITY DRAWING NUMBER	SHEET	REV.	SIZE
1-0102G-E0016	001	01	A1

DRAWING NUMBER	REFERENCE DRAWINGS
----------------	--------------------