

1 MAIN FLOOR PLAN - DEMOLITION
SCALE: 1/8"=1'-0"

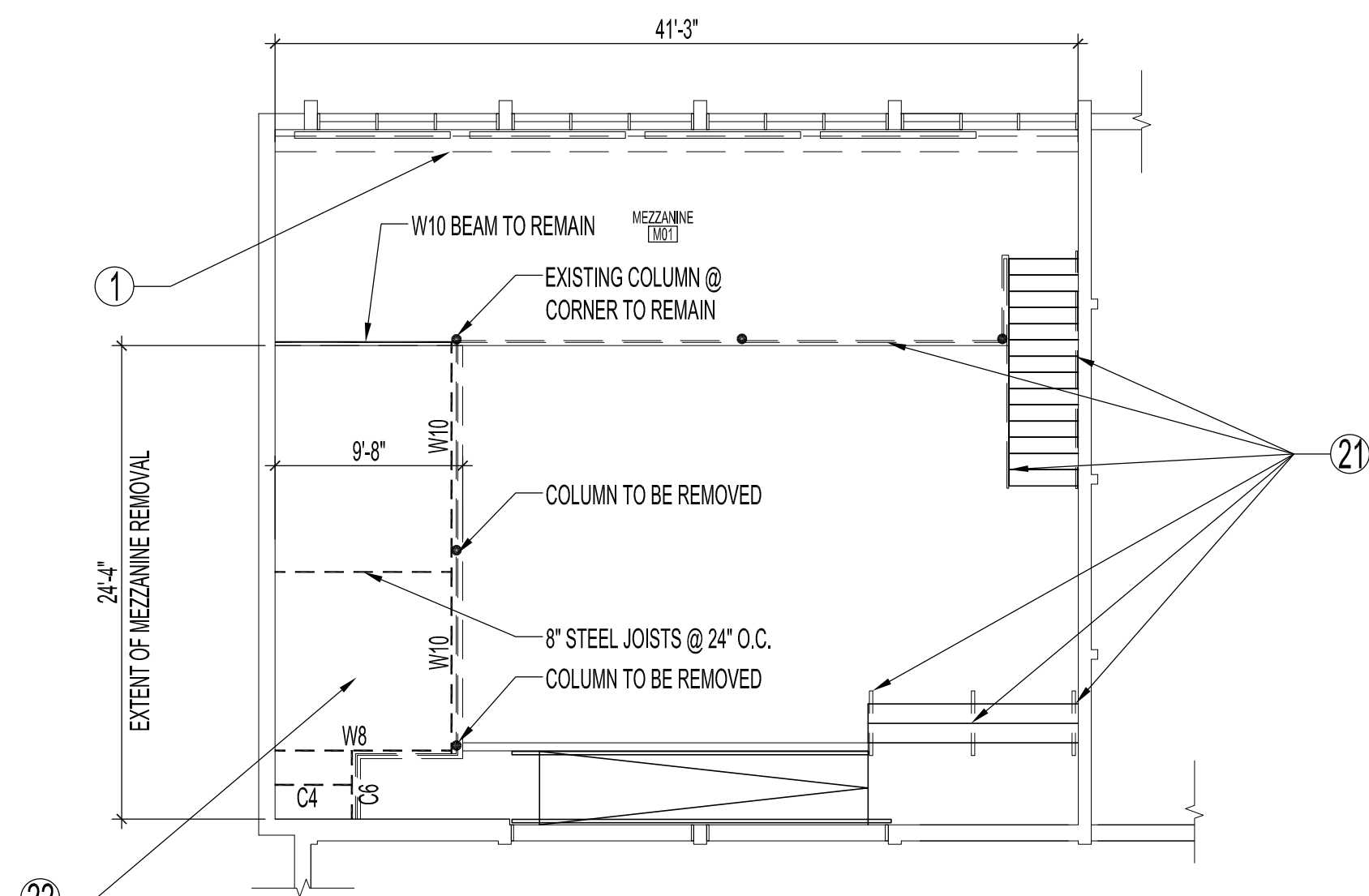

2 MEZZANINE FLOOR PLAN - DEMOLITION
SCALE: 1/8"=1'-0"

GENERAL DEMOLITION NOTES:

BASEMENT CRAWLSPACE AREA

CONTRACTOR TO CLEAN ENTIRE CRAWLSPACE FLOOR AREA BY REMOVING & DISPOSING OF ALL DISCARDED BUT NOT LIMITED TO FOLLOWING MATERIALS / PRODUCTS: WOOD, OLD WINDOWS, PAPER, PLASTIC & ELECTRICAL WIRING, CONDUITS, DRAIN TILES, ETC. FROM CRAWLSPACE WORK AREA.

CAUTION:

CONTRACTOR TO TAKE NECESSARY STEPS & PRECAUTIONS WHEN ENTERING CRAWLSPACE WORK AREA. CONTRACTOR TO CONTACT THE CITY OF WINNIPEG CENTRAL CONTROL OFFICE AT (204) -966-2129 FOR CONFINED SPACE ENTRY PROCEDURES AND PERMIT APPLICATION.

MAIN & MEZZANINE FLOOR AREA

REMOVE & DISCARD ALL EXISTING VERTICAL BLIND WINDOW TREATMENTS & HARDWARE. PATCH ALL EXISTING HOLES IN GYPSUM BOARD LEFT FROM ANCHORS & PREPARE FOR PAINTING.

DEMOLITION NOTES:

- ① REMOVE & DISCARD WOOD CONVECTOR COVERS, FACES, SHOES & HARDWARE. HEATING CONVECTORS TO REMAIN. PATCH WALLS & PREPARE FOR PAINT.
- ② DEMOLISH EXISTING GYP. BD. WALL, DOOR & FRAME FROM FLOOR TO WOOD BEAMS & WOOD ROOF DECK. EXISTING COLUMNS TO REMAIN. PATCH EXISTING COLUMNS & PREPARE FOR PAINTING.
- ③ REMOVE & DISCARD EXISTING GLAZING UNIT, FRAME BETWEEN COLUMNS FROM FLOOR TO U/S OF EXISTING BEAM. PATCH EXISTING GYP. BD. CLAD COLUMNS & PREPARE FOR PAINTING. SEE ELEC. DWG. FOR ELEC. DEMO.
- ④ DEMOLISH +/- 2'-0" WIDE OPENING, 6" FROM CORNER FROM FLOOR TO CEILING IN GYP. BD. WALL FOR NEW TRANSFER GRILLES. SEE RENOVATION DWG FOR DETAILS & MECHANICAL DWG FOR TYPES.
- ⑤ DEMOLISH EXISTING WALL, ALL SHELVING, DOOR & FRAME ABOVE CONCRETE PLATFORM. EAST END WALL @ STAIRWELL TO REMAIN. SEE RENOVATION DWG FOR NEW WALL & FINISHES.
- ⑥ DEMOLISH EXISTING (NORTH WALL ONLY) 8" MASONRY BLOCK & FACE BRICK FROM FLOOR TO U/S OF GYP. BD BULKHEAD, PLUMBING FIXTURES & ACCESSORIES, WALL MOUNTED HEATERS, WATER FOUNTAIN, DOORS & FRAMES. **NOTE: DEMOLISHED WALL IS LOAD BEARING. SEE STRUCTURAL.** EXISTING GYP. BD. CEILING FRAMING TO REMAIN. REMOVE GYP. BD. SEE RENOVATION DWG. & REFLECTED CLNG. PLAN FOR NEW LAYOUT. PARTIAL WALL BASE TO BE REMOVED. SEE FLOOR FINISH DEMOLITION PLAN FOR DETAILS.
- ⑦ REMOVE & DISCARD EXISTING CIRCULATION DESKS & SECURITY GATES (EXISTING CASHIER COUNTER TO REMAIN). ALL ELECTRICAL TO BE REUSED/ RELOCATED IN RENOVATION.
- ⑧ REMOVE & DISCARD EXISTING SINK & CABINET. RE-USE PLUMBING LINES FOR NEW JANITOR'S SINK. RELOCATE THERMOSTATS TO OTHER SIDES OF NEW FIRE RATED WALLS. SEE ELECTRICAL/MECH. DWG.
- ⑨ REMOVE & DISCARD EXISTING WALL, DOOR FRAME, TRIM ETC. PREPARE OPENING FOR NEW DOOR & NEW WALL. SEE RENOVATION DWG.
- ⑩ REMOVE & DISCARD ALL CABINETS, COUNTERTOP, CENTER WALL PARTITION, CLOSET, SINK & FAUCET. SEE RENOVATION DWG. FOR NEW WALL & LAYOUT. SEE ELEC. DWG.
- ⑪ REMOVE ALL MECHANICAL DUCTWORK & SYSTEMS ACCORDING TO MECHANICAL DRAWING. REMOVE ALL WINDOWS ON WEST & SOUTH SIDE & PREPARE OPENINGS FOR NEW WINDOWS. REMOVE EXISTING BASEMENT WINDOW & SECURITY SCREEN (SOUTHWEST). PREPARE OPENING FOR NEW WINDOW & SECURITY SCREEN. SEE RENOVATION DRAWING, BUILDING ELEVATION & WINDOW TYPES & DETAILS.
- ⑫ DEMOLISH EXISTING GYP. BD. WALLS, SHELVING, PLUMBING FIXTURES & ACCESSORIES, DOORS & FRAMES. EXISTING SOIL STACK & MISC. CONDUITS TO BE RELOCATED INTO NEW WALL. SEE PLUMBING DWG. FOR LOCATION. SEE RENOVATION DWG. FOR NEW LAYOUT.
- ⑬ DEMOLISH EXISTING FACE BRICK CLOSET, CONCRETE /FACE BRICK VAULT ROOM DOOR & FRAME, TO U/S OF EXISTING WOOD BEAM AND UP TO ENTRANCE WALL. DEMOLISH EXISTING EAST SIDE GYP. BD. FACADE ABOVE FACE BRICK AND EXISTING 5" CONCRETE CANTILEVERED ROOF ABOVE CLOSET AND VAULT ROOM. SALVAGE ALL DEMOLISHED FACE BRICK FOR REPAIRS & RECONSTRUCTION. REPAIR & REPLACE REMAINING FACE BRICK WALL AS REQUIRED TO MATCH EXISTING. PATCH, GROUT & PREPARE FOR PAINT.
- ⑭ DEMOLISH & REMOVE EXISTING 4" DOUBLE SIDED FACE BRICK WALL FOR NEW DOOR OPENING SIZED AT 3'-6" x 6'-8". PATCH & REPLACE BRICK AS REQUIRED. SEE STRUCTURAL DWGS. FOR NEW LINTELS.
- ⑮ DEMOLISH & REMOVE EXISTING FACE BRICK & EXTERIOR & INTERIOR WALL FOR NEW OPENING FOR NEW BOOK CHUTE. PROVIDE LINTEL AS REQUIRED. SEE STRUCTURAL DWG. PATCH INTERIOR WALL AND CAULK EXTERIOR & INTERIOR PERIMETER.
- ⑯ REMOVE & DISCARD (2) EXISTING METAL DOORS, HARDWARE & GLAZING UNITS IN VESTIBULE 101. PREPARE OPENINGS FOR NEW SLIDING DOOR UNITS, SIDE LIGHT & TRANSOMS.
- ⑰ DEMOLISH & REMOVE EXISTING RAMP, RAILING, CONCRETE PADS ETC. PLANTER & STAIRS TO REMAIN. SEE STRUCTURAL & LANDSCAPING DRAWINGS FOR FULL DEMOLITION, RENOVATION, NOTES AND DETAILS.
- ⑱ REMOVE & DISCARD METAL LOUVERS & HARDWARE. PATCH HOLES IN WOOD & CONCRETE. REMOVE & DISCARD ALL EXISTING WINDOWS. PREPARE OPENINGS FOR NEW WINDOW. SEE RENOVATION DRAWING, BUILDING ELEVATION & WINDOW TYPES & DETAILS.
- ⑲ EXISTING OAK RADIATOR COVER TO REMAIN. REMOVE OAK TOP & GRILLES FOR ACCESS TO CLEANING INTERIOR, RADIATOR GRILLES ETC. (SEE MECH.) CLEAN GRILLE TOPS, SAND OAK TOP, FRONT & LEGS FREE OF PEELING VARNISH & PREPARE ENTIRE NEW PAINT.
- ⑳ REMOVE LARGE PAINTING, COVER, STORE ON SITE & RETURN TO LOCATION AFTER WALL HAS BEEN PAINTED.
- ㉑ REMOVE /DISMANTLE EXISTING METAL RAILINGS GUARDS AND DISCARD. RAILING @ STAIRWAY STRINGERS REQUIRES CUTTING & GRINDING REMOVAL. PREPARE SURFACES FOR NEW RAILING.
- ㉒ DEMOLISH & REMOVE EXISTING MEZZANINE FLOOR AS DIMENSIONED INCLUDING 2 1/2" CONCRETE TOPPING ON METAL DECK PAN, 8" STEEL JOISTS @ 24" O.C., (2)-W10 & (1)-W8 STEEL BEAMS, (1)-C6 & (1)-C4 STEEL CHANNELS, (2)-3 1/2" STEEL PIPE COLUMNS. JOIST /BEAM ENDS EMBEDDED IN MASONRY WALL -CHIP /CUT OUT OR CUT & GRIND FLUSH TO BRICK FACE. COLUMN BASE PLATES - CHIP OUT GROUTED FLOOR RECESS TO EXPOSE BASEPLATE. CUT ANCHOR BOLTS (4 PER COLUMN) DOWN FLUSH WITHIN RECESS. SEE RENOVATION NOTES FOR FLOOR & WALL PATCHING REPAIRS.

NOTES:

ORIGINAL STAMPED BY: R.K. FOK LI Arch.
DATE: 2012.08.24

No.	REVISION/DESCRIPTION	BY	DATE
SEAL			

DRAWN	CHECKED	DESIGNED	APPROVED
DATE: 2012.07.24	USER		

THE CITY OF WINNIPEG
PLANNING, PROPERTY AND
DEVELOPMENT DEPARTMENT
MUNICIPAL ACCOMMODATIONS DIVISION
3-65 GARRY STREET, R3C 4K4

PROJECT
FORT GARRY LIBRARY
INTERIOR & EXTERIOR REFURBISHING
DESIGN

1360 PEMBINA HIGHWAY

SHEET TITLE
MAIN & MEZZANINE FLOOR PLAN
DEMOLITION

SCALE	PROJECT No:	SHEET No:
AS SHOWN	2011-096	A1

DRAWING SHEET SIZE: A1 (841mm x 594mm) PLOT 1:1