

0+98.00 CONNECT TO EXIST 250 CI WM  
 1+00.00 INSTALL 250-45° BEND  
 1+01.15 INSTALL 250-45° BEND  
 1+02.65 INSTALL HYDRANT (SD-006)  
 1+02.70 REMOVE EXIST HYDRANT  
 1+04.150 N E RUE DESCHAMBAULT  
 1+05.01 ABANDON EXIST VALVE  
 1+07.20 INSTALL 250X200X150 CROSS  
 1+08.24 ABANDON EXIST 250X200X150 CROSS  
 1+09.50 INSTALL 250X150 REDUCER  
 1+10.50 INSTALL 150-45° VERT. BEND (SD-005)  
 1+11.20 INSTALL 150-45° VERT. BEND (SD-005)  
 1+11.44 ABANDON EXIST VALVE

1+20.00 INSTALL 150-45° VERT. BEND (SD-005)  
 1+20.60 INSTALL 150-45° VERT. BEND (SD-005)  
 1+24.263 S E RUE DESCHAMBAULT & INSTALL 150 VALVE  
 1+25

1+47.00 INSTALL HYDRANT (SD-006)  
 1+50

1+69.048 N E CABANA PL (N LEG)  
 1+75

1+84.176 S E CABANA PL (N LEG)  
 2+00

2+22.32 REMOVE EXIST HYDRANT  
 2+23.40 INSTALL HYDRANT (SD-006)  
 2+24.63 EXIST COUPLING  
 2+25 N E CABANA PL (S LEG)  
 2+26.85 ABANDON EXIST BEND AND INSTALL 150-90° BEND  
 2+34.140 S E CABANA PL (S LEG)

WATER SERVICE INFORMATION						
ADDRESS	SIZE (mm) MATERIAL (STREET)	SIZE (mm) MATERIAL (PROP.)	SHORT & LONG MEASUREMENT	CORP. LOCATION	REMARKS	
530 RUE BOURGEOULT	20	20	1.66 SNL HSE			
RESIDENTIAL	COPPER	COPPER	38.02 SSL DESCHAMBAULT	0.1 S S/C		
533 RUE BOURGEOULT	20	20	0.44 SNL HSE			
RESIDENTIAL	COPPER	COPPER	31.42 SSL DESCHAMBAULT			
534 RUE BOURGEOULT	20	20	5.90 SNL HSE			
RESIDENTIAL	COPPER	COPPER	23.60 SSL DESCHAMBAULT			
538 RUE BOURGEOULT	20	20	1.64 SNL HSE			
RESIDENTIAL	COPPER	COPPER	4.79 SSL DESCHAMBAULT			
546 RUE BOURGEOULT	20	20	1.81 NSL HSE			
RESIDENTIAL	COPPER	COPPER	6.16>NNL DESCHAMBAULT			
409 RUE DESCHAMBAULT	20	20	0.72 EWL HSE			
RESIDENTIAL	COPPER	COPPER	10.04 WML BOURGEOULT			
410 RUE DESCHAMBAULT	20	20	3.44 EWL HSE			
RESIDENTIAL	COPPER	COPPER	9.84 WML BOURGEOULT			
411 CABANA PL	20	20	1.71 WML HSE			
RESIDENTIAL	COPPER	COPPER	12.40 WML BOURGEOULT	1.4 E S/C		
414 CABANA PL	20	20	1.0 EWL HSE			
RESIDENTIAL	COPPER	COPPER	2.92 EWL BOURGEOULT	2.0 E S/C		
417 CABANA PL	20	20	2.24 NSL HSE			
RESIDENTIAL	COPPER	COPPER	13.61>NNL CABANA		SERV. OFF BOURGEOULT	

\* SERVICES TO BE RENEWED TO R. ALL OTHERS TO BE RECONNECTED

NOTE: CHAINAGES SHOWN ARE ALONG W E OF RUE BOURGEOULT

RUE BOURGEOULT

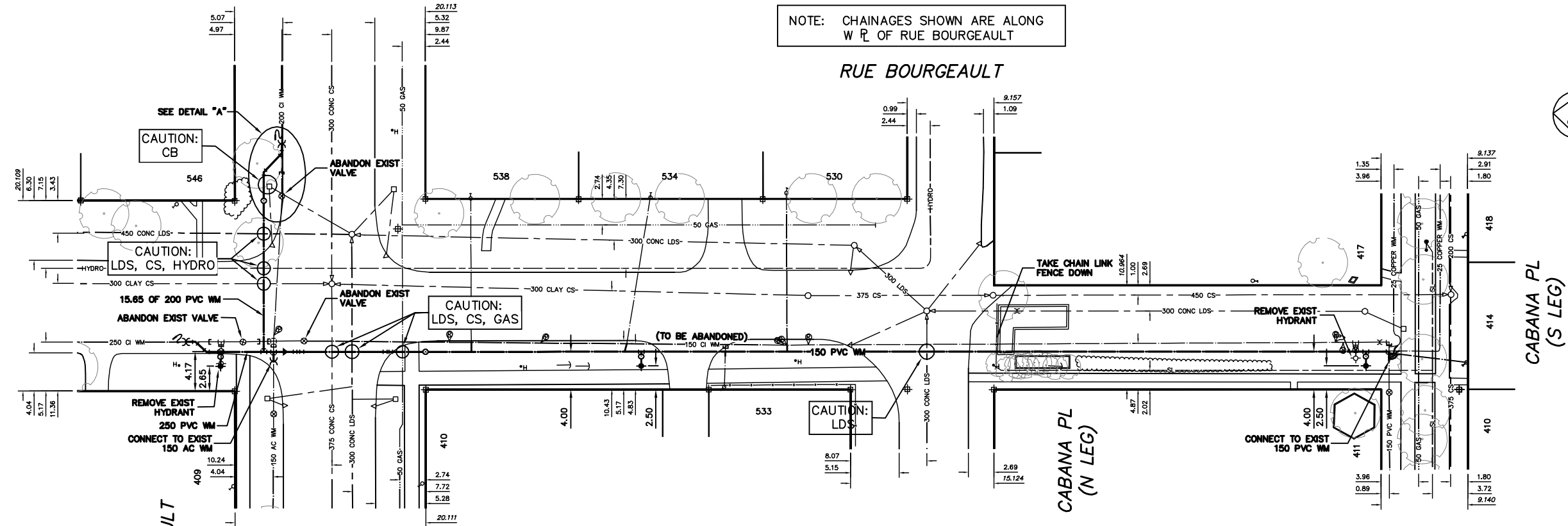

CABANA PL (S LEG)

CABANA PL (N LEG)

RUE DESCHAMBAULT

**WARNING**  
 IF POWER EQUIPMENT OR EXPLOSIVES ARE TO BE USED FOR EXCAVATION ON THIS PROJECT THE CONTRACTOR MUST:  
 1) NOTIFY THE GAS COMPANY OF THE PROPOSED LOCATION OF EXCAVATION.  
 2) TAKE PRECAUTION TO AVOID DAMAGE TO GAS COMPANY INSTALLATIONS.  
 SEE PROVINCIAL REGULATION 210/72 FOR DETAILS

**LOCATION APPROVED UNDERGROUND STRUCTURES**  
 SUPV. U/G STRUCTURES COMMITTEE DATE  
 NOTE:  
 LOCATION OF UNDERGROUND STRUCTURES AS SHOWN ARE BASED ON THE BEST INFORMATION AVAILABLE BUT NO GUARANTEE IS GIVEN THAT ALL EXISTING UTILITIES ARE SHOWN OR THAT THE GIVEN LOCATIONS ARE EXACT. CONFIRMATION OF EXISTENCE AND EXACT LOCATION OF ALL SERVICES MUST BE OBTAINED FROM THE INDIVIDUAL UTILITIES BEFORE PROCEEDING WITH CONSTRUCTION.

B.M. ELEV.	
CONSTRUCTION COMPLETION DATE: YYYY MM DD	
DESIGNED BY	NC
CHECKED BY	SC
DRAWN BY	CJH
APPROVED BY	KZ
SCALE:	
HORIZONTAL	1:250
VERTICAL	1:50
RELEASED FOR CONSTRUCTION	
K.R. ZUREK	
DATE	2012 03 27
DATE	JULY 30, 2012
PLOT DATE:	2012 08 02

ENGINEER'S SEAL  
**ORIGINAL SIGNED BY S.R.J. COURNOYER 12-07-30**  
 CONSULTANT DRAWING NUMBER

**THE CITY OF WINNIPEG**  
 WATER AND WASTE DEPARTMENT  
 ENGINEERING DIVISION  
 2012 WATERMAIN RENEWALS  
**RUE BOURGEOULT**  
 RUE DESCHAMBAULT TO CABANA PLACE  
 SHEET 2 OF 9  
 CITY DRAWING NUMBER  
**D-13025**

METRIC  
 WHOLE NUMBERS INDICATE MILLIMETRES  
 DECIMALIZED NUMBERS INDICATE METRES  
 VALVES TO BE COUNTERCLOCKWISE TO CLOSE (RED OPERATING NUT)