

WAVERLEY STREET CROSS SECTION (STA 7+00 TO STA 7+40)

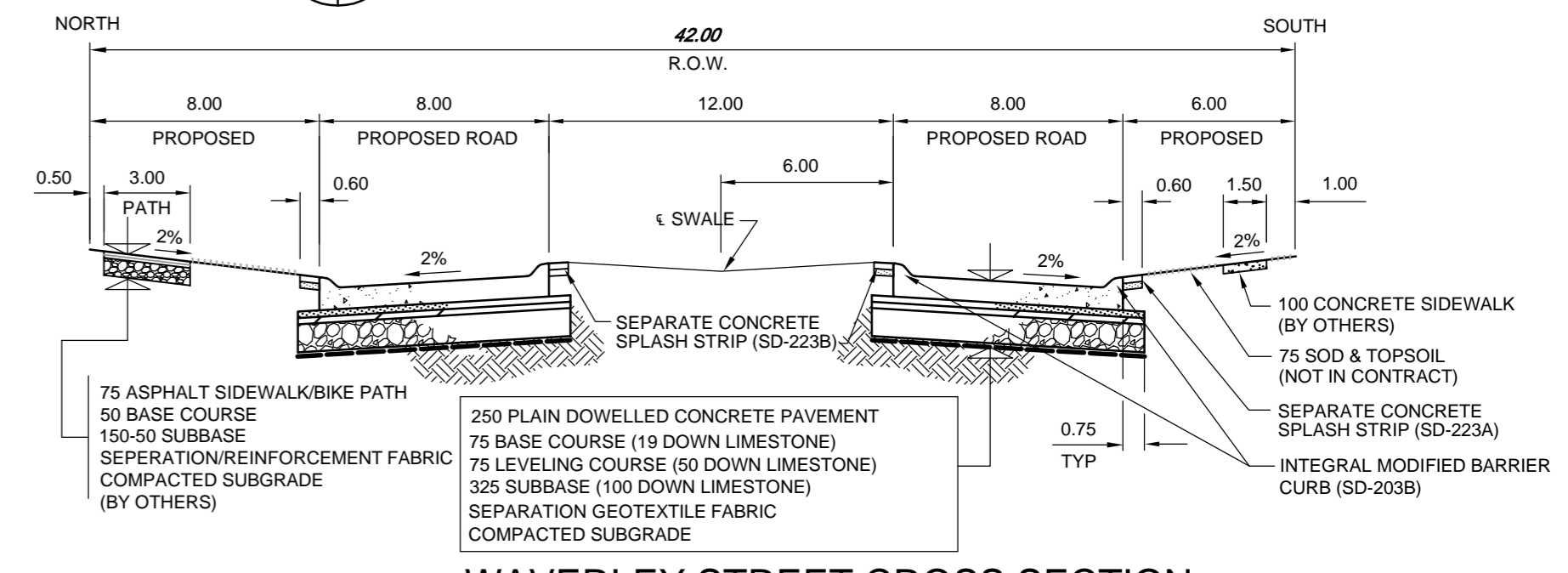

WAVERLEY STREET CROSS SECTION (STA 7+40 TO STA 9+00.6)

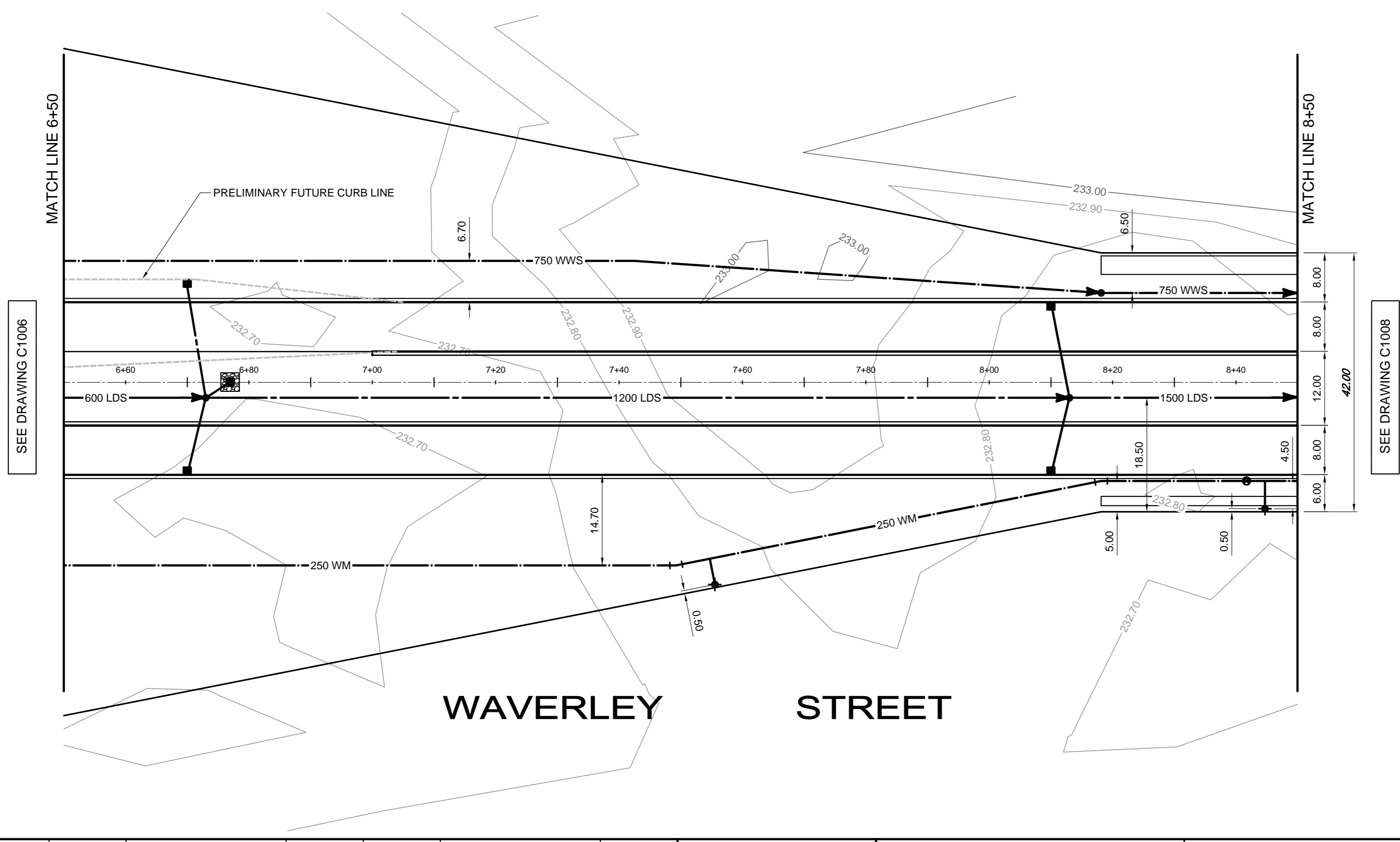
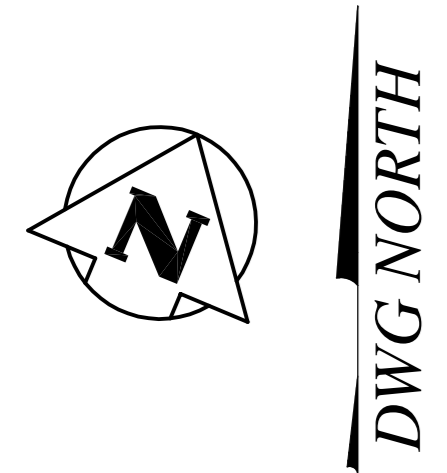

- CONSTRUCTION NOTES**
- ALL HYDRANTS AS PER SD-006.
 - ALL PAVEMENT DIMENSIONS ARE TO BACK OF CURB.
 - ALL BACKFILL UNDER BOULEVARD TO BE CLASS 4 UNLESS OTHERWISE NOTED.
 - ALL PIPE UNDER EXISTING AND FUTURE PAVEMENT TO BE INSTALLED USING TRENCHLESS METHODS. WHERE NOT POSSIBLE, OPEN CUT WITH CLASS 2 BACKFILL.
 - USE CLASS 2 BACKFILL WITHIN 3.0m OF NEW MANHOLE INSTALLATIONS.
 - THE LAST RISER SECTION ON ALL NEW MANHOLES TO BE A 300mm SECTION JUST BELOW THE FLAT TOP REDUCER FOR THE PURPOSE OF FUTURE ADJUSTMENT OF MANHOLES.

- GENERAL NOTES**
- CHAINAGE IS ALONG CENTRE LINE OF PROPOSED WAVERLEY STREET RIGHT-OF-WAY.
 - STATION 10+00 = E/L JOHN ANGSTIM TALE DRIVE.
 - SEE DRAWINGS C1001 TO C1005 FOR SURFACE WORKS.

Coordinate Control Survey Monuments				
No.	Description	Northing	Easting	Elevation
CP 1	IB CP1	3000.000	10000.000	232.535
CP 2	IB CP3	2741.671	10000.000	232.363
CP 3	GBM82024	2675.060	10035.366	232.259
CP 4	GBM82025	1827.090	10031.834	232.917

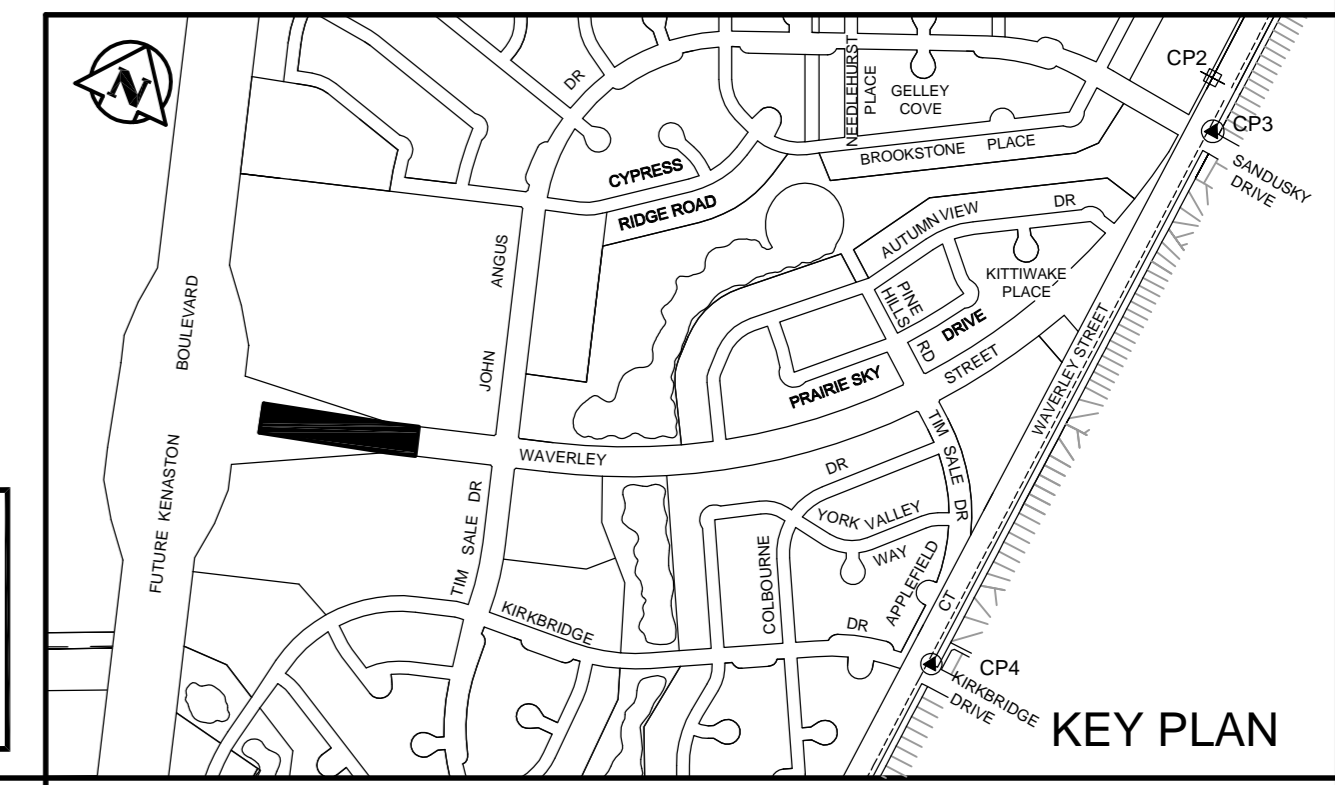

150 WM	WATERMAIN	150 WM	SWALE	RIGHT-OF-WAY	LOCATION APPROVED UNDERGROUND STRUCTURES	B.M. ELEV.		PRELIMINARY DRAWING NOT TO BE USED FOR CONSTRUCTION	THE CITY OF WINNIPEG WATER AND WASTE DEPARTMENT
400 FM	FEEDERMAIN	400 FM	MANHOLE	GAS	SUPV. U/G STRUCTURES COMMITTEE	DATE			
300 LDS	LAND DRAINAGE SEWER	300 LDS	CATCHBASIN	HYDRO	DATE	NO.	ISSUED FOR TENDER: 12.06.11 REVISIONS:	CONSULTANT DRAWING NO.: 1200070300-DWG-C1007-00	CITY DRAWING NUMBER: C1007 SHEET 7 OF 11