

ANSI D SIZE 22" x 34" (559mm x 864mm)

PLOT: 4/2/2012 9:12:20 AM

FILE NAME: W11401000-T-010-UG2_RX.dwg Saved By: dlina

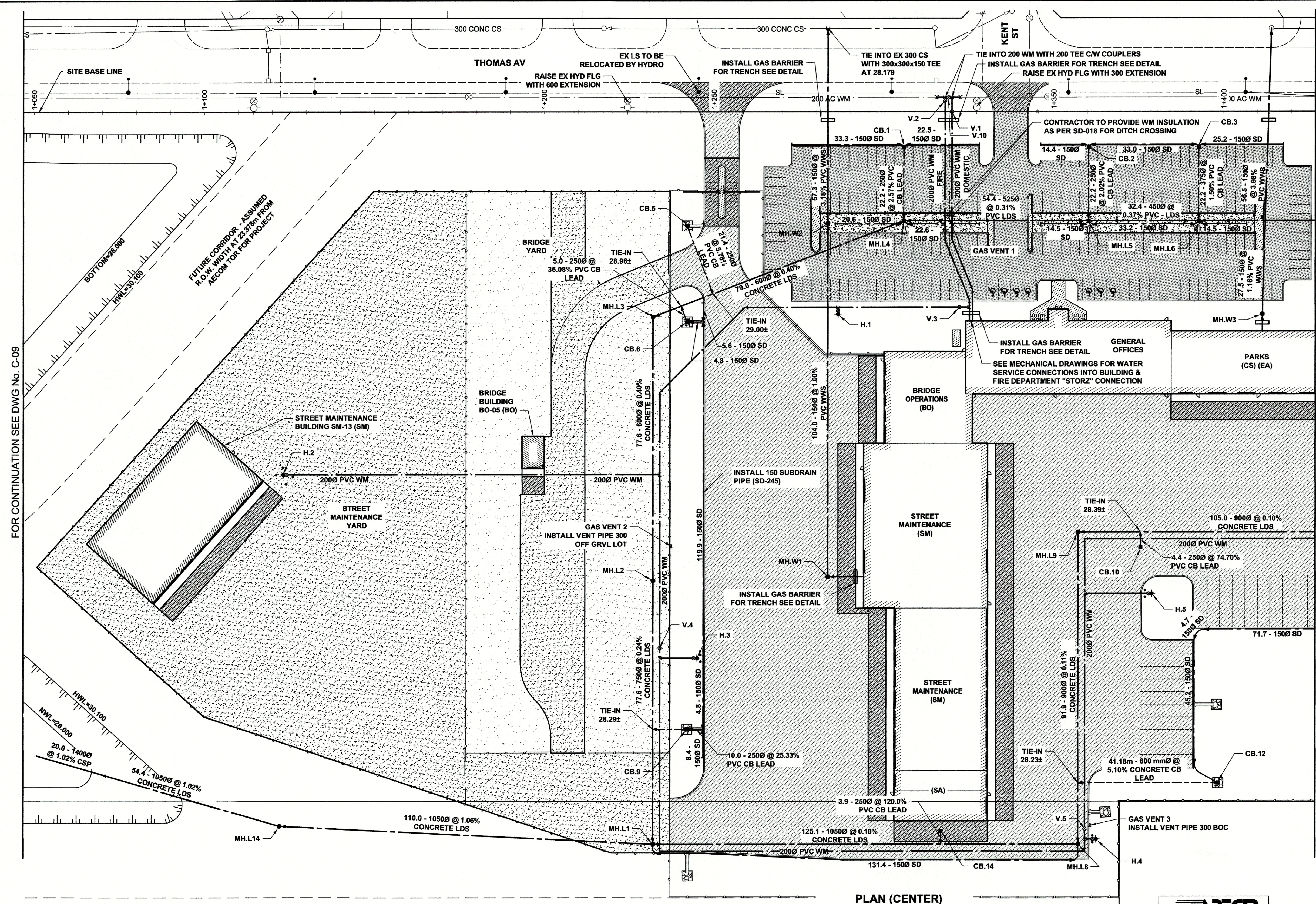

FOR CONTINUATION SEE DWG No. C-09

FOR CONTINUATION SEE DWG No. C-11

PLAN (CENTER)

SCALE: 1:600
0 15 30m

METRIC
WHOLE NUMBERS INDICATE MILLIMETRES
DECIMALIZED NUMBERS INDICATE METRES

150 WM	WATERMAIN	150 WM	HYDRO, STREET LIGHTING	150 WM	WATERMAIN
⊕	HYDRANT	⊕	MTS	⊕	HYDRANT
⊙	VALVE	⊙	TRAFFIC SIGNALS	⊕	VALVE
⊖	300 LDS LAND DRAINAGE SEWER	⊖	GAS	⊖	300 LDS LAND DRAINAGE SEWER
⊗	250 WWS WASTEWATER SEWER	⊗	SURVEY BAR	⊗	250 WWS WASTEWATER SEWER
○	MANHOLE	○	FENCE	○	Q PROFILE
□	CATCH BASIN	□	POLE	○	GROUND ABOVE PIPE
△	CURB INLET	△	CURB STOP	○	Q DITCH (NORTH & WEST)
▽	REDUCER	▽	GUY ANCHOR	○	Q DITCH (SOUTH & EAST)
×	COUPLER	×	LIGHT STANDARD	○	GUTTER (NORTH & WEST)
∇	ANODE	∇	TREE	○	GUTTER (SOUTH & EAST)
---	EXISTING	---	EXISTING	---	EXISTING
---	LEGEND - PLAN	---	LEGEND - PLAN	---	LEGEND - PROFILE
---	NEW	---	NEW	---	NEW

LOCATION APPROVED
UNDERGROUND STRUCTURES

SUPR. U/G STRUCTURES DATE COMMITTEE

NOTE:
LOCATION OF UNDERGROUND STRUCTURES AS SHOWN ARE BASED ON THE BEST INFORMATION AVAILABLE BUT NO GUARANTEE IS GIVEN THAT ALL EXISTING UTILITIES ARE SHOWN OR THAT THE GIVEN LOCATIONS ARE EXACT. CONFIRMATION OF EXISTENCE AND EXACT LOCATION OF ALL SERVICES MUST BE OBTAINED FROM THE INDIVIDUAL UTILITIES BEFORE PROCEEDING WITH CONSTRUCTION.

BM ELEV	1	ISSUED FOR CONSTRUCTION	12/04/02	RPB
	No.	REVISIONS	YY/MM/DD	BY

MORRISON HERSHFIELD

DESIGNED BY	RPB	CHECKED BY	WRJ
DRAWN BY	DML	APPROVED BY	BWB
HOR. SCALE	AS SHOWN	RELEASED FOR CONSTRUCTION	
VERT. SCALE	AS SHOWN	DATE	November 24, 2011

APCGM
Certificate of Authorization
MORRISON HERSHFIELD
No. 1736 Date: April 2/12

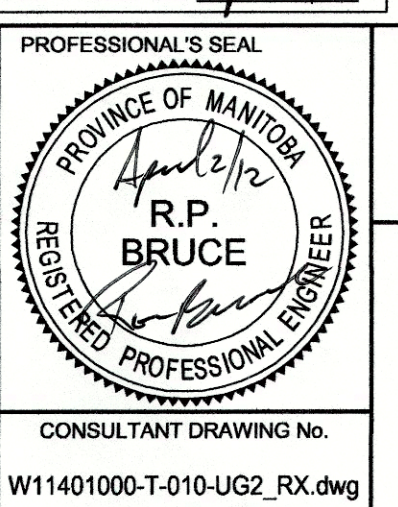

NOTE:
SEE DRAWING No. C-09 FOR UNDERGROUND CONSTRUCTION NOTES.

ERNST HANSCH CONSTRUCTION LTD.

PUBLIC WORKS EAST YARD
#960 THOMAS AVENUE
SURFACE AND UNDERGROUND WORKS
-UNDERGROUND WORKS-
SITE SERVICING PLAN (CENTER)

CITY DRAWING NUMBER	N/A
SHEET	10 OF 17
DRAWING NUMBER	REV
	C-10 1

3 TERRACON PLACE
WINNIPEG, CANADA R2L 4E3
TEL: (204) 233 7831
FAX: (204) 233 4733
general@ehansch.com
www.ehansch.com