

ANSI D SIZE 22" x 34" (559mm x 864mm)

PLOT: 4/22/2012 9:18:18 AM

FILE NAME: W11401000-T-005-PAY_RX.dwg Saved By: dfrme

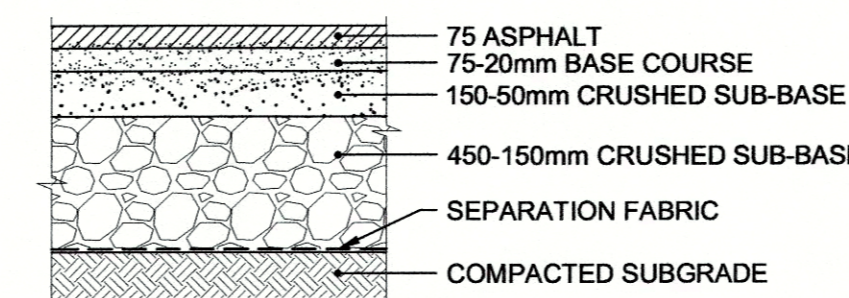
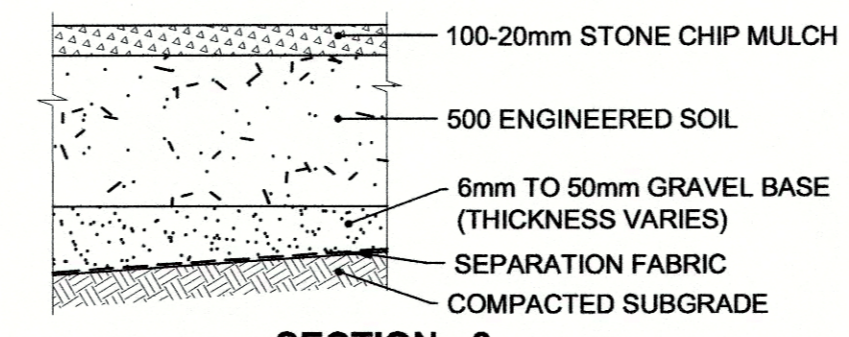
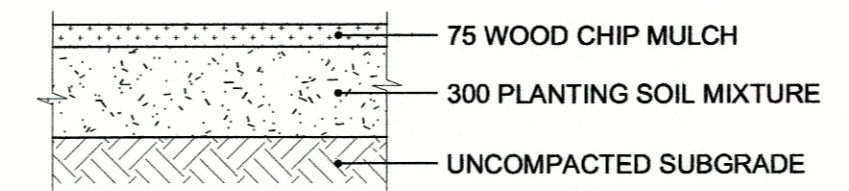
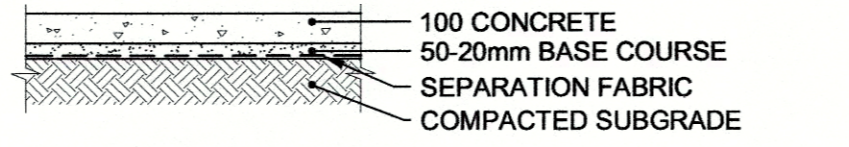
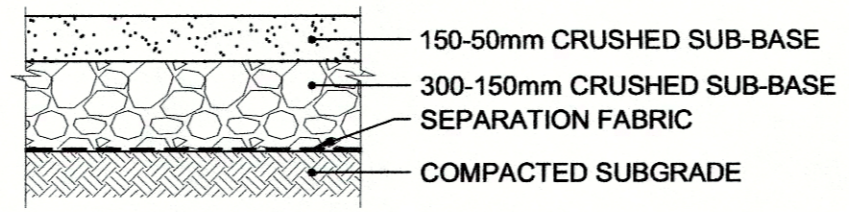
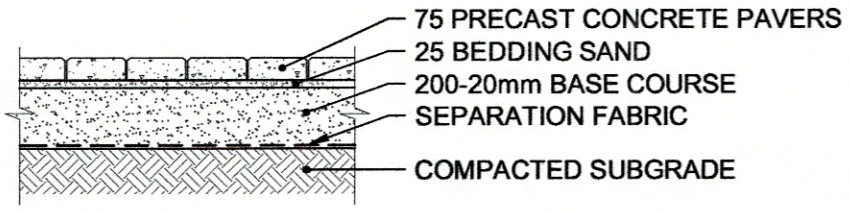
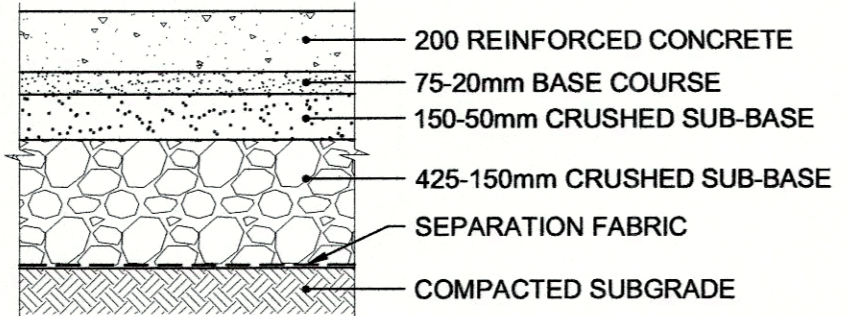
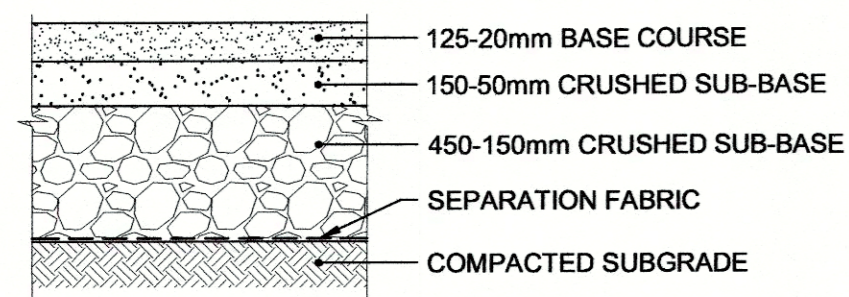
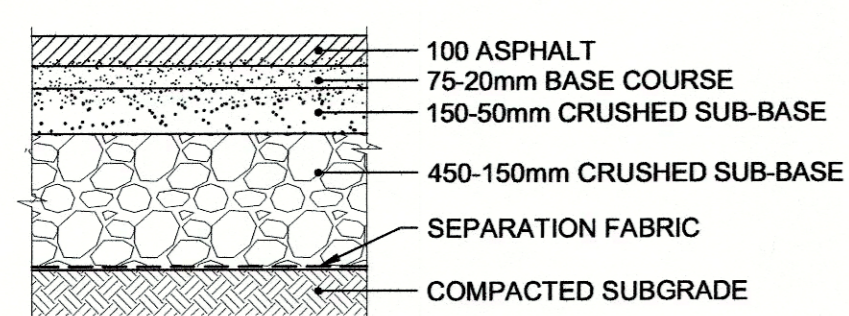
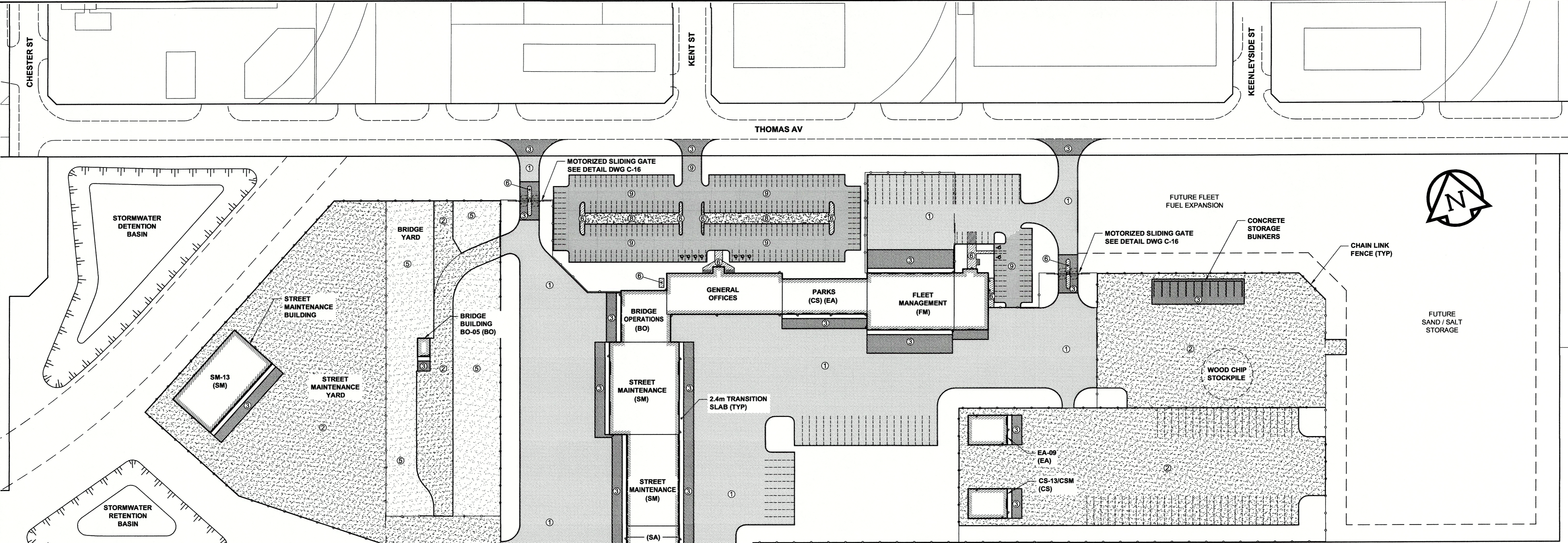

PAVING PLAN

SCALE: 1:1000
0 25 50m

NOTES:

- EMPLOYEE PARKING STALLS = 219 (2.7m x 6.1m)
- HANDICAP PARKING STALLS = 9 (3.6m x 6.1m)
- LARGE VEHICLE PARKING STALLS = 101 (3.7m x 15.3m)
- SEE LANDSCAPE DRAWINGS FOR PLANTING INFORMATION.

CONSTRUCTION NOTES:

1. ALL WORK AND MATERIALS TO BE SUPPLIED AND INSTALLED IN ACCORDANCE WITH THE LATEST EDITION OF THE CITY OF WINNIPEG CONSTRUCTION SPECIFICATION UNLESS OTHERWISE NOTED
2. CONTRACTOR SHALL REMOVE EXISTING TREES AND SHRUBS TO CONSTRUCT NEW BUILDING AND LOT AREAS AS NOTED ON THE DRAWINGS
3. CONTRACTOR SHALL REFER TO THE EROSION CONTROL PLAN (DWG C-17) PRIOR TO START OF CONSTRUCTION
4. CONTRACTOR SHALL TAKE PRECAUTIONARY STEPS TO AVOID DAMAGE FROM CONSTRUCTION ACTIVITIES TO EXISTING FEATURES SUCH AS LAMP STANDARDS, FENCES, HYDRANTS AND VALVES, MANHOLES, BOULEVARD TREES, ETC.
5. CONTRACTOR IS NOT ALLOWED TO CLOSE THOMAS AVENUE TO TRAFFIC
6. CONTRACTOR IS RESPONSIBLE FOR LOCATING EXISTING UNDERGROUNDS AND UTILITIES

LEGEND:

- ① SECTION 1 - ASPHALT PAVEMENT (FM PARKING LOT / ASPHALT YARD)
- ② SECTION 2 - GRAVEL PAVEMENT (GRAVEL ROADS / YARDS)
- ③ SECTION 3 - CONCRETE PAVEMENT (APPROACHES / APRONS / MAJOR PAD)
- ④ SECTION 4 - PRECAST PAVERS (SIDEWALK / PATIO)
- ⑤ SECTION 5 - GRAVEL PAVEMENT (LIGHT STORAGE AREAS IN BRIDGE YARD)
- ⑥ SECTION 6 - CONCRETE PAVEMENT (SIDEWALKS / BULLNOSES)
- ⑦ SECTION 7 - PLANTING BEDS (FRONT OF BUILDING)
- ⑧ SECTION 8 - STORMWATER INFILTRATION SWALE
- ⑨ SECTION 9 - ASPHALT PAVEMENT (EMPLOYEE PARKING LOT)

PAVEMENT SECTIONS

SCALE: 1:25
0 0.5 1.0 1.5m

LOCATION APPROVED UNDERGROUND STRUCTURES

SUPR. U/G STRUCTURES COMMITTEE DATE

NOTE:
LOCATION OF UNDERGROUND STRUCTURES AS SHOWN ARE BASED ON THE BEST INFORMATION AVAILABLE BUT NO GUARANTEE IS GIVEN THAT ALL EXISTING UTILITIES ARE SHOWN OR THAT THE GIVEN LOCATIONS ARE EXACT. CONFIRMATION OF EXISTENCE AND EXACT LOCATION OF ALL SERVICES MUST BE OBTAINED FROM THE INDIVIDUAL UTILITIES BEFORE PROCEEDING WITH CONSTRUCTION.

No.	ISSUED FOR CONSTRUCTION	DATE	BY
1	ISSUED FOR CONSTRUCTION	12/04/02	RPB
	REVISIONS	YYMMDD	

DESIGNED BY	CHECKED BY
RPB	WRJ
DRAWN BY	APPROVED BY
DML	BWB
HOR. SCALE	RELEASED FOR CONSTRUCTION
AS SHOWN	
VERT. SCALE	DATE
AS SHOWN	November 24, 2011

APECM
Certificate of Authorization
MORRISON HERSHFIELD
No. 1736 Date: April 27/12

PROFESSIONAL'S SEAL
PROVINCE OF MANITOBA
REGISTERED PROFESSIONAL ENGINEER
R.P. BRUCE
CONSULTANT DRAWING No.
W11401000-T-005-PAY_RX.dwg

ERNST HANSCH CONSTRUCTION LTD.
3 TERRACON PLAZA
WINNIPEG, CANADA R2L 4B3
TEL: (204) 233 7881
FAX: (204) 233 4733
general@ehansch.com
www.ehansch.com

PUBLIC WORKS EAST YARD
#960 THOMAS AVENUE
SURFACE AND UNDERGROUND WORKS
-SURFACE WORKS-
PAVING PLAN & SECTIONS

CITY DRAWING NUMBER	N/A
SHEET	5 OF 17
DRAWING NUMBER	REV
C-05	1