

ANSI/D SIZE 22" x 34" (559mm x 864mm)

PLOT: 4/2/2012 9:10:56 AM

FILE NAME: W11401000-T-003-SIT2_RX.dwg Saved By: diane

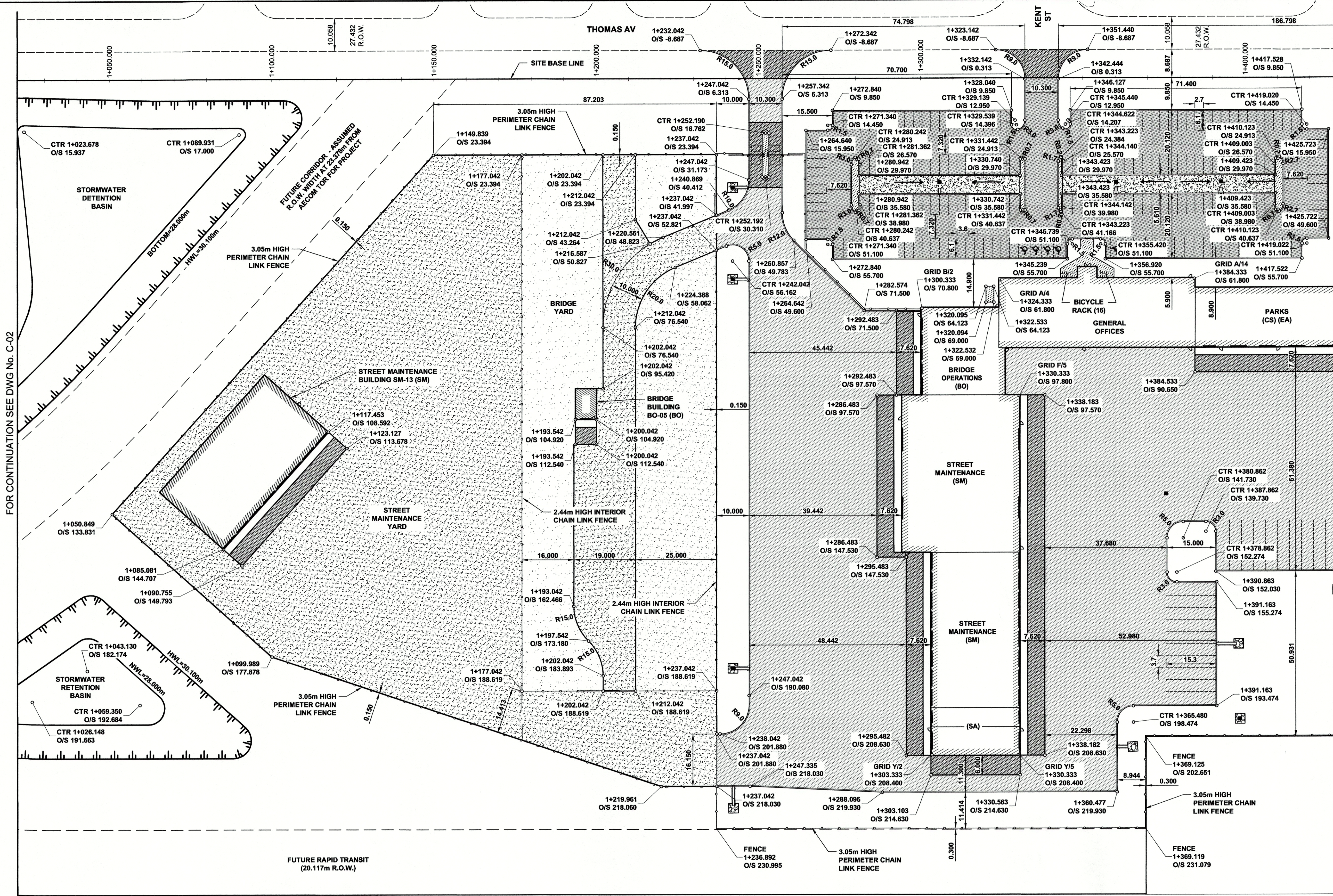

FOR CONTINUATION SEE DWG No. C-02

FOR CONTINUATION SEE DWG No. C-04

SITE BASE LINE		
POINT/STATION	NORTHING	EASTING
POT 1+000.000	10154.056	9380.157
POT 1+791.983	9963.015	10148.753

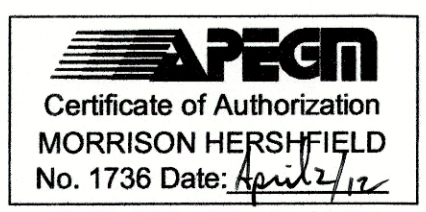
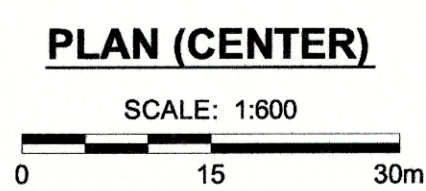

LOCATION APPROVED UNDERGROUND STRUCTURES

SUPR. U/G STRUCTURES DATE COMMITTEE

NOTE:
LOCATION OF UNDERGROUND STRUCTURES AS SHOWN ARE BASED ON THE BEST INFORMATION AVAILABLE BUT NO GUARANTEE IS GIVEN THAT ALL EXISTING UTILITIES ARE SHOWN OR THAT THE GIVEN LOCATIONS ARE EXACT. CONFIRMATION OF EXISTENCE AND EXACT LOCATION OF ALL SERVICES MUST BE OBTAINED FROM THE INDIVIDUAL UTILITIES BEFORE PROCEEDING WITH CONSTRUCTION.

NO.	ISSUED FOR CONSTRUCTION	12/04/02	RPB
1	ISSUED FOR CONSTRUCTION	12/04/02	RPB
	REVISIONS	YYMMDD	BY

MORRISON HERSHFIELD

DESIGNED BY: WRJ
DRAWN BY: DML
HOR. SCALE: AS SHOWN
VERT. SCALE: AS SHOWN
DATE: November 24, 2011

CHECKED BY: RPB
APPROVED BY: BWB
RELEASED FOR CONSTRUCTION

PROFESSIONAL'S SEAL

PROVINCE OF MANITOBA

R.P. BRUCE

CONSULTANT DRAWING No.
W11401000-T-003-SIT2_RX.dwg

ERNST HANSCH CONSTRUCTION LTD.

PUBLIC WORKS EAST YARD
#960 THOMAS AVENUE
SURFACE AND UNDERGROUND WORKS
-SURFACE WORKS-
GENERAL SITE PLAN (CENTER)

CITY DRAWING NUMBER: N/A
SHEET 3 OF 17
DRAWING NUMBER: C-03
REV: 1

3 TERRACON PLACE
WINNIPEG, CANADA R2J 4B3
TEL: (204) 233 7881
FAX: (204) 233 4733
general@ehansch.com
www.ehansch.com

METRIC
WHOLE NUMBERS INDICATE MILLIMETRES
DECIMALIZED NUMBERS INDICATE METRES