

1 SOUTH ELEVATION

1:30 (at 24x36)

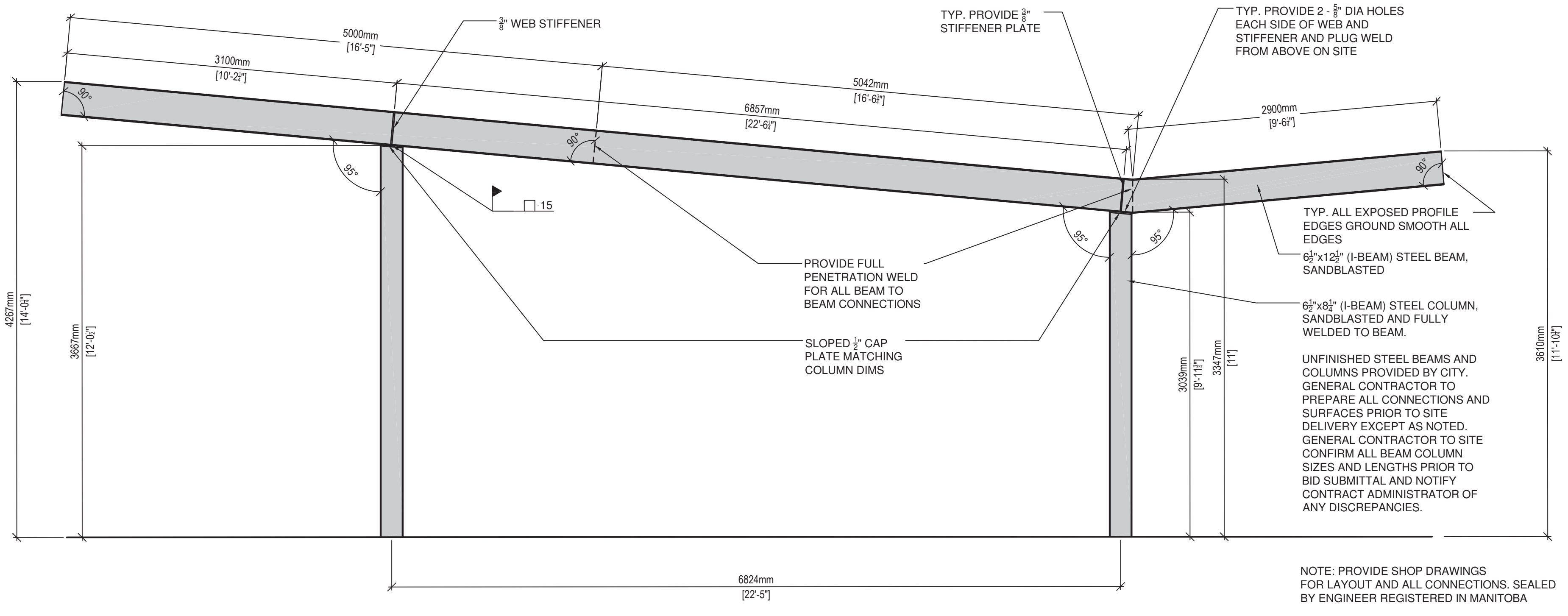

2 NORTH ELEVATION

1:30 (at 24x36)



Elizabeth Wreford Taylor
 Member No. 141
 June 1/12

Project:
LIVING PRAIRIE MUSEUM
 SHADE STRUCTURE AND WORKSHOP
 2795 NESS AVENUE

Project Number: **2011-182**

Drawing Title:
SHADE STRUCTURE ELEVATIONS

#	Issue/Revision	Date
1	33% DESIGN REVIEW	JAN. 14, 2012
2	64% DESIGN REVIEW	MAR. 19, 2012
3	99% DESIGN REVIEW	MAY 31, 2012
4	ISSUED FOR TENDER	JUNE 5, 2012

Sheet No:
L201

This drawing is property of the Crown Administrator and shall remain the property of the Crown Administrator. The contractor is responsible for checking and verifying the accuracy and completeness of all data prior to construction.