

MATCHLINE 0+450

BURROWS AVENUE

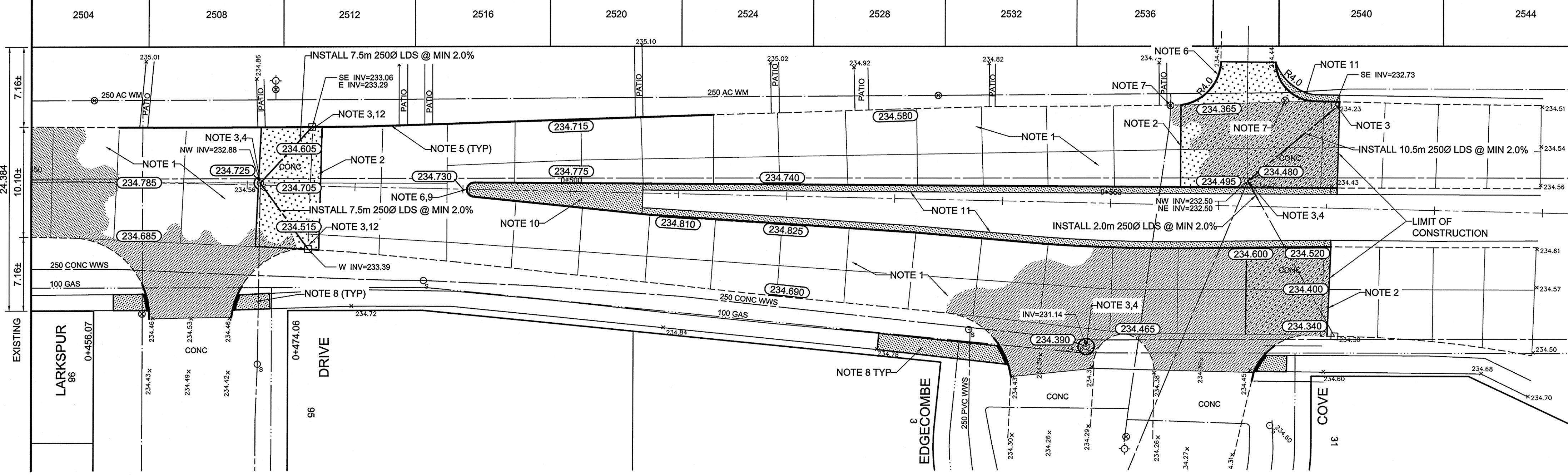

REFERENCE NOTES

- A. PAVEMENT DIMENSIONS ARE TO BACK OF CURB
- B. BASELINE IS CENTRE LINE RIGHT-OF-WAY
- C. PROPERTY LINES OBTAINED FROM CITY OF WINNIPEG L.B.I.S., AND NO SCALE FACTOR WAS APPLIED
- D. REFER TO AECOM FIELD BOOK NO. 4746

CONSTRUCTION NOTES

1. PLACE NEW TYPE 3 ASPHALTIC PAVEMENT (55mm AVG.) AND PLACE NEW TYPE 1A ASPHALTIC PAVEMENT (50mm AVG)
2. REMOVE EXISTING CONCRETE PAVEMENT AND CONSTRUCT NEW 150mm REINFORCED CONCRETE PAVEMENT
3. ADJUST EXISTING MANHOLE/CATCH BASIN TO GRADE
4. INSTALL NEW CAST IRON RISER RING
5. CONSTRUCT NEW BARRIER CURB (150mm REVEAL HT. DOWELLED)
6. CONSTRUCT NEW MODIFIED BARRIER CURB (150mm REVEAL HT. DOWELLED)
7. ADJUST EXISTING WATER VALVE TO GRADE
8. RENEW EXISTING 100mm CONCRETE SIDEWALK
9. CONSTRUCT NEW CONCRETE BULLNOSE
10. CONSTRUCT NEW MONOLITHIC CONCRETE MEDIAN
11. CONSTRUCT NEW MONOLITHIC CONCRETE SPLASH STRIP (150mm REVEAL HT. DOWELLED)
12. INSTALL NEW FRAME AND COVER (AP-008/AP-009)



METRIC
WHOLE NUMBERS INDICATE MILLIMETRES
DECIMALIZED NUMBERS INDICATE METRES

150 mm W.W.M.	WATERMAIN	150 mm W.W.M.	HYDRO	— x —	— x —	— x —	— x —
Hydrant	HYDRANT	M.T.S.	M.T.S.	— x —	— x —	— x —	— x —
Valve	VALVE	CONCRETE	CONCRETE	— x —	— x —	— x —	— x —
300mm L.D.S.	LAND DRAINAGE SEWER	ASPHALT	ASPHALT	— x —	— x —	— x —	— x —
250mm W.W.S.	WASTEWATER SEWER	PROPERTY LINE	PROPERTY LINE	— x —	— x —	— x —	— x —
Manhole	MANHOLE	SURVEY BAR	SURVEY BAR	— x —	— x —	— x —	— x —
Catch Basin	CATCH BASIN	ELEVATION	ELEVATION	— x —	— x —	— x —	— x —
Curb Inlet	CURB INLET	TREE	TREE	— x —	— x —	— x —	— x —
Junctions	JUNCTIONS	SIDEWALK RAMP	SIDEWALK RAMP	— x —	— x —	— x —	— x —
Culvert	CULVERT	CONCRETE SIDEWALK	CONCRETE SIDEWALK	— x —	— x —	— x —	— x —
Gas	GAS	FENCE	FENCE	— x —	— x —	— x —	— x —
EXISTING	LEGEND - PLAN	PROPOSED	EXISTING	LEGEND - PLAN	PROPOSED	EXISTING	LEGEND - PROFILE

LOCATION APPROVED UNDERGROUND STRUCTURES	DATE
SUPV. U/G STRUCTURES COMMITTEE	
NOTE:	
LOCATION OF UNDERGROUND STRUCTURES AS SHOWN ARE BASED ON THE BEST INFORMATION AVAILABLE. BUT NO GUARANTEE IS GIVEN THAT ALL EXISTING UTILITIES ARE SHOWN OR THAT THE GIVEN LOCATIONS ARE EXACT. CONFIRMATION OF EXISTENCE AND EXACT LOCATION OF ALL SERVICES MUST BE OBTAINED FROM THE INDIVIDUAL UTILITIES BEFORE PROCEEDING WITH CONSTRUCTION.	

B.M. 16-018	N.E. Cor. Burrows Ave. & Garden Grove Dr., 19 mm dia. x 6.1 m l.b. in Valve Box, 6 m S. of N.L. Burrows Ave. & on E.L. of Garden Grove Dr.		
ELEV. 234.641			
NO.	REVISIONS	DATE	BY
0	ISSUED FOR TENDER	05/08/2012	BC
A	ISSUED FOR REVIEW	04/24/2012	BC

AECOM	
DESIGNED BY	SS
CHECKED BY	KWR / BC
DRAWN BY	SS
APPROVED BY	
HOR. SCALE:	1:250
VERTICAL:	1:10
DATE	2012/04/17
RELEASED FOR CONSTRUCTION BY:	
DATE	May 8/12

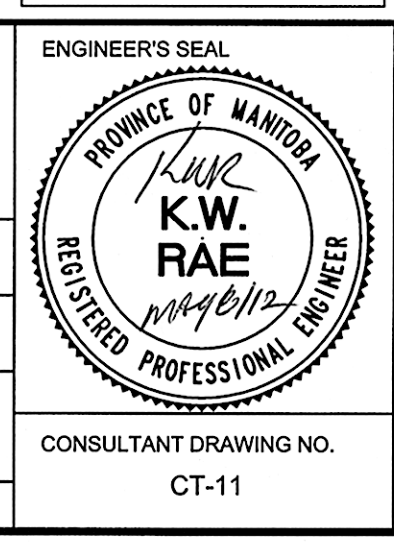

THE CITY OF WINNIPEG
PUBLIC WORKS DEPARTMENT
ENGINEERING DIVISION

2012 LOCAL STREET RENEWAL PROGRAM

BURROWS AVE. - HADDON ROAD TO INKSTER BOULEVARD
PAVEMENT REHABILITATION
STATION 0+450 TO EDGECOMBE COVE

CITY DRAWING NUMBER
SHEET 11 OF 27

CONSULTANT DRAWING NO. CT-11