

power pole required for electrical access; power req'd below desk too.

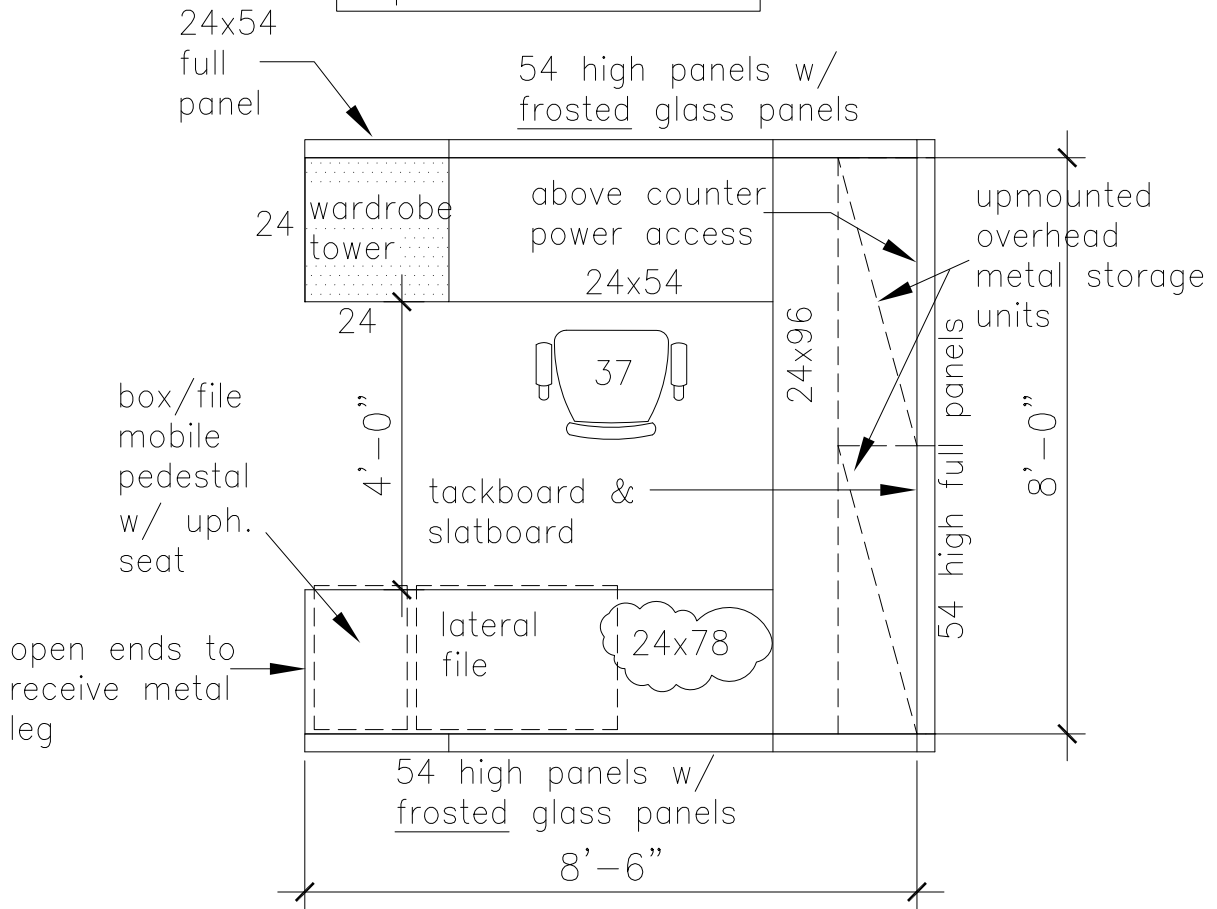

SWS "closed" workstation

 THE CITY OF WINNIPEG PLANNING, PROPERTY AND DEVELOPMENT DEPARTMENT MUNICIPAL ACCOMMODATIONS DIVISION 3-65 GARRY STREET, R3C 4K4		PROJECT  <b>SOLID WASTE/ IST RELOCATION</b> 1120 WAVERLY STREET			SHEET TITLE <b>SWS "CLOSED" WORKSTATIONS          ENLARGED PLAN</b>	
DRAWN BY: KN	CHECKED BY:	DESIGNED BY: KN	APPROVED BY:	DATE: 2012-05-01	SCALE: 3/8"=1'-0"	SHEET No:
				eFILE:	PROJECT No: 2012-035	<b>A6-R1</b>