

MATCHLINE 0+230

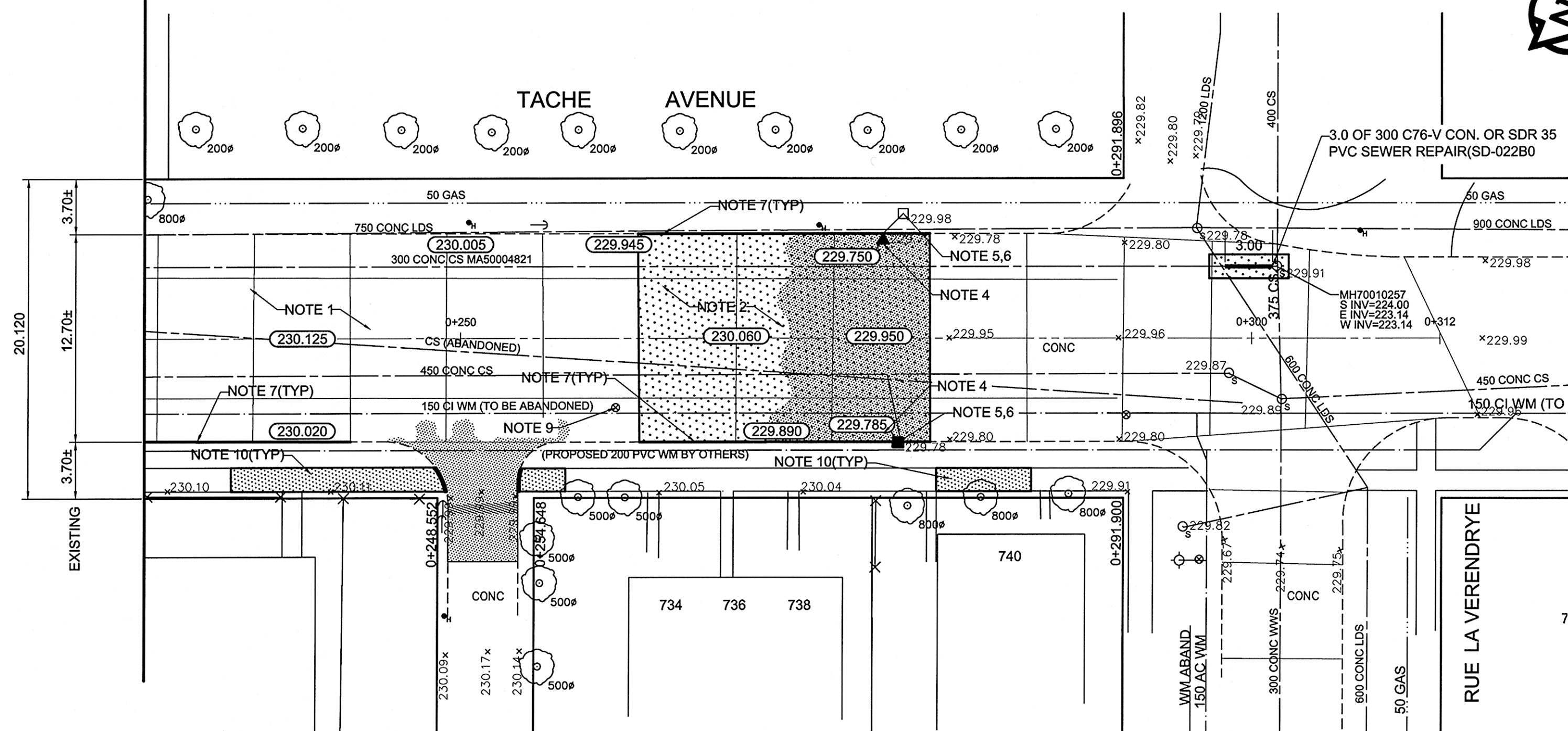

**REFERENCE NOTES**

- A. PAVEMENT DIMENSIONS ARE TO BACK OF CURB
- B. BASELINE IS CENTRE LINE RIGHT-OF-WAY
- C. PROPERTY LINES OBTAINED FROM CITY OF WINNIPEG L.B.I.S., AND NO SCALE FACTOR WAS APPLIED
- D. REFER TO AECOM FIELD BOOK NO. 4744

**CONSTRUCTION NOTES**

1. PLACE NEW ASPHALTIC PAVEMENT TYPE 1A (AVERAGE THICKNESS 80mm)
2. REMOVE EXISTING CONCRETE PAVEMENT AND CONSTRUCT NEW 200mm REINFORCED CONCRETE PAVEMENT c/w 85mm ASPHALT OVERLAY (TYPE 1A)
3. REMOVE EXISTING CONCRETE PAVEMENT AND CONSTRUCT NEW 200mm REINFORCED CONCRETE PAVEMENT
4. REMOVE EXISTING CATCHPIT AND INSTALL NEW CURB AND GUTTER INLET COMPLETE WITH CATCHPIT AND CONNECT TO EXISTING CATCH BASIN (SD-023)
5. ADJUST EXISTING MANHOLE/CATCH BASIN TO GRADE
6. INSTALL NEW CAST IRON RISER RING
7. CONSTRUCT NEW BARRIER CURB (150mm HT.)
8. CONSTRUCT NEW MODIFIED BARRIER CURB (150mm HT. DOWELLED)
9. ADJUST EXISTING WATER VALVE TO GRADE
10. RENEW EXISTING 100mm CONCRETE SIDEWALK
11. ADJUST EXISTING CURB STOP
12. REMOVE AND REPLACE EXISTING PAVERS
13. INSTALL NEW CURB AND GUTTER INLET c/w CATCH BASIN (SD-024) AND CONNECT NEW 250mm LED TO EXISTING 450mm CONCRETE SEWER



**METRIC**  
WHOLE NUMBERS INDICATE MILLIMETRES  
DECIMALIZED NUMBERS INDICATE METRES

150 mm W.M.	WATERMAIN	150 mm W.M.	HYDRO	— x —	PROFILE
Hydrant symbol	HYDRANT	Manhole symbol	M.T.S.	Northwest gutter symbol	NORTH/WEST GUTTER
Valve symbol	VALVE	Survey bar symbol	CONCRETE	South/east gutter symbol	SOUTH/EAST GUTTER
300mm L.D.S.	LAND DRAINAGE SEWER	300mm L.D.S.	ASPHALT	NW PROPERTY LINE symbol	NW PROPERTY LINE
250mm W.W.S.	WASTEWATER SEWER	250mm W.W.S.	PROPERTY LINE	S/E PROPERTY LINE symbol	S/E PROPERTY LINE
Manhole symbol	MANHOLE	Survey bar symbol	SURVEY BAR		
Catch basin symbol	CATCH BASIN	Elevation symbol (35.750)	ELEVATION		
Curb inlet symbol	CURB INLET	Tree symbol	TREE		
Junctions symbol	JUNCTIONS	Sidewalk ramp symbol	SIDEWALK RAMP		
Culvert symbol	CULVERT	Concrete sidewalk symbol	CONCRETE SIDEWALK		
Gas symbol	GAS	Fence symbol	FENCE		
Existing symbol	EXISTING	Proposed symbol	LEGEND - PLAN	Existing symbol	LEGEND - PROFILE
Proposed symbol	PROPOSED	Proposed symbol	LEGEND - PLAN	Proposed symbol	LEGEND - PROFILE

**LOCATION APPROVED UNDERGROUND STRUCTURES**

SUPV. U/G STRUCTURES COMMITTEE DATE

**NOTE:**  
LOCATION OF UNDERGROUND STRUCTURES AS SHOWN ARE BASED ON THE BEST INFORMATION AVAILABLE. BUT NO GUARANTEE IS GIVEN THAT ALL EXISTING UTILITIES ARE SHOWN OR THAT THE GIVEN LOCATIONS ARE EXACT. CONFIRMATION OF EXISTENCE AND EXACT LOCATION OF ALL SERVICES MUST BE OBTAINED FROM THE INDIVIDUAL UTILITIES BEFORE PROCEEDING WITH CONSTRUCTION.

B.M. M10R104  
ELEV. 231.146

Cap in 0.46m diam. concrete pile located in back on S/E corner of Tache ave. and Rue Masson, 1.90m East of most Easterly edge of sidewalk on East side of Tache and 2.16m SW of light standard in foot of Rue Masson.

0	ISSUED FOR TENDER	04/13/2012	BC
A	ISSUED FOR REVIEW	03/28/2012	BC
NO.	REVISIONS	DATE	BY

**AECOM**

DESIGNED BY	SS	CHECKED BY	KWR
DRAWN BY	MS	APPROVED BY	
HOR. SCALE:	1:250	RELEASED FOR CONSTRUCTION BY:	
VERTICAL:	1:10	DATE	April 13/12

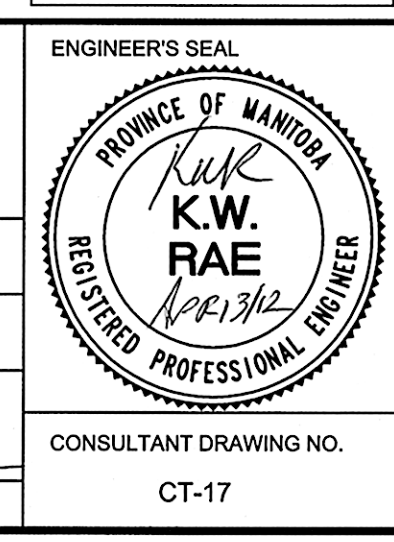

**THE CITY OF WINNIPEG**  
PUBLIC WORKS DEPARTMENT  
ENGINEERING DIVISION

2012 LOCAL STREET RENEWAL PROGRAM

TACHE AVE. - BOUL PROVENCHER TO RUE LA VERENDRYE  
PAVEMENT REHABILITATION  
STATION 0+230 TO STATION 0+379.7

CITY DRAWING NUMBER  
SHEET 17 OF 19

CONSULTANT DRAWING NO. CT-17