

SEWER JUNCTION INFORMATION*			
REF MH	DIST FROM MH	SIZE	CLOCK AT
MH20005015	34.30	150Ø	10
MH20005015	44.80	150Ø	11
MH20005015	45.50	150Ø	03
MH20005015	46.10	200Ø	12

*JUNCTION INFORMATION FROM VIDEO INSPECTION

- REFERENCE NOTES
- PAVEMENT DIMENSIONS ARE TO BACK OF CURB
 - BASELINE IS CENTRE LINE RIGHT-OF-WAY
 - PROPERTY LINES OBTAINED FROM CITY OF WINNIPEG L.B.I.S., AND NO SCALE FACTOR WAS APPLIED
 - REFER TO AECOM FIELD BOOK NO. 4726

VIDEO EXISTING COMBINED SEWER AFTER EXCAVATION PRIOR TO PLACEMENT OF NEW PAVEMENT

- CONSTRUCTION NOTES
- REMOVE EXISTING CONCRETE PAVEMENT AND CONSTRUCT NEW 100mm ASPHALTIC PAVEMENT (TYPE 1A)
 - REMOVE EXISTING CONCRETE PAVEMENT AND CONSTRUCT NEW 150mm REINFORCED CONCRETE PAVEMENT
 - REMOVE AND REINSTALL EXISTING PAVING STONES AND CONSTRUCT 150mm HT. CONCRETE BARRIER CURB EDGING
 - RENEW EXISTING 100mm CONCRETE SIDEWALK
 - CONSTRUCT NEW BARRIER CURB AND GUTTER (180mm HT.)
 - CONSTRUCT NEW LIP CURB AND GUTTER (40mm HT. INTEGRAL)
 - INSTALL NEW CURB AND GUTTER INLET c/w CATCH BASIN (SD-024) AND CONNECT NEW 250mm LEAD TO EXISTING MANHOLE
 - INSTALL 150mm SUBDRAIN
 - REMOVE EXISTING FRAME AND COVER AND PLACE NEW FRAME AND SOLID COVER (AP-004005)
 - ADJUST EXISTING MANHOLE TO GRADE
 - INSTALL NEW CAST IRON RISER RING
 - ADJUST EXISTING WATER VALVE TO GRADE
 - ADJUST EXISTING CURB STOP
 - RELOCATE EXISTING LIGHT STANDARD (BY OTHERS)
 - REMOVE EXISTING CATCHBASIN AND ABANDON EXISTING 300mm LDS SEWER

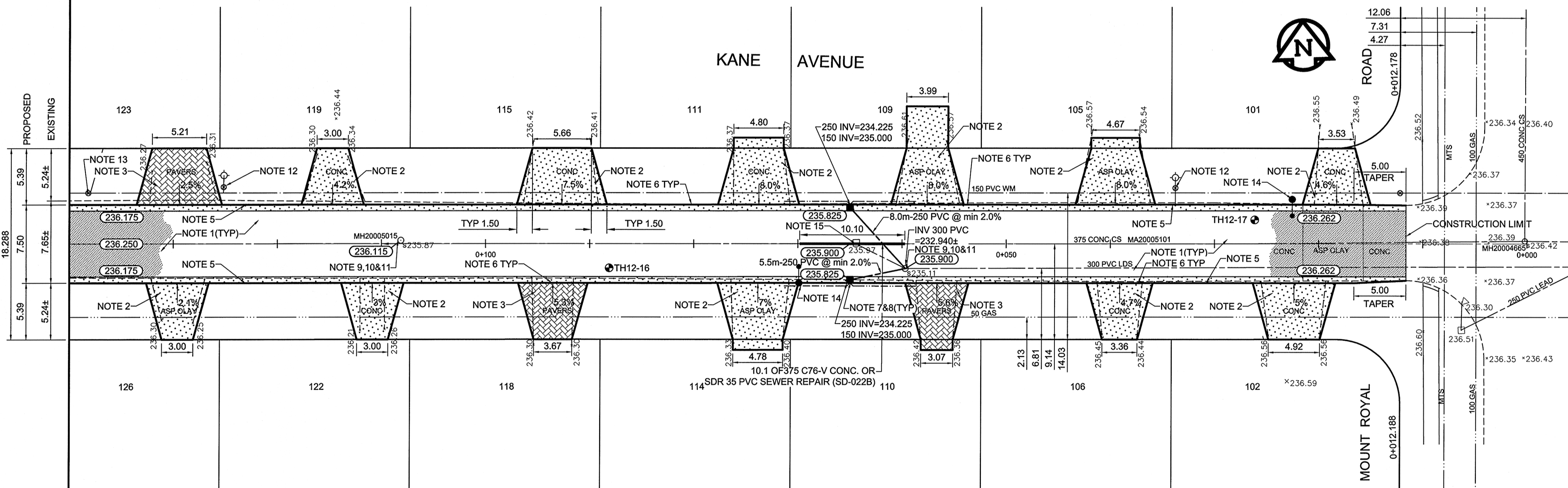

METRIC
WHOLE NUMBERS INDICATE MILLIMETRES
DECIMALIZED NUMBERS INDICATE METRES

EXISTING	LEGEND - PLAN	PROPOSED	EXISTING	LEGEND - PLAN	PROPOSED	EXISTING	LEGEND - PROFILE	PROPOSED
150 mm W.M.	WATERMAIN	150 mm W.M.	HYDRO	HYDRO	HYDRO	---	---	---
300mm L.D.S.	LAND DRAINAGE SEWER	300mm L.D.S.	CONCRETE	CONCRETE	CONCRETE	---	---	---
250mm W.W.S.	WASTEWATER SEWER	250mm W.W.S.	ASPHALT	ASPHALT	ASPHALT	---	---	---
○	MANHOLE	○	PROPERTY LINE	PROPERTY LINE	PROPERTY LINE	---	---	---
□	CATCH BASIN	□	SURVEY BAR	SURVEY BAR	SURVEY BAR	---	---	---
▽	CURB INLET	▽	ELEVATION	ELEVATION	ELEVATION	---	---	---
---	JUNCTIONS	---	TREE	TREE	TREE	---	---	---
---	CULVERT	---	SIDEWALK RAMP	SIDEWALK RAMP	SIDEWALK RAMP	---	---	---
---	GAS	---	CONCRETE SIDEWALK	CONCRETE SIDEWALK	CONCRETE SIDEWALK	---	---	---
---	LEGEND - PLAN	---	FENCE	FENCE	FENCE	---	---	---

LOCATION APPROVED UNDERGROUND STRUCTURES

DATE

NOTE:
LOCATION OF UNDERGROUND STRUCTURES AS SHOWN ARE BASED ON THE BEST INFORMATION AVAILABLE. BUT NO GUARANTEE IS GIVEN THAT ALL EXISTING UTILITIES ARE SHOWN OR THAT THE GIVEN LOCATIONS ARE EXACT. CONFIRMATION OF EXISTENCE AND EXACT LOCATION OF ALL SERVICES MUST BE OBTAINED FROM THE INDIVIDUAL UTILITIES BEFORE PROCEEDING WITH CONSTRUCTION.

NO.	REVISIONS	DATE	BY
0	ISSUED FOR TENDER	04/13/2012	BC
A	ISSUED FOR REVIEW	03/28/2012	BC

DESIGNED BY	BC	CHECKED BY	
DRAWN BY	SS	APPROVED BY	
HOR. SCALE:	1:250	RELEASED FOR CONSTRUCTION BY:	
VERTICAL:	1:10	DATE	April 13, 2012

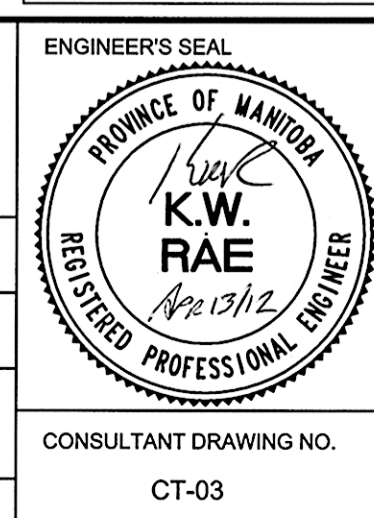

THE CITY OF WINNIPEG
PUBLIC WORKS DEPARTMENT
ENGINEERING DIVISION

2012 LOCAL STREET RENEWAL PROGRAM

KANE AVE. - MOUNT ROYAL RD. TO MOUNT ROYAL RD.
PAVEMENT RECONSTRUCTION
MOUNT ROYAL ROAD TO STATION 0+140

CITY DRAWING NUMBER
SHEET 3 OF 19

CONSULTANT DRAWING NO.
CT-03