

CARSON BAY (W. LEG)

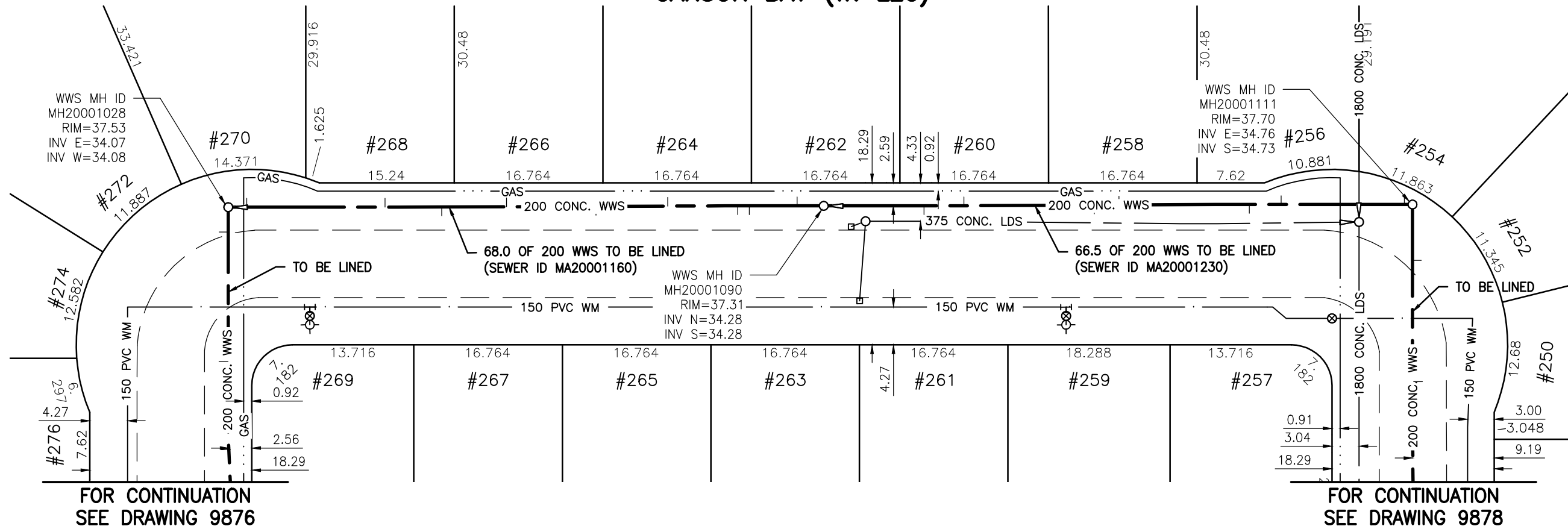

SEWER JUNCTION INFORMATION FOR SEWER ID MA20001160

REFERENCE—METERS SOUTH OF MANHOLE MH20001090

DIST. FROM REF. MANHOLE	JUNCTION DIA.	CLOCK REF.	SERVICE TYPE	DESCRIPTION
3.0	150	03	JN	LIVE
8.4	150	09	JN	CAPPED
9.6	150	09	CNI	-
17.6	150	03	JN	-
25.7	150	08	JN	-
35.8	150	03	JN	LIVE
43.1	150	09	JN	LIVE
49.5	150	03	JN	LIVE
65.1	150	03	JX	LIVE. CC IN ADJ. SEWER

ALL JUNCTION INFORMATION BASED ON CCTV INSPECTION

SEWER JUNCTION INFORMATION FOR SEWER ID MA20001230

REFERENCE—METERS SOUTH OF MANHOLE MH20001111

DIST. FROM REF. MANHOLE	JUNCTION DIA.	CLOCK REF.	SERVICE TYPE	DESCRIPTION
0.9	150	03	CN	LIVE
14.8	150	03	JN	-
18.4	150	09	CN	-
33.1	150	03	JN	LIVE
35.9	150	09	JN	LIVE
50.6	150	03	JN	LIVE
55.1	150	09	JN	LIVE

WARNING

IF POWER EQUIPMENT OR EXPLOSIVES ARE TO BE USED FOR EXCAVATION ON THIS PROJECT THE CONTRACTOR MUST:

- 1) NOTIFY THE GAS COMPANY OF THE PROPOSED LOCATION OF EXCAVATION.
- 2) TAKE PRECAUTION TO AVOID DAMAGE TO GAS COMPANY INSTALLATIONS.

SEE PROVINCIAL REGULATION 140/92 FOR DETAILS

METRIC

WHOLE NUMBERS INDICATE MILLIMETRES
DECIMALIZED NUMBERS INDICATE METRES

BENCH MARK: W. side Cavalier Dr., S. of Fairlane Ave., Tblt. in E. Conc. foundation No. 664 Cavalier Dr., 2.5 m S. & 0.2 m below brick of N.E. Cor. of dwelling.



Certificate of Authorization

Stantec Consulting Ltd.

No. 1301 Date: _____

BID OPPORTUNITY 927-2011

LOCATION APPROVED
UNDERGROUND STRUCTURES

B.M. 40-026
ELEV. 237.452m

SUPV. U/G STRUCTURES COMMITTEE DATE

NOTE:
LOCATION OF UNDERGROUND STRUCTURES AS SHOWN ARE BASED ON THE BEST INFORMATION AVAILABLE BUT NO GUARANTEE IS GIVEN THAT ALL EXISTING UTILITIES ARE SHOWN OR THAT THE GIVEN LOCATIONS ARE EXACT. CONFIRMATION OF EXISTENCE AND EXACT LOCATION OF ALL SERVICES MUST BE OBTAINED FROM THE INDIVIDUAL UTILITIES BEFORE PROCEEDING WITH CONSTRUCTION.

NO.	REVISIONS	DATE	BY



Stantec Consulting Ltd.

905 Waverley Street, Winnipeg, Manitoba
Tel 204-489-5900 Fax 204-453-9012

DESIGNED BY	J.K.H.	CHECKED BY	W.A.B.
DRAWN BY	K.R.	APPROVED BY	H.A.K.
HOR. SCALE:	1:500	RELEASED FOR CONSTRUCTION:	
VERTICAL:	N/A	DATE	2011.10.08

ENGINEER'S SEAL

CONSULTANT DRAWING NO.
C-210



THE CITY OF WINNIPEG
WATER AND WASTE DEPARTMENT

2011 SEWER RENEWALS
BY CIPP LINING - CONTRACT 21
CARSON BAY (W. LEG)

MH AT CARSON BY. (N. LEG) (PL) TO
MH AT CARSON BY. (S. LEG) (PL)

SHEET OF	113 OF 119
CAD FILE DRAWING NUMBER	13220c-207-766.dwg
CITY DRAWING NUMBER	9879