

**SEWER JUNCTION INFORMATION
FOR SEWER ID MA20001136**

REFERENCE--METERS EAST OF MANHOLE MH20001004

DIST. FROM REF. MANHOLE	JUNCTION DIA.	CLOCK REF.	SERVICE TYPE	DESCRIPTION
1.4	150	02	JN	-
1.9	150	10	JN	LIVE
12.9	100	02	JN	-
15.7	100	09	JN	LIVE
29.0	150	03	CX	CRACKED
29.3	150	02	JN	CAPPED
34.8	100	10	JN	LIVE
44.6	150	02	JN	CAPPED
47.5	100	02	CN	-
54.4	150	10	CNI	-
76.2	150	10	CN	W DEG
88.0	150	03	JN	-
93.5	150	09	JN	W DEG

ALL JUNCTION INFORMATION
BASED ON CCTV INSPECTION

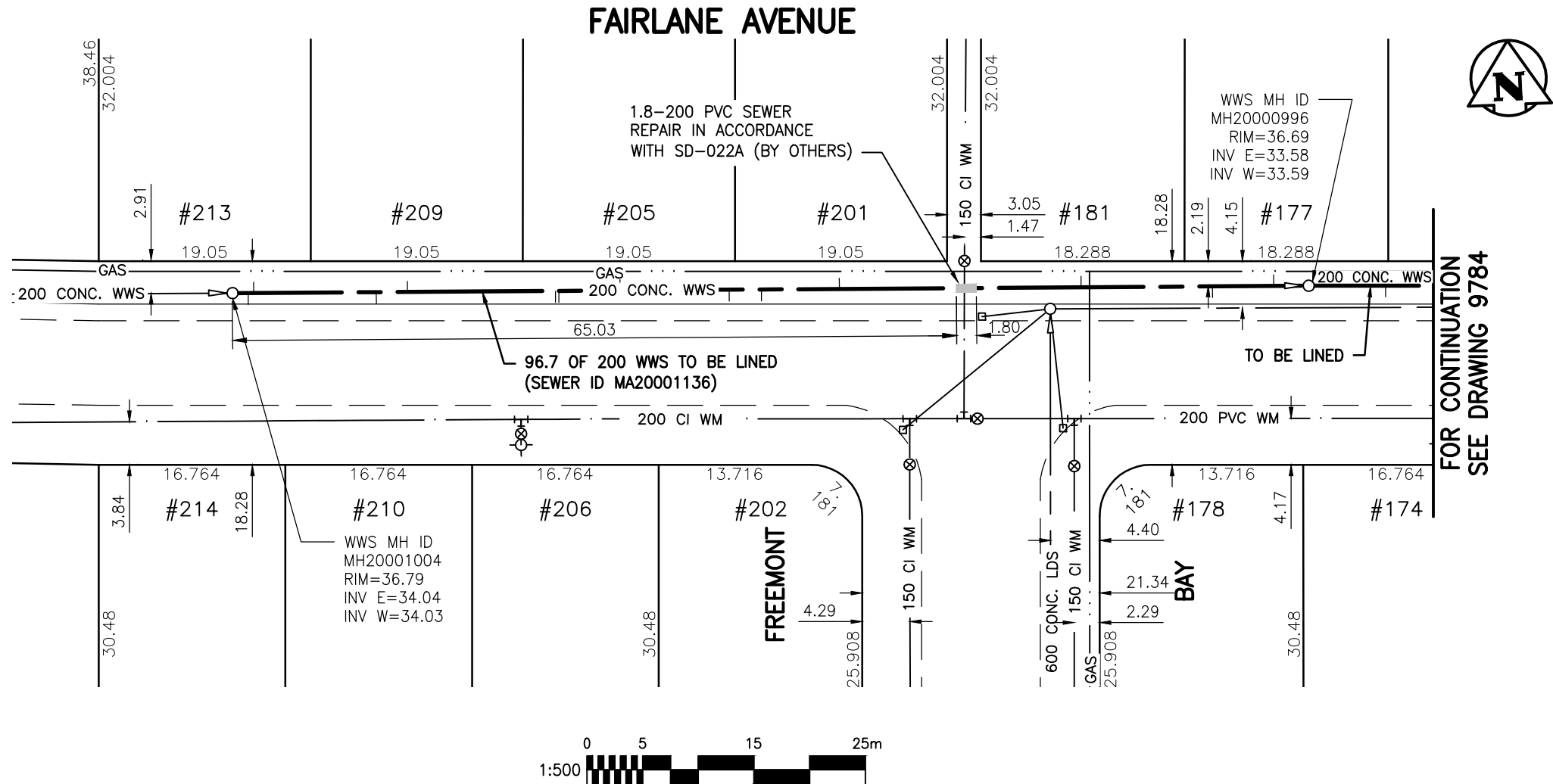

FOR CONTINUATION
SEE DRAWING 9784

WARNING

IF POWER EQUIPMENT OR EXPLOSIVES ARE TO BE USED FOR EXCAVATION ON THIS PROJECT THE CONTRACTOR MUST:

- 1) NOTIFY THE GAS COMPANY OF THE PROPOSED LOCATION OF EXCAVATION.
- 2) TAKE PRECAUTION TO AVOID DAMAGE TO GAS COMPANY INSTALLATIONS.

SEE PROVINCIAL REGULATION 140/92 FOR DETAILS

METRIC

WHOLE NUMBERS INDICATE MILLIMETRES
DECIMALIZED NUMBERS INDICATE METRES

BENCH MARK: W. side Cavalier Dr., S. of Fairlane Ave., Tblt. in E. Conc. foundation No. 664 Cavalier Dr., 2.5 m S. & 0.2 m below brick of N.E. Cor. of dwelling.

APEGM
Certificate of Authorization
Stantec Consulting Ltd.
No. 1301 Date: _____

BID OPPORTUNITY 927-2011

<p>LOCATION APPROVED UNDERGROUND STRUCTURES</p> <p>SUPV. U/G STRUCTURES COMMITTEE _____ DATE _____</p> <p>NOTE: LOCATION OF UNDERGROUND STRUCTURES AS SHOWN ARE BASED ON THE BEST INFORMATION AVAILABLE BUT NO GUARANTEE IS GIVEN THAT ALL EXISTING UTILITIES ARE SHOWN OR THAT THE GIVEN LOCATIONS ARE EXACT. CONFIRMATION OF EXISTENCE AND EXACT LOCATION OF ALL SERVICES MUST BE OBTAINED FROM THE INDIVIDUAL UTILITIES BEFORE PROCEEDING WITH CONSTRUCTION.</p>	<p>B.M. 40-026 ELEV. 237.452m</p>	<p>Stantec Consulting Ltd. 905 Waverley Street, Winnipeg, Manitoba Tel 204-489-5900 Fax 204-453-9012</p>	<p>ENGINEER'S SEAL</p>	<p>THE CITY OF WINNIPEG WATER AND WASTE DEPARTMENT</p>																	
		<table border="1" style="width: 100%; border-collapse: collapse;"> <tr> <td>DESIGNED BY</td><td>J.K.H.</td> <td>CHECKED BY</td><td>W.A.B.</td> </tr> <tr> <td>DRAWN BY</td><td>K.R.</td> <td>APPROVED BY</td><td>H.A.K.</td> </tr> <tr> <td>HOR. SCALE:</td><td>1:500</td> <td>RELEASED FOR CONSTRUCTION:</td><td></td> </tr> <tr> <td>VERTICAL:</td><td>N/A</td> <td>DATE</td><td>2011.10.08</td> </tr> </table>	DESIGNED BY	J.K.H.	CHECKED BY	W.A.B.	DRAWN BY	K.R.	APPROVED BY	H.A.K.	HOR. SCALE:	1:500	RELEASED FOR CONSTRUCTION:		VERTICAL:	N/A	DATE	2011.10.08	<p>CONSULTANT DRAWING NO. C-206</p>	<p>2011 SEWER RENEWALS BY CIPP LINING - CONTRACT 21 FAIRLANE AVENUE</p> <p>1ST MH W. OF FREEMONT BY. (PL) TO 1ST MH E. OF FREEMONT BY. (PL)</p>	
DESIGNED BY	J.K.H.	CHECKED BY	W.A.B.																		
DRAWN BY	K.R.	APPROVED BY	H.A.K.																		
HOR. SCALE:	1:500	RELEASED FOR CONSTRUCTION:																			
VERTICAL:	N/A	DATE	2011.10.08																		
	<table border="1" style="width: 100%; border-collapse: collapse;"> <tr> <td>NO.</td><td>REVISIONS</td><td>DATE</td><td>BY</td> </tr> <tr> <td> </td><td> </td><td> </td><td> </td> </tr> </table>	NO.	REVISIONS	DATE	BY							<table border="1" style="width: 100%; border-collapse: collapse;"> <tr> <td>SHEET OF</td><td>109</td><td>119</td> </tr> <tr> <td>CAD FILE DRAWING NUMBER</td><td colspan="2">I3220c-I86-766.dwg</td> </tr> <tr> <td>CITY DRAWING NUMBER</td><td colspan="2">9875</td> </tr> </table>	SHEET OF	109	119	CAD FILE DRAWING NUMBER	I3220c-I86-766.dwg		CITY DRAWING NUMBER	9875	
NO.	REVISIONS	DATE	BY																		
SHEET OF	109	119																			
CAD FILE DRAWING NUMBER	I3220c-I86-766.dwg																				
CITY DRAWING NUMBER	9875																				

\\CD1201-F02\work_group\1112\active\111213220\drawing\402_design\sheet_files\13220c-186-766.dwg
Date: 2011-12-19 4:51pm Login: Ammeter, Wes