

**SEWER JUNCTION INFORMATION
FOR SEWER ID MA20001126**

REFERENCE--METERS EAST OF MANHOLE MH20000996

DIST. FROM REF. MANHOLE	JUNCTION DIA.	CLOCK REF.	SERVICE TYPE	DESCRIPTION
6.9	150	02	JN	-
16.0	100	10	CN	LIVE
24.2	150	03	CN	-
32.4	150	10	CN	LIVE
39.7	150	03	CNI	LIVE
51.5	100	10	CN	-
57.5	150	03	CNI	-
58.8	150	03	CN	CAPPED
69.8	150	09	JN	LIVE
75.3	150	02	JN	CAPPED
75.6	150	02	CNI	LIVE

REFERENCE--METERS WEST OF MANHOLE MH20001010

DIST. FROM REF. MANHOLE	JUNCTION DIA.	CLOCK REF.	SERVICE TYPE	DESCRIPTION
3.0	100	10	CN	-
8.5	150	03	CNI	-
20.9	150	10	CN	-

ALL JUNCTION INFORMATION
BASED ON CCTV INSPECTION

FAIRLANE AVENUE

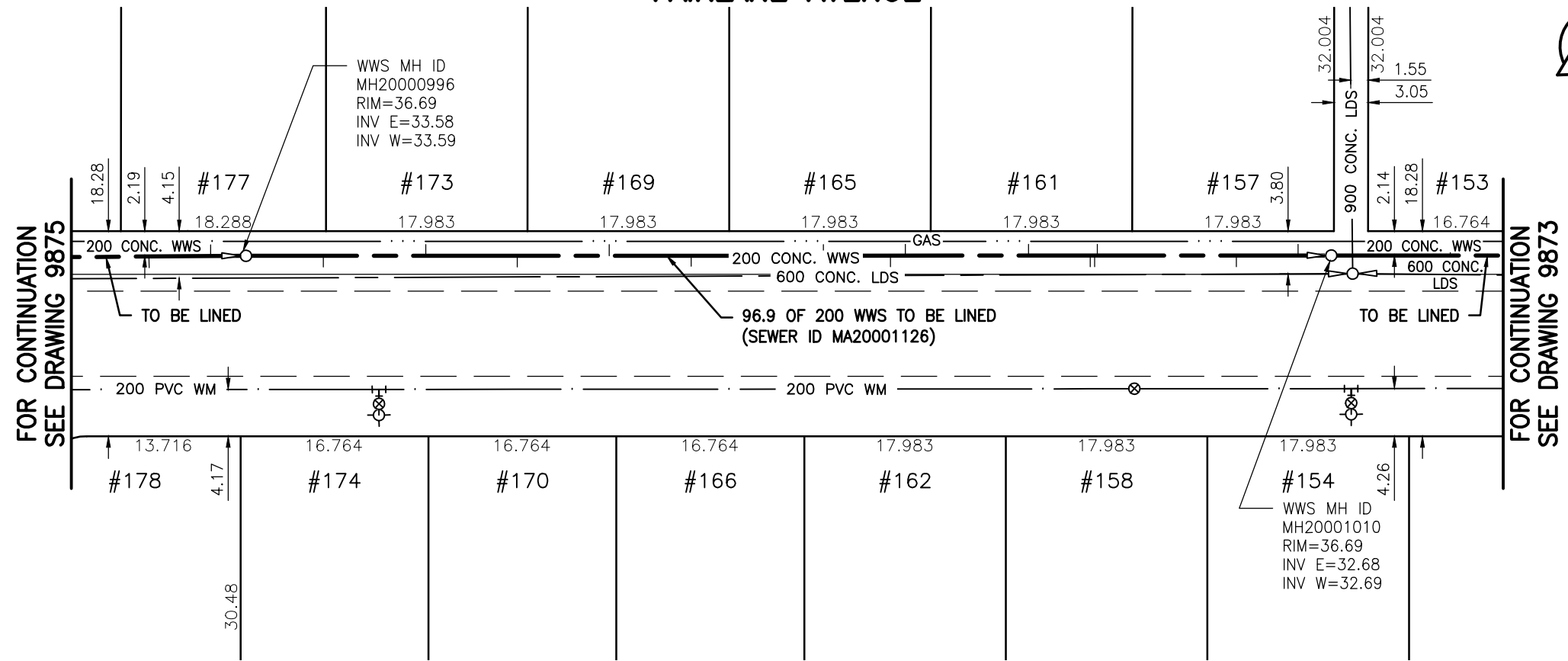

WARNING

IF POWER EQUIPMENT OR EXPLOSIVES ARE TO BE USED FOR EXCAVATION ON THIS PROJECT THE CONTRACTOR MUST:

- 1) NOTIFY THE GAS COMPANY OF THE PROPOSED LOCATION OF EXCAVATION.
- 2) TAKE PRECAUTION TO AVOID DAMAGE TO GAS COMPANY INSTALLATIONS.

SEE PROVINCIAL REGULATION 140/92 FOR DETAILS

METRIC

WHOLE NUMBERS INDICATE MILLIMETRES
DECIMALIZED NUMBERS INDICATE METRES

BENCH MARK: W. side Cavalier Dr., S. of Fairlane Ave., Tblt. in E. Conc. foundation No. 664 Cavalier Dr., 2.5 m S. & 0.2 m below brick of N.E. Cor. of dwelling.

APEGM
Certificate of Authorization
Stantec Consulting Ltd.
No. 1301 Date: _____

BID OPPORTUNITY 927-2011

<p>LOCATION APPROVED UNDERGROUND STRUCTURES</p> <p>SUPV. U/G STRUCTURES COMMITTEE _____ DATE _____</p> <p>NOTE: LOCATION OF UNDERGROUND STRUCTURES AS SHOWN ARE BASED ON THE BEST INFORMATION AVAILABLE BUT NO GUARANTEE IS GIVEN THAT ALL EXISTING UTILITIES ARE SHOWN OR THAT THE GIVEN LOCATIONS ARE EXACT. CONFIRMATION OF EXISTENCE AND EXACT LOCATION OF ALL SERVICES MUST BE OBTAINED FROM THE INDIVIDUAL UTILITIES BEFORE PROCEEDING WITH CONSTRUCTION.</p>	<p>B.M. 40-026 ELEV. 237.452m</p>	<p>Stantec Consulting Ltd. 905 Waverley Street, Winnipeg, Manitoba Tel 204-489-5900 Fax 204-453-9012</p>	<p>ENGINEER'S SEAL</p>	<p>THE CITY OF WINNIPEG WATER AND WASTE DEPARTMENT</p>																																	
<table border="1" style="width:100%; border-collapse: collapse;"> <thead> <tr> <th>NO.</th> <th>REVISIONS</th> <th>DATE</th> <th>BY</th> </tr> </thead> <tbody> <tr><td> </td><td> </td><td> </td><td> </td></tr> <tr><td> </td><td> </td><td> </td><td> </td></tr> <tr><td> </td><td> </td><td> </td><td> </td></tr> <tr><td> </td><td> </td><td> </td><td> </td></tr> </tbody> </table>	NO.	REVISIONS	DATE	BY																	<table border="1" style="width:100%; border-collapse: collapse;"> <tr> <td style="width:50%;">DESIGNED BY J.K.H.</td> <td style="width:50%;">CHECKED BY W.A.B.</td> </tr> <tr> <td>DRAWN BY K.R.</td> <td>APPROVED BY H.A.K.</td> </tr> <tr> <td>HOR. SCALE: VERTICAL:</td> <td>RELEASED FOR CONSTRUCTION:</td> </tr> <tr> <td>1:500 N/A</td> <td> </td> </tr> <tr> <td>DATE 2011.10.08</td> <td>DATE </td> </tr> </table>	DESIGNED BY J.K.H.	CHECKED BY W.A.B.	DRAWN BY K.R.	APPROVED BY H.A.K.	HOR. SCALE: VERTICAL:	RELEASED FOR CONSTRUCTION:	1:500 N/A		DATE 2011.10.08	DATE 	<p>CONSULTANT DRAWING NO. C-205</p>	<p>2011 SEWER RENEWALS BY CIPP LINING - CONTRACT 21 FAIRLANE AVENUE 1ST MH E. OF FREEMONT BY. (PL) TO 2ND MH E. OF FREEMONT BY. (PL)</p>	<table border="1" style="width:100%; border-collapse: collapse;"> <tr> <td>SHEET OF 108 OF 119</td> </tr> <tr> <td>CAD FILE DRAWING NUMBER 13220c-186-766.dwg</td> </tr> <tr> <td>CITY DRAWING NUMBER 9874</td> </tr> </table>	SHEET OF 108 OF 119	CAD FILE DRAWING NUMBER 13220c-186-766.dwg	CITY DRAWING NUMBER 9874
NO.	REVISIONS	DATE	BY																																		
DESIGNED BY J.K.H.	CHECKED BY W.A.B.																																				
DRAWN BY K.R.	APPROVED BY H.A.K.																																				
HOR. SCALE: VERTICAL:	RELEASED FOR CONSTRUCTION:																																				
1:500 N/A																																					
DATE 2011.10.08	DATE 																																				
SHEET OF 108 OF 119																																					
CAD FILE DRAWING NUMBER 13220c-186-766.dwg																																					
CITY DRAWING NUMBER 9874																																					

\\CD1201-F02\work_group\1112\active\111213220\drawing\402_design\sheet_files\13220c-186-766.dwg
 Date: 2011-12-19 4:51pm Login: Ammeter, Wes