

# FAIRLANE AVENUE

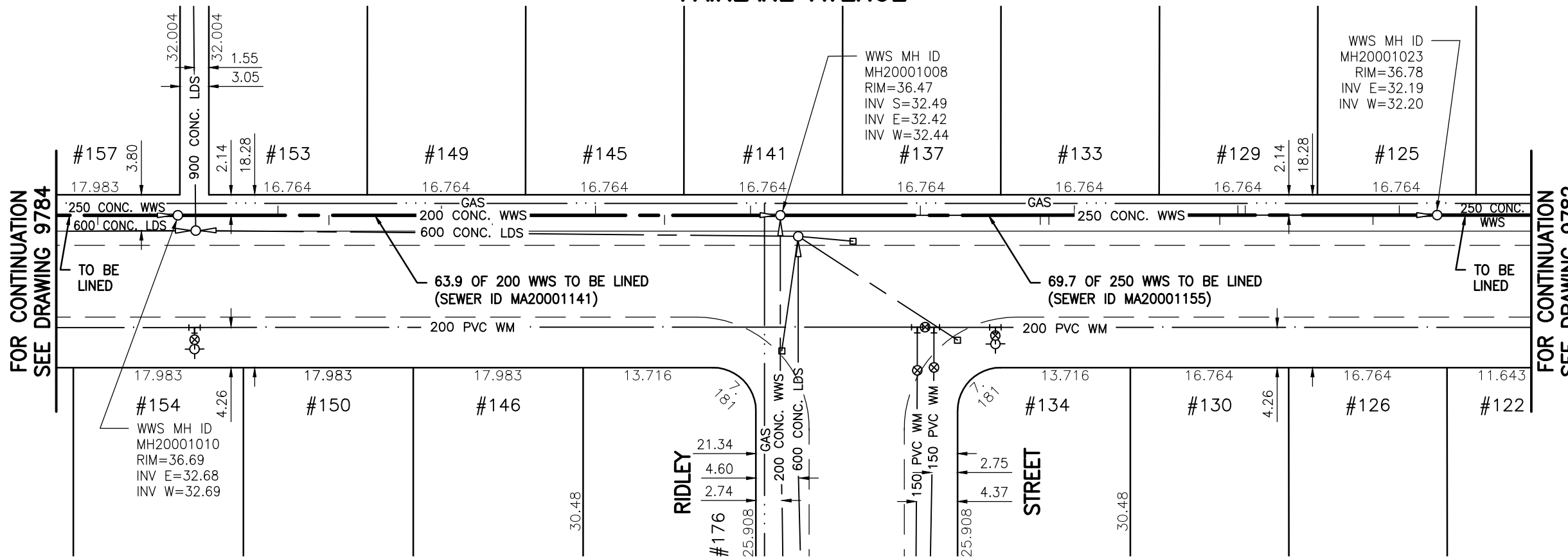

### SEWER JUNCTION INFORMATION FOR SEWER ID MA20001141

REFERENCE—METERS EAST OF MANHOLE MH20001010

DIST. FROM REF. MANHOLE	JUNCTION DIA.	CLOCK REF.	SERVICE TYPE	DESCRIPTION
10.6	150	11	JN	LIVE
16.0	100	02	CN	LIVE
27.9	150	11	JN	LIVE
33.3	150	01	CN	W RM
44.2	150	10	CN	LIVE
51.5	100	01	CN	LIVE
60.6	150	11	CN	W RF

ALL JUNCTION INFORMATION BASED ON CCTV INSPECTION

### SEWER JUNCTION INFORMATION FOR SEWER ID MA20001155

REFERENCE—METERS EAST OF MANHOLE MH20001008

DIST. FROM REF. MANHOLE	JUNCTION DIA.	CLOCK REF.	SERVICE TYPE	DESCRIPTION
14.8	100	11	JN	—
27.5	100	01	JN	LIVE
28.4	100	01	JN	—
31.1	150	11	JN	LIVE
46.5	100	01	JN	—
48.4	100	11	JX	LIVE. FRACTURED
49.2	150	10	CN	W RF
62.7	100	01	JN	—
65.5	100	11	JN	LIVE

## WARNING

IF POWER EQUIPMENT OR EXPLOSIVES ARE TO BE USED FOR EXCAVATION ON THIS PROJECT THE CONTRACTOR MUST:

- 1) NOTIFY THE GAS COMPANY OF THE PROPOSED LOCATION OF EXCAVATION.
- 2) TAKE PRECAUTION TO AVOID DAMAGE TO GAS COMPANY INSTALLATIONS.

SEE PROVINCIAL REGULATION 140/92 FOR DETAILS

## METRIC

WHOLE NUMBERS INDICATE MILLIMETRES  
DECIMALIZED NUMBERS INDICATE METRES

BENCH MARK: W. side Cavalier Dr., S. of Fairlane Ave., Tblt. in E. Conc. foundation No. 664 Cavalier Dr., 2.5 m S. & 0.2 m below brick of N.E. Cor. of dwelling.



Certificate of Authorization

Stantec Consulting Ltd.

No. 1301 Date: \_\_\_\_\_

BID OPPORTUNITY 927-2011

### LOCATION APPROVED UNDERGROUND STRUCTURES

B.M. 40-026  
ELEV. 237.452m

SUPV. U/G STRUCTURES COMMITTEE DATE

#### NOTE:

LOCATION OF UNDERGROUND STRUCTURES AS SHOWN ARE BASED ON THE BEST INFORMATION AVAILABLE BUT NO GUARANTEE IS GIVEN THAT ALL EXISTING UTILITIES ARE SHOWN OR THAT THE GIVEN LOCATIONS ARE EXACT. CONFIRMATION OF EXISTENCE AND EXACT LOCATION OF ALL SERVICES MUST BE OBTAINED FROM THE INDIVIDUAL UTILITIES BEFORE PROCEEDING WITH CONSTRUCTION.

NO.	REVISIONS	DATE	BY



### Stantec Consulting Ltd.

905 Waverley Street, Winnipeg, Manitoba  
Tel 204-489-5900 Fax 204-453-9012

DESIGNED BY	J.K.H.	CHECKED BY	W.A.B.
DRAWN BY	K.R.	APPROVED BY	H.A.K.
HOR. SCALE:	1:500	RELEASED FOR CONSTRUCTION:	
VERTICAL:	N/A	DATE	2011.10.08

ENGINEER'S SEAL

CONSULTANT DRAWING NO.  
**C-204**



## THE CITY OF WINNIPEG WATER AND WASTE DEPARTMENT

### 2011 SEWER RENEWALS BY CIPP LINING - CONTRACT 21 FAIRLANE AVENUE

1ST MH E. OF RIDLEY ST. (PL) TO  
2ND MH E. OF FREEMONT BY. (PL)

SHEET	OF	
107		119
CAD FILE DRAWING NUMBER 13220c-186-766.dwg		
CITY DRAWING NUMBER <b>9873</b>		