

\\CD1201-F02\work\_group\1112\active\111213220\drawing\402\_design\sheet\_files\13220c-186-766.dwg  
 Date: 2011-12-19 4:12pm Login: Ammeter, Wes

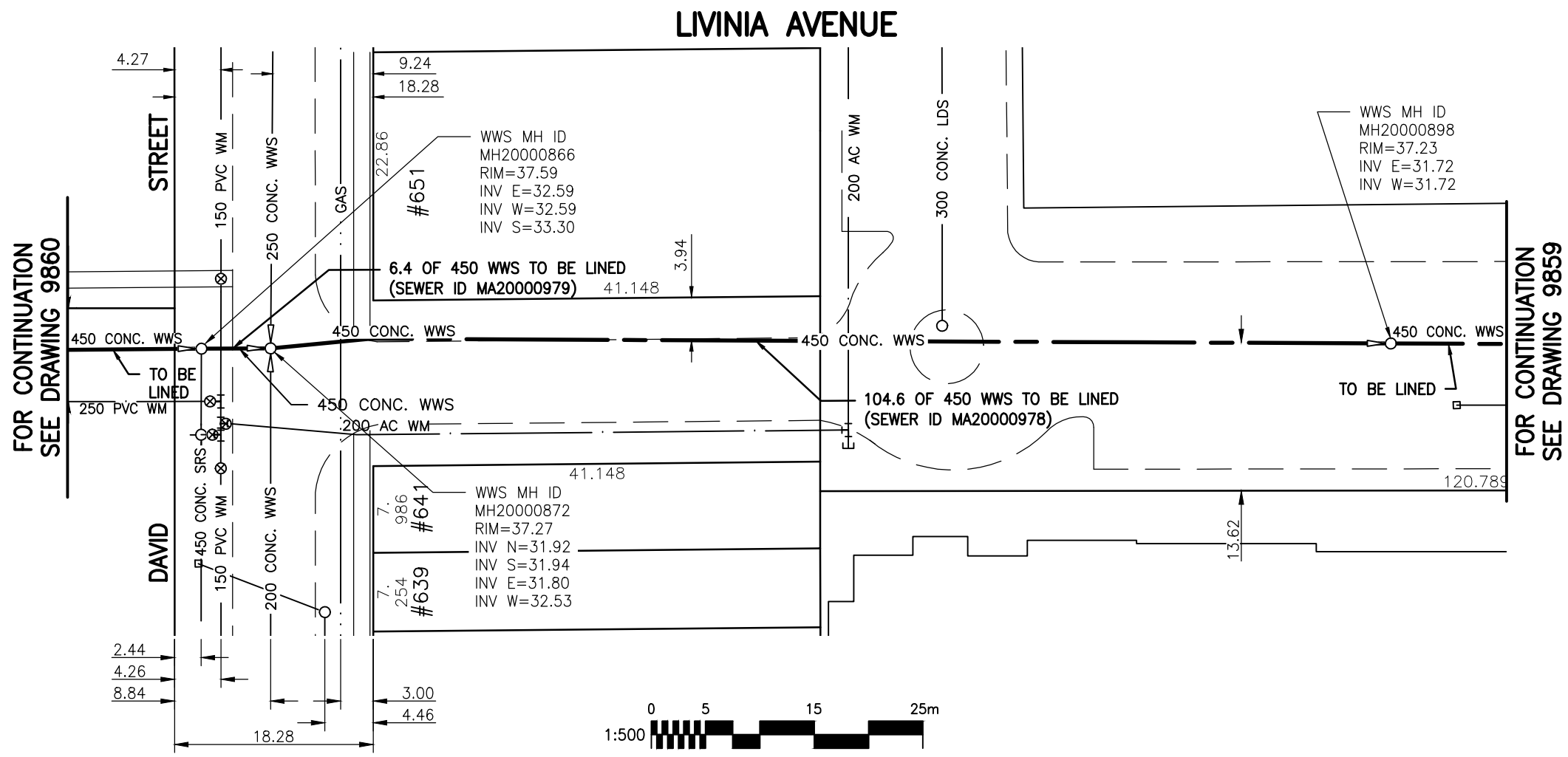

### WARNING

IF POWER EQUIPMENT OR EXPLOSIVES ARE TO BE USED FOR EXCAVATION ON THIS PROJECT THE CONTRACTOR MUST:

- 1) NOTIFY THE GAS COMPANY OF THE PROPOSED LOCATION OF EXCAVATION.
- 2) TAKE PRECAUTION TO AVOID DAMAGE TO GAS COMPANY INSTALLATIONS.

SEE PROVINCIAL REGULATION 140/92 FOR DETAILS

### METRIC

WHOLE NUMBERS INDICATE MILLIMETRES  
 DECIMALIZED NUMBERS INDICATE METRES

BENCH MARK: N.Side Portage Ave. & Bedson St., Tblt. in most Sly. Conc. foundation of No. 3535 Portage Ave., 0.5 m E. & 0.3 m below Tyndall Stone of S.W. Cor. of apartment block.

Certificate of Authorization  
 Stantec Consulting Ltd.  
 No. 1301 Date: \_\_\_\_\_

BID OPPORTUNITY 927-2011

<b>LOCATION APPROVED UNDERGROUND STRUCTURES</b>  SUPV. U/G STRUCTURES COMMITTEE _____ DATE _____  <b>NOTE:</b> LOCATION OF UNDERGROUND STRUCTURES AS SHOWN ARE BASED ON THE BEST INFORMATION AVAILABLE BUT NO GUARANTEE IS GIVEN THAT ALL EXISTING UTILITIES ARE SHOWN OR THAT THE GIVEN LOCATIONS ARE EXACT. CONFIRMATION OF EXISTENCE AND EXACT LOCATION OF ALL SERVICES MUST BE OBTAINED FROM THE INDIVIDUAL UTILITIES BEFORE PROCEEDING WITH CONSTRUCTION.	B.M. 40-030 ELEV. 238.035m  <table border="1" style="width: 100%; border-collapse: collapse;"> <thead> <tr> <th>NO.</th> <th>REVISIONS</th> <th>DATE</th> <th>BY</th> </tr> </thead> <tbody> <tr><td> </td><td> </td><td> </td><td> </td></tr> <tr><td> </td><td> </td><td> </td><td> </td></tr> <tr><td> </td><td> </td><td> </td><td> </td></tr> <tr><td> </td><td> </td><td> </td><td> </td></tr> </tbody> </table>	NO.	REVISIONS	DATE	BY																	<p><b>Stantec Consulting Ltd.</b>          905 Waverley Street, Winnipeg, Manitoba          Tel 204-489-5900 Fax 204-453-9012</p> <table border="1" style="width: 100%; border-collapse: collapse;"> <tr> <td>DESIGNED BY J.K.H.</td> <td>CHECKED BY W.A.B.</td> </tr> <tr> <td>DRAWN BY K.R.</td> <td>APPROVED BY H.A.K.</td> </tr> <tr> <td>HOR. SCALE: VERTICAL:</td> <td>RELEASED FOR CONSTRUCTION:</td> </tr> <tr> <td>1:500 N/A</td> <td> </td> </tr> </table>	DESIGNED BY J.K.H.	CHECKED BY W.A.B.	DRAWN BY K.R.	APPROVED BY H.A.K.	HOR. SCALE: VERTICAL:	RELEASED FOR CONSTRUCTION:	1:500 N/A		ENGINEER'S SEAL    CONSULTANT DRAWING NO. <p style="text-align: center;"><b>C-190</b></p>	<p><b>THE CITY OF WINNIPEG</b>  <b>WATER AND WASTE DEPARTMENT</b></p> <div style="border: 1px solid black; padding: 5px; text-align: center;"> <p><b>2011 SEWER RENEWALS</b>          BY CIPP LINING - CONTRACT 21  <b>LIVINIA AVENUE</b>          MH AT DAVID ST. (W. PL) TO          1ST MH E. OF DAVID ST.</p> </div> <table border="1" style="width: 100%; border-collapse: collapse; margin-top: 10px;"> <tr> <td style="text-align: center;">SHEET OF</td> <td style="text-align: center;">93 OF 119</td> </tr> <tr> <td colspan="2" style="text-align: center;">CAD FILE DRAWING NUMBER 13220c-186-766.dwg</td> </tr> <tr> <td colspan="2" style="text-align: center;">CITY DRAWING NUMBER <b>9859</b></td> </tr> </table>	SHEET OF	93 OF 119	CAD FILE DRAWING NUMBER 13220c-186-766.dwg		CITY DRAWING NUMBER <b>9859</b>	
NO.	REVISIONS	DATE	BY																																			
DESIGNED BY J.K.H.	CHECKED BY W.A.B.																																					
DRAWN BY K.R.	APPROVED BY H.A.K.																																					
HOR. SCALE: VERTICAL:	RELEASED FOR CONSTRUCTION:																																					
1:500 N/A																																						
SHEET OF	93 OF 119																																					
CAD FILE DRAWING NUMBER 13220c-186-766.dwg																																						
CITY DRAWING NUMBER <b>9859</b>																																						