

BANCROFT BAY (W. LEG)

FOR CONTINUATION
SEE DRAWING 9848



SEWER JUNCTION INFORMATION FOR SEWER ID MA20000622

REFERENCE—METERS NORTH OF MANHOLE MH20000547

DIST. FROM REF. MANHOLE	JUNCTION DIA.	CLOCK REF.	SERVICE TYPE	DESCRIPTION
7.6	150	10	CN	—
9.5	150	02	CN	LIVE
12.2	150	02	CN	CAPPED
24.8	150	10	CN	CAPPED
27.5	150	11	CNI	—
29.5	150	10	CN	LIVE
45.7	150	02	CN	—

SEWER JUNCTION INFORMATION FOR SEWER ID MA20000627

REFERENCE—METERS SOUTH OF MANHOLE MH20000550

DIST. FROM REF. MANHOLE	JUNCTION DIA.	CLOCK REF.	SERVICE TYPE	DESCRIPTION
8.7	150	03	CNI	LIVE
10.5	150	09	CN	LIVE
27.0	150	02	JN	RM INSIDE
28.7	150	09	JN	LIVE

ALL JUNCTION INFORMATION
BASED ON CCTV INSPECTION

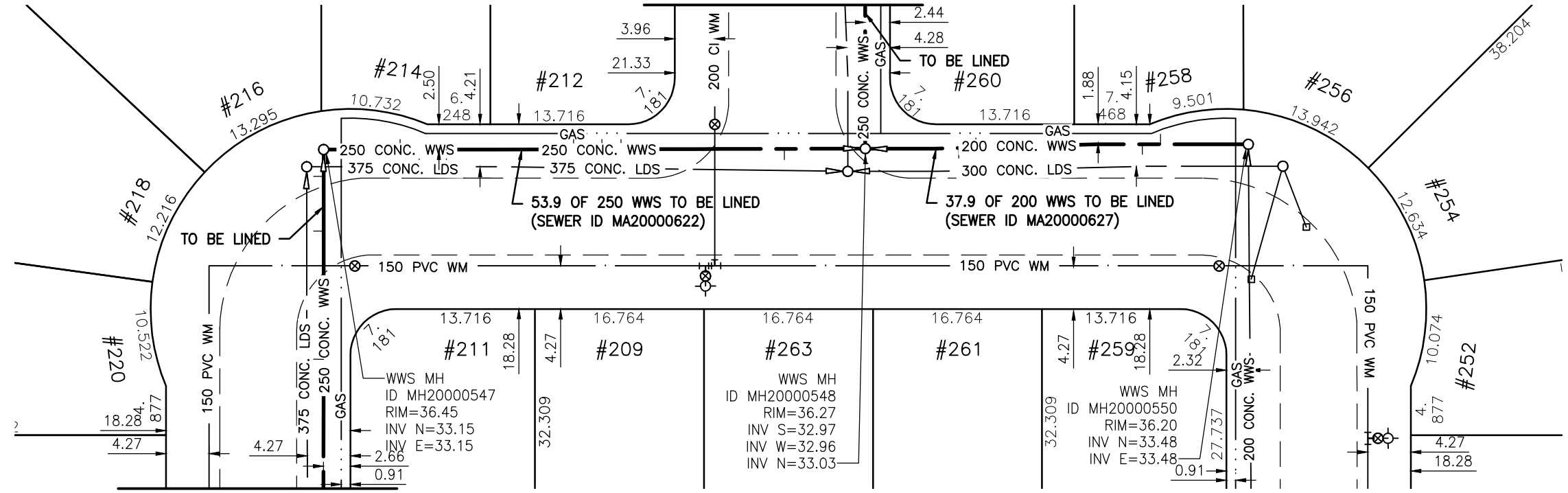

FOR CONTINUATION
SEE DRAWING 9846

WARNING

IF POWER EQUIPMENT OR EXPLOSIVES ARE TO BE USED FOR EXCAVATION ON THIS PROJECT THE CONTRACTOR MUST:

- 1) NOTIFY THE GAS COMPANY OF THE PROPOSED LOCATION OF EXCAVATION.
- 2) TAKE PRECAUTION TO AVOID DAMAGE TO GAS COMPANY INSTALLATIONS.

SEE PROVINCIAL REGULATION 140/92 FOR DETAILS

METRIC

WHOLE NUMBERS INDICATE MILLIMETRES
DECIMALIZED NUMBERS INDICATE METRES

BENCH MARK: W. side Cavalier Dr., S. of Fairlane Ave., Tblt. in E. Conc. foundation No. 664 Cavalier Dr., 2.5 m S. & 0.2 m below brick of N.E. Cor. of Dwelling.

Certificate of Authorization
Stantec Consulting Ltd.
No. 1301 Date: _____

BID OPPORTUNITY 927-2011

LOCATION APPROVED UNDERGROUND STRUCTURES

SUPV. U/G STRUCTURES COMMITTEE DATE

NOTE:
LOCATION OF UNDERGROUND STRUCTURES AS SHOWN ARE BASED ON THE BEST INFORMATION AVAILABLE BUT NO GUARANTEE IS GIVEN THAT ALL EXISTING UTILITIES ARE SHOWN OR THAT THE GIVEN LOCATIONS ARE EXACT. CONFIRMATION OF EXISTENCE AND EXACT LOCATION OF ALL SERVICES MUST BE OBTAINED FROM THE INDIVIDUAL UTILITIES BEFORE PROCEEDING WITH CONSTRUCTION.

NO.	REVISIONS	DATE	BY

Stantec Consulting Ltd.
905 Waverley Street, Winnipeg, Manitoba
Tel 204-489-5900 Fax 204-453-9012

DESIGNED BY	J.K.H.	CHECKED BY	W.A.B.
DRAWN BY	K.R.	APPROVED BY	H.A.K.
HOR. SCALE:	1:500	RELEASED FOR CONSTRUCTION:	
VERTICAL:	N/A	DATE	2011.10.05

ENGINEER'S SEAL

CONSULTANT DRAWING NO.
C-178

**THE CITY OF WINNIPEG
WATER AND WASTE DEPARTMENT**

**2011 SEWER RENEWALS
BY CIPP LINING - CONTRACT 21
BANCROFT BAY (W. LEG)**

MH AT BANCROFT BY. (S. LEG) (PL) TO
MH AT BANCROFT BY. (N. LEG) (PL)

SHEET OF	81 OF 119
CAD FILE DRAWING NUMBER	13220c-161-766.dwg
CITY DRAWING NUMBER	9847

\\CD1201-F02\work_group\1112\active\111213220\drawing\402_design\sheet_files\13220c-161-766.dwg
 Date: 2011-12-19 3:50pm Login: Ammeter, Wes