

**SEWER JUNCTION INFORMATION  
FOR SEWER ID MA20000645**

REFERENCE—METERS NORTH OF MANHOLE MH20000569

DIST. FROM REF. MANHOLE	JUNCTION DIA.	CLOCK REF.	SERVICE TYPE	DESCRIPTION
2.3	150	02	CN	-
5.2	150	02	CNI	-
7.0	150	02	CNI	LIVE
13.8	150	10	CN	-
16.0	150	03	CN	-
31.4	150	10	CN	-
33.2	150	02	CN	-
47.7	150	10	CN	-
49.5	150	02	CN	-
65.0	150	10	CN	-
66.8	150	02	CN	LIVE
80.4	150	10	CN	-
82.2	150	02	CN	LIVE

ALL JUNCTION INFORMATION BASED ON CCTV INSPECTION

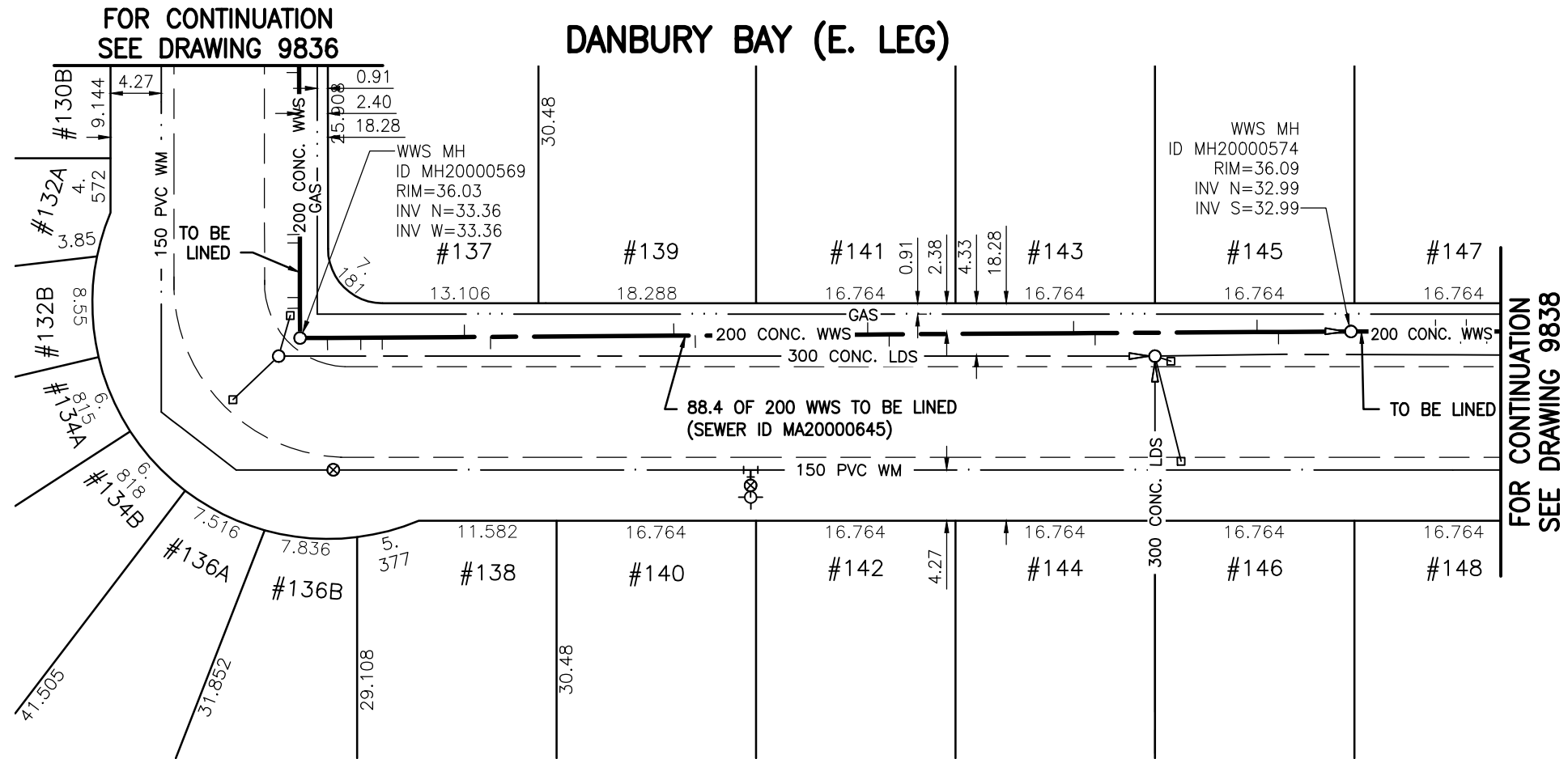

**WARNING**

IF POWER EQUIPMENT OR EXPLOSIVES ARE TO BE USED FOR EXCAVATION ON THIS PROJECT THE CONTRACTOR MUST:

- 1) NOTIFY THE GAS COMPANY OF THE PROPOSED LOCATION OF EXCAVATION.
- 2) TAKE PRECAUTION TO AVOID DAMAGE TO GAS COMPANY INSTALLATIONS.

SEE PROVINCIAL REGULATION 140/92 FOR DETAILS

**METRIC**

WHOLE NUMBERS INDICATE MILLIMETRES  
DECIMALIZED NUMBERS INDICATE METRES

BENCH MARK: W. side Cavalier Dr., S. of Fairlane Ave., Tblt. in E. Conc. foundation No. 664 Cavalier Dr., 2.5 m S. & 0.2 m below brick of N.E. Cor. of Dwelling.



Certificate of Authorization

Stantec Consulting Ltd.

No. 1301 Date: \_\_\_\_\_

BID OPPORTUNITY 927-2011

LOCATION APPROVED  
UNDERGROUND STRUCTURES

B.M. 40-026  
ELEV. 237.452m

SUPV. U/G STRUCTURES COMMITTEE DATE

NOTE:  
LOCATION OF UNDERGROUND STRUCTURES AS SHOWN ARE BASED ON THE BEST INFORMATION AVAILABLE BUT NO GUARANTEE IS GIVEN THAT ALL EXISTING UTILITIES ARE SHOWN OR THAT THE GIVEN LOCATIONS ARE EXACT. CONFIRMATION OF EXISTENCE AND EXACT LOCATION OF ALL SERVICES MUST BE OBTAINED FROM THE INDIVIDUAL UTILITIES BEFORE PROCEEDING WITH CONSTRUCTION.

NO.	REVISIONS	DATE	BY



**Stantec Consulting Ltd.**

905 Waverley Street, Winnipeg, Manitoba  
Tel 204-489-5900 Fax 204-453-9012

DESIGNED BY	J.K.H.	CHECKED BY	W.A.B.
DRAWN BY	K.R.	APPROVED BY	H.A.K.
HOR. SCALE:	1:500	RELEASED FOR CONSTRUCTION:	
VERTICAL:	N/A	DATE	2011.10.05

ENGINEER'S SEAL

CONSULTANT DRAWING NO.  
**C-168**



**THE CITY OF WINNIPEG**  
WATER AND WASTE DEPARTMENT

**2011 SEWER RENEWALS**  
BY CIPP LINING - CONTRACT 21  
**DANBURY BAY (E. LEG)**  
MH AT DANBURY BY. (S. LEG) (PL) TO  
1ST MH N. OF DANBURY BY. (S. LEG) (PL)

SHEET OF	71 OF 119
CAD FILE DRAWING NUMBER	I3220c-161-766.dwg
CITY DRAWING NUMBER	<b>9837</b>