

PORTAGE AVENUE



SEWER JUNCTION INFORMATION  
FOR SEWER ID MA20003799

REFERENCE—METERS WEST OF MANHOLE MH20003537

DIST. FROM REF. MANHOLE	JUNCTION DIA.	CLOCK REF.	SERVICE TYPE	DESCRIPTION
5.9	150	10	CNI	LIVE
47.0	150	02	CN	-
47.8	150	12	CNI	LIVE
55.7	150	01	CN	-

ALL JUNCTION INFORMATION  
BASED ON CCTV INSPECTION

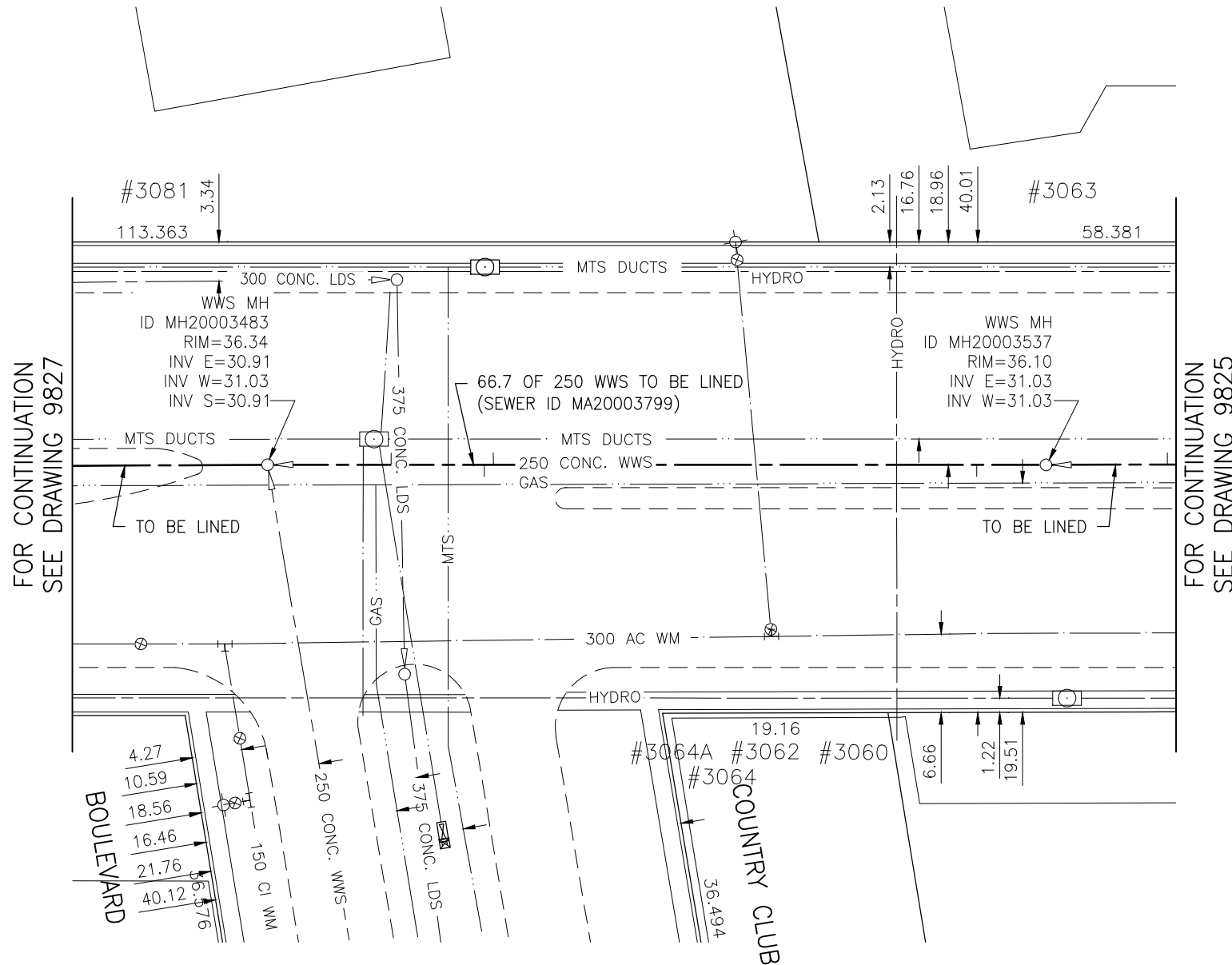

FOR CONTINUATION  
SEE DRAWING 9827

FOR CONTINUATION  
SEE DRAWING 9825

**WARNING**

IF POWER EQUIPMENT OR EXPLOSIVES ARE TO BE USED FOR EXCAVATION ON THIS PROJECT THE CONTRACTOR MUST:

- 1) NOTIFY THE GAS COMPANY OF THE PROPOSED LOCATION OF EXCAVATION.
- 2) TAKE PRECAUTION TO AVOID DAMAGE TO GAS COMPANY INSTALLATIONS.

SEE PROVINCIAL REGULATION 140/92 FOR DETAILS

**METRIC**

WHOLE NUMBERS INDICATE MILLIMETRES  
DECIMALIZED NUMBERS INDICATE METRES

BENCH MARK: S.W. Cor. Portage Ave. & Woodlands Cres., Tblt. in E. Conc. foundation of Bldg. (Goodyear Auto Service), 0.7 m S. & 0.1 m below brick of N.E. cor. of Bldg.



Certificate of Authorization

Stantec Consulting Ltd.

No. 1301 Date: \_\_\_\_\_

BID OPPORTUNITY 927-2011

LOCATION APPROVED  
UNDERGROUND STRUCTURES

B.M.	41-009		
ELEV.	236.224m		
SUPV. U/G STRUCTURES COMMITTEE	DATE		
NOTE:	LOCATION OF UNDERGROUND STRUCTURES AS SHOWN ARE BASED ON THE BEST INFORMATION AVAILABLE BUT NO GUARANTEE IS GIVEN THAT ALL EXISTING UTILITIES ARE SHOWN OR THAT THE GIVEN LOCATIONS ARE EXACT. CONFIRMATION OF EXISTENCE AND EXACT LOCATION OF ALL SERVICES MUST BE OBTAINED FROM THE INDIVIDUAL UTILITIES BEFORE PROCEEDING WITH CONSTRUCTION.		
NO.	REVISIONS	DATE	BY



**Stantec Consulting Ltd.**

905 Waverley Street, Winnipeg, Manitoba  
Tel 204-489-5900 Fax 204-453-9012

DESIGNED BY	J.K.H.	CHECKED BY	W.A.B.
DRAWN BY	K.R.	APPROVED BY	H.A.K.
HOR. SCALE:	1:500	RELEASED FOR CONSTRUCTION:	
VERTICAL:	N/A	DATE	2011.10.04

ENGINEER'S SEAL

CONSULTANT DRAWING NO.

C-157



**THE CITY OF WINNIPEG**

**WATER AND WASTE DEPARTMENT**

2011 SEWER RENEWALS  
BY CIPP LINING - CONTRACT 21  
PORTAGE AVENUE

1ST MH E. OF COUNTRY CLUB BV. (CL) TO  
MH AT COUNTRY CLUB BV. (CL)

SHEET	OF	
60		119
CAD FILE DRAWING NUMBER I3220c-I40-766.dwg		
CITY DRAWING NUMBER 9826		

\\CD1201-F02\work\_group\1112\active\111213220\drawing\402\_design\sheet\_files\13220c-140-766.dwg  
 Date: 2011-12-19 2:30pm Login: Ammeter, Wes