



**SEWER JUNCTION INFORMATION
FOR SEWER ID MA20004217**

REFERENCE—METERS EAST OF MANHOLE MH20003875

DIST. FROM REF. MANHOLE	JUNCTION DIA.	CLOCK REF.	SERVICE TYPE	DESCRIPTION
2.6	100	02	CN	LIVE
3.1	100	10	CNI	LIVE
19.5	100	02	JN	-
20.5	100	09	JN	-
37.2	100	11	CN	LIVE
37.9	100	01	CN	LIVE
55.3	100	11	CNI	LIVE
55.9	100	02	CNI	LIVE

ALL JUNCTION INFORMATION
BASED ON CCTV INSPECTION

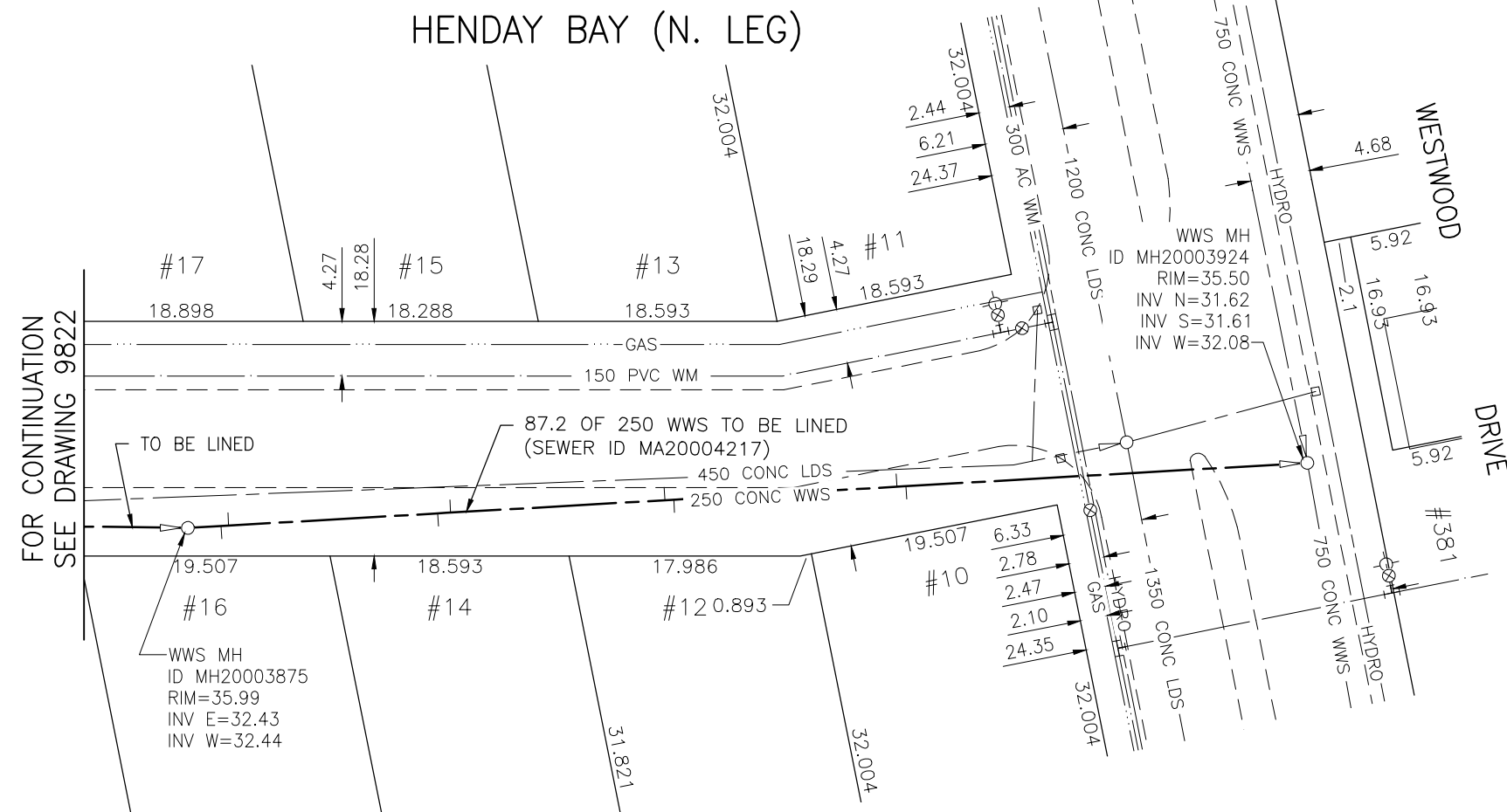

WARNING

IF POWER EQUIPMENT OR EXPLOSIVES ARE TO BE USED FOR EXCAVATION ON THIS PROJECT THE CONTRACTOR MUST:

- 1) NOTIFY THE GAS COMPANY OF THE PROPOSED LOCATION OF EXCAVATION.
- 2) TAKE PRECAUTION TO AVOID DAMAGE TO GAS COMPANY INSTALLATIONS.

SEE PROVINCIAL REGULATION 140/92 FOR DETAILS

METRIC

WHOLE NUMBERS INDICATE MILLIMETRES
DECIMALIZED NUMBERS INDICATE METRES

BENCH MARK: UNSTABLE — S. W. Cor.
Henday Bay & Westwood Dr., (S. Leg of
Henday Bay) Tblt in E. Conc. foundation No.
57 Henday Bay 0.8 m S. & 0.2 below stucco
of N.E. Cor. of dwelling.

Certificate of Authorization
Stantec Consulting Ltd.
No. 1301 Date: _____

BID OPPORTUNITY 927-2011

**LOCATION APPROVED
UNDERGROUND STRUCTURES**

NO.	REVISIONS	DATE	BY

SUPV. U/G STRUCTURES COMMITTEE DATE

NOTE:
LOCATION OF UNDERGROUND STRUCTURES AS SHOWN ARE BASED ON THE BEST INFORMATION AVAILABLE BUT NO GUARANTEE IS GIVEN THAT ALL EXISTING UTILITIES ARE SHOWN OR THAT THE GIVEN LOCATIONS ARE EXACT. CONFIRMATION OF EXISTENCE AND EXACT LOCATION OF ALL SERVICES MUST BE OBTAINED FROM THE INDIVIDUAL UTILITIES BEFORE PROCEEDING WITH CONSTRUCTION.

Stantec Consulting Ltd.
905 Waverley Street, Winnipeg, Manitoba
Tel 204-489-5900 Fax 204-453-9012

DESIGNED BY	J.K.H.	CHECKED BY	W.A.B.
DRAWN BY	K.R.	APPROVED BY	H.A.K.
HOR. SCALE:	1:500	RELEASED FOR CONSTRUCTION:	
VERTICAL:	N/A	DATE	2011.10.04

ENGINEER'S SEAL

CONSULTANT DRAWING NO.
C-152

THE CITY OF WINNIPEG
WATER AND WASTE DEPARTMENT

2011 SEWER RENEWALS
BY CIPP LINING - CONTRACT 21
HENDAY BAY (N. LEG)
1ST MH W. OF WESTWOOD DR. (PL) TO
MH AT WESTWOOD DR. (PL)

SHEET	OF
55	119
CAD FILE DRAWING NUMBER I3220c-I40-766.dwg	
CITY DRAWING NUMBER 9821	

\\CD1201-F02\work_group\1112\active\111213220\drawing\402_design\sheet_files\13220c-140-766.dwg
 Date: 2011-12-19 2:20pm Login: Ammeter, Wes