



**SEWER JUNCTION INFORMATION
FOR SEWER ID MA20002787**

REFERENCE—METERS SOUTH OF MANHOLE MH20003290

DIST. FROM REF. MANHOLE	JUNCTION DIA.	CLOCK REF.	SERVICE TYPE	DESCRIPTION
1.4	150	10	CN	LIVE
2.1	150	02	CNI	—
21.6	150	03	CXI	LIVE. H IN ADJ. SEWER
22.8	150	11	CXI	LIVE. SSM IN ADJ. SEWER
41.8	150	02	CX	LIVE. FC IN ADJ. SEWER
43.5	150	10	CX	SSM IN ADJ. SEWER
63.4	150	03	CNI	LIVE
64.6	150	10	CN	LIVE

ALL JUNCTION INFORMATION
BASED ON CCTV INSPECTION

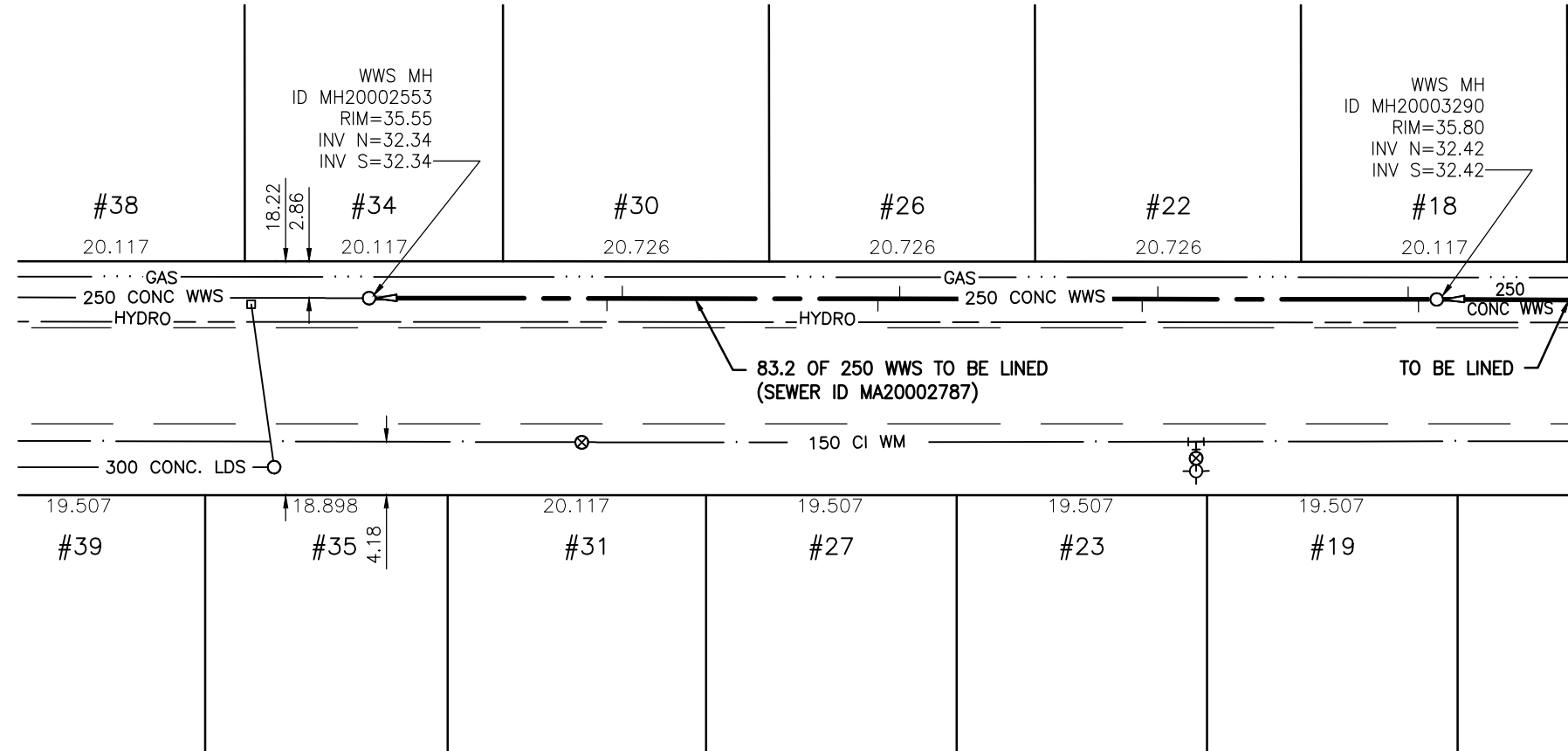

FOR CONTINUATION
SEE DRAWING 9797

WARNING

IF POWER EQUIPMENT OR EXPLOSIVES ARE TO BE USED FOR EXCAVATION ON THIS PROJECT THE CONTRACTOR MUST:

- 1) NOTIFY THE GAS COMPANY OF THE PROPOSED LOCATION OF EXCAVATION.
- 2) TAKE PRECAUTION TO AVOID DAMAGE TO GAS COMPANY INSTALLATIONS.

SEE PROVINCIAL REGULATION 140/92 FOR DETAILS

METRIC

WHOLE NUMBERS INDICATE MILLIMETRES
DECIMALIZED NUMBERS INDICATE METRES

BENCH MARK: S.W. Cor. Browning Blvd. & Pinehurst Cres., 19 mm dia. x 6.1 m I.B. in valve box, 0.3 m N. of S.L. Browning Blvd. & 0.3 m W. of W.L. Pinehurst Cres.



APEGM
Certificate of Authorization
Stantec Consulting Ltd.
No. 1301 Date: _____

BID OPPORTUNITY 927-2011

**LOCATION APPROVED
UNDERGROUND STRUCTURES**

NO.	REVISIONS	DATE	BY

SUPV. U/G STRUCTURES COMMITTEE DATE

NOTE:
LOCATION OF UNDERGROUND STRUCTURES AS SHOWN ARE BASED ON THE BEST INFORMATION AVAILABLE BUT NO GUARANTEE IS GIVEN THAT ALL EXISTING UTILITIES ARE SHOWN OR THAT THE GIVEN LOCATIONS ARE EXACT. CONFIRMATION OF EXISTENCE AND EXACT LOCATION OF ALL SERVICES MUST BE OBTAINED FROM THE INDIVIDUAL UTILITIES BEFORE PROCEEDING WITH CONSTRUCTION.



Stantec Consulting Ltd.

905 Waverley Street, Winnipeg, Manitoba
Tel 204-489-5900 Fax 204-453-9012

DESIGNED BY	J.K.H.	CHECKED BY	W.A.B.
DRAWN BY	K.R.	APPROVED BY	H.A.K.
HOR. SCALE:	1:500	RELEASED FOR CONSTRUCTION:	
VERTICAL:	N/A	DATE	2011.10.03

ENGINEER'S SEAL

CONSULTANT DRAWING NO.
C-127



**THE CITY OF WINNIPEG
WATER AND WASTE DEPARTMENT**

**2011 SEWER RENEWALS
BY CIPP LINING - CONTRACT 21
HAGEN DRIVE**

1ST MH S. OF PINEHURST CR. (PL) TO
2ND MH S. OF PINEHURST CR. (PL)

SHEET OF	30 OF 119
CAD FILE DRAWING NUMBER	13220c-116-766.dwg
CITY DRAWING NUMBER	9796

\\CD1201-F02\work_group\1112\active\111213220\drawing\402_design\sheet_files\13220c-116-766.dwg
Date: 2011-12-19 3:34pm Login: Ammeter, Wes