



**SEWER JUNCTION INFORMATION  
FOR SEWER ID MA60001576**

REFERENCE—METERS NORTH OF MANHOLE MH60000892

DIST. FROM REF. MANHOLE	JUNCTION DIA.	CLOCK REF.	SERVICE TYPE	DESCRIPTION
6.8	150	02	CN	W RM
27.6	150	03	CN	-
41.4	150	03	CN	-

**SEWER JUNCTION INFORMATION  
FOR SEWER ID MA60001575**

REFERENCE—METERS NORTH OF MANHOLE MH60001189

DIST. FROM REF. MANHOLE	JUNCTION DIA.	CLOCK REF.	SERVICE TYPE	DESCRIPTION
14.7	150	11	CNI	-
33.9	200	06	JN	-

ALL JUNCTION INFORMATION  
BASED ON CCTV INSPECTION

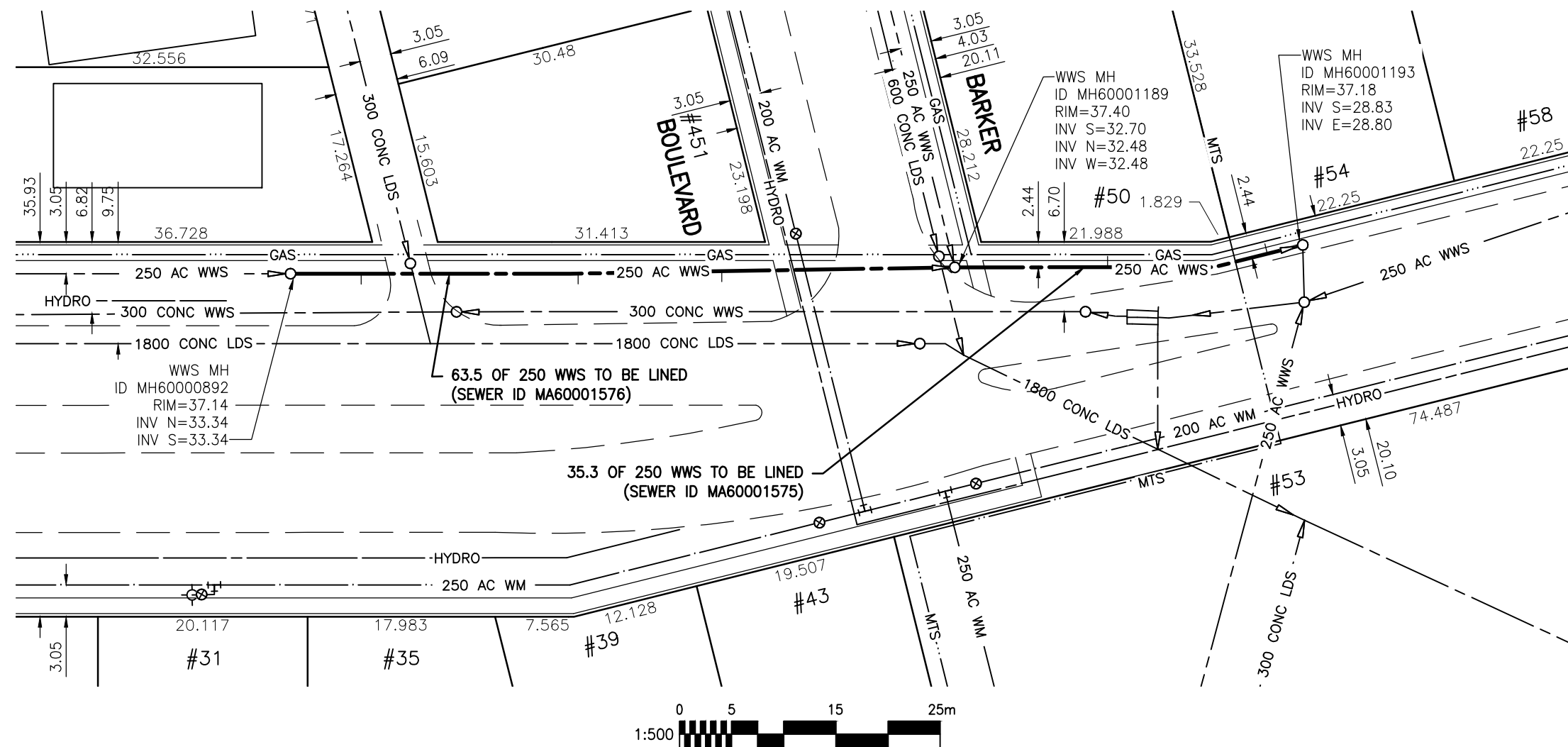

**WARNING**

IF POWER EQUIPMENT OR EXPLOSIVES ARE TO BE USED FOR EXCAVATION ON THIS PROJECT THE CONTRACTOR MUST:

- 1) NOTIFY THE GAS COMPANY OF THE PROPOSED LOCATION OF EXCAVATION.
- 2) TAKE PRECAUTION TO AVOID DAMAGE TO GAS COMPANY INSTALLATIONS.

SEE PROVINCIAL REGULATION 140/92 FOR DETAILS

**METRIC**

WHOLE NUMBERS INDICATE MILLIMETRES  
DECIMALIZED NUMBERS INDICATE METRES

BENCH MARK: W side Barker Blvd., Tblt in N. Conc. foundation of attached garage of No. 94 Barker Blvd., 1.0 m W. of N.E. Cor. of garage & 0.2 m below stucco.

Certificate of Authorization  
Stantec Consulting Ltd.  
No. 1301 Date: \_\_\_\_\_

**BID OPPORTUNITY 927-2011**

**LOCATION APPROVED  
UNDERGROUND STRUCTURES**

SUPV. U/G STRUCTURES COMMITTEE DATE

NOTE:  
LOCATION OF UNDERGROUND STRUCTURES AS SHOWN ARE BASED ON THE BEST INFORMATION AVAILABLE BUT NO GUARANTEE IS GIVEN THAT ALL EXISTING UTILITIES ARE SHOWN OR THAT THE GIVEN LOCATIONS ARE EXACT. CONFIRMATION OF EXISTENCE AND EXACT LOCATION OF ALL SERVICES MUST BE OBTAINED FROM THE INDIVIDUAL UTILITIES BEFORE PROCEEDING WITH CONSTRUCTION.

B.M.	48-007		
ELEV.	234.302m		
NO.	REVISIONS	DATE	BY



**Stantec Consulting Ltd.**

905 Waverley Street, Winnipeg, Manitoba  
Tel 204-489-5900 Fax 204-453-9012

DESIGNED BY	J.K.H.	CHECKED BY	W.A.B.
DRAWN BY	K.R.	APPROVED BY	H.A.K.
HOR. SCALE:	1:500	RELEASED FOR CONSTRUCTION:	
VERTICAL:	N/A		
DATE	2011.10.03	DATE	

ENGINEER'S SEAL

CONSULTANT DRAWING NO.  
**C-116**



**THE CITY OF WINNIPEG  
WATER AND WASTE DEPARTMENT**

**2011 SEWER RENEWALS  
BY CIPP LINING - CONTRACT 21  
BARKER BOULEVARD (E. LEG)**

**1ST MH S. BARKER BV. (S. LEG) TO  
1ST MH N. BARKER BV. (S. LEG)**

SHEET OF	19 OF 19
CAD FILE DRAWING NUMBER	13220c-116-766.dwg
CITY DRAWING NUMBER	<b>9785</b>