



**SEWER JUNCTION INFORMATION
FOR SEWER ID MA60000438**

REFERENCE—METERS NORTH OF MANHOLE MH60000260

DIST. FROM REF. MANHOLE	JUNCTION DIA.	CLOCK REF.	SERVICE TYPE	DESCRIPTION
9.9	100	11	JN	-
21.3	100	10	CN	-
28.4	100	11	JN	LIVE
46.8	100	11	JN	-
63.7	100	11	JN	-

ALL JUNCTION INFORMATION
BASED ON CCTV INSPECTION

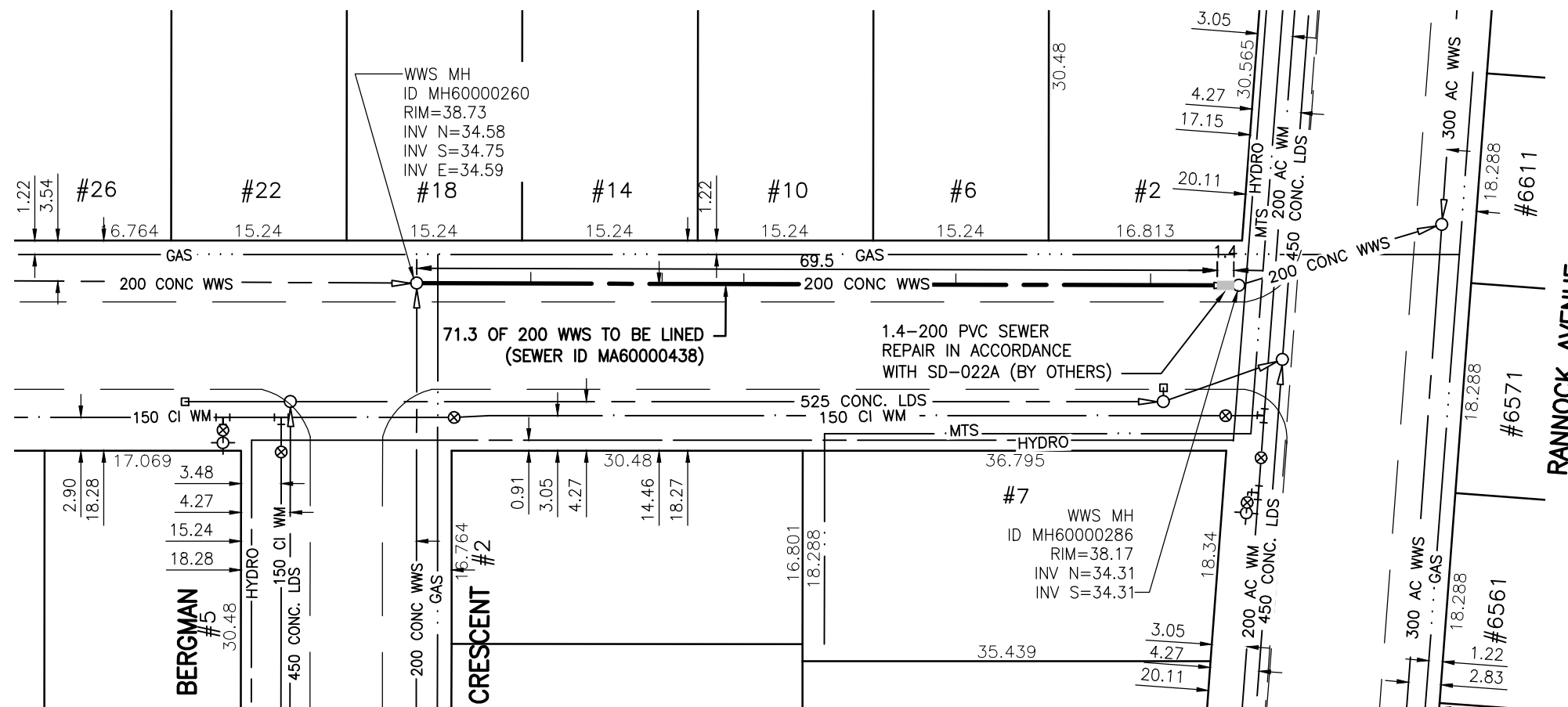

WARNING

IF POWER EQUIPMENT OR EXPLOSIVES ARE TO BE USED FOR EXCAVATION ON THIS PROJECT THE CONTRACTOR MUST:

- 1) NOTIFY THE GAS COMPANY OF THE PROPOSED LOCATION OF EXCAVATION.
- 2) TAKE PRECAUTION TO AVOID DAMAGE TO GAS COMPANY INSTALLATIONS.

SEE PROVINCIAL REGULATION 140/92 FOR DETAILS

METRIC

WHOLE NUMBERS INDICATE MILLIMETRES
DECIMALIZED NUMBERS INDICATE METRES

BENCH MARK: 83R553 - S.W. Cor. Cullen Dr. & Rannock St.; Tblt. on top of 0.05 m dia. X 2.4 m iron pipe, 2.1 m N. of S.L. of Rannock Ave. & on W.L. of Cullen Dr. produced from the S.



Certificate of Authorization

Stantec Consulting Ltd.

No. 1301 Date: _____

BID OPPORTUNITY 927-2011

LOCATION APPROVED
UNDERGROUND STRUCTURES

B.M.	48-039		
ELEV.	238.765m		
SUPV. U/G STRUCTURES COMMITTEE	DATE		
NO.	REVISIONS	DATE	BY



Stantec Consulting Ltd.

905 Waverley Street, Winnipeg, Manitoba
Tel 204-489-5900 Fax 204-453-9012

DESIGNED BY	J.K.H.	CHECKED BY	W.A.B.
DRAWN BY	K.R.	APPROVED BY	H.A.K.
HOR. SCALE:	1:500	RELEASED FOR CONSTRUCTION:	
VERTICAL:	N/A	DATE	2011.09.30

ENGINEER'S SEAL

CONSULTANT DRAWING NO.

C-110



**THE CITY OF WINNIPEG
WATER AND WASTE DEPARTMENT**

**2011 SEWER RENEWALS
BY CIPP LINING - CONTRACT 21
ATKINSON ROAD
MH AT BERGMAN CR. TO
1ST MH S. RANNOCK AV.**

SHEET	OF
13	119
CAD FILE DRAWING NUMBER 13220c-101-766.dwg	
CITY DRAWING NUMBER 9779	

\\CD1201-F02\work_group\1112\active\111213220\drawing\402_design\sheet_files\13220c-101-766.dwg
 Date: 2011-12-19 3:41pm Login: Ammeter, Wes