



**SEWER JUNCTION INFORMATION  
FOR SEWER ID MA6000078**

REFERENCE—METERS NORTH OF MANHOLE MH6000001

DIST. FROM REF. MANHOLE	JUNCTION DIA.	CLOCK REF.	SERVICE TYPE	DESCRIPTION
17.5	150	12	JN	CAPPED
25.3	150	02	CNI	—
26.7	150	12	CN	CAPPED
33.8	150	10	CXI	CRACKED
45.1	150	12	CN	—
52.0	200	11	CXI	LIVE. CRACKED
52.7	150	12	CN	CAPPED
60.5	150	02	CNI	—
63.3	150	12	CN	CAPPED
70.9	150	12	CN	CAPPED
72.4	150	10	CN	—
80.4	150	02	CN	—
81.6	150	12	CN	CAPPED
89.1	150	12	CN	CAPPED
91.0	150	10	CNI	LIVE
98.4	150	12	CN	CAPPED
98.8	150	02	CN	—

ALL JUNCTION INFORMATION  
BASED ON CCTV INSPECTION

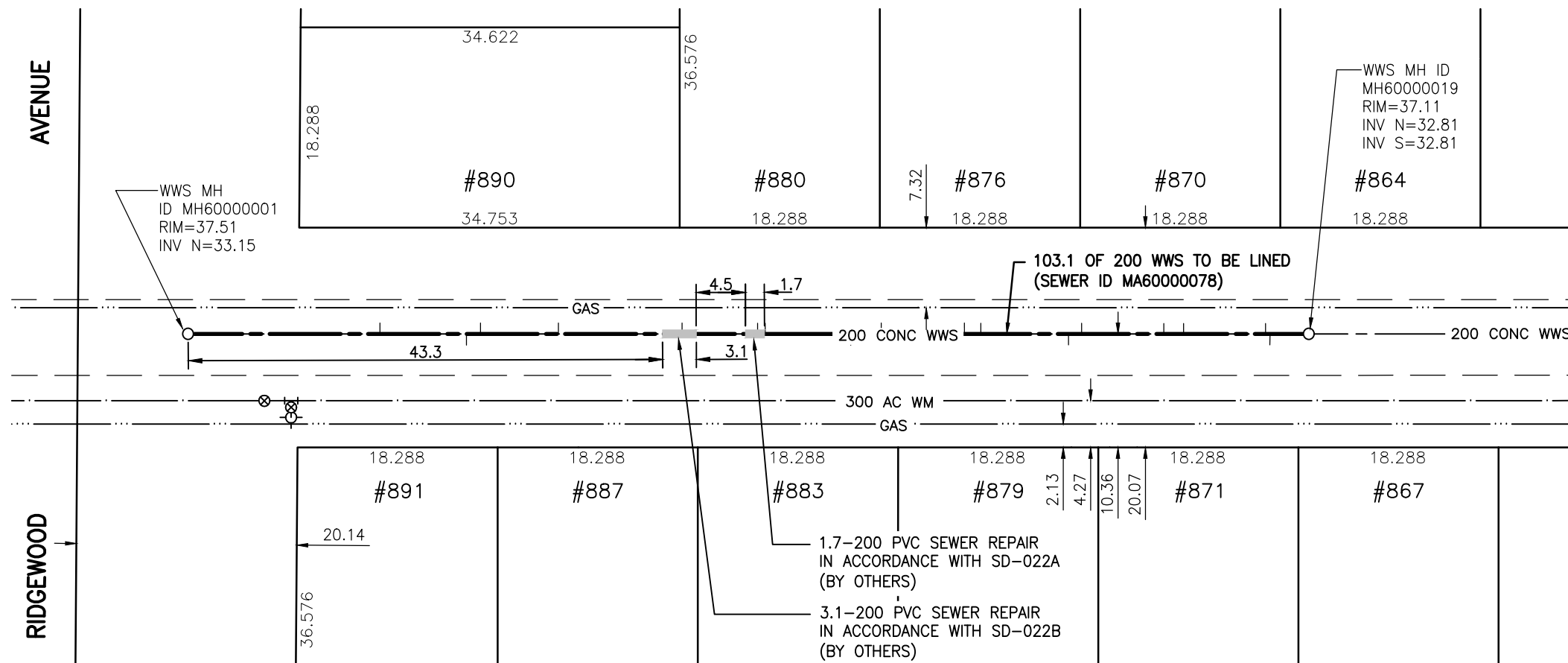

**WARNING**

IF POWER EQUIPMENT OR EXPLOSIVES ARE TO BE USED FOR EXCAVATION ON THIS PROJECT THE CONTRACTOR MUST:

- 1) NOTIFY THE GAS COMPANY OF THE PROPOSED LOCATION OF EXCAVATION.
- 2) TAKE PRECAUTION TO AVOID DAMAGE TO GAS COMPANY INSTALLATIONS.

SEE PROVINCIAL REGULATION 140/92 FOR DETAILS

BENCH MARK: S.E. Cor. Community Row & C.N.R. Harte Sub., Tblt. in N. Conc. foundation of fireplace on N. foundation of No. 901 Community Row, 2.6 m E. of N.W. Cor. of house & 2.0 m below stucco.

**METRIC**

WHOLE NUMBERS INDICATE MILLIMETRES  
DECIMALIZED NUMBERS INDICATE METRES



Certificate of Authorization

Stantec Consulting Ltd.

No. 1301 Date: \_\_\_\_\_

**BID OPPORTUNITY 927-2011**

**LOCATION APPROVED  
UNDERGROUND STRUCTURES**

NO.	REVISIONS	DATE	BY

SUPV. U/G STRUCTURES COMMITTEE DATE

**NOTE:**  
LOCATION OF UNDERGROUND STRUCTURES AS SHOWN ARE BASED ON THE BEST INFORMATION AVAILABLE BUT NO GUARANTEE IS GIVEN THAT ALL EXISTING UTILITIES ARE SHOWN OR THAT THE GIVEN LOCATIONS ARE EXACT. CONFIRMATION OF EXISTENCE AND EXACT LOCATION OF ALL SERVICES MUST BE OBTAINED FROM THE INDIVIDUAL UTILITIES BEFORE PROCEEDING WITH CONSTRUCTION.



**Stantec Consulting Ltd.**

905 Waverley Street, Winnipeg, Manitoba  
Tel 204-489-5900 Fax 204-453-9012

DESIGNED BY	J.K.H.	CHECKED BY	W.A.B.
DRAWN BY	K.R.	APPROVED BY	H.A.K.
HOR. SCALE:	1:500	RELEASED FOR CONSTRUCTION:	
VERTICAL:	N/A	DATE	2011.09.30

ENGINEER'S SEAL

CONSULTANT DRAWING NO.  
**C-108**



**THE CITY OF WINNIPEG**

**WATER AND WASTE DEPARTMENT**

**2011 SEWER RENEWALS  
BY CIPP LINING - CONTRACT 21  
COMMUNITY ROW**

**4TH MH S. OF RANNOCK AV. (CL) TO  
3RD MH S. OF RANNOCK AV.**

SHEET	OF
<b>11</b>	<b>119</b>
CAD FILE DRAWING NUMBER 13220c-101-766.dwg	
CITY DRAWING NUMBER <b>9777</b>	